

UNITED STATES  
DEPARTMENT OF THE INTERIOR  
BUREAU OF LAND MANAGEMENT

FORM APPROVED  
OMB No. 1004-0135  
Expires: January 31, 2004

**SUNDRY NOTICES AND REPORTS ON WELLS**

*Do not use this form for proposals to drill or to re-enter an abandoned well. Use Form 3160-3 (APD) for such proposals.*

**SUBMIT IN TRIPLICATE- Other instructions on reverse side**

1. Type of Well  
☐ Oil Well ☒ Gas Well ☐ Other

2. Name of Operator  
Lance Oil & Gas Company, Inc.

3a. Address  
P. O. Box 70, Kirtland, NM 87417

3b. Phone No. (include area code)  
505-598-5601

4. Location of Well (Footage, Sec., T., R., M., or Survey Description)

1,272' FNL & 673' FWL  
Section 10, T29N - R14W, NMPM

5. Lease Serial No.

NMSF - 079968

6. If Indian, Allottee or Tribe Name

1 N72

7. If Unit or CA/Agreement, Name and/or No.

N/A

8. Well Name and No.

ROPCO 10 #1

9. API Well No.

30 - 045 - 30444

10. Field and Pool, or Exploratory Area

Basin Fruitland Coal / Harper Hill PC

11. County or Parish, State

San Juan County, NM

**12. CHECK APPROPRIATE BOX(ES) TO INDICATE NATURE OF NOTICE, REPORT, OR OTHER DATA**

**TYPE OF SUBMISSION**

- ☒ Notice of Intent  
☐ Subsequent Report  
☐ Final Abandonment Notice

**TYPE OF ACTION**

- |   |   |  |   |
|---|---|--|---|
| <input type="checkbox"/> Acidize              | <input type="checkbox"/> Deepen           | <input type="checkbox"/> Production (Start/Resume) | <input type="checkbox"/> Water Shut-Off |
| <input type="checkbox"/> Alter Casing         | <input type="checkbox"/> Fracture Treat   | <input type="checkbox"/> Reclamation               | <input type="checkbox"/> Well Integrity |
| <input type="checkbox"/> Casing Repair        | <input type="checkbox"/> New Construction | <input checked="" type="checkbox"/> Recomplete     | <input type="checkbox"/> Other          |
| <input type="checkbox"/> Change Plans         | <input type="checkbox"/> Plug and Abandon | <input type="checkbox"/> Temporarily Abandon       |   |
| <input type="checkbox"/> Convert to Injection | <input type="checkbox"/> Plug Back        | <input type="checkbox"/> Water Disposal            |   |

13. Describe Proposed or Completed Operation (clearly state all pertinent details, including estimated starting date of any proposed work and approximate duration thereof. If the proposal is to deepen directionally or recompleat horizontally, give subsurface locations and measured and true vertical depths of all pertinent markers and zones. Attach the Bond under which the work will be performed or provide the Bond No. on file with BLM/BIA. Required subsequent reports shall be filed within 30 days following completion of the involved operations. If the operation results in a multiple completion or recompleat in a new interval, a Form 3160-4 shall be filed once testing has been completed. Final Abandonment Notices shall be filed only after all requirements, including reclamation, have been completed, and the operator has determined that the site is ready for final inspection.)

Lance Oil & Gas Company, Inc. respectfully requests approval to add the Basin Fruitland Coal (71629) to this well with the originally completed Harper Hill Pictured Cliffs.

Please find the ROPCO 10 #1 amended C - 102 indicating the W/2 proration unit.

**CONDITIONS OF APPROVAL**

Adhere to previously issued stipulations.

SEE ATTACHED FOR  
CONDITIONS OF APPROVAL

14. I hereby certify that the foregoing is true and correct  
Name (Printed/Typed)

Thomas M. Erwin, P.E.

Title Senior Production Engineer

Signature

*Thomas M. Erwin 9/20/05*

Date

09/19/2005

**THIS SPACE FOR FEDERAL OR STATE OFFICE USE**

Approved by *Matt Haldut*  
Conditions of approval, if any, are attached. Approval of this notice does not warrant or certify that the applicant holds legal or equitable title to those rights in the subject lease which would entitle the applicant to conduct operations thereon.

Title *PETR ENG*

Date

*10/6/05*

Office

*BLM-FFO*

Title 18 U.S.C. Section 1001 and Title 43 U.S.C. Section 1212, make it a crime for any person knowingly and willfully to make to any department or agency of the United States any false, fictitious or fraudulent statements or representations as to any matter within its jurisdiction.

(Instructions on page 2)

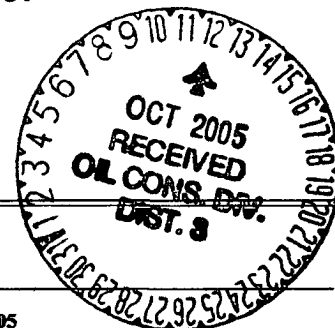

NMOC

State of New Mexico  
Energy, Minerals & Mining Resources Department

Form C - 102

OIL CONSERVATION DIVISION

2040 South Pacheco  
Santa Fe, NM 87505

WELL LOCATION AND ACREAGE DEDICATION PLAT

☒ AMENDED REPORT

APA Number <b>30-045-3044</b>	Pool Code <b>78160/71629</b>	Pool Name <b>Harper Hill Fruitland Sand PC / Basin Fruitland Coal</b>
Property Code <b>27015</b>	Property Name <b>ROPCO</b>	Well Number <b>10 - 1</b>
OCRD No. <b>229938</b>	Operator Name <b>Lance Oil &amp; Gas Company, Inc</b>	Elevation <b>5400'</b>

Surface Location									
UL or Lot	Sec.	Twp.	Rge.	Lot Lch.	Feet from	North/South	Feet from	East/West	County
<b>Q</b>	<b>10</b>	<b>29.N.</b>	<b>14 W.</b>		<b>.1272</b>	<b>NORTH</b>	<b>673.</b>	<b>WEST</b>	<b>SAN JUAN</b>

Bottom Hole Location if Different From Surface									
UL or Lot	Sec.	Twp.	Rge.	Lot Lch.	Feet from	North/South	Feet from	East/West	County
Dedication	Joint ?	Consolidation	Order No.						
<b>W/2 320</b>									

NO ALLOWABLE WILL ASSIGNED TO THIS COMPLETION UNTIL ALL INTERESTS HAVE BEEN CONSOLIDATED  
OR A NON-STANDARD UNIT HAS BEEN APPROVED BY THE DIVISION

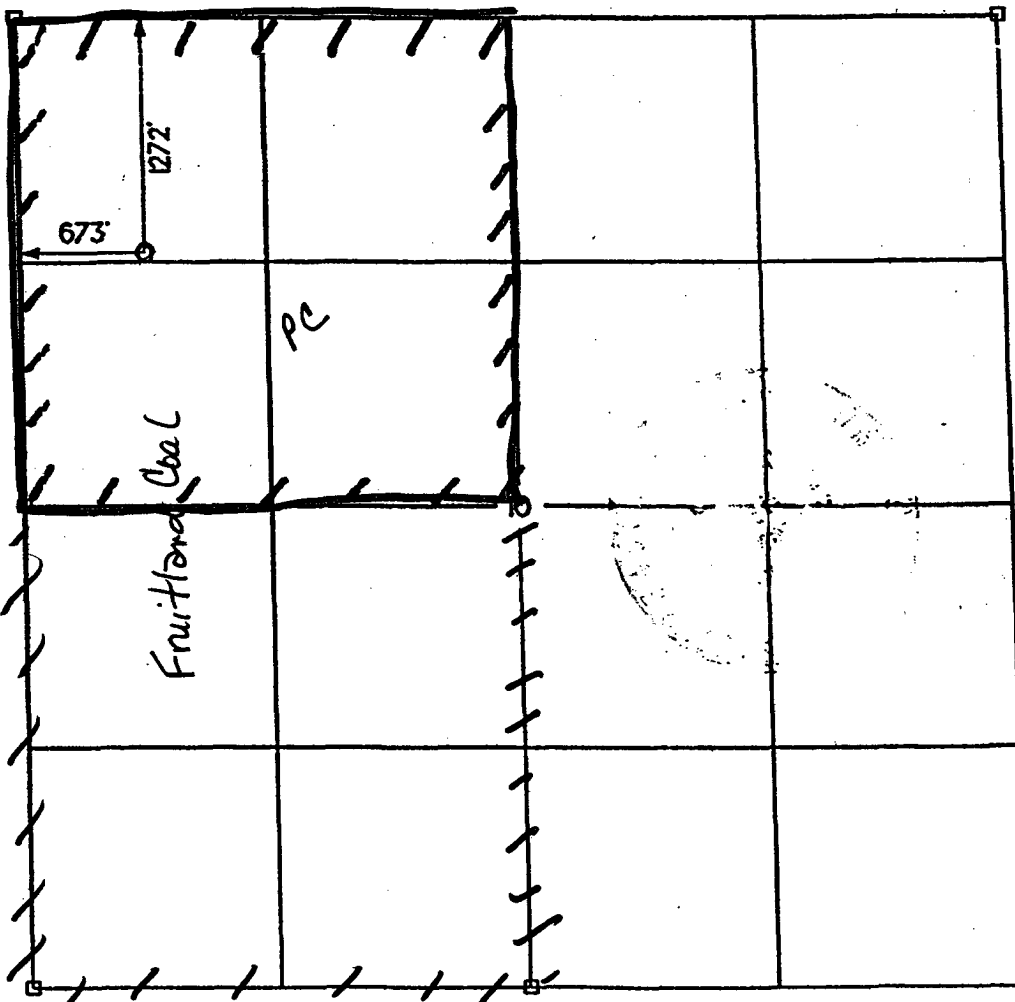

OPERATOR CERTIFICATION

I hereby certify that the information contained herein is true and complete to the best of my knowledge and belief.

Signature

*Thomas M. Erwin*

Printed Name

**THOMAS M. ERWIN**

Title

**S.R. PRODUCTION ENGINEER**

Date

**9/28/05**

SURVEYOR CERTIFICATION

I hereby certify that the well location on this plat was plotted from field notes of actual surveys made by me or under my supervision, and that the same is true and correct to the best of my belief.

Date of Survey

**9/28/05**

Signature

Professional Surveyor

**6844**

REGISTERED LAND SURVEYOR

## **Bureau of Land Management Conditions of Approval:**

- 1) If this well is located in a Specially Designated Area (SDA), compliance with the appropriate seasonal closure requirements will be necessary.**
- 2) Pits must be lined with an impervious material at least 12 mils thick. The pit must be fenced on three (3) sides during workover operations and on the 4<sup>th</sup> side after the rig moves off location. Pits must be closed within 90 days of completion of the workover operations. Prior to closing the pit the liner must be cut off at mud level.**