

## District I

1625 N. French Dr., Hobbs, NM 88240

## District II

1301 W. Grand Avenue, Artesia, NM 88210

## District III

1000 Rio Brazos Road, Aztec, NM 87410

## District IV

1220 S. St. Francis Dr., Santa Fe, NM 87505

State of New Mexico  
Energy Minerals and Natural Resources

Form C-101

March 4, 2004

## Oil Conservation Division

1220 South St. Francis Dr.

Santa Fe, NM 87505

Submit to appropriate District Office

State Lease - 6 Copies

Fee Lease - 5 Copies

☐ AMENDED REPORT

## APPLICATION FOR PERMIT TO DRILL, RE-ENTER, DEEPEN, PLUGBACK, OR ADD A ZONE

<sup>1</sup> Operator Name and Address <b>Robert L. Bayless, Producer LLC</b> <b>PO Box 168</b> <b>Farmington, NM 87499</b>		<sup>2</sup> OGRID Number <b>150182</b>
		<sup>3</sup> API Number 30 - <b>045-33437</b>
<sup>4</sup> Property Code <b>35264</b>	<sup>5</sup> Property Name <b>Boeing</b>	<sup>6</sup> Well No. <b>4</b>

<sup>7</sup> Surface Location

UL or lot no.	Section	Township	Range	Lot Idn	Feet from the	North/South line	Feet from the	East/West line	County
<b>P</b>	<b>2</b>	<b>26N</b>	<b>8W</b>		<b>760</b>	<b>South</b>	<b>1215</b>	<b>East</b>	<b>San Juan</b>

<sup>8</sup> Proposed Bottom Hole Location If Different From Surface

UL or lot no.	Section	Township	Range	Lot Idn	Feet from the	North/South line	Feet from the	East/West line	County

<sup>9</sup> Proposed Pool 1 <b>Basin Dakota</b>	<sup>10</sup> Proposed Pool 2 <b>Blanco Mesa Verde</b>
-----------------------------------------------------	-----------------------------------------------------------

## Drilling Pit Location and Other Information

UL or lot no. <b>P</b>	Section <b>2</b>	Township <b>26N</b>	Range <b>8W</b>	Lot Idn	Feet from the <b>760</b>	North/South line <b>South</b>	Feet from the <b>1215</b>	East/West line <b>East</b>	County <b>San Juan</b>
Depth to ground water <b>&gt;100 ft</b>				Distance from nearest fresh water well <b>&gt;1000 ft</b>		Distance from nearest surface water <b>&gt;100 ft</b>			
<sup>11</sup> Work Type Code <b>N</b>		<sup>12</sup> Well Type Code <b>M</b>		<sup>13</sup> Cable/Rotary <b>R</b>		<sup>14</sup> Lease Type Code <b>S</b>		<sup>15</sup> Ground Level Elevation <b>6187</b>	
<sup>16</sup> Multiple <b>Yes</b>		<sup>17</sup> Proposed Depth <b>6815</b>		<sup>18</sup> Formation <b>Dakota</b>		<sup>19</sup> Contractor		<sup>20</sup> Spud Date <b>ASAP</b>	

<sup>21</sup> Proposed Casing and Cement Program

Hole Size	Casing Size	Casing weight/foot	Setting Depth	Sacks of Cement	Estimated TOC
<b>12 1/4</b>	<b>8 5/8</b>	<b>24.0</b>	<b>300</b>	<b>210 sx (248 cf)</b>	<b>Surface</b>
<b>7 7/8</b>	<b>4 1/2</b>	<b>10.5</b>	<b>6815</b>	<b>880 sx (1871 cf)</b>	<b>Surface</b>

<sup>22</sup> Describe the proposed program. If this application is to DEEPEN or PLUG BACK, give the data on the present productive zone and proposed new productive zone. Describe the blowout prevention program, if any. Use additional sheets if necessary.

**Will drill a 12 1/4" hole to 300 feet and set 300 feet of 8 5/8" J-55 24.0 #/ft casing, cemented with 210 sx Class G cement. Cement will be circulated to surface. Will install and test BOP as per attached diagram. Will drill 7 7/8" hole to 6815 feet with clear water, natural mud, and water loss control. Open hole induction and density logs will be run. No abnormal temperatures or pressures are expected. Will run 6815 feet of 4 1/2" J-55 10.5 #/ft casing and cement with 880 sx cement in two stages, circulated to surface.**

<sup>23</sup> I hereby certify that the information given above is true and complete to the best of my knowledge and belief. I further certify that the drilling pit will be constructed according to NMOCD guidelines ☐, a general permit ☐, or an (attached) alternative OCD-approved plan ☐.

Signature: Printed name: **Price M. Bayless**Title: **Engineering Manager**E-mail Address: **tucker@rlbayless.com**Date: **11-17-05**Phone: **(505) 564-7803**

## OIL CONSERVATION DIVISION

Approved by:

Title: **DEPUTY OIL & GAS INSPECTOR, U.S.I.**Approval Date: **NOV 18 2005** Expiration Date: **NOV 18 2006**

Conditions of Approval:

Attached ☐

# Robert L. Bayless, Producer LLC

## Well Control Equipment Schematic for 2M Service

Attachment to Drilling Technical Program

### Boeing #4

Location: 760 FSL & 1215 FEL (SESE)  
Sec 2, T26N, R8W, NMPM  
San Juan, New Mexico

**BOP Stack**

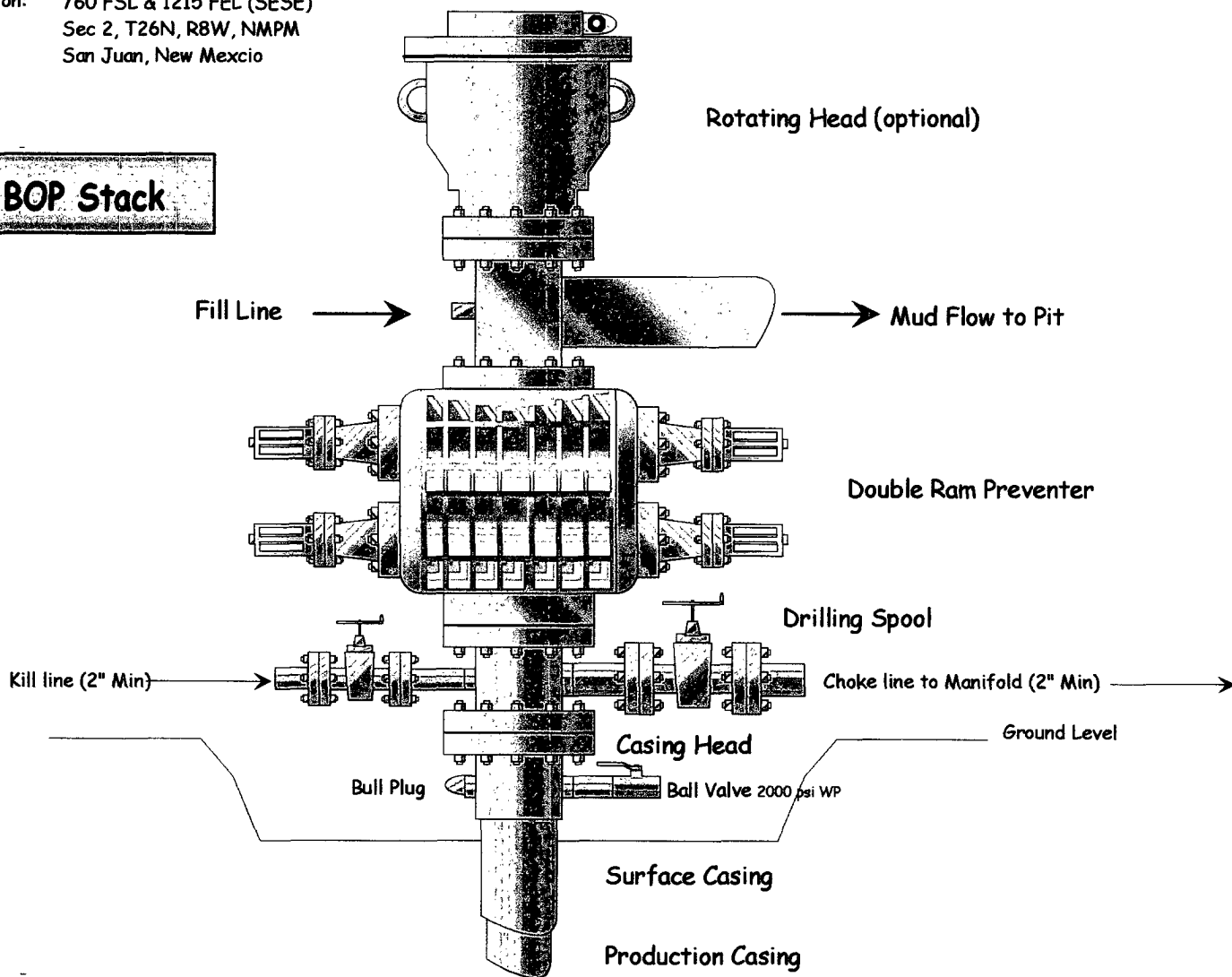

**Choke & Kill  
Manifold**

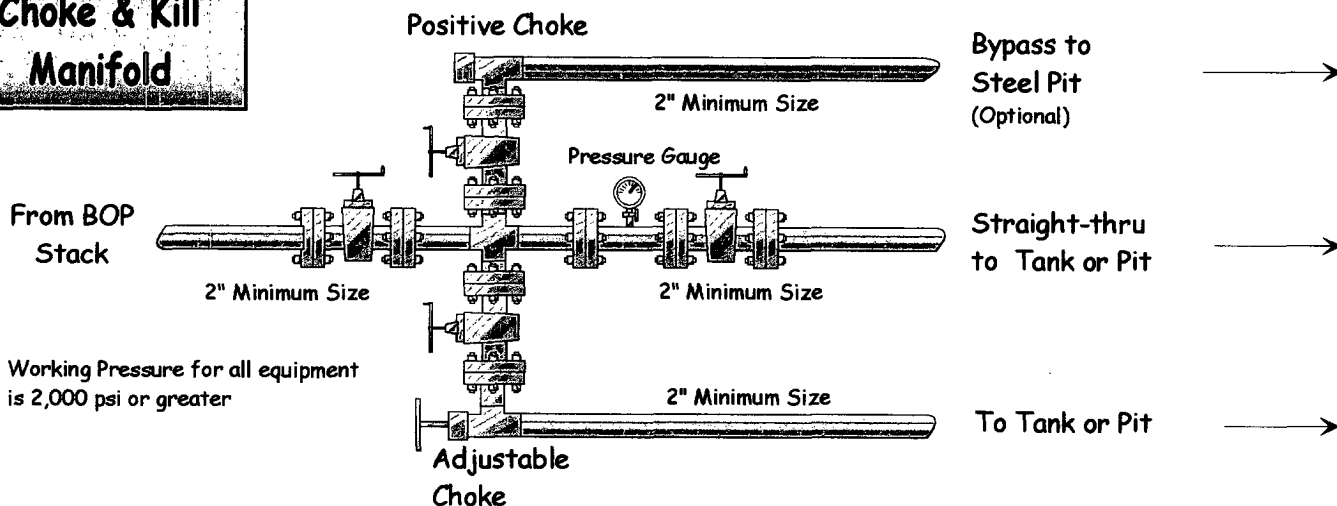

Working Pressure for all equipment  
is 2,000 psi or greater

District I  
1625 N. French Dr., Hobbs, NM 88240  
District II  
1301 W. Grand Avenue, Artesia, NM 88210  
District III  
1000 Rio Brazos Rd., Aztec, NM 87410  
District IV  
1220 S. St. Francis Dr., Santa Fe, NM 87505

State of New Mexico  
Energy, Minerals & Natural Resources Department  
**OIL CONSERVATION DIVISION**  
1220 South St. Francis Dr.  
Santa Fe, NM 87505

Form C-102  
Revised June 10, 2003  
Submit to Appropriate District Office  
State Lease - 4 Copies  
Fee Lease - 3 Copies

☐ AMENDED REPORT

**WELL LOCATION AND ACREAGE DEDICATION PLAT**

API Number <b>30-045-33437</b>		Pool Code 71599 72319	Pool Name Basin Dakota/Blanco Mesa Verde
Property Code <b>35264</b>	Property Name <b>BOEING</b>		Well Number <b>4</b>
OGRID No. 150182	Operator Name <b>ROBERT L. BAYLESS, PRODUCER LLC</b>		Elevation <b>6187</b>

**10 Surface Location**

UL or lot no. <b>P</b>	Section <b>2</b>	Township <b>26N</b>	Range <b>8W</b>	Lot Idn	Feet from the <b>760</b>	North/South line <b>South</b>	Feet from the <b>1215</b>	East/West line <b>East</b>	County <b>San Juan</b>
---------------------------	---------------------	------------------------	--------------------	---------	-----------------------------	----------------------------------	------------------------------	-------------------------------	---------------------------

**11 Bottom Hole Location If Different From Surface**

UL or lot no.	Section	Township	Range	Lot Idn	Feet from the	North/South line	Feet from the	East/West line	County
Dedicated Acres Joint or Infill Consolidation Code Order No.									

NO ALLOWABLE WILL BE ASSIGNED TO THIS COMPLETION UNTIL ALL INTERESTS HAVE BEEN CONSOLIDATED OR A NON-STANDARD UNIT HAS BEEN APPROVED BY THE DIVISION

<b>16</b> N 08°50'W Lot No (TP) <b>4</b> 20.34 79.87cm. 19.84				<b>77.79cm</b> <b>2</b> 20.31 79.76cm. 19.82				<b>17 OPERATOR CERTIFICATION</b> I hereby certify that the information contained herein is true and complete to the best of my knowledge and belief.  Signature Price M. Bayless Printed Name Engineering Manager Title and E-mail Address tucker@rlbayless.com Date 10-26-2005			
N 0°44'W 39.29				LAT. 36.51003°N LONG. 107.64719°W 1215' 760' 79.06cm. N 09°55'W				<b>18 SURVEYOR CERTIFICATION</b> I hereby certify that the well location shown on this plat was plotted from field notes of actual surveys made by me or under my supervision, and that the same is true and correct to the best of my knowledge and belief.  Date of Survey Signature and Seal of Professional Surveyor William H. Mahke II Certificate Number 8466			

ROBERT L. BAYLESS, PRODUCER LLC  
 BOEING #4  
 760'FSL & 1215'FEL  
 Sec.2, T26N, R8W, NMPM  
 San Juan Co., NM

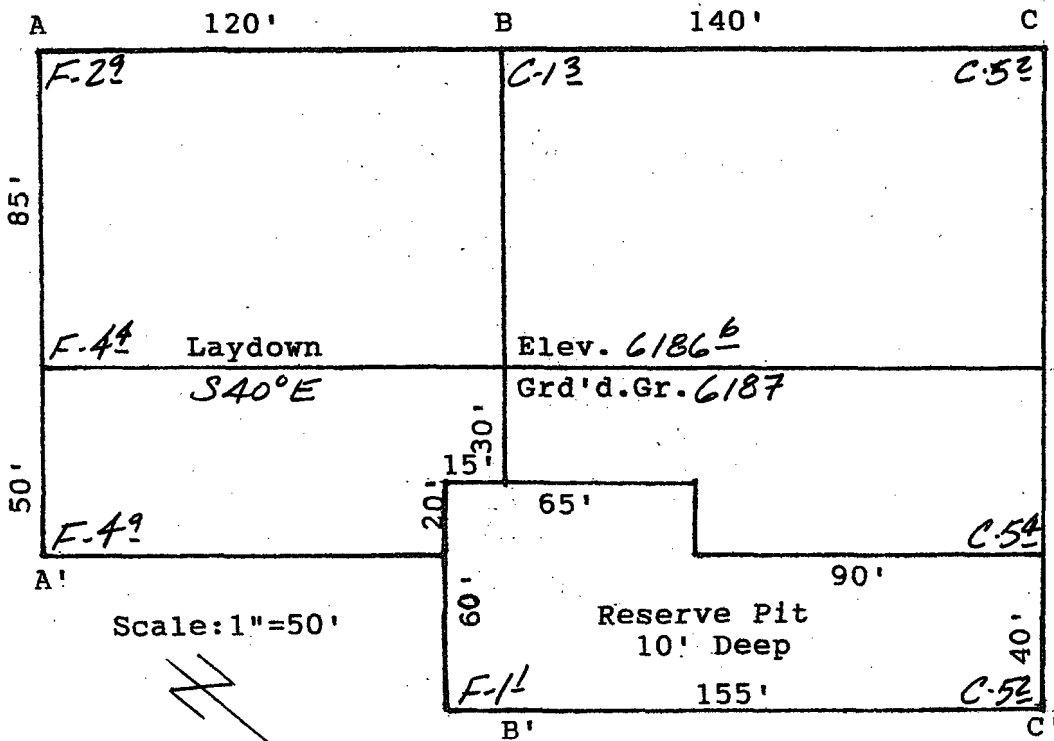

A-A'	Vert: 1"=30'	Horiz: 1"=50'	C/L
6190	-----	-----	-----
6180	-----	-----	-----
	-----	-----	-----
B-B'			
6190	-----	-----	-----
6180	-----	-----	-----
	-----	-----	-----
C-C'			
6190	-----	-----	-----
6180	-----	-----	-----
	-----	-----	-----