

UNITED STATES
DEPARTMENT OF THE INTERIOR
BUREAU OF LAND MANAGEMENT

FORM APPROVED
OMB No. 1004-0137
Expires: March 31, 2007

SUNDRY NOTICES AND REPORTS ON WELLS

Do not use this form for proposals to drill or to re-enter an abandoned well. Use Form 3160-3 (APD) for such proposals.

SUBMIT IN TRIPLICATE- Other instructions on reverse side.

1. Type of Well
☐ Oil Well ☒ Gas Well ☐ Other

2. Name of Operator **CONOCOPHILLIPS COMPANY**

3a. Address
4001 PENBROOK, ODESSA, TX 79762

3b. Phone No. (include area code)
432-368-1230

4. Location of Well (Footage, Sec., T., R., M., or Survey Description)
SWSE of Section 24, T31N, R8W 815 FSL - 1440 FEL

5. Lease Serial No.
SF-079351

6. Indian, Allottee or Tribe Name

7. If Unit or CA/Agreement, Name and/or No.

8. Well Name and No.

SAN JUAN 32-8 UNIT #206A

9. API Well No.

30-045-33308

10. Field and Pool, or Exploratory Area
Basin Fruitland Coal

11. County or Parish, State

SAN JUAN COUNTY, NM

12. CHECK APPROPRIATE BOX(ES) TO INDICATE NATURE OF NOTICE, REPORT, OR OTHER DATA

TYPE OF SUBMISSION	TYPE OF ACTION			
<input checked="" type="checkbox"/> Notice of Intent	<input type="checkbox"/> Acidize	<input type="checkbox"/> Deepen	<input type="checkbox"/> Production (Start/Resume)	<input type="checkbox"/> Water Shut-Off
<input type="checkbox"/> Subsequent Report	<input type="checkbox"/> Alter Casing	<input type="checkbox"/> Fracture Treat	<input type="checkbox"/> Reclamation	<input type="checkbox"/> Well Integrity
<input type="checkbox"/> Final Abandonment Notice	<input type="checkbox"/> Casing Repair	<input type="checkbox"/> New Construction	<input type="checkbox"/> Recomplete	<input checked="" type="checkbox"/> Other SUBMIT
	<input type="checkbox"/> Change Plans	<input type="checkbox"/> Plug and Abandon	<input type="checkbox"/> Temporarily Abandon	CATHODIC
	<input type="checkbox"/> Convert to Injection	<input type="checkbox"/> Plug Back	<input type="checkbox"/> Water Disposal	PROTECTION

13. Describe Proposed or Completed Operation (clearly state all pertinent details, including estimated starting date of any proposed work and approximate duration thereof. If the proposal is to deepen directionally or recomplate horizontally, give subsurface locations and measured and true vertical depths of all pertinent markers and zones. Attach the Bond under which the work will be performed or provide the Bond No. on file with BLM/BIA. Required subsequent reports shall be filed within 30 days following completion of the involved operations. If the operation results in a multiple completion or recompletion in a new interval, a Form 3160-4 shall be filed once testing has been completed. Final Abandonment Notices shall be filed only after all requirements, including reclamation, have been completed, and the operator has determined that the site is ready for final inspection.)

ConocoPhillips requests to submit the attached cathodic protection information and plat for this well.

ACCEPTED FOR RECORD

SEP 12 2005

FARMINGTON FIELD OFFICE
BY RS

14. I hereby certify that the foregoing is true and correct
Name (Printed/Typed)

Peggy James

Title **Sr. Associate**

Signature

Peggy James

Date

09/06/2005

THIS SPACE FOR FEDERAL OR STATE OFFICE USE

Approved by

Conditions of approval, if any, are attached. Approval of this notice does not warrant or certify that the applicant holds legal or equitable title to those rights in the subject lease which would entitle the applicant to conduct operations thereon.

Title

Date

Office

Title 18 U.S.C. Section 1001 and Title 43 U.S.C. Section 1212, make it a crime for any person knowingly and willfully to make to any department or agency of the United States any false, fictitious or fraudulent statements or representations as to any matter within its jurisdiction.

(Instructions on page 2)

NMOC



TECHNICAL SERVICES
A CORROSION COMPANY

CATHODIC PROTECTION PLAN FOR NEW WELLS

WELL NAME S.J. 32-B #206A

LEGALS 0-2431-B

COUNTY S.J.

PURPOSED C.P. SYSTEM: DRILL G.B. & SET RECT @ S.W. CORNER OF LOCATION. TRENCH @
200' #8 NEG FROM RECT. TO W.H. ALSO SET H.P. @ MAIN RD & TRENCH @
600' OF A.C. FROM M.P. TO RECT. @ LOCATION.

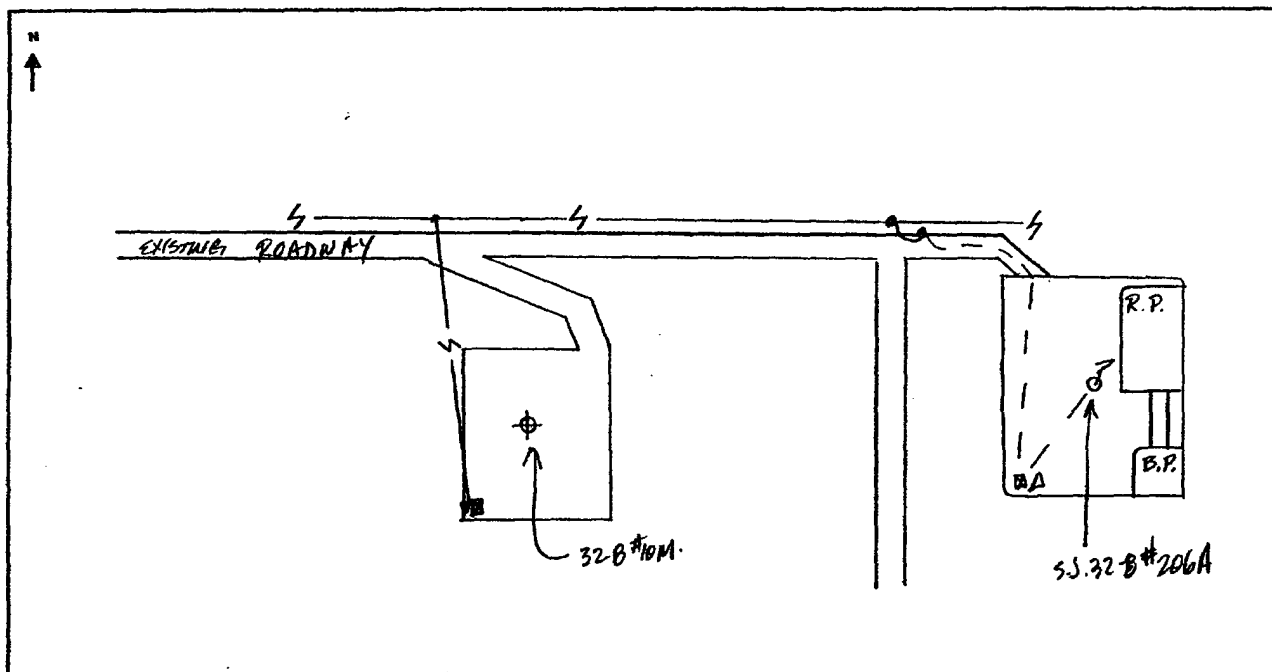

EXISTING WELLHEAD	METER HOUSE	G.B.	POWER SOURCE	CABLE	NEW WELL	OVERHEAD A.C.

COMMENTS:

NEAREST POWER SOURCE O.H.

DISTANCE: 600'

PIPELINES IN AREA:

TECHNICIAN: [Signature]

DATE: 8-23-05

6 CR 5412 BLOOMFIELD, N.M. 87413
OFFICE: 505-634-0271 CELL: 505-793-8953

Property : SAN JUAN 32-8 UNIT **Well #:** 206A

Surface Location:

Unit: O **Section:** 24 **Township:** 31N **Range:** 8W

County: SAN JUAN **State:** New Mexico

Footage: 815 **from the** SOUTH **line,** 1440 **from the** EAST **line.**

CATHODIC PROTECTION

ConocoPhillips (COP) proposes to drill a cathodic protection deep well groundbed for the subject well. COP will drill a hole vertically at the surface large enough to accommodate 20 feet of 8 inch diameter PVC pipe for surface casing to assist in further drilling and loading. Casing may be cemented in place for stability if needed. COP will drill a 6-7/8" hole to an anticipated minimum depth of 300' (maximum depth of 500'). Cement plugs will not be used unless more than one water zone is encountered. Prior drilling history for the area indicates only one zone to that depth. If more than one water zone is encountered, notification will be made and details of cement and casing will be provided.

All drilling activity will remain on the existing well pad and a Farmington based company will be doing the drilling for ConocoPhillips.