

District I  
1625 N. French Dr., Hobbs, NM 88240  
District II  
1301 W. Grand Avenue, Artesia, NM 88210  
District III  
1000 Rio Brazos Road, Aztec, NM 87410  
District IV  
1220 S. St. Francis Dr., Santa Fe, NM 87505

State of New Mexico  
Energy Minerals and Natural Resources

Form C-144  
June 1, 2004

Oil Conservation Division  
1220 South St. Francis Dr.  
Santa Fe, NM 87505

For drilling and production facilities, submit to  
appropriate NMOCD District Office.  
For downstream facilities, submit to Santa Fe  
office

**Pit or Below-Grade Tank Registration or Closure**

Is pit or below-grade tank covered by a "general plan"? Yes ☒ No ☐

Type of action: Registration of a pit or below-grade tank ☐ Closure of a pit or below-grade tank ☒

Operator: BP America Production Company Telephone: (505)326-9200 e-mail address: \_\_\_\_\_  
Address: 200 Energy Ct. Farmington, NM 87401  
Facility or well name: Drillhard #5 API #: 3004520738 U/L or Qtr/Qtr \_\_\_\_\_ Sec \_\_\_\_\_ T N R W  
County: San Juan Latitude \_\_\_\_\_ Longitude \_\_\_\_\_ NAD: 1927 ☐ 1983 ☐  
Surface Owner: Federal ☐ State ☐ Private ☐ Indian ☐

Pit	Below-grade tank
Type: Drilling <input type="checkbox"/> Production <input checked="" type="checkbox"/> Disposal <input type="checkbox"/> Workover <input type="checkbox"/> Emergency <input type="checkbox"/> Lined <input type="checkbox"/> Unlined <input type="checkbox"/> Liner type: Synthetic <input type="checkbox"/> Thickness _____ mil Clay <input type="checkbox"/> Pit Volume _____ bbl	Volume: _____ bbl Type of fluid: _____ Construction material: _____ Double-walled, with leak detection? Yes <input type="checkbox"/> If not, explain why not. _____
Depth to ground water (vertical distance from bottom of pit to seasonal high water elevation of ground water.)	Less than 50 feet (20 points) 50 feet or more, but less than 100 feet (10 points) 100 feet or more (0 points)
Wellhead protection area: (Less than 200 feet from a private domestic water source, or less than 1000 feet from all other water sources.)	Yes (20 points) No (0 points)
Distance to surface water: (horizontal distance to all wetlands, playas, irrigation canals, ditches, and perennial and ephemeral watercourses.)	Less than 200 feet (20 points) 200 feet or more, but less than 1000 feet (10 points) 1000 feet or more (0 points)
Ranking Score (Total Points)	

If this is a pit closure: (1) Attach a diagram of the facility showing the pit's relationship to other equipment and tanks. (2) Indicate disposal location: (check the onsite box if you are burying in place) onsite ☐ offsite ☐ If offsite, name of facility \_\_\_\_\_. (3) Attach a general description of remedial action taken including remediation start date and end date. (4) Groundwater encountered: No ☐ Yes ☐ If yes, show depth below ground surface \_\_\_\_\_ ft. and attach sample results. (5) Attach soil sample results and a diagram of sample locations and excavations.

Additional Comments:

See Attached Documentation

NOV 2005  
RECEIVED  
OIL CONS. DIV.  
DIST. 8

I hereby certify that the information above is true and complete to the best of my knowledge and belief. I further certify that the above-described pit or below-grade tank has been/will be constructed or closed according to NMOCD guidelines ☒, a general permit ☐, or an (attached) alternative OCD-approved plan ☐.

Date: 11/01/2005

Printed Name/Title Jeffrey C. Blagg, Agent

Signature Jeffrey C. Blagg

Your certification and NMOCD approval of this application/closure does not relieve the operator of liability should the contents of the pit or tank contaminate ground water or otherwise endanger public health or the environment. Nor does it relieve the operator of its responsibility for compliance with any other federal, state, or local laws and/or regulations.

Approval: DEPUTY OIL & GAS INSPECTOR, DIST. 8 Signature Denny Farnley Date: NOV 18 2005

District I  
P.O. Box 1980, Hobbs, NM  
District II  
P.O. Drawer DD, Artesia, NM 88211  
District III  
100 Rio Brazos Rd, Aztec, NM 87410

State of New Mexico  
Energy, Minerals and Natural Resources Department

OIL CONSERVATION DIVISION  
P.O. Box 2088  
Santa Fe, New Mexico 87504-2088

SUBMIT 1 COPY TO  
APPROPRIATE  
DISTRICT OFFICE  
AND 1 COPY TO  
SANTA FE OFFICE

## PIT REMEDIATION AND CLOSURE REPORT

Operator: Amoco Production Company Telephone: (505) - 326-9200  
Address: 200 Amoco Court, Farmington, New Mexico 87401  
Facility Or: PRITCHARD # 5  
Well Name \_\_\_\_\_  
Location: Unit or Qtr/Qtr Sec B Sec 34 T31N R 9W County SAN JUAN  
Pit Type: Separator ABANDONED Dehydrator ☒ Other \_\_\_\_\_  
Land Type: BLM ☒, State \_\_\_\_\_, Fee \_\_\_\_\_, Other \_\_\_\_\_

Pit Location: Pit dimensions: length 18', width 19', depth 4'  
(Attach diagram) Reference: wellhead ☒, other \_\_\_\_\_  
Footage from reference: 75'  
Direction from reference: 82 Degrees ☒ East North \_\_\_\_\_  
of \_\_\_\_\_ West South ☒

Depth To Ground Water: Less than 50 feet (20 points)  
(Vertical distance from 50 feet to 99 feet (10 points)  
contaminants to seasonal Greater than 100 feet (0 Points) 20  
high water elevation of  
ground water)

Wellhead Protection Area: Yes (20 points)  
(Less than 200 feet from a private No (0 points) 0  
domestic water source, or; less than  
1000 feet from all other water sources)

Distance To Surface Water: Less than 200 feet (20 points)  
(Horizontal distance to perennial 200 feet to 1000 feet (10 points) 10  
lakes, ponds, rivers, streams, creeks,  
irrigation canals and ditches) Greater than 1000 feet (0 points)

RANKING SCORE (TOTAL POINTS): 30

80279

ABAS. DEHY

Date Remediation Started: \_\_\_\_\_ Date Completed: 12/13/00Remediation Method: Excavation ☒  
(Check all appropriate sections)Landfarmed ☒Approx. cubic yards 30Insitu Bioremediation ☐

Other \_\_\_\_\_

Remediation Location: Onsite ☒ Offsite ☐(ie. landfarmed onsite,  
name and location of  
offsite facility)

General Description Of Remedial Action: \_\_\_\_\_

Excavation .  
\_\_\_\_\_  
\_\_\_\_\_  
\_\_\_\_\_  
\_\_\_\_\_  
\_\_\_\_\_Ground Water Encountered: No ☒ Yes ☐ Depth \_\_\_\_\_

Final Pit:

Closure Sampling:

(if multiple samples,  
attach sample results  
and diagram of sample  
locations and depths)Sample location see Attached DocumentsSample depth 5' (PTT Bottom)Sample date 12/12/00Sample time 1010

Sample Results

Benzene(ppm) \_\_\_\_\_

Total BTEX(ppm) \_\_\_\_\_

Field headspace(ppm) 0.0TPH 68.4 ppmGround Water Sample: Yes ☐ No ☒ (If yes, attach sample results)I HEREBY CERTIFY THAT THE INFORMATION ABOVE IS TRUE AND COMPLETE TO THE BEST  
OF MY KNOWLEDGE AND BELIEFDATE 12/13/00

SIGNATURE

B. ShawPRINTED NAME  
AND TITLEBuddy D. Shaw  
ENVIRONMENTAL COORDINATOR

3004520738

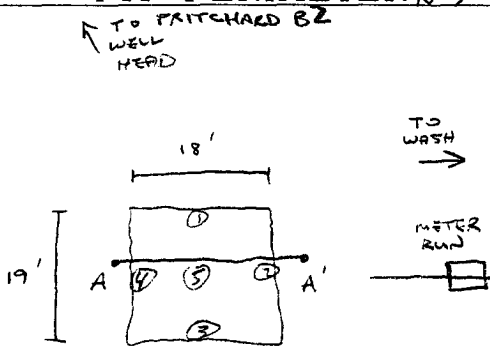
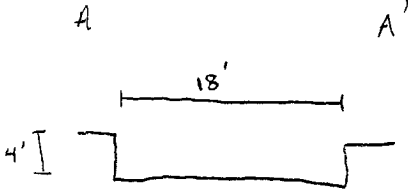
CLIENT: <u>AMOCO</u>	BLAGG ENGINEERING, INC. P.O. BOX 87, BLOOMFIELD, NM 87413 (505) 632-1199	LOCATION NO: <u>B0279</u> C.D.C. NO: <u>8262</u>																											
FIELD REPORT: CLOSURE VERIFICATION		PAGE No: <u>1</u> of <u>1</u>																											
LOCATION: NAME: <u>PRITCHARD</u> WELL #: <u>5</u> PIT: <u>ASAD DEHY</u> QUAD/UNIT: <u>B</u> SEC: <u>34</u> TWP: <u>31N</u> RNG: <u>9W</u> PM: <u>NM</u> CNTY: <u>ST NM</u> QTR/FOOTAGE: <u>1100'N/1650'E</u> NONE CONTRACTOR: <u>FLINT</u>		DATE STARTED: <u>12/12/00</u> DATE FINISHED: _____ ENVIRONMENTAL SPECIALIST: <u>JU</u>																											
EXCAVATION APPROX. <u>18</u> FT. x <u>19</u> FT. x <u>4</u> FT. DEEP. CUBIC YARDAGE: <u>30</u> DISPOSAL FACILITY: <u>ON-SITE</u> REMEDIATION METHOD: <u>LANDFARMED</u> LAND USE: <u>RANGE</u> LEASE: <u>NM 013686</u> FORMATION: <u>DR</u>																													
FIELD NOTES & REMARKS: PIT LOCATED APPROXIMATELY <u>75</u> FT. <u>582E</u> FROM WELL HEAD. DEPTH TO GROUNDWATER: <u>&lt;50'</u> NEAREST WATER SOURCE: <u>&gt;1000'</u> NEAREST SURFACE WATER: <u>&lt;1000'</u> NMOC RANKING SCORE: <u>30</u> NMOC TPH CLOSURE STD: <u>100</u> PPM SOIL AND EXCAVATION DESCRIPTION: <u>MOD. YELL. TO DISKY BROWN SILT CLAY TO CLAY, SLIGHTLY PLASTIC TO PLASTIC, SLIGHTLY MOIST TO MOIST, FIRM TO STIFF, NO APPARENT STAINING OBSERVED OR HC DOOR DETECTED WITHIN EXCAVATION OR OVM SAMPLES.</u>																													
		CHECK ONE <input checked="" type="checkbox"/> PIT ABANDONED <input type="checkbox"/> STEEL TANK INSTALLED <input type="checkbox"/> FIBERGLASS TANK INSTALLED																											
OVM CALIB. READ. <u>51.2</u> ppm TIME: <u>0850</u> am/pm <u>12/12/00</u>																													
SCALE 																													
FIELD 418.1 CALCULATIONS																													
TIME	SAMPLE I.D.	LAB No:	WEIGHT (g)	mL. FREON	DILUTION	READING	CALC. ppm																						
1010																													
PIT PERIMETER		PIT PROFILE																											
		OVM RESULTS <table border="1" style="width:100%; border-collapse: collapse;"> <thead> <tr> <th>SAMPLE ID</th> <th>FIELD HEADSPACE PID (ppm)</th> </tr> </thead> <tbody> <tr><td>1 @ 2'</td><td>0.0</td></tr> <tr><td>2 @ 2'</td><td>0.0</td></tr> <tr><td>3 @ 2'</td><td>0.0</td></tr> <tr><td>4 @ 2'</td><td>0.0</td></tr> <tr><td>5 @ 5'</td><td>0.0</td></tr> <tr><td> </td><td> </td></tr> <tr><td> </td><td> </td></tr> <tr><td> </td><td> </td></tr> <tr><td> </td><td> </td></tr> <tr><td> </td><td> </td></tr> </tbody> </table>		SAMPLE ID	FIELD HEADSPACE PID (ppm)	1 @ 2'	0.0	2 @ 2'	0.0	3 @ 2'	0.0	4 @ 2'	0.0	5 @ 5'	0.0														
SAMPLE ID	FIELD HEADSPACE PID (ppm)																												
1 @ 2'	0.0																												
2 @ 2'	0.0																												
3 @ 2'	0.0																												
4 @ 2'	0.0																												
5 @ 5'	0.0																												
		LAB SAMPLES <table border="1" style="width:100%; border-collapse: collapse;"> <thead> <tr> <th>SAMPLE ID</th> <th>ANALYSIS</th> <th>TIME</th> </tr> </thead> <tbody> <tr> <td>5 @ 5'</td> <td>TPH (8015)</td> <td>1010</td> </tr> <tr> <td colspan="3" style="text-align: center;"><u>PASSED</u></td> </tr> <tr><td> </td><td> </td><td> </td></tr> <tr><td> </td><td> </td><td> </td></tr> <tr><td> </td><td> </td><td> </td></tr> </tbody> </table>		SAMPLE ID	ANALYSIS	TIME	5 @ 5'	TPH (8015)	1010	<u>PASSED</u>																			
SAMPLE ID	ANALYSIS	TIME																											
5 @ 5'	TPH (8015)	1010																											
<u>PASSED</u>																													
TRAVEL NOTES: CALLOUT: <u>12/12/00 - MORN.</u> ONSITE: <u>12/12/00 - MORN.</u>																													

# ENVIROTECH LABS

PRACTICAL SOLUTIONS FOR A BETTER TOMORROW

## EPA METHOD 8015 Modified Nonhalogenated Volatile Organics Total Petroleum Hydrocarbons

Client:	Blagg / BP	Project #:	403410
Sample ID:	5 @ 5'	Date Reported:	12-13-00
Laboratory Number:	18988	Date Sampled:	12-12-00
Chain of Custody No:	8262	Date Received:	12-12-00
Sample Matrix:	Soil	Date Extracted:	12-13-00
Preservative:	Cool	Date Analyzed:	12-13-00
Condition:	Cool and Intact	Analysis Requested:	8015 TPH

Parameter	Concentration (mg/Kg)	Det. Limit (mg/Kg)
Gasoline Range (C5 - C10)	1.1	0.2
Diesel Range (C10 - C28)	67.3	0.1
Total Petroleum Hydrocarbons	68.4	0.1

ND - Parameter not detected at the stated detection limit.

References: Method 8015B, Nonhalogenated Volatile Organics, Test Methods for Evaluating Solid Waste, SW-846, USEPA, December 1996.

Comments: Pritchard #5 Abandoned Dehydrator Pit.

  
Analyst

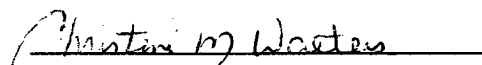
  
Review

CLIENT: <u>BP</u>	BLAGG ENGINEERING, INC. P.O. BOX 87, BLOOMFIELD, NM 87413 (505) 632-1199	LOCATION NO <u>80279</u> C.O.C. NO: <u>9729</u>
-------------------	--	--

# FIELD REPORT: LANDFARM/COMPOST PILE CLOSURE VERIFICATION

LOCATION: NAME: <u>PRITCHARD</u>	WELL #: <u>5</u>	PITS: <u>DENY</u>	DATE STARTED: <u>2/26/02</u>
QUAD/UNIT: <u>B SEC: 34 TWP: 31N RNG: 9W PM: NM CNTY: SJ ST: NM</u>			DATE FINISHED: _____
QTR/FOOTAGE: <u>NW 1/4</u>	CONTRACTOR: <u>FLINT</u>	ENVIRONMENTAL SPECIALIST: <u>NV</u>	

SOIL REMEDIATION:	30 + 400
REMEDIATION SYSTEM: <u>LANDFARM</u>	APPROX. CUBIC YARDAGE: <u>430</u>
LAND USE: <u>RANGE - BLM</u>	LIFT DEPTH (ft): <u>1-1.5</u>

FIELD NOTES & REMARKS:	NMOC Ranking Score: <u>0</u>	NMOC TPH Closure Std: <u>100</u> ppm
DEPTH TO GROUNDWATER: <u>&lt;50'</u>	NEAREST WATER SOURCE: <u>&gt;1000'</u>	NEAREST SURFACE WATER: <u>&lt;1000'</u>

SOIL TYPE: (SAND) / SILTY SAND / SILT / SILTY CLAY / CLAY / GRAVEL / OTHER \_\_\_\_\_

SOIL COLOR: DR. YELL. ORANGE TO DR. YELL.

COHESION (ALL OTHERS): (NON COHESIVE) / SLIGHTLY COHESIVE / COHESIVE / HIGHLY COHESIVE

CONSISTENCY (NON COHESIVE SOILS): (LOOSE) / (FIRM) / DENSE / VERY DENSE

PLASTICITY (CLAYS): NON PLASTIC / SLIGHTLY PLASTIC / COHESIVE / MEDIUM PLASTIC / HIGHLY PLASTIC

DENSITY (COHESIVE CLAYS & SILTS): SOFT / FIRM / STIFF / VERY STIFF / HARD

MOISTURE: DRY / (SLIGHTLY MOIST) / MOIST / WET / SATURATED / SUPER SATURATED

DISCOLORATION/STAINING OBSERVED: (YES) / NO EXPLANATION - SURFACE STAINING (SEE SKETCH)

HC ODOR DETECTED: YES / (NO) EXPLANATION - \_\_\_\_\_

SAMPLING DEPTHS (LANDFARMS): 8-15 (INCHES)

SAMPLE TYPE: GRAB / (COMPOSITE) - # OF PTS. 5

ADDITIONAL COMMENTS: 400 C.Y. DEPOSED FROM SCHWEDTFEGER & BIA (0-27-31-9) AFTER SAMPLING MATERIAL WAS THEN MOVED BACK TO SCHWEDTFEGER & BIA (STANDARD 5,000 PPM)

## FIELD 418.1 CALCULATIONS

SAMP. TIME	SAMPLE I.D.	LAB No:	WEIGHT (g)	mL. FREON	DILUTION	READING	CALC. ppm

## SKETCH/SAMPLE LOCATIONS

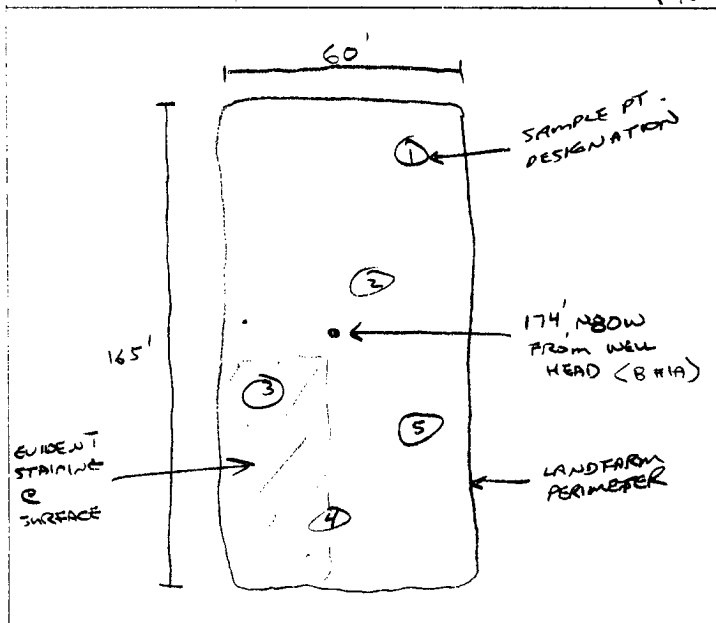

DVM CALIB. READ. 52.3 ppm  
DVM CALIB. GAS = 100 ppm; RF = 0.52  
TIME: 9:05 am DATE: 2/26/02

## OVM RESULTS

## LAB SAMPLES

SAMPLE ID	FIELD HEADSPACE PID (ppm)	SAMPLE ID	ANALYSIS	TIME	RESULTS
LF-1	1.1	LF-1	TPH (20158)	1230	2,180

## SCALE



TRAVEL NOTES: CALLOUT: <u>NA</u>	ONSITE: <u>2/26/02</u>
----------------------------------	------------------------

# ENVIROTECH LABS

PRACTICAL SOLUTIONS FOR A BETTER TOMORROW

## EPA METHOD 8015 Modified Nonhalogenated Volatile Organics Total Petroleum Hydrocarbons

Client:	Blagg / BP	Project #:	94034-010
Sample ID:	LF-1	Date Reported:	02-27-02
Laboratory Number:	22104	Date Sampled:	02-26-02
Chain of Custody No:	9729	Date Received:	02-27-02
Sample Matrix:	Soil	Date Extracted:	02-27-02
Preservative:	Cool	Date Analyzed:	02-27-02
Condition:	Cool and Intact	Analysis Requested:	8015 TPH

Parameter	Concentration (mg/Kg)	Det. Limit (mg/Kg)
Gasoline Range (C5 - C10)	7.1	0.2
Diesel Range (C10 - C28)	2,170	0.1
Total Petroleum Hydrocarbons	2,180	0.2

ND - Parameter not detected at the stated detection limit.

References: Method 8015B, Nonhalogenated Volatile Organics, Test Methods for Evaluating Solid Waste, SW-846, USEPA, December 1996.

Comments: Pritchard #5 Landfarm 5 Pt. Composite.

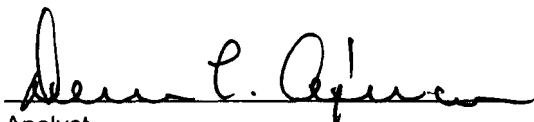
  
Analyst

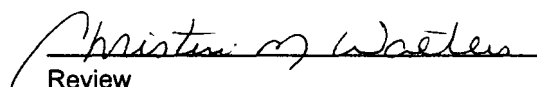
  
Review