

District I
1625 N. French Dr., Hobbs, NM 88240
District II
1301 W. Grand Avenue, Artesia, NM 88210
District III
1000 Rio Brazos Road, Aztec, NM 87410
District IV
1220 S. St. Francis Dr., Santa Fe, NM 87505

State of New Mexico
Energy Minerals and Natural Resources

Form C-144
June 1, 2004

Oil Conservation Division
1220 South St. Francis Dr.
Santa Fe, NM 87505

For drilling and production facilities, submit to appropriate NMOCD District Office.
For downstream facilities, submit to Santa Fe office

Pit or Below-Grade Tank Registration or Closure

Is pit or below-grade tank covered by a "general plan"? Yes ☒ No ☐

Type of action: Registration of a pit or below-grade tank ☐ Closure of a pit or below-grade tank ☒

Operator: <u>Burlington Resources</u> Telephone: <u>(505) 326-9841</u> e-mail address: <u>LHasely@br-inc.com</u>		
Address: <u>3401 East 30th Street, Farmington, New Mexico, 87402</u>		
Facility or well name: <u>Huerfano Unit 122</u>	API #: <u>30045206130000</u>	U/L or Qtr/Qtr <u>P</u> Sec <u>10</u> T <u>26N</u> R <u>10W</u>
County: <u>San Juan</u>	Latitude <u>N36d 29.904'</u>	Longitude <u>W107d 52.659'</u> NAD: 1927 <input checked="" type="checkbox"/> 1983 <input type="checkbox"/>
Surface Owner: Federal <input checked="" type="checkbox"/> State <input type="checkbox"/> Private <input type="checkbox"/> Indian <input type="checkbox"/>		
Pit Type: Drilling <input type="checkbox"/> Production <input type="checkbox"/> Disposal <input type="checkbox"/> Workover <input type="checkbox"/> Emergency <input type="checkbox"/> Lined <input type="checkbox"/> Unlined <input type="checkbox"/> Liner type: Synthetic <input type="checkbox"/> Thickness <u> </u> mil Clay <input type="checkbox"/> Pit Volume <u> </u> bbl	Below-grade tank Volume: <u>60</u> bbl Type of fluid: <u>Produced Water and Incidental Oil</u> Construction material: <u>Fiberglass</u> Double-walled, with leak detection? Yes <input type="checkbox"/> If not, explain why not. <u>No - in place prior to Rule 50</u>	
Depth to ground water (vertical distance from bottom of pit to seasonal high water elevation of ground water.)	Less than 50 feet	(20 points)
	50 feet or more, but less than 100 feet	(10 points)
	100 feet or more	(0 points) 0
Wellhead protection area: (Less than 200 feet from a private domestic water source, or less than 1000 feet from all other water sources.)	Yes	(20 points)
	No	(0 points) 0
Distance to surface water: (horizontal distance to all wetlands, playas, irrigation canals, ditches, and perennial and ephemeral watercourses.)	Less than 200 feet	(20 points)
	200 feet or more, but less than 1000 feet	(10 points)
	1000 feet or more	(0 points) 0
Ranking Score (Total Points)		0

If this is a pit closure: (1) Attach a diagram of the facility showing the pit's relationship to other equipment and tanks. (2) Indicate disposal location: (check the onsite box if you are burying in place) onsite ☐ offsite ☒ If offsite, name of facility Envirotech Landfarm # 2. (3) Attach a general description of remedial action taken including remediation start date and end date. (4) Groundwater encountered: No ☒ Yes ☐ If yes, show depth below ground surface ft. and attach sample results. (5) Attach soil sample results and a diagram of sample locations and excavations.

Additional Comments:

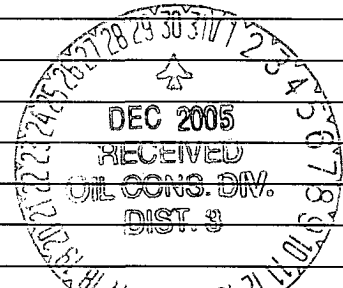

I hereby certify that the information above is true and complete to the best of my knowledge and belief. I further certify that the above-described pit or below-grade tank has been/will be constructed or closed according to NMOCD guidelines ☒, a general permit ☐, or an (attached) alternative OCD-approved plan ☐.

Date: 12/28/05

Printed Name/Title Mr. Ed Hasely, Environmental Advisor

Signature [Signature]

Your certification and NMOCD approval of this application/closure does not relieve the operator of liability should the contents of the pit or tank contaminate ground water or otherwise endanger public health or the environment. Nor does it relieve the operator of its responsibility for compliance with any other federal, state, or local laws and/or regulations.

Approval: [Signature]
DEPUTY OIL & GAS INSPECTOR, DIST. 3
Printed Name/Title Wendy Kaul

Date: DEC 30 2005

CLIENT: <u>Burlington Resources</u>	ENVIROTECH INC. <small>ENVIRONMENTAL SCIENTISTS & ENGINEERS 5796 U.S. HIGHWAY 64-3014 FARMINGTON, NEW MEXICO 87401 PHONE: (505) 632-0815</small>	LOCATION NO: _____ C.D.C. NO: _____
-------------------------------------	---	--

FIELD REPORT: CLOSURE VERIFICATION	PAGE No: <u>1</u> of <u>1</u>
---	-------------------------------

LOCATION: NAME: <u>Huerfano Unit</u> WELL #: <u>122</u> PIT: _____ QUAD/UNIT: <u>P</u> SEC: <u>10</u> TWP: <u>26N</u> RNG: <u>10W</u> PM: <u>NMM</u> CNTY: <u>SS</u> ST: <u>NM</u> QTR/FOOTAGE: <u>990' S</u> <u>990' E</u> CONTRACTOR: <u>M&M</u>	DATE STARTED: <u>11/22/05</u> DATE FINISHED: <u>11/28/05</u> ENVIRONMENTAL SPECIALIST: <u>MPM</u>
--	---

EXCAVATION APPROX. <u>50</u> FT. x <u>45</u> FT. x <u>18</u> FT. DEEP.	CUBIC YARDAGE: <u>1,340</u> 1500 yd ³
DISPOSAL FACILITY: <u>Envirotech LF</u> REMEDIATION METHOD: <u>Landfarm</u>	
LAND USE: _____ LEASE: <u>SF 079658</u> FORMATION: _____	

FIELD NOTES & REMARKS:	PIT LOCATED APPROXIMATELY <u>80'</u> FT. <u>345°</u> FROM WELLHEAD. DEPTH TO GROUNDWATER: <u>0</u> NEAREST WATER SOURCE: <u>0</u> NEAREST SURFACE WATER: <u>0</u> NMCD RANKING SCORE: <u>0</u> NMCD TPH CLOSURE STD: <u>5000</u> PPM
SOIL AND EXCAVATION DESCRIPTION:	

CHECK ONE :
☐ PIT ABANDONED
☒ STEEL TANK INSTALLED

M&M has completed excavation. New steel reserve tank was placed prior to M&M's excavation. Unknown location of removed fiberglass BGT, azimuth & distance from wellhead to approximate center of excavation.

FIELD 418.1 CALCULATIONS

TIME	SAMPLE I.D.	LAB No:	WEIGHT (g)	mL. FREON	DILUTION	READING	CALC. ppm
	<u>SEE</u>	<u>412.1</u>	<u>Analysis Log</u>				

SCALE



PIT PERIMETER

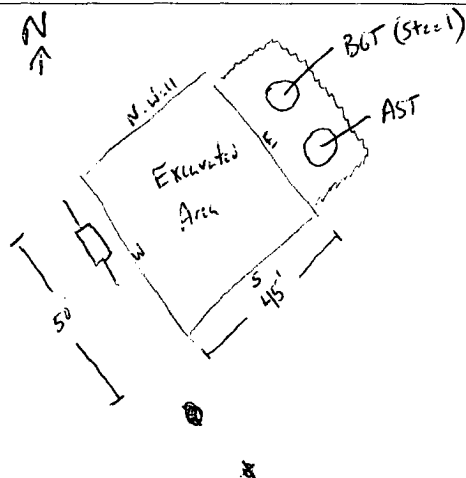

OVM RESULTS

SAMPLE ID	FIELD HEADSPACE PID (ppm)
1 <u>Benton</u>	<u>1</u>
2 <u>N. Well</u>	<u>0</u>
3 <u>E. Well</u>	<u>0</u>
4 <u>S. Well</u>	<u>4</u>
5 <u>W. Well</u>	<u>2</u>

SAMPLE ID	ANALYSIS	TIME

PIT PROFILE

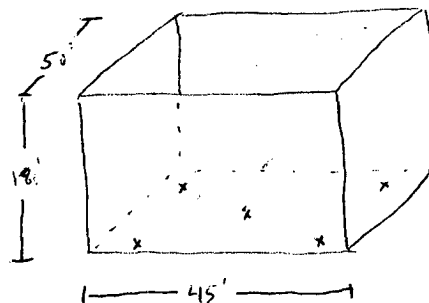

x: Bottom composite

Note: Each well analysed separately by composite sample.

TRAVEL NOTES:	CALLOUT: _____	ONSITE: _____
---------------	----------------	---------------

ENVIROTECH INC.

PRACTICAL SOLUTIONS FOR A BETTER TOMORROW

Method 418.1 Analysis Log Total Petroleum Hydrocarbons

Date 11/28/05

Analyst M. Marquez

Location Huerfano Unit 122

Instrument Foxboro

Job No. 92115-044

Sample No.	Sample Description	Sample Wt. (g)	Volume Freon (mL)	Dilution Factor	Abs. Reading	TPH (mg/kg)
1	Bottom c 18'	5	20	1	0.087	604
2	N. Wall	5	20	1	0.0046	31.9
3	E. Wall	5	20	1	0.0062	43.0
4	S. Wall	5	20	1	0.0096	66.6
5	W. Wall	5	20	1	0.0048	33.3

Infrared Spectrophotometer Calibration

New Freon _____

Date Standards Prepared _____

Standard Concentration (mg/L) Absorbance

100 _____

200 0.126

500 _____

1000 _____

I-CAL RF: 1735

C-CAL RF: _____

RSD: _____ %

% Difference: _____ %

QA/QC Acceptance Criteria: I-CAL RSD +/- 20%

C-Cal Difference +/- 10%

**EPA METHOD 418.1
TOTAL PETROLEUM
HYDROCARBONS**

Client: Burlington Resources
Sample No.: 1
Sample ID: Bottom @ 18' depth
Sample Matrix: Soil
Preservative: Cool
Condition: Cool and Intact

Project #: 92115-044
Date Reported: 11/28/2005
Date Sampled: 11/28/2005
Date Analyzed: 11/28/2005
Analysis Needed: TPH-418.1

Parameter	Concentration (mg/kg)	Det. Limit (mg/kg)
-----------	--------------------------	--------------------------

Total Petroleum Hydrocarbons

604

5.0

ND = Parameter not detected at the stated detection limit.

References: Method 418.1, Petroleum Hydrocarbons, Total Recoverable, Chemical Analysis of Water and Waste, USEPA Storet No. 4551, 1978.

Comments: **Huerfano Unit 122**

Analyst

Review

**EPA METHOD 418.1
TOTAL PETROLEUM
HYDROCARBONS**

Client:	Burlington Resources	Project #:	92115-044
Sample No.:	2	Date Reported:	11/28/2005
Sample ID:	N. Wall Composite	Date Sampled:	11/28/2005
Sample Matrix:	Soil	Date Analyzed:	11/28/2005
Preservative:	Cool	Analysis Needed:	TPH-418.1
Condition:	Cool and Intact		

Parameter	Concentration (mg/kg)	Det. Limit (mg/kg)
-----------	--------------------------	--------------------------

Total Petroleum Hydrocarbons	31.9	5.0
-------------------------------------	-------------	------------

ND = Parameter not detected at the stated detection limit.

References: Method 418.1, Petroleum Hydrocarbons, Total Recoverable, Chemical Analysis of Water and Waste, USEPA Storet No. 4551, 1978.

Comments: **Huerfano Unit 122**

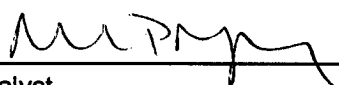

Analyst

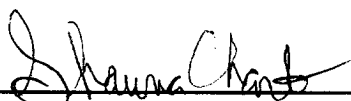

Review

**EPA METHOD 418.1
TOTAL PETROLEUM
HYDROCARBONS**

Client:	Burlington Resources	Project #:	92115-044
Sample No.:	3	Date Reported:	11/28/2005
Sample ID:	E. Wall Composite	Date Sampled:	11/28/2005
Sample Matrix:	Soil	Date Analyzed:	11/28/2005
Preservative:	Cool	Analysis Needed:	TPH-418.1
Condition:	Cool and Intact		

Parameter	Concentration (mg/kg)	Det. Limit (mg/kg)
-----------	--------------------------	--------------------------

Total Petroleum Hydrocarbons	43.0	5.0
-------------------------------------	-------------	------------

ND = Parameter not detected at the stated detection limit.

References: Method 418.1, Petroleum Hydrocarbons, Total Recoverable, Chemical Analysis of Water and Waste, USEPA Storet No. 4551, 1978.

Comments: **Huerfano Unit 122**



Analyst



Review

**EPA METHOD 418.1
TOTAL PETROLEUM
HYDROCARBONS**

Client: Burlington Resources
Sample No.: 4
Sample ID: S. Wall Composite
Sample Matrix: Soil
Preservative: Cool
Condition: Cool and Intact

Project #: 92115-044
Date Reported: 11/28/2005
Date Sampled: 11/28/2005
Date Analyzed: 11/28/2005
Analysis Needed: TPH-418.1

Parameter	Concentration (mg/kg)	Det. Limit (mg/kg)
Total Petroleum Hydrocarbons	66.6	5.0

ND = Parameter not detected at the stated detection limit.

References: Method 418.1, Petroleum Hydrocarbons, Total Recoverable, Chemical Analysis of Water and Waste, USEPA Storet No. 4551, 1978.

Comments: **Huerfano Unit 122**

Analyst

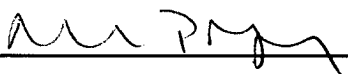

Review

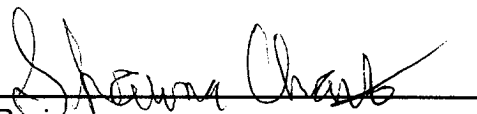

**EPA METHOD 418.1
TOTAL PETROLEUM
HYDROCARBONS**

Client:	Burlington Resources	Project #:	92115-044
Sample No.:	5	Date Reported:	11/28/2005
Sample ID:	W. Wall Composite	Date Sampled:	11/28/2005
Sample Matrix:	Soil	Date Analyzed:	11/28/2005
Preservative:	Cool	Analysis Needed:	TPH-418.1
Condition:	Cool and Intact		

Parameter	Concentration (mg/kg)	Det. Limit (mg/kg)
-----------	--------------------------	--------------------------

Total Petroleum Hydrocarbons	33.3	5.0
-------------------------------------	-------------	------------

ND = Parameter not detected at the stated detection limit.

References: Method 418.1, Petroleum Hydrocarbons, Total Recoverable, Chemical Analysis of Water and Waste, USEPA Storet No. 4551, 1978.

Comments: **Huerfano Unit 122**



Analyst



Review