

District I

1625 N. French Dr., Hobbs, NM 88240

District II

1301 W. Grand Ave., Artesia, NM 88210

District III

1000 Rio Brazos Rd., Aztec, NM 87410

District IV

1220 S. St. Francis Dr., Santa Fe, NM 87505

Energy, Minerals and Natural Resources

OIL CONSERVATION DIVISION

1220 South St. Francis Dr.

Santa Fe, NM 87505

WELL API NO.	30-045- 33580
5. Indicate Type of Lease	STATE <input type="checkbox"/> FEE <input checked="" type="checkbox"/>
6. State Oil & Gas Lease No.	
7. Lease Name or Unit Agreement Name	McGrath
8. Well Number	#3S
9. OGRID Number	14538
10. Pool name or Wildcat	Basin Fruitland Coal

SUNDRY NOTICES AND REPORTS ON WELLS
(DO NOT USE THIS FORM FOR PROPOSALS TO DRILL OR TO DEEPEN OR PLUG BACK TO A DIFFERENT RESERVOIR. USE "APPLICATION FOR PERMIT" (FORM C-101) FOR SUCH PROPOSALS.)

1. Type of Well:
Oil Well ☐ Gas Well ☒ Other

2. Name of Operator
BURLINGTON RESOURCES OIL & GAS COMPANY LP

3. Address of Operator
3401 E. 30TH STREET, FARMINGTON, NM 87402

4. Well Location
Unit Letter B : 660 feet from the North line and 1500 feet from the East line
Section 3 Township 29N Range 12W NMPM County San Juan

11. Elevation (Show whether DR, RKB, RT, GR, etc.)
5839'

Pit or Below-grade Tank Application ☐ or Closure ☐

Pit type New Drill Depth to Groundwater >100' Distance from nearest fresh water well >1000' Distance from nearest surface water >1000'
Pit Liner Thickness: 12 mil Below-Grade Tank: Volume bbls; Construction Material

12. Check Appropriate Box to Indicate Nature of Notice, Report or Other Data

NOTICE OF INTENTION TO:

PERFORM REMEDIAL WORK ☐ PLUG AND ABANDON ☐
TEMPORARILY ABANDON ☐ CHANGE PLANS ☐
PULL OR ALTER CASING ☐ MULTIPLE COMPL ☐

OTHER: New Drill ☒

SUBSEQUENT REPORT OF:

REMEDIAL WORK ☐ ALTERING CASING ☐
COMMENCE DRILLING OPNS. ☐ P AND A ☐
CASING/CEMENT JOB ☐

OTHER: ☐

13. Describe proposed or completed operations. (Clearly state all pertinent details, and give pertinent dates, including estimated date of starting any proposed work). SEE RULE 1103. For Multiple Completions: Attach wellbore diagram of proposed completion or recompletion.

New Drill, Lined:

Burlington Resources proposes to construct a new drilling pit and an associated vent/flare pit. Based on Burlington's interpretation of the Ecosphere's risk ranking criteria, the new drilling pit will be a lined pit as detailed in Burlington's Revised Drilling / Workover Pit Construction / Operation Procedures dated November 11, 2004 on file at the NMOCD office. A portion of the vent/flare pit will be designed to manage fluids and that portion will be lined as per the risk ranking criteria. Burlington Resources anticipates closing these pits according to the Drilling / Workover Pit Closure Procedure dated August 2, 2004 on file at the NMOCD office

I hereby certify that the information above is true and complete to the best of my knowledge and belief. I further certify that any pit or below-grade tank has been/will be constructed or closed according to NMOCD guidelines ☐, a general permit ☒ or an (attached) alternative OCD-approved plan ☐.

SIGNATURE Amanda Sandoval TITLE Regulatory Assistant III DATE 2/8/2006

Type or print name Amanda Sandoval E-mail address: asandoval@br-inc.com Telephone No. 505-326-9891

For State Use Only

APPROVED BY Denny Fent TITLE DEPUTY OIL & GAS INSPECTOR, DIST. III DATE FEB 16 2006
Conditions of Approval (if any):

BURLINGTON RESOURCES OIL & GAS COMPANY McGRATH #3S
660' FNL & 1500' FEL, SECTION 3, T29N, R12W, NMPM, SAN JUAN COUNTY, NM
GROUND ELEVATION: 5839' DATE: JANUARY 11, 2006

205' X 240' 305' X 340' = 2.38 ACRES

LATITUDE: 36.76057° N
LONGITUDE: 108.08179° W
 DATUM: NAD1983

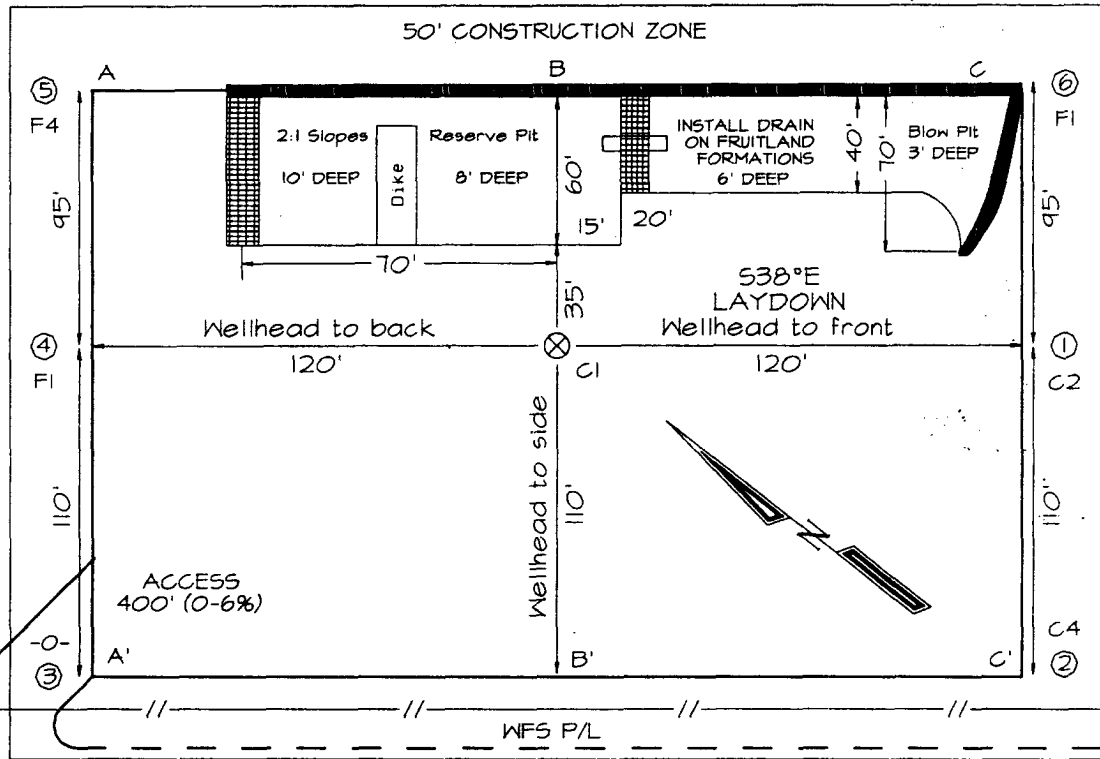

TWO-TRACK ROADWAY

Reserve Pit Dike: to be 8' above Deep side (overflow - 3' wide and 1' above shallow side).
 Blow Pit: overflow pipe halfway between top and bottom and to extend over plastic liner and into blow pit.

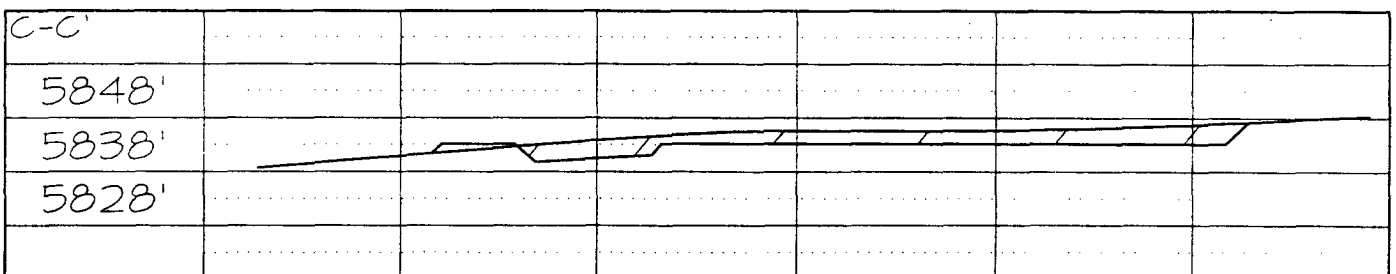
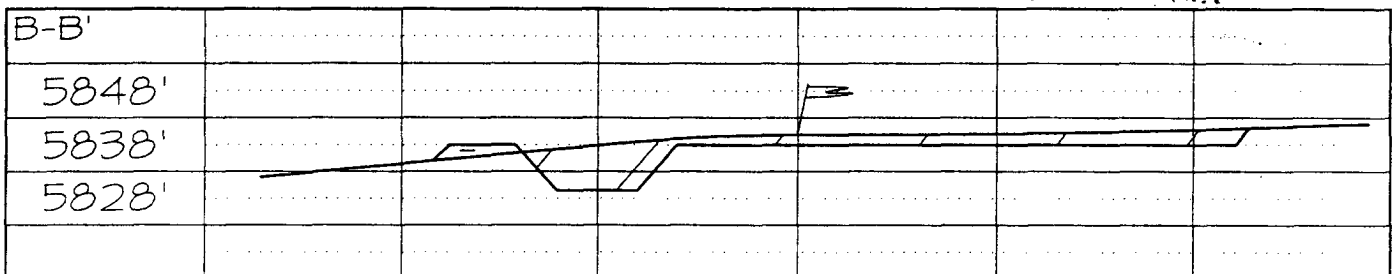
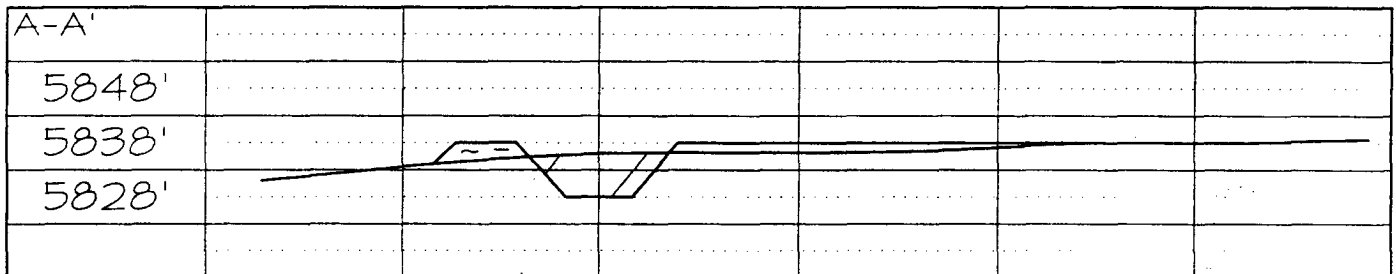

Note: Contractor should call One-Call for location of any marked or unmarked buried pipelines or cables on well pad and/or access road at least two (2) working days prior to construction