

District I
1625 N. French Dr., Hobbs, NM 88240
District II
1301 W. Grand Avenue, Artesia, NM 88210
District III
1000 Rio Brazos Road, Aztec, NM 87410
District IV
1220 S. St. Francis Dr., Santa Fe, NM 87505

State of New Mexico
Energy Minerals and Natural Resources

Form C-144
June 1, 2004

Oil Conservation Division
1220 South St. Francis Dr.
Santa Fe, NM 87505

For drilling and production facilities, submit to appropriate NMOCD District Office.
For downstream facilities, submit to Santa Fe office

Pit or Below-Grade Tank Registration or Closure

Is pit or below-grade tank covered by a "general plan"? Yes ☒ No ☐

WFS CLOSURE Type of action: Registration of a pit or below-grade tank ☐ Closure of a pit or below-grade tank ☒

Operator: BURLINGTON RESOURCES OIL & GAS CO Telephone: _____ e-mail address: _____
Address: 801 CHERRY ST FORT WORTH, TX 76102
Facility or well name: CRANDELL #002 API #: 30-045-05898 U/L or Qtr/Qtr P SEC 19 T 31N R 10W
County: SAN JUAN Latitude 36.88812 Longitude -107.92618 NAD: 1927 ☒ 1983 ☐
Surface Owner: Federal ☒ State ☐ Private ☐ Indian ☐

Pit

Type: Drilling ☐ Production ☒ Disposal ☐

Workover ☐ Emergency ☐

Lined ☐ Unlined ☒

Liner Type: Synthetic ☒ Thickness _____ mil Clay ☐

Pit Volume 120 bbl

Below-grade tank

Volume: _____ bbl Type of fluid: _____

Construction Material: _____

Double-walled, with leak detection? Yes ☒

If not, explain why not: _____

FEB 2006
OIL & GAS DIV.
DIST. 3

Depth to ground water (vertical distance from bottom of pit to seasonal high water elevation of ground water.)

Less than 50 feet
50 feet or more, but less than 100 feet
100 feet or more

(20 points)
(10 points) 0
(0 points)

Wellhead protection area: (Less than 200 feet from a private domestic water source, or less than 1000 feet from all other water sources.)

Yes
No

(20 points)
(0 points) 0

Distance to surface water: (Horizontal distance to all wetlands, playas, irrigation canals, ditches, and perennial and ephemeral watercourses.)

Less than 200 feet
200 feet to 1,000 feet
Greater than 1,000 feet

(20 points)
(10 points) 0
(0 points)

Ranking Score (TOTAL POINTS):

0

If this is a pit closure: (1) Attach a diagram of the facility showing the pit's relationship to other equipment and tanks. (2) Indicate disposal location: (check the onsite box if you are burying in place) onsite ☒ offsite ☐ If offsite, name of facility: _____. (3) Attach a general description of remedial action taken including remediation start date and end date. (4) Groundwater encountered: No ☒ Yes ☐ If yes, show depth below ground surface _____ ft. and attach sample results. (5) Attach soil sample results and a diagram of sample locations and excavations.

Additional Comments:

Meter: 34451

Outside VA

I hereby certify that the information above is true and complete to the best of my knowledge and belief. I further certify that the above-described pit or below-grade tank has been/will be constructed or closed according to NMOCD guidelines ☐, a general permit ☐, or an (attached) alternative OCD-approved plan ☒

Date: 10/3/05

Printed Name/Title Mark Harvey for Williams Field Services Signature Mark Harvey, for WFS

Your certification and NMOCD approval of this application/closure does not relieve the operator of liability should the contents of the pit or tank contaminate ground water or otherwise endanger public health or the environment. Nor does it relieve the operator of its responsibility for compliance with any other federal, state, or local laws and/or regulations.

Approval:

Printed Name/Title DEPUTY OIL & GAS INSPECTOR, DIST. 3

Signature Denny Feist

FEB 02 2006

Date: _____

ADDENDUM TO OCD FORM C-144

Operator: BURLINGTON RESOURCES OIL & GAS COMPANY LP

API 30-045-05898

Well Name: CRANDELL #002

Meter: 34451

Facility Diagram:

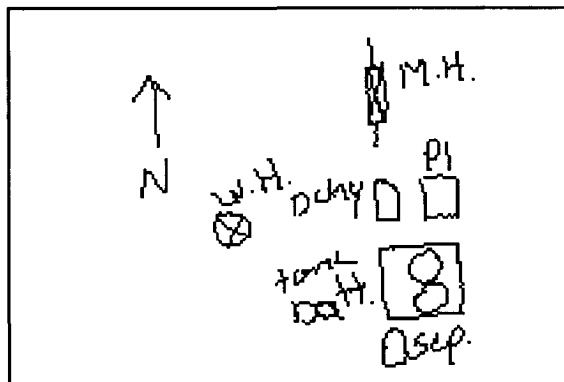

Sampling Diagram:

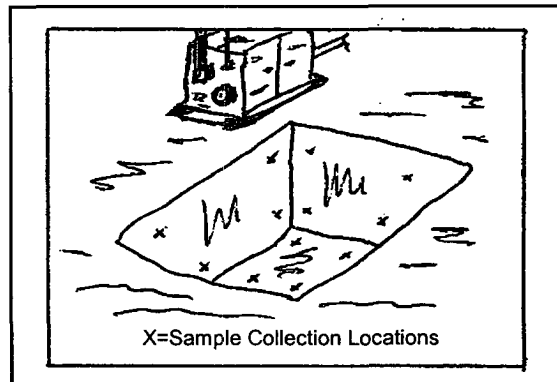

Pit Dimensions

Length 15 Ft.
Width 15 Ft.
Depth 3 Ft.

Location of Pit Center

Latitude 36.88817
Longitude -107.92579
(NAD 1927)

Pit ID

344511

Pit Type

Glycol Dehydrator

Date Closure Started: 6/14/05

Date Closure Completed: 6/14/05

Closure Method: Excavated, Blended, Treated Soil Returned

Bedrock Encountered ? ☐

Cubic Yards Excavated: 8

Vertical Extent of Equipment Reached ? ☒

Description Of Closure Action:

Contaminated soil was removed and treated then returned to the excavation following sampling of the walls and floor.

Pit Closure Sampling:

| Sample ID | Sample Date | Head Space | BTEX Total (mg/kg) | Benzene (mg/kg) | TPH DRO (mg/kg) | Purpose | Location | Depth | |
|-------------|-------------|------------|--------------------|-----------------|-----------------|------------|----------|-------|-------------------|
| 091514JUN05 | 6/14/05 | 107 | 850 | 13 | 3900 | EX Confirm | Walls | 10 | See Risk Analysis |
| 092314JUN05 | 6/14/05 | 167 | 888 | 15 | 1300 | EX Confirm | Flr | 12 | See Risk Analysis |

Lab Project Number: 6096735
Client Project ID: N. MEX PITS SPRING 2005

Lab Sample No: 608302360 Project Sample Number: 6096735-003 Date Collected: 06/14/05 09:15
Client Sample ID: 091514JUN05 Matrix: Soil Date Received: 06/25/05 08:15

| Parameters | Results | Units | Report Limit | DF | Analyzed | By | CAS No. | Qual | RegLmt |
|------------|---------|-------|--------------|----|----------|----|---------|------|--------|
|------------|---------|-------|--------------|----|----------|----|---------|------|--------|

GC Semivolatiles

Total Extractable Hydrocarbons Prep/Method: OA2 / OA2

| | | | | | | | | | |
|------------------------------|----------|-------|-----|-----|----------------|------|------------|---|--|
| Mineral Spirits | ND | mg/kg | 12. | 1.2 | 06/28/05 18:15 | RMN1 | | | |
| Jet Fuel | ND | mg/kg | 12. | 1.2 | 06/28/05 18:15 | RMN1 | | | |
| Kerosene | ND | mg/kg | 12. | 1.2 | 06/28/05 18:15 | RMN1 | | | |
| Diesel Fuel | ND | mg/kg | 12. | 1.2 | 06/28/05 18:15 | RMN1 | 68334-30-5 | | |
| Fuel Oil | ND | mg/kg | 12. | 1.2 | 06/28/05 18:15 | RMN1 | 68334-30-5 | | |
| Motor Oil | ND | mg/kg | 12. | 1.2 | 06/28/05 18:15 | RMN1 | | | |
| Total Petroleum Hydrocarbons | 3900 | mg/kg | 12. | 1.2 | 06/28/05 18:15 | RMN1 | | 3 | |
| n-Tetracosane (S) | 107 | % | | 1.0 | 06/28/05 18:15 | RMN1 | 646-31-1 | | |
| p-Terphenyl (S) | 85 | % | | 1.0 | 06/28/05 18:15 | RMN1 | 92-94-4 | | |
| Date Extracted | 06/28/05 | | | | 06/28/05 | | | | |

Organics Prep

| | | | | | | | | | |
|------------------|------------------|---|--|-----|----------|------|--|--|--|
| Percent Moisture | Method: SM 2540G | | | | | | | | |
| Percent Moisture | 15.1 | % | | 1.0 | 06/27/05 | ALJ1 | | | |

GC Volatiles

Aromatic Volatile Organics Prep/Method: EPA 5030 Medium Soil / EPA 8021

| | | | | | | | | | |
|----------------------------|--------|-------|-------|-----|----------------|-----|-----------|--|--|
| Benzene | 13000 | ug/kg | 5400 | 107 | 06/29/05 22:53 | SHF | 71-43-2 | | |
| Ethylbenzene | 17000 | ug/kg | 5400 | 107 | 06/29/05 22:53 | SHF | 100-41-4 | | |
| Toluene | 170000 | ug/kg | 5400 | 107 | 06/29/05 22:53 | SHF | 108-88-3 | | |
| Xylene (Total) | 650000 | ug/kg | 14000 | 107 | 06/29/05 22:53 | SHF | 1330-20-7 | | |
| a,a,a-Trifluorotoluene (S) | 95 | % | | 1.0 | 06/29/05 22:53 | SHF | 98-08-8 | | |

REPORT OF LABORATORY ANALYSIS

This report shall not be reproduced, except in full,
without the written consent of Pace Analytical Services, Inc.

Lab Project Number: 6096735
Client Project ID: N. MEX PITS SPRING 2005

Lab Sample No: 608302386 Project Sample Number: 6096735-004 Date Collected: 06/14/05 09:23
Client Sample ID: 092314JUN05 Matrix: Soil Date Received: 06/25/05 08:15

| Parameters | Results | Units | Report Limit | DF | Analyzed | By | CAS No. | Qual | RegLmt |
|------------|---------|-------|--------------|----|----------|----|---------|------|--------|
|------------|---------|-------|--------------|----|----------|----|---------|------|--------|

GC Semivolatiles

| | | | | | | | | | |
|--------------------------------|------------------------|-------|-----|-----|----------------|------|------------|---|--|
| Total Extractable Hydrocarbons | Prep/Method: OA2 / OA2 | | | | | | | | |
| Mineral Spirits | ND | mg/kg | 11. | 1.1 | 06/28/05 18:35 | RMN1 | | | |
| Jet Fuel | ND | mg/kg | 11. | 1.1 | 06/28/05 18:35 | RMN1 | | | |
| Kerosene | ND | mg/kg | 11. | 1.1 | 06/28/05 18:35 | RMN1 | | | |
| Diesel Fuel | ND | mg/kg | 11. | 1.1 | 06/28/05 18:35 | RMN1 | 68334-30-5 | | |
| Fuel Oil | ND | mg/kg | 11. | 1.1 | 06/28/05 18:35 | RMN1 | 68334-30-5 | | |
| Motor Oil | ND | mg/kg | 11. | 1.1 | 06/28/05 18:35 | RMN1 | | | |
| Total Petroleum Hydrocarbons | 1300 | mg/kg | 11. | 1.1 | 06/28/05 18:35 | RMN1 | | 3 | |
| n-Tetracosane (S) | 116 | % | | 1.0 | 06/28/05 18:35 | RMN1 | 646-31-1 | | |
| p-Terphenyl (S) | 111 | % | | 1.0 | 06/28/05 18:35 | RMN1 | 92-94-4 | | |
| Date Extracted | 06/28/05 | | | | 06/28/05 | | | | |

Organics Prep

| | | | | | | | | | |
|------------------|------------------|---|--|-----|----------|------|--|--|--|
| Percent Moisture | Method: SM 2540G | | | | | | | | |
| Percent Moisture | 11.1 | % | | 1.0 | 06/27/05 | ALJ1 | | | |

GC Volatiles

| | | | | | | | | | |
|----------------------------|--|-------|------|------|----------------|-----|-----------|--|--|
| Aromatic Volatile Organics | Prep/Method: EPA 5030 Medium Soil / EPA 8021 | | | | | | | | |
| Benzene | 15000 | ug/kg | 2700 | 54.1 | 06/29/05 12:36 | SHF | 71-43-2 | | |
| Ethylbenzene | 53000 | ug/kg | 2700 | 54.1 | 06/29/05 12:36 | SHF | 100-41-4 | | |
| Toluene | 290000 | ug/kg | 2700 | 54.1 | 06/29/05 12:36 | SHF | 108-88-3 | | |
| Xylene (Total) | 530000 | ug/kg | 7000 | 54.1 | 06/29/05 12:36 | SHF | 1330-20-7 | | |
| a,a,a-Trifluorotoluene (S) | 95 | % | | 1.0 | 06/29/05 12:36 | SHF | 98-08-8 | | |

REPORT OF LABORATORY ANALYSIS

This report shall not be reproduced, except in full,
without the written consent of Pace Analytical Services, Inc.