

District I  
1625 N. French Dr., Hobbs, NM 88240  
District II  
1301 W. Grand Avenue, Artesia, NM 88210  
District III  
1000 Rio Brazos Road, Aztec, NM 87410  
District IV  
1220 S. St. Francis Dr., Santa Fe, NM 87505

State of New Mexico  
Energy Minerals and Natural Resources

Form C-144  
June 1, 2004

Oil Conservation Division  
1220 South St. Francis Dr.  
Santa Fe, NM 87505

For drilling and production facilities, submit to  
appropriate NMOCD District Office.  
For downstream facilities, submit to Santa Fe  
office

**Pit or Below-Grade Tank Registration or Closure**

Is pit or below-grade tank covered by a "general plan"? Yes ☒ No ☐

WFS CLOSURE Type of action: Registration of a pit or below-grade tank ☐ Closure of a pit or below-grade tank ☒

Operator: BP AMERICA PRODUCTION COMPANY

Telephone:

e-mail address:

Address: PO BOX 22048 TULSA, OK 74121

Facility or well name: FLORANCE #001A

API #: 30-045-22350

U/L or Qtr/Qtr P SEC 35 T 29N R 9W

County: SAN JUAN

Latitude 36 40.658 N

Longitude 107 44.803 W

NAD: 1927 ☒ 1983 ☐

Surface Owner: Federal ☒ State ☐ Private ☐ Indian ☐

**Pit**

Type: Drilling ☐ Production ☒ Disposal ☐

Workover ☐ Emergency ☐

Lined ☐ Unlined ☒

Liner Type: Synthetic ☒ Thickness \_\_\_\_\_ mil Clay ☐

Pit Volume 80 bbl

**Below-grade tank**

Volume: \_\_\_\_\_ bbl Type of fluid: \_\_\_\_\_

Construction Material: \_\_\_\_\_

Double-walled, with leak detection? Yes ☒ If not, explain why not.

Depth to ground water (vertical distance from bottom of pit to seasonal high water elevation of ground water.)

Less than 50 feet  
50 feet or more, but less than 100 feet  
100 feet or more

(20 points)  
(10 points)  
(0 points)

0

Wellhead protection area: (Less than 200 feet from a private domestic water source, or less than 1000 feet from all other water sources.)

Yes  
No

(20 points)  
(0 points)

0

Distance to surface water: (Horizontal distance to all wetlands, playas, irrigation canals, ditches, and perennial and ephemeral watercourses.)

Less than 200 feet  
200 feet to 1,000 feet  
Greater than 1,000 feet

(20 points)  
(10 points)  
(0 points)

0

**Ranking Score (TOTAL POINTS):**

0

**If this is a pit closure:** (1) Attach a diagram of the facility showing the pit's relationship to other equipment and tanks. (2) Indicate disposal location: (check the onsite box if you are burying in place) onsite ☒ offsite ☐ If offsite, name of facility \_\_\_\_\_. (3) Attach a general description of remedial action taken including remediation start date and end date. (4) Groundwater encountered: No ☒ Yes ☐ If yes, show depth below ground surface \_\_\_\_\_ ft. and attach sample results. (5) Attach soil sample results and a diagram of sample locations and excavations.

Additional Comments:

Meter: 34513

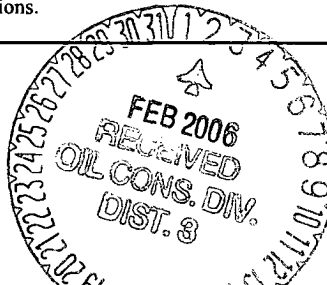

I hereby certify that the information above is true and complete to the best of my knowledge and belief. I further certify that the above-described pit or below-grade tank has been/will be constructed or closed according to NMOCD guidelines ☐, a general permit ☐, or an (attached) alternative OCD-approved plan ☒

Date: 10/3/05

Printed Name/Title Mark Harvey for Williams Field Services

Signature Mark Harvey FOR WFS

Your certification and NMOCD approval of this application/closure does not relieve the operator of liability should the contents of the pit or tank contaminate ground water or otherwise endanger public health or the environment. Nor does it relieve the operator of its responsibility for compliance with any other federal, state, or local laws and/or regulations.

Approval:

Printed Name/Title DEPUTY OIL & GAS INSPECTOR, DIST. 8

Signature [Signature]

Date: FEB 02 2006

# **ADDENDUM TO OCD FORM C-144**

**Operator:** BP AMERICA PRODUCTION COMPANY

**API** 30-045-22350

**Well Name:** FLORANCE #001A

**Meter:** 34513

**Facility Diagram:**

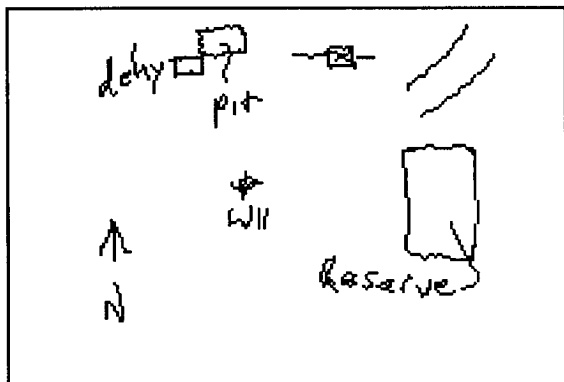

**Sampling Diagram:**

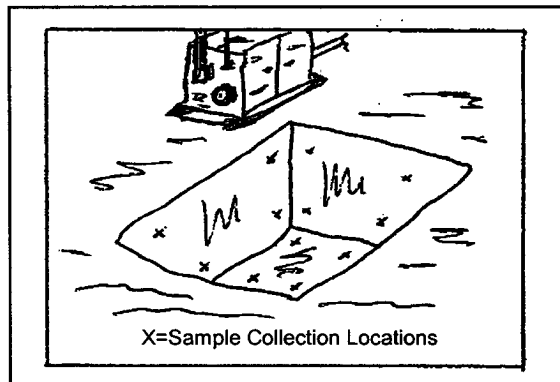

**Pit Dimensions**

Length 15 Ft.

Width 15 Ft.

Depth 2 Ft.

**Location of Pit Center**

Latitude 36 40.662 N

Longitude 07 44.817 W

(NAD 1927)

**Pit ID**

345131

**Pit Type**

Glycol Dehydrator

**Date Closure Started:** 3/21/05

**Date Closure Completed:** 3/21/05

**Closure Method:** Excavated, Blended, Treated Soil Returned

**Bedrock Encountered ?** ☐

**Cubic Yards Excavated:** 108

**Vertical Extent of Equipment Reached ?** ☒

**Description Of Closure Action:**

Contaminated soil was removed and treated then returned to the excavation following sampling of the walls and floor.

Vertical extent of excavation limited by equipment

**Pit Closure Sampling:**

Sample ID	Sample Date	Head Space	BTEX Total (mg/kg)	Benzene (mg/kg)	TPH DRO (mg/kg)	Purpose	Location	Depth
130118FEB05	2/18/05		64.2	0	190	ASSESS	Flr	3.5
144821MAR05	3/21/05	8			0	EX Confirm	Walls	9
145321MAR05	3/21/05	106	0	0	11	EX Confirm	Flr	12

See Risk Analysis

Lab Project Number: 6093428

Client Project ID: N. Mex. Pit Program

Lab Sample No: 608026092  
Client Sample ID: 144821MAR05

Project Sample Number: 6093428-004  
Matrix: Soil

Date Collected: 03/21/05 14:48  
Date Received: 04/01/05 09:00

Parameters	Results	Units	Report Limit	DF	Analyzed	By	CAS No.	Qual	RegLmt
<b>GC Semivolatiles</b>									
Total Extractable Hydrocarbons	Prep/Method: OA2 / OA2								
Mineral Spirits	ND	mg/kg	11.		1.1 04/06/05 16:51	RMN1			
Jet Fuel	ND	mg/kg	11.		1.1 04/06/05 16:51	RMN1			
Kerosene	ND	mg/kg	11.		1.1 04/06/05 16:51	RMN1			
Diesel Fuel	ND	mg/kg	11.		1.1 04/06/05 16:51	RMN1	68334-30-5		
Fuel Oil	ND	mg/kg	11.		1.1 04/06/05 16:51	RMN1	68334-30-5		
Motor Oil	ND	mg/kg	11.		1.1 04/06/05 16:51	RMN1			
n-Tetracosane (S)	94	%			1.0 04/06/05 16:51	RMN1	646-31-1		
p-Terphenyl (S)	99	%			1.0 04/06/05 16:51	RMN1	92-94-4		
Date Extracted	04/04/05				04/04/05				

#### Organics Prep

Percent Moisture	Method: SM 2540G								
Percent Moisture	11.4	%			1.0 04/05/05	ALJ1			

## REPORT OF LABORATORY ANALYSIS

This report shall not be reproduced, except in full,  
without the written consent of Pace Analytical Services, Inc.

Lab Project Number: 6093428  
Client Project ID: N. Mex. Pit Program

Lab Sample No: 608027017 Project Sample Number: 6093428-005 Date Collected: 03/21/05 14:53  
Client Sample ID: 145321MAR05 Matrix: Soil Date Received: 04/01/05 09:00

Parameters	Results	Units	Report Limit	DF	Analyzed	By	CAS No.	Qual	RegLmt
<b>GC Semivolatiles</b>									
Total Extractable Hydrocarbons	Prep/Method: OA2 / OA2								
Mineral Spirits	ND	mg/kg	10.	1.0	04/05/05 12:08	RMN1			
Jet Fuel	ND	mg/kg	10.	1.0	04/05/05 12:08	RMN1			
Kerosene	ND	mg/kg	10.	1.0	04/05/05 12:08	RMN1			
Diesel Fuel	ND	mg/kg	10.	1.0	04/05/05 12:08	RMN1	68334-30-5		
Fuel Oil	ND	mg/kg	10.	1.0	04/05/05 12:08	RMN1	68334-30-5		
Motor Oil	ND	mg/kg	10.	1.0	04/05/05 12:08	RMN1			
Total Petroleum Hydrocarbons	11.	mg/kg	10.	1.0	04/05/05 12:08	RMN1			3
n-Tetracosane (S)	69	%		1.0	04/05/05 12:08	RMN1	646-31-1		
p-Terphenyl (S)	71	%		1.0	04/05/05 12:08	RMN1	92-94-4		4
Date Extracted	04/04/05				04/04/05				

#### Organics Prep

Percent Moisture	Method: SM 2540G								
Percent Moisture	4.7	%		1.0	04/05/05	ALJ1			

#### GC/MS Volatiles

UST VOCs in Soil	Prep/Method: EPA 5030 Medium Soil / EPA 8260								
Benzene	ND	ug/kg	230	4.6	04/05/05 16:14	AEP	71-43-2		
Toluene	ND	ug/kg	230	4.6	04/05/05 16:14	AEP	108-88-3		
Ethylbenzene	ND	ug/kg	230	4.6	04/05/05 16:14	AEP	100-41-4		
Xylene (Total)	ND	ug/kg	700	4.6	04/05/05 16:14	AEP	1330-20-7		
Dibromofluoromethane (S)	97	%		1.0	04/05/05 16:14	AEP	1868-53-7		
1,2-Dichloroethane-d4 (S)	97	%		1.0	04/05/05 16:14	AEP	17060-07-0		
Toluene-d8 (S)	101	%		1.0	04/05/05 16:14	AEP	2037-26-5		
4-Bromofluorobenzene (S)	102	%		1.0	04/05/05 16:14	AEP	460-00-4		

Comments : Sample was diluted due to matrix for method 8260B. The sample did not contain any compounds of interest above the report limit.

## REPORT OF LABORATORY ANALYSIS

This report shall not be reproduced, except in full,  
without the written consent of Pace Analytical Services, Inc.

Lab Project Number: 6092681  
Client Project ID: NM Pits 02/18-03/04/2005

Lab Sample No: 607961489      Project Sample Number: 6092681-003      Date Collected: 02/18/05 13:01  
Client Sample ID: 130118FEB05      Matrix: Soil      Date Received: 03/10/05 09:00

Parameters	Results	Units	Report Limit	DF	Analyzed	By	CAS No.	Qual	ReqLmt
------------	---------	-------	--------------	----	----------	----	---------	------	--------

### GC Semivolatiles

Total Extractable Hydrocarbons Prep/Method: OA2 / OA2

Mineral Spirits	ND	mg/kg	12.	1.2	03/11/05 19:10	WAW			
Jet Fuel	ND	mg/kg	12.	1.2	03/11/05 19:10	WAW			
Kerosene	ND	mg/kg	12.	1.2	03/11/05 19:10	WAW			
Diesel Fuel	ND	mg/kg	12.	1.2	03/11/05 19:10	WAW	68334-30-5		
Fuel Oil	ND	mg/kg	12.	1.2	03/11/05 19:10	WAW	68334-30-5		
Motor Oil	ND	mg/kg	12.	1.2	03/11/05 19:10	WAW			
Total Petroleum Hydrocarbons	190	mg/kg	12.	1.2	03/11/05 19:10	WAW		1	
n-Tetracosane (S)	86	%		1.0	03/11/05 19:10	WAW	646-31-1		
p-Terphenyl (S)	94	%		1.0	03/11/05 19:10	WAW	92-94-4		
Date Extracted	03/10/05				03/10/05				

### Organics Prep

Percent Moisture Method: SM 2540G  
Percent Moisture 15.0 % 1.0 03/10/05 ALJ1

### GC/MS Volatiles

UST VOCs in Soil Prep/Method: EPA 5030 Medium Soil / EPA 8260

Benzene	ND	ug/kg	290	5.7	03/14/05 11:31	AEP	71-43-2		
Toluene	25000	ug/kg	290	5.7	03/14/05 11:31	AEP	108-88-3		
Ethylbenzene	3200	ug/kg	290	5.7	03/14/05 11:31	AEP	100-41-4		
Xylene (Total)	36000	ug/kg	860	5.7	03/14/05 11:31	AEP	1330-20-7		
Dibromofluoromethane (S)	101	%		1.0	03/14/05 11:31	AEP	1868-53-7		
1,2-Dichloroethane-d4 (S)	106	%		1.0	03/14/05 11:31	AEP	17060-07-0		
Toluene-d8 (S)	111	%		1.0	03/14/05 11:31	AEP	2037-26-5		
4-Bromofluorobenzene (S)	100	%		1.0	03/14/05 11:31	AEP	460-00-4		

## REPORT OF LABORATORY ANALYSIS

This report shall not be reproduced, except in full,  
without the written consent of Pace Analytical Services, Inc.