

District I
1625 N. French Dr., Hobbs, NM 88240
District II
1301 W. Grand Avenue, Artesia, NM 88210
District III
1000 Rio Brazos Road, Aztec, NM 87410
District IV
1220 S. St. Francis Dr., Santa Fe, NM 87505

State of New Mexico
Energy Minerals and Natural Resources

Form C-144
June 1, 2004

Oil Conservation Division
1220 South St. Francis Dr.
Santa Fe, NM 87505

For drilling and production facilities, submit to appropriate NMOCD District Office.
For downstream facilities, submit to Santa Fe office

Pit or Below-Grade Tank Registration or Closure

Is pit or below-grade tank covered by a "general plan"? Yes ☒ No ☐

WFS CLOSURE

Type of action: Registration of a pit or below-grade tank ☐ Closure of a pit or below-grade tank ☒

Operator: BURLINGTON RESOURCES OIL & GAS CO Telephone: _____ e-mail address: _____
Address: 801 CHERRY ST FORT WORTH, TX 76102
Facility or well name: DECKER #005 API #: 30-045-23351 U/L or Qtr/Qtr A SEC 26 T 32N R 12W
County: SAN JUAN Latitude 36 57.721 N Longitude 108 03.535 W NAD: 1927 ☒ 1983 ☐
Surface Owner: Federal ☐ State ☐ Private ☒ Indian ☐

Pit

Type: Drilling ☐ Production ☒ Disposal ☐

Workover ☐ Emergency ☐

Lined ☐ Unlined ☒

Liner Type: Synthetic ☒ Thickness _____ mil Clay ☐

Pit Volume 51 bbl

Below-grade tank

Volume: _____ bbl Type of fluid: _____

Construction Material: _____

Double-walled, with leak detection? Yes ☒ If not, explain why not.

Depth to ground water (vertical distance from bottom of pit to seasonal high water elevation of ground water.)

Less than 50 feet
50 feet or more, but less than 100 feet
100 feet or more

(20 points)
(10 points) 0
(0 points)

Wellhead protection area: (Less than 200 feet from a private domestic water source, or less than 1000 feet from all other water sources.)

Yes
No

(20 points)
(0 points) 0

Distance to surface water: (Horizontal distance to all wetlands, playas, irrigation canals, ditches, and perennial and ephemeral watercourses.)

Less than 200 feet
200 feet to 1,000 feet
Greater than 1,000 feet

(20 points)
(10 points) 0
(0 points)

Ranking Score (TOTAL POINTS):

0

If this is a pit closure: (1) Attach a diagram of the facility showing the pit's relationship to other equipment and tanks. (2) Indicate disposal location: (check the onsite box if you are burying in place) onsite ☒ offsite ☐ If offsite, name of facility _____. (3) Attach a general description of remedial action taken including remediation start date and end date. (4) Groundwater encountered: No ☒ Yes ☐ If yes, show depth below ground surface _____. ft. and attach sample results. (5) Attach soil sample results and a diagram of sample locations and excavations.

Additional Comments:

Bedrock

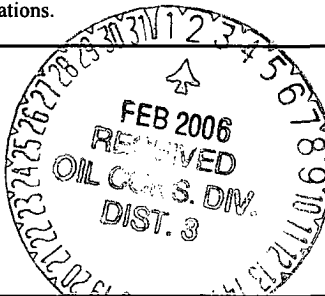

Meter: 34653

I hereby certify that the information above is true and complete to the best of my knowledge and belief. I further certify that the above-described pit or below-grade tank has been/will be constructed or closed according to NMOCD guidelines ☐, a general permit ☐, or an (attached) alternative OCD-approved plan ☒

Date: 10/3/05

Printed Name/Title Mark Harvey for Williams Field Services Signature Mr. Harvey FOR WFS

Your certification and NMOCD approval of this application/closure does not relieve the operator of liability should the contents of the pit or tank contaminate ground water or otherwise endanger public health or the environment. Nor does it relieve the operator of its responsibility for compliance with any other federal, state, or local laws and/or regulations.

Approval: DEPUTY OIL & GAS INSPECTOR, DIST. 3

Printed Name/Title _____ Signature Henry Jay

FEB 02 2006
Date: _____

ADDENDUM TO OCD FORM C-144

Operator: BURLINGTON RESOURCES OIL & GAS COMPANY LP

API 30-045-23351

Well Name: DECKER #005

Meter: 34653

Facility Diagram:

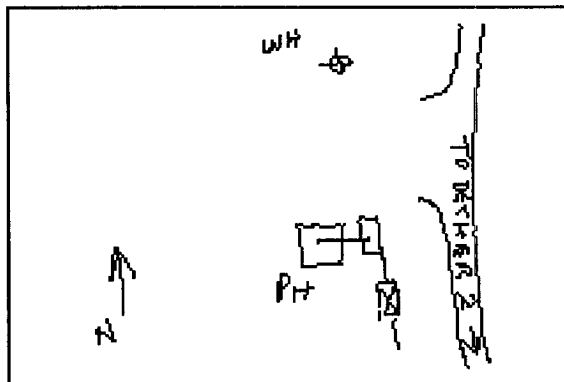

Sampling Diagram:

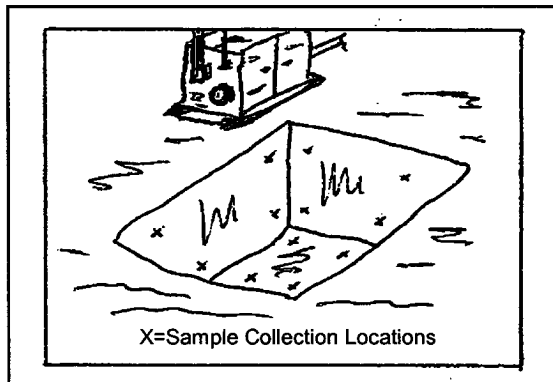

Pit Dimensions

Length 12 Ft.

Width 12 Ft.

Depth 2 Ft.

Location of Pit Center

Latitude 36 57.708 N

Longitude 08 03.537 W

(NAD 1927)

Pit ID

346531

Pit Type

Glycol Dehydrator

Date Closure Started: 2/28/05

Date Closure Completed: 2/28/05

Closure Method: Excavated, Blended, Treated Soil Returned

Bedrock Encountered ? ☒

Cubic Yards Excavated: 27

Vertical Extent of Equipment Reached ? ☐

Description Of Closure Action:

Contaminated soil was removed and treated then returned to the excavation following sampling of the walls and floor.

BEDROCK limited vertical excavation and/or prevented sampling. This condition limits deleterious environmental effects.

Pit Closure Sampling:

Sample ID	Sample Date	Head Space	BTEX Total (mg/kg)	Benzene (mg/kg)	TPH DRO (mg/kg)	Purpose	Location	Depth
115922JAN05	1/22/05		96.8	0	420	ASSESS	Flr	2.5
133328FEB05	2/28/05	97			18	EX Confirm	Walls	5
133728FEB05	2/28/05	280	14.59	0	160	EX Confirm	Flr	5

See Risk Analysis

Lab Project Number: 6091199
Client Project ID: NM Pits

Lab Sample No: 607850039 Project Sample Number: 6091199-010 Date Collected: 01/22/05 11:59
Client Sample ID: 115922JAN05 Matrix: Soil Date Received: 01/26/05 09:00

Parameters	Results	Units	Report Limit	DF	Analyzed	By	CAS No.	Qual	RegLmt
------------	---------	-------	--------------	----	----------	----	---------	------	--------

GC Semivolatiles

Total Extractable Hydrocarbons Prep/Method: OA2 / OA2

Mineral Spirits	ND	mg/kg	11.	1.1	02/02/05 04:39	RMN1			
Jet Fuel	ND	mg/kg	11.	1.1	02/02/05 04:39	RMN1			
Kerosene	ND	mg/kg	11.	1.1	02/02/05 04:39	RMN1			
Diesel Fuel	ND	mg/kg	11.	1.1	02/02/05 04:39	RMN1	68334-30-5		
Fuel Oil	ND	mg/kg	11.	1.1	02/02/05 04:39	RMN1	68334-30-5		
Motor Oil	ND	mg/kg	11.	1.1	02/02/05 04:39	RMN1			
Total Petroleum Hydrocarbons	420	mg/kg	11.	1.1	02/02/05 04:39	RMN1		1	
n-Tetracosane (S)	99	%		1.0	02/02/05 04:39	RMN1	646-31-1		
p-Terphenyl (S)	106	%		1.0	02/02/05 04:39	RMN1	92-94-4		
Date Extracted	01/31/05				01/31/05				

Organics Prep

Percent Moisture	Method: SM 2540G								
Percent Moisture	12.5	%		1.0	01/31/05	ALJ1			

GC Volatiles

Aromatic Volatile Organics Prep/Method: EPA 5030 Medium Soil / EPA 8021

Benzene	ND	ug/kg	2700	54.4	01/27/05 14:12		71-43-2		
Ethylbenzene	5800	ug/kg	2700	54.4	01/27/05 14:12		100-41-4		
Toluene	30000	ug/kg	2700	54.4	01/27/05 14:12		108-88-3		
Xylene (Total)	61000	ug/kg	7100	54.4	01/27/05 14:12		1330-20-7		
a,a,a-Trifluorotoluene (S)	142	%		1.0	01/27/05 14:12		98-08-8	2.3	

REPORT OF LABORATORY ANALYSIS

This report shall not be reproduced, except in full,
without the written consent of Pace Analytical Services, Inc.

Lab Project Number: 6092681
Client Project ID: NM Pits 02/18-03/04/2005

Lab Sample No: 607961794 Project Sample Number: 6092681-025 Date Collected: 02/28/05 13:33
Client Sample ID: 133328FEB05 Matrix: Soil Date Received: 03/10/05 09:00

Parameters	Results	Units	Report Limit	DF	Analyzed	By	CAS No.	Qual	RegLmt
------------	---------	-------	--------------	----	----------	----	---------	------	--------

GC Semivolatiles

Total Extractable Hydrocarbons	Prep/Method: OA2 / OA2								
Mineral Spirits	ND	mg/kg	11.	1.1	03/11/05 21:42	WAW			
Jet Fuel	ND	mg/kg	11.	1.1	03/11/05 21:42	WAW			
Kerosene	ND	mg/kg	11.	1.1	03/11/05 21:42	WAW			
Diesel Fuel	ND	mg/kg	11.	1.1	03/11/05 21:42	WAW	68334-30-5		
Fuel Oil	ND	mg/kg	11.	1.1	03/11/05 21:42	WAW	68334-30-5		
Motor Oil	ND	mg/kg	11.	1.1	03/11/05 21:42	WAW			
Total Petroleum Hydrocarbons	18.	mg/kg	11.	1.1	03/11/05 21:42	WAW		1	
n-Tetracosane (S)	94	%		1.0	03/11/05 21:42	WAW	646-31-1		
p-Terphenyl (S)	102	%		1.0	03/11/05 21:42	WAW	92-94-4		
Date Extracted	03/10/05				03/10/05				

Organics Prep

Percent Moisture	Method: SM 2540G								
Percent Moisture	8.1	%		1.0	03/10/05	ALJ1			

REPORT OF LABORATORY ANALYSIS

This report shall not be reproduced, except in full,
without the written consent of Pace Analytical Services, Inc.

Lab Project Number: 6092681

Client Project ID: NM Pits 02/18-03/04/2005

Lab Sample No: 607961802
Client Sample ID: 133728FEB05

Project Sample Number: 6092681-026
Matrix: Soil

Date Collected: 02/28/05 13:37
Date Received: 03/10/05 09:00

Parameters	Results	Units	Report Limit	DF	Analyzed	By	CAS No.	Qual	ReqLmt
------------	---------	-------	--------------	----	----------	----	---------	------	--------

GC Semivolatiles

Total Extractable Hydrocarbons	Prep/Method: OA2 / OA2								
Mineral Spirits	ND	mg/kg	11.	1.1	03/11/05 22:04	WAW			
Jet Fuel	ND	mg/kg	11.	1.1	03/11/05 22:04	WAW			
Kerosene	ND	mg/kg	11.	1.1	03/11/05 22:04	WAW			
Diesel Fuel	ND	mg/kg	11.	1.1	03/11/05 22:04	WAW	68334-30-5		
Fuel Oil	ND	mg/kg	11.	1.1	03/11/05 22:04	WAW	68334-30-5		
Motor Oil	ND	mg/kg	11.	1.1	03/11/05 22:04	WAW			
Total Petroleum Hydrocarbons	160	mg/kg	11.	1.1	03/11/05 22:04	WAW		1	
n-Tetracosane (S)	104	%		1.0	03/11/05 22:04	WAW	646-31-1		
p-Terphenyl (S)	101	%		1.0	03/11/05 22:04	WAW	92-94-4		
Date Extracted	03/10/05				03/10/05				

Organics Prep

Percent Moisture	Method: SM 2540G								
Percent Moisture	7.7	%		1.0	03/10/05	ALJ1			

GC/MS Volatiles

UST VOCs in Soil	Prep/Method: EPA 5030 Medium Soil / EPA 8260								
Benzene	ND	ug/kg	100	2.1	03/14/05 12:56	AEP	71-43-2		
Toluene	590	ug/kg	100	2.1	03/14/05 12:56	AEP	108-88-3		
Ethylbenzene	ND	ug/kg	100	2.1	03/14/05 12:56	AEP	100-41-4		
Xylene (Total)	14000	ug/kg	310	2.1	03/14/05 12:56	AEP	1330-20-7		
Dibromofluoromethane (S)	97	%		1.0	03/14/05 12:56	AEP	1868-53-7		
1,2-Dichloroethane-d4 (S)	106	%		1.0	03/14/05 12:56	AEP	17060-07-0		
Toluene-d8 (S)	122	%		1.0	03/14/05 12:56	AEP	2037-26-5	6	
4-Bromofluorobenzene (S)	94	%		1.0	03/14/05 12:56	AEP	460-00-4		

REPORT OF LABORATORY ANALYSIS

This report shall not be reproduced, except in full,
without the written consent of Pace Analytical Services, Inc.