

District I  
1625 N. French Dr., Hobbs, NM 88240  
District II  
1301 W. Grand Avenue, Artesia, NM 88210  
District III  
1000 Rio Brazos Road, Aztec, NM 87410  
District IV  
1220 S. St. Francis Dr., Santa Fe, NM 87505

State of New Mexico  
Energy Minerals and Natural Resources

Oil Conservation Division  
1220 South St. Francis Dr.  
Santa Fe, NM 87505

Form C-144  
June 1, 2004

For drilling and production facilities, submit to appropriate NMOCD District Office.  
For downstream facilities, submit to Santa Fe office

**Pit or Below-Grade Tank Registration or Closure**

Is pit or below-grade tank covered by a "general plan"? Yes ☒ No ☐

WES

Type of action: Registration of a pit or below-grade tank ☐

Closure of a pit or below-grade tank ☒

Operator: CONOCOPHILLIPS COMPANY

Telephone:

e-mail address:

Address: PO BOX 2197 HOUSTON, TX 77252

Facility or well name: SAN JUAN 32 7 UNIT #089

API #: 30-045-29878

U/L or Qtr/Qtr D SEC 26 T 32N R 7W

County: SAN JUAN

Latitude 36 57.364 N

Longitude 107 32.579 W

NAD: 1927 ☒ 1983 ☐

Surface Owner: Federal ☒ State ☐ Private ☐ Indian ☐

**Pit**

Type: Drilling ☐ Production ☒ Disposal ☐

Workover ☐ Emergency ☐

Lined ☐ Unlined ☒

Liner Type: Synthetic ☒ Thickness \_\_\_\_\_ mil Clay ☐

Pit Volume 26 bbl

**Below-grade tank**

Volume: \_\_\_\_\_ bbl Type of fluid:

Construction Material:

Double-walled, with leak detection? Yes ☐ If not, explain why not.

Depth to ground water (vertical distance from bottom of pit to seasonal high water elevation of ground water.)

Less than 50 feet  
50 feet or more, but less than 100 feet  
100 feet or more

(20 points)  
(10 points) 0  
(0 points)

Wellhead protection area: (Less than 200 feet from a private domestic water source, or less than 1000 feet from all other water sources.)

Yes  
No

(20 points)  
(0 points) 0

Distance to surface water: (Horizontal distance to all wetlands, playas, irrigation canals, ditches, and perennial and ephemeral watercourses.)

Less than 200 feet  
200 feet to 1,000 feet  
Greater than 1,000 feet

(20 points)  
(10 points) 0  
(0 points)

**Ranking Score (TOTAL POINTS):**

0

**If this is a pit closure:** (1) Attach a diagram of the facility showing the pit's relationship to other equipment and tanks. (2) Indicate disposal location: (check the onsite box if you are burying in place) onsite ☒ offsite ☐ If offsite, name of facility \_\_\_\_\_. (3) Attach a general description of remedial action taken including remediation start date and end date. (4) Groundwater encountered: No ☒ Yes ☐ If yes, show depth below ground surface \_\_\_\_\_ ft. and attach sample results. (5) Attach soil sample results and a diagram of sample locations and excavations.

Additional Comments:

Secondary containment with fiberglass tub and liner - removed tub and liner and dig test trench to 3 ft BGS - no evidence of hydrocarbon impacts -  
ppm HS - no sample - return to grade

Meter: 82662

0

I hereby certify that the information above is true and complete to the best of my knowledge and belief. I further certify that the above-described pit or below-grade tank has been/will be constructed or closed according to NMOCD guidelines ☐, a general permit ☐, or an (attached) alternative OGD-approved plan ☒.

Date: 1/31/06

Printed Name/Title Mark Harvey for Williams Field Services

Signature Mark Harvey

Your certification and NMOCD approval of this application/closure does not relieve the operator of liability should the contents of the pit or tank contaminate ground water or otherwise endanger public health or the environment. Nor does it relieve the operator of its responsibility for compliance with any other federal, state, or local laws and/or regulations.

Approval:

Printed Name/Title

DEPUTY OIL & GAS INSPECTOR, DIST. #2

Signature Wesley

FEB 02 2006  
Date:

## **ADDENDUM TO OCD FORM C-144**

**Operator:** CONOCOPHILLIPS COMPANY

**API 30-045-29878**

**Well Name:** SAN JUAN 32 7 UNIT #089

**Meter:** 82662

**Facility Diagram:**

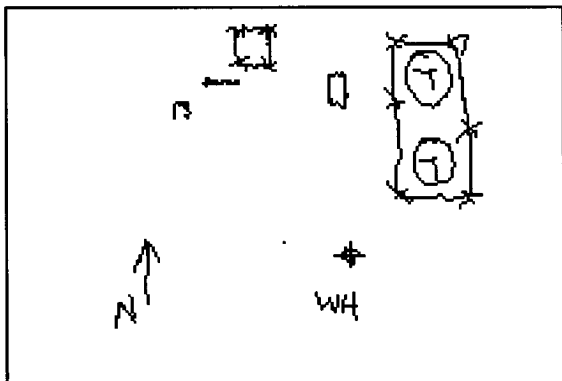

**Sampling Diagram:**

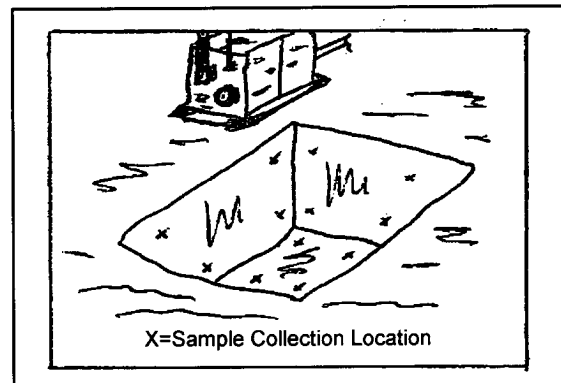

### **Pit Dimensions**

Length 12 Ft.

Width 12 Ft.

Depth 1 Ft.

### Location of Pit Center

Latitude 36 57.381 N

Longitude 07 32.582 W

(NAD 1927)

## Pit ID

826621

**Pit Type**

Unknown

**Date Closure Started: 6/21/05**

**Closure Method:** Pushed In

**Date Closure Completed:** 6/21/05

**Bedrock Encountered ?** ☐

**Cubic Yards Excavated:**

**Vertical Extent of Equipment Reached ? ☐**

**Description Of Closure Action:**

The pit was assessed and sampled in accordance with NMOCD guidelines. Based on assessment findings, the pit was backfilled.

### Pit Closure Sampling:

[illegible]