

District I
1625 N. French Dr., Hobbs, NM 88240
District II
1301 W. Grand Avenue, Artesia, NM 88210
District III
1000 Rio Brazos Road, Aztec, NM 87410

State of New Mexico
Energy Minerals and Natural Resources

Form C-144
June 1, 2004

Oil Conservation Division
1220 South St. Francis Dr.
Santa Fe, NM 87505

For drilling and production facilities, submit to appropriate NMOCD District Office.
For downstream facilities, submit to Santa Fe office

District IV
1220 S. St. Francis Dr., Santa Fe, NM 87505

Pit or Below-Grade Tank Registration or Closure

Is pit or below-grade tank covered by a "general plan"? Yes ☒ No ☐

Type of action: Registration of a pit or below-grade tank ☐ Closure of a pit or below-grade tank ☒

Operator: <u>BP AMERICA PROD. CO.</u> Telephone: <u>505-326-9200</u> e-mail address: _____		
Address: <u>200 ENERGY COURT, FARMINGTON, NM 87410</u>		
Facility or well name: <u>BARNES #19</u> API #: <u>30-045- 26801</u> U/L or Qtr/Qtr <u>A</u> Sec <u>26</u> T <u>32N</u> R <u>11W</u>		
County: <u>SAN JUAN</u> Latitude <u>36.96015</u> Longitude <u>107.95457</u> NAD: 1927 <input type="checkbox"/> 1983 <input checked="" type="checkbox"/> Surface Owner Federal <input checked="" type="checkbox"/> State <input type="checkbox"/> Private <input type="checkbox"/> Indian <input type="checkbox"/>		
Pit Type: Drilling <input type="checkbox"/> Production <input type="checkbox"/> Disposal <input checked="" type="checkbox"/> SEP/COMP Workover <input type="checkbox"/> Emergency <input type="checkbox"/> Lined <input type="checkbox"/> Unlined <input checked="" type="checkbox"/> Liner type: Synthetic <input type="checkbox"/> Thickness _____ mil Clay <input type="checkbox"/> Pit Volume _____ bbl	Below-grade tank Volume: _____ bbl Type of fluid: _____ Construction material: <u>NA</u> Double-walled, with leak detection? Yes <input type="checkbox"/> If not, explain why not. _____	
Depth to ground water (vertical distance from bottom of pit to seasonal high water elevation of ground water.)	Less than 50 feet 50 feet or more, but less than 100 feet 100 feet or more	(20 points) (10 points) (0 points) 0
Wellhead protection area: (Less than 200 feet from a private domestic water source, or less than 1000 feet from all other water sources.)	Yes No	(20 points) (0 points) 0
Distance to surface water: (horizontal distance to all wetlands, playas, irrigation canals, ditches, and perennial and ephemeral watercourses.)	Less than 200 feet 200 feet or more, but less than 1000 feet 1000 feet or more	(20 points) (10 points) (0 points) 0
Ranking Score (Total Points)		0

If this is a pit closure: (1) attach a diagram of the facility showing the pit's relationship to other equipment and tanks. (2) Indicate disposal location: (check the onsite box if you are burying in place) onsite ☐ offsite ☒ If offsite, name of facility BP CROUCH MESA LF (3) Attach a general description of remedial action taken including remediation start date and end date. (4) Groundwater encountered: No ☒ Yes ☐ If yes, show depth below ground surface _____ ft. and attach sample results. (5) Attach soil sample results and a diagram of sample locations and excavations.

Additional Comments: <u>PIT LOCATED APPROXIMATELY 111 FT. N77E FROM WELL HEAD.</u>
<u>PIT EXCAVATION: WIDTH 22 ft., LENGTH 20 ft., DEPTH 9 ft.</u>
<u>PIT REMEDIATION: CLOSE AS IS: <input type="checkbox"/> LANDFARM: <input checked="" type="checkbox"/> COMPOST: <input type="checkbox"/> STOCKPILE: <input type="checkbox"/> OTHER <input type="checkbox"/> (explain)</u>
Cubic yards: <u>145</u>
<u>BEDROCK BOTTOM</u>

I hereby certify that the information above is true and complete to the best of my knowledge and belief. I further certify that the above-described pit or below-grade tank has been/will be constructed or closed according to NMOCD guidelines ☒, a general permit ☐, or an alternative OCD-approved plan ☒.

Date: 05/27/05

Printed Name/Title: Jeff Blagg - P.E. # 11607 Signature: Jeff Blagg

Your certification and NMOCD approval of this application/closure does not relieve the operator of liability should the contents of the pit or tank contaminate ground water or otherwise endanger public health or the environment. Nor does it relieve the operator of its responsibility for compliance with any other federal, state, or local laws and/or regulations.

Approval: _____
Printed Name/Title: DEPUTY OIL & GAS INSPECTOR, DIST. # Signature: Denny Ford Date: FEB 21 2006

CLIENT:

BP

BLAGG ENGINEERING, INC.
P.O. BOX 87, BLOOMFIELD, NM 87413
(505) 632-1199

LOCATION NO: 81531

COCR NO: 13874

FIELD REPORT: PIT CLOSURE VERIFICATION

PAGE No: 1 of 1

LOCATION: NAME: BARNES WELL #: 19 TYPE: SEP/COMPR.

DATE STARTED: 5/24/05

QUAD/UNIT: A SEC: 26 TWP: 32N RNG: 11W PM: NM CNTY: ST ST: NM

DATE FINISHED:

QTR/FOOTAGE: 1165'N/1135'E NE/NE CONTRACTOR: PJS (TRINNY)

ENVIRONMENTAL SPECIALIST: NV

EXCAVATION APPROX. 22 FT. x 20 FT. x 9 FT. DEEP. CUBIC YARDAGE: 145

DISPOSAL FACILITY: BP-CROWN MESA FACILITY REMEDIATION METHOD: LANDFARM

LAND USE: RANGE-BUM LEASE: SF 078039 FORMATION: PC

FIELD NOTES & REMARKS:

PIT LOCATED APPROXIMATELY 111 FT. N77E FROM WELLHEAD.

DEPTH TO GROUNDWATER: >100 NEAREST WATER SOURCE: >1,000 NEAREST SURFACE WATER: >1,000

NMOCD RANKING SCORE: 0 NMOCD TPH CLOSURE STD: 5,000 PPM

SOIL AND EXCAVATION DESCRIPTION:

OVM CALIB. READ. = ppm

OVM CALIB. GAS = 100 ppm RF = 0.52

TIME: am/pm DATE:

SOIL TYPE: SAND SILTY SAND SILT SILTY CLAY CLAY GRAVEL OTHER BEDROCK (SANDSTONE)

SOIL COLOR: VARYING GRAY BEDROCK - LT. GRAY

COHESION (ALL OTHERS): NON COHESIVE SLIGHTLY COHESIVE COHESIVE HIGHLY COHESIVE

CONSISTENCY (NON COHESIVE SOILS): LOOSE FIRM DENSE VERY DENSE

PLASTICITY (CLAYS): NON PLASTIC SLIGHTLY PLASTIC COHESIVE MEDIUM PLASTIC HIGHLY PLASTIC

DENSITY (COHESIVE CLAYS & SILTS): SOFT FIRM STIFF VERY STIFF HARD

MOISTURE: DRY SLIGHTLY MOIST MOIST WET SATURATED SUPER SATURATED

DISCOLORATION/STAINING OBSERVED: YES NO EXPLANATION: ENTIRE TEST HOLE & BEDROCK SURFACE.

HC ODOR DETECTED: YES NO EXPLANATION:

SAMPLE TYPE: GRAB COMPOSITE - # OF PTS. -

ADDITIONAL COMMENTS: COLLECTED SAMPLE FROM BEDROCK SURFACE. BEDROCK - HARD,

BEDROCK
BOTTOM

SLIGHTLY FRIABLE.

CLOSED

SCALE

0 FT

FIELD 418.1 CALCULATIONS

SAMP. TIME	SAMP. ID	LAB NO.	WEIGHT (g)	mL FREON	DILUTION	READING	CALC. (ppm)

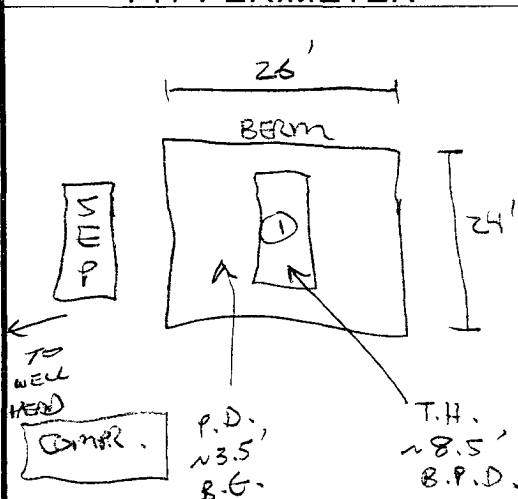
PIT PERIMETER**OVM READING**

SAMPLE ID	FIELD HEADSPACE (ppm)
1 @ 12'	225.4
2 @	
3 @	
4 @	
5 @	

LAB SAMPLES

SAMPLE ID	ANALYSIS	TIME
DC12	TPH (30158)	1403
4	BTEX (30218)	1
	PASSED	

PIT PROFILE

NOT APPLICABLE

P.D. = PIT DEPRESSION; B.G. = BELOW GRADE; B = BELOW
 T.H. = TEST HOLE; ~ = APPROX.; T.B. = TANK BOTTOM

TRAVEL NOTES:

CALLOUT: 5/24/05 - MORN. ONSITE: 5/24/05 - AFTER.

ENVIROTECH LABS

PRACTICAL SOLUTIONS FOR A BETTER TOMORROW

EPA METHOD 8015 Modified Nonhalogenated Volatile Organics Total Petroleum Hydrocarbons

Client:	Blagg / BP	Project #:	94034-010
Sample ID:	1 @ 12'	Date Reported:	05-27-05
Laboratory Number:	33103	Date Sampled:	05-24-05
Chain of Custody No:	13874	Date Received:	05-25-05
Sample Matrix:	Soil	Date Extracted:	05-25-05
Preservative:	Cool	Date Analyzed:	05-27-05
Condition:	Cool and Intact	Analysis Requested:	8015 TPH

Parameter	Concentration (mg/Kg)	Det. Limit (mg/Kg)
Gasoline Range (C5 - C10)	234	0.2
Diesel Range (C10 - C28)	133	0.1
Total Petroleum Hydrocarbons	367	0.2

ND - Parameter not detected at the stated detection limit.

References: Method 8015B, Nonhalogenated Volatile Organics, Test Methods for Evaluating Solid Waste, SW-846, USEPA, December 1996.

Comments: **Barnes #19 Separator/Compressor Pit Grab Sample.**

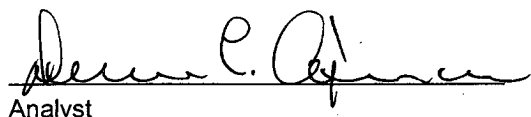
Analyst

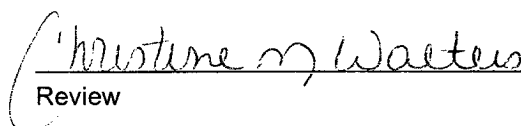
Review

ENVIROTECH LABS

PRACTICAL SOLUTIONS FOR A BETTER TOMORROW

EPA METHOD 8021 AROMATIC VOLATILE ORGANICS

Client:	Blagg / BP	Project #:	94034-010
Sample ID:	1 @ 12'	Date Reported:	05-27-05
Laboratory Number:	33103	Date Sampled:	05-24-05
Chain of Custody:	13874	Date Received:	05-25-05
Sample Matrix:	Soil	Date Analyzed:	05-27-05
Preservative:	Cool	Date Extracted:	05-25-05
Condition:	Cool & Intact	Analysis Requested:	BTEX

Parameter	Concentration (ug/Kg)	Det. Limit (ug/Kg)
Benzene	ND	2.1
Toluene	20.3	1.8
Ethylbenzene	263	1.7
p,m-Xylene	2,570	1.5
o-Xylene	220	2.2
Total BTEX	3,070	

ND - Parameter not detected at the stated detection limit.

Surrogate Recoveries:	Parameter	Percent Recovery
	Fluorobenzene	97.0 %
	1,4-difluorobenzene	97.0 %
	Bromochlorobenzene	97.0 %

References: Method 5030B, Purge-and-Trap, Test Methods for Evaluating Solid Waste, SW-846, USEPA, December 1996.

Method 8021B, Aromatic Volatile Organics, Test Methods for Evaluating Solid Waste, SW-846, USEPA, December 1996.

Comments: Barnes #19 Separator/Compressor Pit Grab Sample.

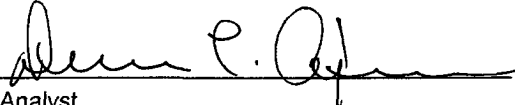
Analyst

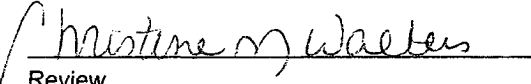
Review