

UNITED STATES
DEPARTMENT OF THE INTERIOR
BUREAU OF LAND MANAGEMENTFORM APPROVED
OMB NO. 1004-0135
Expires: November 30, 2000

SUNDRY NOTICES AND REPORTS ON WELLS

Do not use this form for proposals to drill or to re-enter an abandoned well. Use Form 3160-3 (APD) for such proposals.

SUBMIT IN TRIPLICATE - Other instructions on reverse side

1. Type of Well

☐ Oil Well ☒ Gas Well ☐ Other

2. Name of Operator

ENERGEN RESOURCES CORPORATION

3a. Address

2198 Bloomfield Highway, Farmington, NM 87401

3b. Phone No. (include area code)

4. Location of Well (Footage, Sec., T., R., M., or Survey Description)

2410' FNL, 1615' FEL, Sec. 20, T30N, R4W, N.M.P.M.

5. Lease Serial No.

NMSF-079487A

6. If Indian, Allottee or Tribe Name

7. If Unit or CA/Agreement, Name and/or No

8. Well Name and No.

San Juan 30-4 Unit 45

9. API Well No.

30-039-26330

10. Field and Pool, or Exploratory Area

Basin Fruitland Coal/
E. Blanco Pictured Cliffs

11. County or Parish, State

Rio Arriba NM

12. CHECK APPROPRIATE BOX(ES) TO INDICATE NATURE OF NOTICE, REPORT, OR OTHER DATA

TYPE OF SUBMISSION

☒ Notice of Intent☐ Subsequent Report☐ Final Abandonment Notice

TYPE OF ACTION

☐ Acidize☐ Alter Casing☐ Casing Repair☐ Change Plans☐ Convert to Injection☐ Deepen☐ Fracture Treat☐ New Construction☐ Plug and Abandon☐ Plug Back☐ Production (Start/Resume)☐ Reclamation☐ Recomplete☐ Temporarily Abandon☐ Water Disposal☐ Water Shut-Off☐ Well Integrity☒ Other Pay Add &Down-HoleCommingle

13. Describe Proposed or Completed Operation (clearly state all pertinent details, including estimated starting date of any proposed work and approximate duration thereof. If the proposal is to deepen directionally or recomple horizontally, give subsurface locations and measured and true vertical depths of all pertinent markers and zones. Attach the Bond under which the work will be performed or provide the Bond No. on file with BLM/BIA. Required subsequent reports shall be filed within 30 days following completion of the involved operations. If the operation results in a multiple completion or recomple in a new interval, a Form 3160-4 shall be filed once testing has been completed. Final Abandonment Notices shall be filed only after all requirements, including reclamation, have been completed, and the operator has determined that the final site is ready for final inspection.)

In accordance with NMOCD order # R-11363, it is intended to add the Fruitland Coal and downhole commingle it with the Pictured Cliffs as follows:

1. MIRU. TOH and lay down tubing.
2. Set CIBP at 4268'. Test casing to 3000 psi.
3. Selectively perforate Fruitland coal and fracture treat.
4. Flow back frac. TIH and clean out to PBDT with air mist.
5. Run 2 3/8" tubing. Run pump and rods. Install pumping unit and return to production.

Note: A amended well location plat with the dedicated acreage is attached.

CONDITIONS OF APPROVAL
Adhere to previously issued stipulations

DHC1245AZ

070 Farmington NM
2003 JUN 24 AM 10:38
RECEIVED

14. I hereby certify that the foregoing is true and correct

Name (Printed/Typed)

Charlie Donahue

Title

District Engineer

Date 6/19/03

THIS SPACE FOR FEDERAL OR STATE OFFICE USE

Approved by

/s/ Jim Lovato

Title

Date

Conditions of approval, if any, are attached. Approval of this notice does not warrant or certify that the applicant holds legal or equitable title to those rights in the subject lease which would entitle the applicant to conduct operations thereon.

Office

JUL 1 2003

Title 18 U.S.C. Section 1001, and Title 43 U.S.C. Section 1212, makes it a crime for any person knowingly and willfully to make to any department or agency of the United States any false, fictitious or fraudulent statements or representations as to any matter within its jurisdiction.

District I
PO Box 1980, Hobbs, NM 88241-1980

District II
PO Drawer DD, Artesia, NM 88211-0719

District III
1000 Rio Brazos Rd., Aztec, NM 87410

District IV
PO Box 2088, Santa Fe, NM 87504-2088

State of New Mexico
Energy, Minerals & Natural Resources Depart.

OIL CONSERVATION DIVISION
PO Box 2088
Santa Fe, NM 87504-2088

Form C-102
Revised February 21, 1994
Instructions on back
Submit to Appropriate District Office
State Lease - 4 Copies
Fee Lease - 3 Copies

RECEIVED

2003 JUN 27 AM 10:44 ☒ AMENDED REPORT

WELL LOCATION AND ACREAGE DEDICATION PLAT

*API Number 30-039-26330		*Pool Code 72400 / 71629	*Pool Name East Blanco Pictured Cliffs / Basin Fruitland Coal
*Property Code 21994...	*Property Name SAN JUAN 30-4 UNIT		*Well Number 45
*OGAID No. 162928	*Operator Name ENERGEN RESOURCES CORPORATION		*Elevation 7570'

¹⁰ Surface Location

UL or lot no.	Section	Township	Range	Lot Idn	Feet from the	North/South line	Feet from the	East/West line	County
G	20	30N	4W		2410	NORTH	1615	EAST	RIO ARriba

¹¹ Bottom Hole Location If Different From Surface

UL or lot no.	Section	Township	Range	Lot Idn	Feet from the	North/South line	Feet from the	East/West line	County

¹² Dedicated Acres 160 / 320	¹³ Joint or Infill	¹⁴ Consolidation Code	¹⁵ Order No.
--	-------------------------------	----------------------------------	-------------------------

NO ALLOWABLE WILL BE ASSIGNED TO THIS COMPLETION UNTIL ALL INTERESTS HAVE BEEN CONSOLIDATED OR A NON-STANDARD UNIT HAS BEEN APPROVED BY THE DIVISION

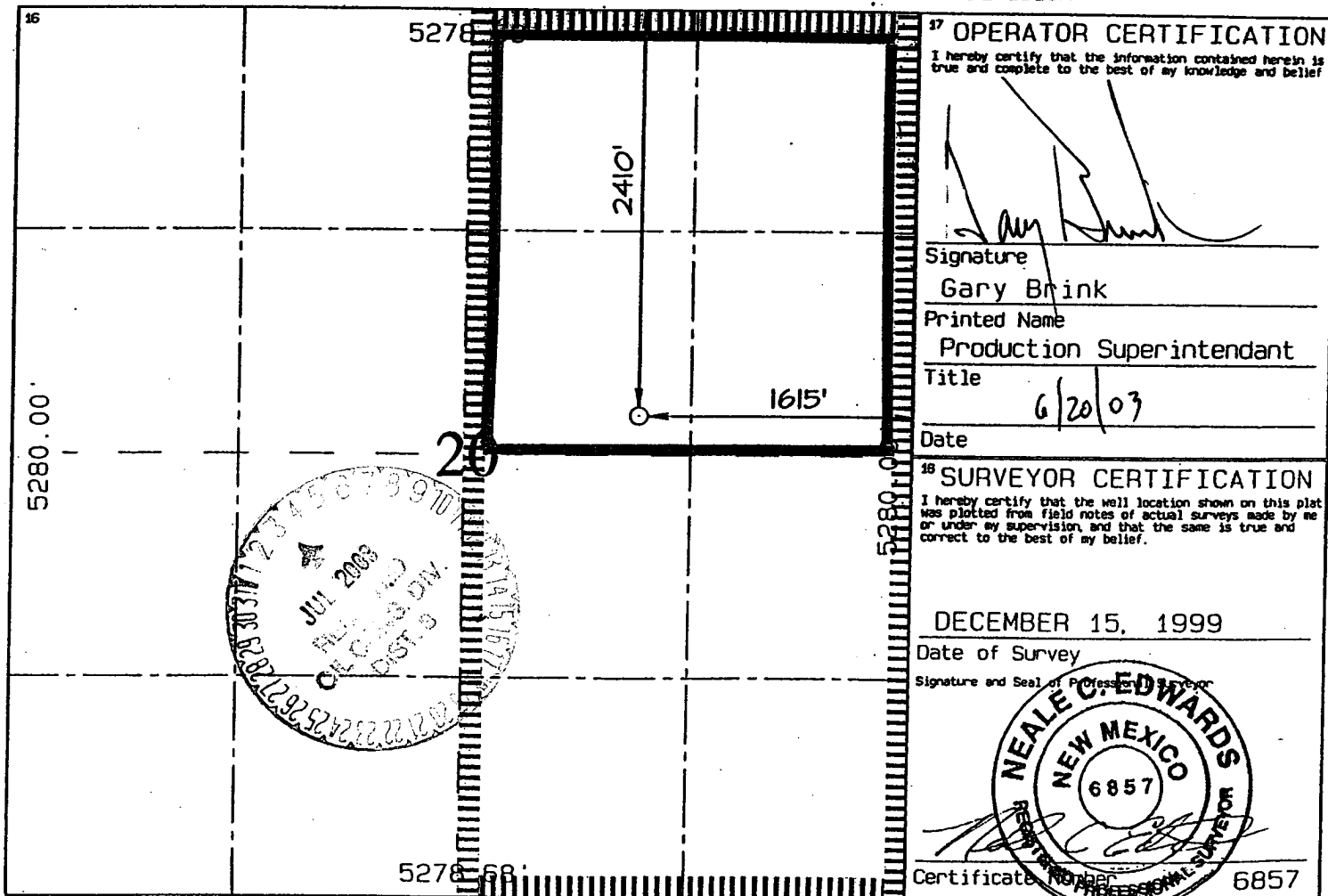

¹⁷ OPERATOR CERTIFICATION

I hereby certify that the information contained herein is true and complete to the best of my knowledge and belief

[Signature]
Signature

Gary Brink
Printed Name

Production Superintendant
Title

6/20/03
Date

¹⁸ SURVEYOR CERTIFICATION

I hereby certify that the well location shown on this plat was plotted from field notes of actual surveys made by me or under my supervision, and that the same is true and correct to the best of my belief.

DECEMBER 15, 1999
Date of Survey

[Signature]
Signature and Seal of Professional Surveyor

NEALE C. EDWARDS
NEW MEXICO
6857
Certificate Number 6857