

UNITED STATES
DEPARTMENT OF THE INTERIOR
BUREAU OF LAND MANAGEMENT

FORM APPROVED
OMB No. 1004-0135
Expires: January 31, 2004

SUNDRY NOTICES AND REPORTS ON WELLS
Do not use this form for proposals to drill or to re-enter an abandoned well. Use Form 3160-3 (APD) for such proposals.

SUBMIT IN TRIPLICATE - Other instructions on reverse side

1. Type of Well

☐ Oil Well ☒ Gas Well ☐ Other

2. Name of Operator

Richardson Operating Company

3a. Address

3100 La Plata Highway Farmington, NM 87401

3b. Phone No. (include area code)

505-564-3100

4. Location of Well (Footage, Sec., T, R., M., or Survey Description)

1637' FNL & 746' FWL

Sec. 33, T30N, R14W NMPM

5. Lease Serial No.

NMSF-079968

6. If Indian, Allottee or Tribe Name

7. If Unit or CA/Agreement, Name and/or No.

8. Well Name and No.

WF Federal 33 #2

9. API Well No.

30-045-30655

10. Field and Pool, or Exploratory Area

Basin Fruitland Coal

11. County or Parish, State

San Juan

12. CHECK APPROPRIATE BOX(ES) TO INDICATE NATURE OF NOTICE, REPORT, OR OTHER DATA

TYPE OF SUBMISSION

☒ Notice of Intent

☐ Subsequent Report

☐ Final Abandonment Notice

TYPE OF ACTION

☐ Acidize

☐ Alter Casing

☐ Casing Repair

☐ Change Plans

☐ Convert to Injection

☐ Deepen

☐ Fracture Treat

☐ New Construction

☐ Plug and Abandon

☐ Plug Back

☐ Production (Start/Resume)

☐ Reclamation

☒ Recomplete

☐ Temporarily Abandon

☐ Water Disposal

☐ Water Shut-Off

☐ Well Integrity

☐ Other Add a zone

3. Describe Proposed or Completed Operation (clearly state all pertinent details, including estimated starting date of any proposed work and approximate duration thereof. If the proposal is to deepen directionally or recomple horizontally, give subsurface locations and measured and true vertical depths of all pertinent markers and zones. Attach the Bond under which the work will be performed or provide the Bond No. on file with BLM/BIA. Required subsequent reports shall be filed within 30 days following completion of the involved operations. If the operation results in a multiple completion or recompletion in a new interval, a Form 3160-4 shall be filed once testing has been completed. Final Abandonment Notices shall be filed only after all requirements, including reclamation, have been completed, and the operator has determined that the site is ready for final inspection.)

Richardson Operating Company proposes adding the Basin Fruitland Coal (71629) pursuant to New Mexico Oil Conservation Division Order No. R-11775-B.

Please find the attached plat for the subject well (WF Federal 33 #2) with the original Basin Fruitland well in the dedicated acreage (WF Federal 33 #1) depicted on the same plat.

14. I hereby certify that the foregoing is true and correct
Name (Printed/Typed)

Drew Carnes

Title Operations Manager

Signature

Date 5-22-03

THIS SPACE FOR FEDERAL OR STATE OFFICE USE

Approved by (Signature)

/s/ Jim Lovato

Name

(Printed/Typed)

Title

Conditions of approval, if any, are attached. Approval of this notice does not warrant or certify that the applicant holds legal or equitable title to those rights in the subject lease which would entitle the applicant to conduct operations thereon.

Office

Date

MAY 29 2003

Title 18 U.S.C. Section 1001 and Title 43 U.S.C. Section 1212, make it a crime for any person knowingly and willfully to make to any department or agency of the United States any false, fictitious or fraudulent statements or representations as to any matter within its jurisdiction.

(Continued on next page)

NMOC

RECEIVED
MAY 23 AM 10:33
070 Farmington, NM

State of New Mexico
Energy, Minerals & Mining Resources Department

Form C - 102

OL CONSERVATION DIVISION
2040 South Pacheco
Santa Fe, NM 87505

☒ AMENDED REPORT

WELL LOCATION AND ACREAGE DEDICATION PLAT

APA Number	Pool Code 71629 & 86620	Pool Name Basin Fruitland Coal & Twin Mounds Pictured Cliffs
Property Code	Property Name WF FEDERAL	Well Number 33 - 2
OGRID No. 019219	Operator Name -RICHARDSON OPERATING COMPANY	Elevation 5510'

Surface Location									
UL or Lot E	Sec. 33	Twp. 30 N.	Rge. 14 W.	Lot Lch.	Feet from > 1637	North/South NORTH	Feet from > 746	East/West WEST	County SAN JUAN

Bottom Hole Location if Different From Surface									
UL or Lot	Sec.	Twp.	Rge.	Lot Lch.	Feet from >	North/South	Feet from >	East/West	County

Dedication	Joint ?	Consolidation	Order No.
------------	---------	---------------	-----------

NO ALLOWABLE WILL ASSIGNED TO THIS COMPLETION UNTIL ALL INTERESTS HAVE BEEN CONSOLIDATED
OR A NON-STANDARD UNIT HAS BEEN APPROVED BY THE DIVISION

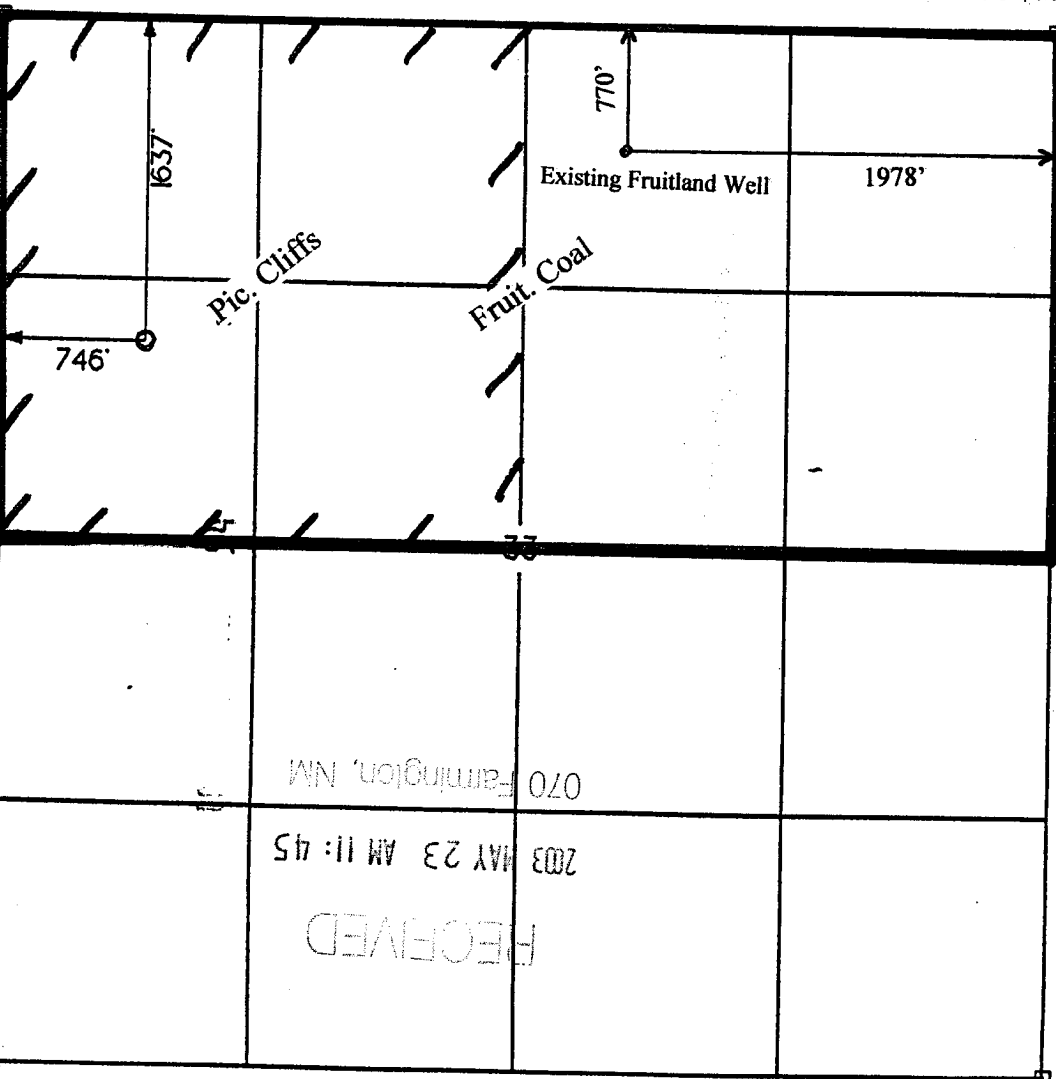

OPERATOR CERTIFICATION I hereby certify that the information contained herein is true and complete to the best of my knowledge and belief. Signature: <i>[Signature]</i>	
Printed Name: Drew Carnes	
Title: Operations Manager	
Date: 5/22/03	
SURVEYOR CERTIFICATION I hereby certify that the well location on this plat was plotted from field notes of actual surveys made by me or under my supervision, and that the same is true and correct to the best of my belief. Date of Survey:	
Signature and Seal of Registered Land Surveyor: <i>[Signature]</i> <div style="text-align: center;"> </div>	