

District I
1625 N. French Dr., Hobbs, NM 88240
District II
1301 W. Grand Avenue, Artesia, NM 88210
District III
1000 Rio Brazos Road, Aztec, NM 87410
District IV
1220 S. St. Francis Dr., Santa Fe, NM 87505

State of New Mexico
Energy Minerals and Natural Resources

Form C-144

June 1, 2004

Oil Conservation Division
1220 South St. Francis Dr.
Santa Fe, NM 87505

For drilling and production facilities, submit to
appropriate NMOCD District Office.
For downstream facilities, submit to Santa Fe
office

Pit or Below-Grade Tank Registration or Closure

Is pit or below-grade tank covered by a "general plan"? Yes ☒ No ☐

WFS CLOSURE Type of action: Registration of a pit or below-grade tank ☐ Closure of a pit or below-grade tank ☒

Operator: CONOCOPHILLIPS COMPANY Telephone: _____ e-mail address: _____
Address: PO BOX 2197 HOUSTON, TX 77252
Facility or well name: SAN JUAN 32 7 UNIT #079 API #: 30-045-25207 U/L or Qtr/Qtr I SEC 7 T 31N R 7W
County: SAN JUAN Latitude 36 54.721 N Longitude 107 36.578 W NAD: 1927 ☒ 1983 ☐
Surface Owner: Federal ☒ State ☐ Private ☐ Indian ☐

Pit

Type: Drilling ☐ Production ☒ Disposal ☐

Workover ☐ Emergency ☐

Lined ☐ Unlined ☒

Liner Type: Synthetic ☒ Thickness _____ mil Clay ☐

Pit Volume 80 bbl

Below-grade tank

Volume: _____ bbl Type of fluid: _____

Construction Material: _____

Double-walled, with leak detection? Yes ☒ If not, explain why not.

Depth to ground water (vertical distance from bottom of pit to seasonal high water elevation of ground water.)

Less than 50 feet
50 feet or more, but less than 100 feet
100 feet or more

(20 points)
(10 points)
(0 points)

0

Wellhead protection area: (Less than 200 feet from a private domestic water source, or less than 1000 feet from all other water sources.)

Yes
No

(20 points)
(0 points)

0

Distance to surface water: (Horizontal distance to all wetlands, playas, irrigation canals, ditches, and perennial and ephemeral watercourses.)

Less than 200 feet
200 feet to 1,000 feet
Greater than 1,000 feet

(20 points)
(10 points)
(0 points)

0

Ranking Score (TOTAL POINTS):

0

If this is a pit closure: (1) Attach a diagram of the facility showing the pit's relationship to other equipment and tanks. (2) Indicate disposal location: (check the onsite box if you are burying in place) onsite ☒ offsite ☐ If offsite, name of facility _____. (3) Attach a general description of remedial action taken including remediation start date and end date. (4) Groundwater encountered: No ☒ Yes ☐ If yes, show depth below ground surface _____ ft. and attach sample results. (5) Attach soil sample results and a diagram of sample locations and excavations.

Additional Comments:

Meter: 85647

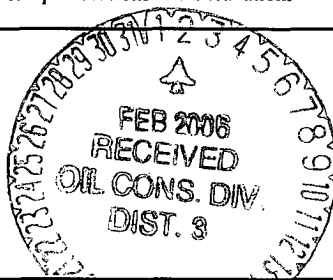

I hereby certify that the information above is true and complete to the best of my knowledge and belief. I further certify that the above-described pit or below-grade tank has been/will be constructed or closed according to NMOCD guidelines ☐, a general permit ☐, or an (attached) alternative OCD-approved plan ☒

Date: 10/3/05

Printed Name/Title Mark Harvey for Williams Field Services Signature Mr. Harvey, for WFS

Your certification and NMOCD approval of this application/closure does not relieve the operator of liability should the contents of the pit or tank contaminate ground water or otherwise endanger public health or the environment. Nor does it relieve the operator of its responsibility for compliance with any other federal, state, or local laws and/or regulations.

Approval: DEPUTY OIL & GAS INSPECTOR, DIST. 3

Printed Name/Title _____ Signature Gary Faint

FEB 02 2006
Date: _____

ADDENDUM TO OCD FORM C-144

Operator: CONOCOPHILLIPS COMPANY

API 30-045-25207

Well Name: SAN JUAN 32 7 UNIT #079

Meter: 85647

Facility Diagram:

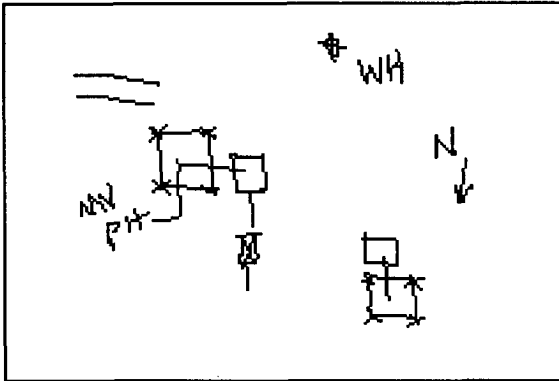

Sampling Diagram:

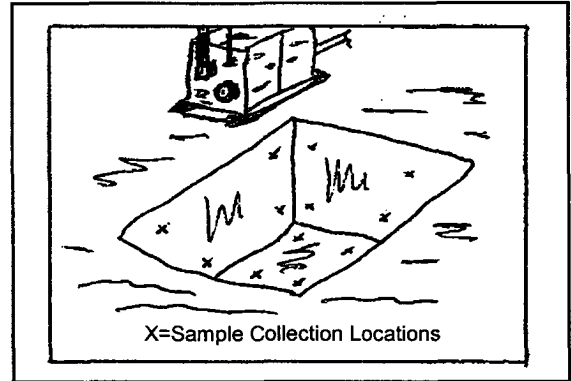

Pit Dimensions

Length 15 Ft.

Width 15 Ft.

Depth 2 Ft.

Location of Pit Center

Latitude 36 54.731 N

Longitude 07 36.582 W

(NAD 1927)

Pit ID

856472

Pit Type

Glycol Dehydrator

Date Closure Started: 7/8/05

Date Closure Completed: 7/8/05

Closure Method: Excavated, Blended, Treated Soil Returned

Bedrock Encountered ? ☒

Cubic Yards Excavated: 25

Vertical Extent of Equipment Reached ? ☐

Description Of Closure Action:

Contaminated soil was removed and treated then returned to the excavation following sampling of the walls and floor.

BEDROCK limited vertical excavation and/or prevented sampling. This condition limits deleterious environmental effects.

Pit Closure Sampling:

Sample ID	Sample Date	Head Space	BTEX Total (mg/kg)	Benzene (mg/kg)	TPH DRO (mg/kg)	Purpose	Location	Depth
113108JUL05	7/8/05	0			0	EX Confirm	Walls	2
114208JUL05	7/8/05	0			0	EX Confirm	Flr	3
155621JUN05	6/21/05		0.076	0	30000	ASSESS	Flr	2

Lab Project Number: 6096734
Client Project ID: NM Pits 2nd QTR 2005

Lab Sample No: 608302410 Project Sample Number: 6096734-014 Date Collected: 06/21/05 15:56
Client Sample ID: 155621JUN05 Matrix: Soil Date Received: 06/25/05 08:15

Parameters	Results	Units	Report Limit	DF	Analyzed	By	CAS No.	Qual	ReqLmt
------------	---------	-------	--------------	----	----------	----	---------	------	--------

GC Semivolatiles

Total Extractable Hydrocarbons	Prep/Method: OA2 / OA2								
Mineral Spirits	ND	mg/kg	1200	117	07/01/05 18:44	MAM			
Jet Fuel	ND	mg/kg	1200	117	07/01/05 18:44	MAM			
Kerosene	ND	mg/kg	1200	117	07/01/05 18:44	MAM			
Diesel Fuel	ND	mg/kg	1200	117	07/01/05 18:44	MAM	68334-30-5		
Fuel Oil	ND	mg/kg	1200	117	07/01/05 18:44	MAM	68334-30-5		
Motor Oil	ND	mg/kg	1200	117	07/01/05 18:44	MAM			
Total Petroleum Hydrocarbons	30000	mg/kg	1200	117	07/01/05 18:44	MAM			2
n-Tetracosane (S)	0	%		1.0	07/01/05 18:44	MAM	646-31-1		6
p-Terphenyl (S)	0	%		1.0	07/01/05 18:44	MAM	92-94-4		6
Date Extracted	06/29/05				06/29/05				

Organics Prep

Percent Moisture	Method: SM 2540G								
Percent Moisture	14.7	%			1.0 06/28/05	ALJ1			

GC Volatiles

Aromatic Volatile Organics	Prep/Method: EPA 5030 Medium Soil / EPA 8021								
Benzene	ND	ug/kg	58.	1.2	06/29/05 20:39	SHF	71-43-2		
Ethylbenzene	ND	ug/kg	58.	1.2	06/29/05 20:39	SHF	100-41-4		
Toluene	76.	ug/kg	58.	1.2	06/29/05 20:39	SHF	108-88-3		
Xylene (Total)	ND	ug/kg	150	1.2	06/29/05 20:39	SHF	1330-20-7		
a,a,a-Trifluorotoluene (S)	105	%		1.0	06/29/05 20:39	SHF	98-08-8		

REPORT OF LABORATORY ANALYSIS

This report shall not be reproduced, except in full,
without the written consent of Pace Analytical Services, Inc.

Lab Project Number: 6097736
Client Project ID: NM PIT PROGRAM

Lab Sample No: 608389037 Project Sample Number: 6097736-004 Date Collected: 07/08/05 11:31
Client Sample ID: 113108JUL05 Matrix: Soil Date Received: 07/23/05 08:20

Parameters	Results	Units	Report Limit	DF	Analyzed	By	CAS No.	Qual	ReqLmt
GC Semivolatiles									
Total Extractable Hydrocarbons	Prep/Method: OA2 / OA2								
Mineral Spirits	ND	mg/kg	11.	1.1	07/29/05 10:26	CPR			
Jet Fuel	ND	mg/kg	11.	1.1	07/29/05 10:26	CPR	94114-58-6		
Kerosene	ND	mg/kg	11.	1.1	07/29/05 10:26	CPR			
Diesel Fuel	ND	mg/kg	11.	1.1	07/29/05 10:26	CPR	68334-30-5		
Fuel Oil	ND	mg/kg	11.	1.1	07/29/05 10:26	CPR	68334-30-5		
Motor Oil	ND	mg/kg	11.	1.1	07/29/05 10:26	CPR			
n-Tetracosane (S)	106	%		1.0	07/29/05 10:26	CPR	646-31-1		
p-Terphenyl (S)	107	%		1.0	07/29/05 10:26	CPR	92-94-4		
Date Extracted	07/25/05				07/25/05				

Organics Prep

Percent Moisture	Method: SM 2540G								
Percent Moisture	11.2	%		1.0	07/25/05	JDM			

REPORT OF LABORATORY ANALYSIS

This report shall not be reproduced, except in full,
without the written consent of Pace Analytical Services, Inc.

Lab Project Number: 6097736
Client Project ID: NM PIT PROGRAM

Lab Sample No: 608389045 Project Sample Number: 6097736-005 Date Collected: 07/08/05 11:42
Client Sample ID: 114208JUL05 Matrix: Soil Date Received: 07/23/05 08:20

Parameters	Results	Units	Report Limit	DF	Analyzed	By	CAS No.	Qual	RegLmt
GC Semivolatiles									
Total Extractable Hydrocarbons	Prep/Method: OA2 / OA2								
Mineral Spirits	ND	mg/kg	10.	1.0	07/29/05 10:46	CPR			
Jet Fuel	ND	mg/kg	10.	1.0	07/29/05 10:46	CPR	94114-58-6		
Kerosene	ND	mg/kg	10.	1.0	07/29/05 10:46	CPR			
Diesel Fuel	ND	mg/kg	10.	1.0	07/29/05 10:46	CPR	68334-30-5		
Fuel Oil	ND	mg/kg	10.	1.0	07/29/05 10:46	CPR	68334-30-5		
Motor Oil	ND	mg/kg	10.	1.0	07/29/05 10:46	CPR			
n-Tetracosane (S)	94	%		1.0	07/29/05 10:46	CPR	646-31-1		
p-Terphenyl (S)	93	%		1.0	07/29/05 10:46	CPR	92-94-4		
Date Extracted	07/25/05				07/25/05				

Organics Prep

Percent Moisture Method: SM 2540G
Percent Moisture 3.4 % 1.0 07/25/05 JDM

REPORT OF LABORATORY ANALYSIS

This report shall not be reproduced, except in full,
without the written consent of Pace Analytical Services, Inc.