

UNITED STATES
DEPARTMENT OF THE INTERIOR
BUREAU OF LAND MANAGEMENT

RECEIVED

SEP 20 2004

FORM APPROVED
OMB No. 1004-0136
Expires November 30, 2000

APPLICATION FOR PERMIT TO DRILL OR REENTER

Bureau of Land Management
Farmington Field Office

1a. Type of Work: <input checked="" type="checkbox"/> DRILL <input type="checkbox"/> REENTER		5. Lease Serial No. SF-078738
1b. Type of Well: <input type="checkbox"/> Oil Well <input type="checkbox"/> Gas Well <input checked="" type="checkbox"/> Other: CBM <input checked="" type="checkbox"/> Single Zone <input type="checkbox"/> Multiple Zone		6. If Indian, Allottee or Tribe Name
2. Name of Operator CONOCOPHILLIPS COMPANY		7. If Unit or CA Agreement, Name and No.
Contact: VICKI WESTBY E-Mail: Vicki.R.Westby@conocophillips.com		8. Lease Name and Well No. SAN JUAN 30-5 UNIT 249A
3a. Address 4001 PENBROOK, SUITE 346 ODESSA, TX 79762	3b. Phone No. (include area code) Ph: 915.368.1352	9. API Well No. 30-039-29230
4. Location of Well (Report location clearly and in accordance with any State requirements.) At surface NWSE 1447FSL 2492FEL At proposed prod. zone		10. Field and Pool, or Exploratory BASIN FRUITLAND COAL
14. Distance in miles and direction from nearest town or post office*		11. Sec., T., R., M., or Blk. and Survey or Area Sec 23 T30N R5W Mer NMP
15. Distance from proposed location to nearest property or lease line, ft. (Also to nearest drig. unit line, if any)	16. No. of Acres in Lease	12. County or Parish RIO ARriba
18. Distance from proposed location to nearest well, drilling completed, applied for, on this lease, ft.	19. Proposed Depth 3620 MD	13. State NM
21. Elevations (Show whether DF, KB, RT, GL, etc.) 6820 GL	22. Approximate date work will start	17. Spacing Unit dedicated to this well 320 E/2
23. Estimated duration		

24. Attachments

The following, completed in accordance with the requirements of Onshore Oil and Gas Order No. 1, shall be attached to this form:

- Well plat certified by a registered surveyor.
- A Drilling Plan.
- A Surface Use Plan (if the location is on National Forest System Lands, the SUPO shall be filed with the appropriate Forest Service Office).
- Bond to cover the operations unless covered by an existing bond on file (see Item 20 above).
- Operator certification
- Such other site specific information and/or plans as may be required by the authorized officer.

25. Signature (Electronic Submission)	Name (Printed/Typed) VICKI WESTBY	Date 09/17/2004
Title AGENT		
Approved by (Signature) <i>[Signature]</i>	Name (Printed/Typed)	Date 5/8/06
Title AFM	Office FFO	

Application approval does not warrant or certify the applicant holds legal or equitable title to those rights in the subject lease which would entitle the applicant to conduct operations thereon.
Conditions of approval, if any, are attached.

Title 18 U.S.C. Section 1001 and Title 43 U.S.C. Section 1212, make it a crime for any person knowingly and willfully to make to any department or agency of the United States any false, fictitious or fraudulent statements or representations as to any matter within its jurisdiction.

Additional Operator Remarks (see next page)

Electronic Submission #36278 verified by the BLM Well Information System
For CONOCOPHILLIPS COMPANY, sent to the Farmington

DRILLING OPERATIONS AUTHORIZED ARE
SUBJECT TO COMPLIANCE WITH ATTACHED
"GENERAL REQUIREMENTS".

This action is subject to technical and
procedural review pursuant to 43 CFR 3165.3
and appeal pursuant to 43 CFR 3165.4

NMOCD

** OPERATOR-SUBMITTED ** OPERATOR-SUBMITTED ** OPERATOR-SUBMITTED **

Additional Operator Remarks:

ConocoPhillips Company proposes to drill a vertical wellbore to the Basin Fruitland Coal formation.

This well will be drilled and equipped in accordance with the attachments submitted herewith.

This application is for APD/ROW.

ConocoPhillips will have mudloggers on location and they will be picking the TD to prevent us from accessing the PC.

This well is not in a HPA.

State of New Mexico
Energy, Minerals & Natural Resources Department
OIL CONSERVATION DIVISION
1220 South St. Francis Dr.
Santa Fe, NM 87505

Form C-102

Revised June 10, 2003

Submit to Appropriate District Office

State Lease - 4 Copies

Fee Lease - 3 Copies

SEP 20 2004

Bureau of Land Management
Farmington Field Office

☐ AMENDED REPORT

District I

1625 N. French Dr., Hobbs, NM 88240

District II

1301 W. Grand Avenue, Artesia, NM 88210

District III

1000 Rio Brazos Rd., Aztec, NM 87410

District IV

1220 S. St. Francis Dr., Santa Fe, NM 87505

WELL LOCATION AND ACREAGE DEDICATION PLAT

API Number 30-039-29230		Pool Code 71629	Pool Name BASIN FRUITLAND COAL (GAS)
Property Code 31328	Property Name SAN JUAN 30-5 UNIT		Well Number 249A
OGRIID No. 217817	Operator Name CONOCOPHILLIPS COMPANY		Elevation 6820

Surface Location

UL or lot no.	Section	Township	Range	Lot	Feet from the	North/South line	Feet from the	East/West line	County
J	23	30N	05W	1447	1447	SOUTH	2492	EAST	RIO ARRIBA

Bottom Hole Location If Different From Surface

UL or lot no.	Section	Township	Range	Lot	Feet from the	North/South line	Feet from the	East/West line	County

Dedicated Acres 320.0	Joint or Infill	Consolidation Code	Order No.
--------------------------	-----------------	--------------------	-----------

East 1/2

NO ALLOWABLE WILL BE ASSIGNED TO THIS COMPLETION UNTIL ALL INTERESTS HAVE BEEN CONSOLIDATED OR A NON-STANDARD UNIT HAS BEEN APPROVED BY THE DIVISION

<p>16</p>	<p>17 OPERATOR CERTIFICATION</p> <p>I hereby certify that the information contained herein is true and complete to the best of my knowledge and belief.</p> <p><i>Vicki Westby (pf)</i> Signature Vicki Westby Printed Name Sr. Analyst Title and E-mail Address 9/17/04 Date</p> <p>18 SURVEYOR CERTIFICATION</p> <p>I hereby certify that the well location shown on this plat was plotted from field notes of actual surveys made by me or under my supervision, and that the same is true and correct to the best of my belief.</p> <p>Date of Survey: 9/17/04 Signature and Seal of Professional Surveyor Certificate Number: NM 11533</p>
-----------	--

Submit 3 Copies To Appropriate District Office

District I

1625 N. French Dr., Hobbs, NM 88240
District II
1301 W. Grand Ave., Artesia, NM 88210

District III

1000 Rio Brazos Rd., Aztec, NM 87410

District IV

1220 S. St. Francis Dr., Santa Fe, NM 87505

State of New Mexico
Energy, Minerals and Natural Resources

OIL CONSERVATION DIVISION

1220 South St. Francis Dr.
Santa Fe, NM 87505

Form C-103

May 27, 2004

WELL API NO. 30-039-29230	
5. Indicate Type of Lease STATE <input type="checkbox"/> FEE <input type="checkbox"/>	
6. State Oil & Gas Lease No.	
7. Lease Name or Unit Agreement Name SAN JUAN 30-5 UNIT	
8. Well Number	249A
9. OGRID Number	
10. Pool name or Wildcat BASIN FRUITLAND COAL	
Pit r Btl n% aj nlv I ink Appliktion <input type="checkbox"/> ir Closure <input type="checkbox"/>	
Pit type DRILL Depth to Groundwater 50-100' Distance from nearest fresh water well >1000' Distance from nearest surface water >200'	
Pit Liner Thickness: mil Below-Grade Tank: Volume bbbls Construction Material	

12. Check Appropriate Box to Indicate Nature of Notice, Report or Other Data

NOTICE OF INTENTION TO:

PERFORM REMEDIAL WORK ☐ PLUG AND ABANDON ☐
TEMPORARILY ABANDON ☐ CHANGE PLANS ☐
PULL OR ALTER CASING ☐ MULTIPLE COMPL ☐

OTHER: ☐

SUBSEQUENT REPORT OF:

REMEDIAL WORK ☐ ALTERING CASING ☐
COMMENCE DRILLING OPNS. ☐ PANDA ☐
CASING/CEMENT JOB ☐

OTHER: ☐

13. Describe proposed or completed operations. (Clearly state all pertinent details, and give pertinent dates, including estimated date of starting any proposed work). SEE RULE 11.03. For Multiple Completions: Attach wellbore diagram of proposed completion or recompletion.

ConocoPhillips Generic Pit Plan is on files at the NMOCD in Aztec, NM. See the attached diagram that details the location of the pit in reference to the proposed wellhead. The drill pit will be lined. The drill pit will be closed after the well has been completed. The solids left after the water has been disposed of will be sampled and NMOCD approval will be obtained prior to closure of this pit.

I hereby certify that the information above is true and complete to the best of my knowledge and belief. I further certify that any pit or below-grade tank has been/will be constructed or closed according to NMOCD guidelines ☒ a general permit ☐ or an (attached) alternative OCD-approved plan ☐

SIGNATURE

Vicki Westby

TITLE

Sr. Analyst

DATE 9/17/04

Type or print name

E-mail address:

Telephone No.

For State Use Only

APPROVED BY:

TITLE

DEPUTY OIL & GAS INSPECTOR, DIST. 40

DATE

MAY 11 2006

Conditions of Approval (if any):

CONOCOPHILLIPS COMPANY SAN JUAN 30-5 UNIT #249A
 1447' FSL & 2492' FEL, SECTION 23, T30N, R5W, NMPM
 RIO ARRIBA COUNTY, NEW MEXICO, ELEVATION: 6820'

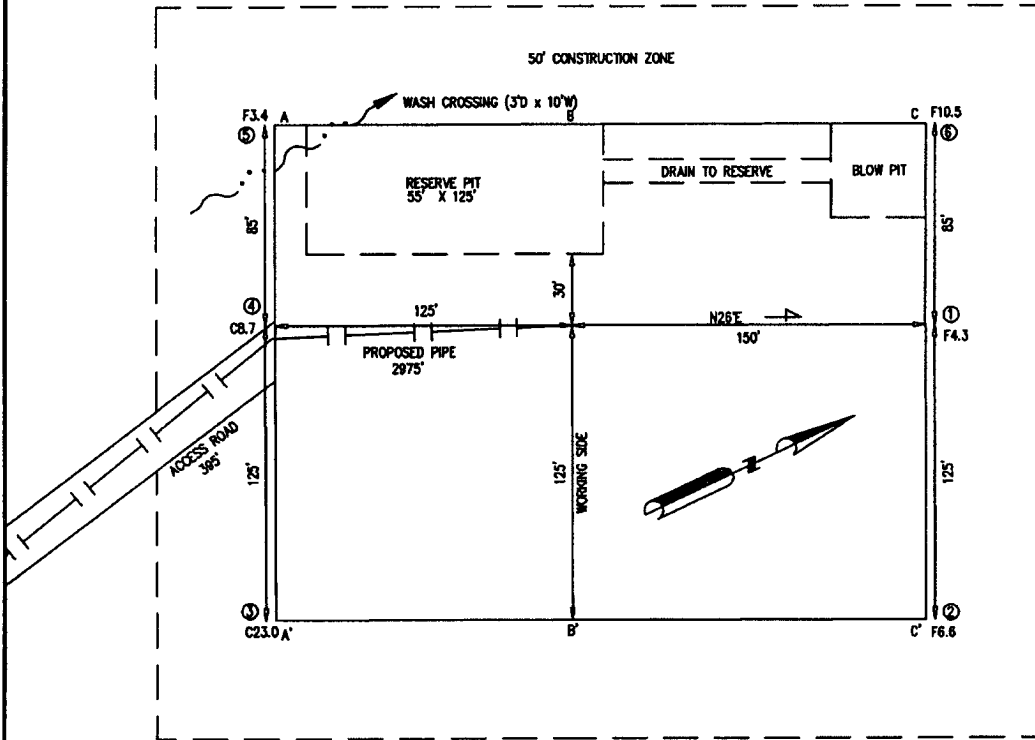

PLAT NOTE:

SURFACE OWNER
 BLM/FOREST SERVICE

NAD 27
 36 47 41.42
 107 19 32.27

LATITUDE: 36.79484° N
 LONGITUDE: 107.32623° W
 DATUM: WGS84

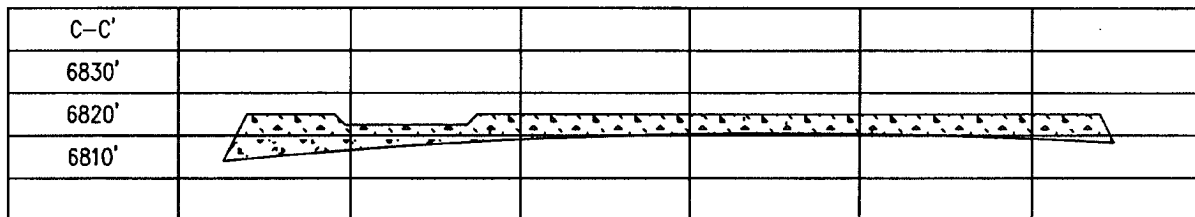
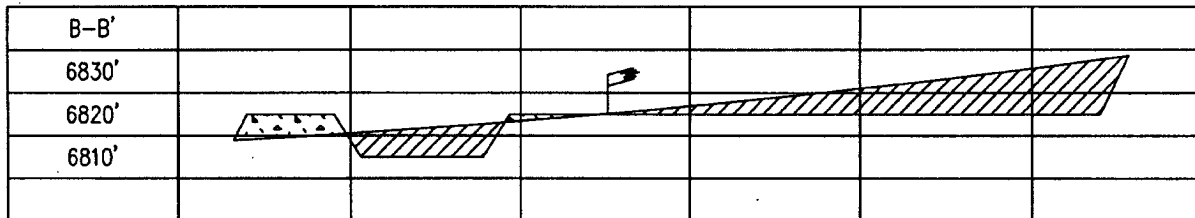
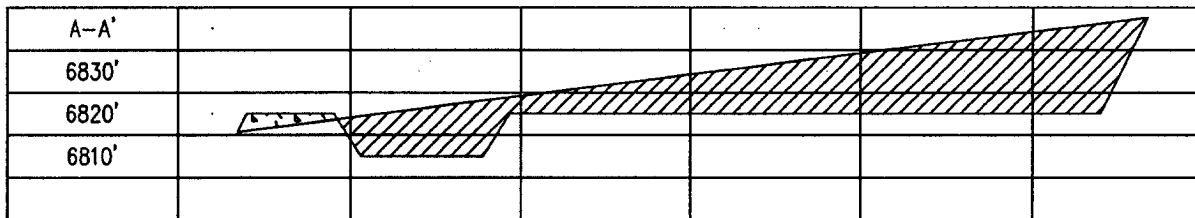



San Juan Business Unit

PROJECT PROPOSAL - New Drill / Sidetrack

SAN JUAN 30-5 249A

Lease:		AFE #:		AFE \$:	
Field Name: hPHILLIPS 30-5		Rig:	State: NM	County: RIO ARRIBA	API #:
Geoscientist: Cloud, Tom A		Phone: +1 832 486-2377	Prod. Engineer: Bergman, Pat W.		Phone: (832) 486-2358
Res. Engineer: Kolesar, James E.		Phone: (832) 486 - 2336	Proj. Field Lead:		Phone:
Primary Objective (Zones):					
Zone	Zone Name				
JCV	BASIN FRUITLAND COAL (GAS)				
Location: Surface					
Latitude: 36.79	Longitude: -107.33	X:	Y:	Section: 23	Range: 5W
Footage X: 2492 FEL	Footage Y: 1447 FSL	Elevation: 6820	(FT)	Township: 30N	
Tolerance:					
Location Type:		Start Date (Est.):	Completion Date:	Date In Operation:	
Formation Data: Assume KB = 6833 Units = FT					
Formation Call & Casing Points	Depth (TVD in Ft)	SS (Ft)	Depletion (Yes/No)	BHP (PSIG)	BHT
SAN JOSE	13	6820	<input type="checkbox"/>		
Surface Casing	213	6620	<input type="checkbox"/>		12-1/4 hole. 9 5/8" 32.3 ppf, H-40, STC casing. Circulate cement to surface.
NCMT	1833	5000	<input type="checkbox"/>		
OJAM	2983	3850	<input type="checkbox"/>		Possible water flows.
KRLD	3103	3730	<input type="checkbox"/>		
FRLD	3333	3500	<input type="checkbox"/>		Possible gas.
Intermediate Casing	3413	3420	<input type="checkbox"/>		8 3/4" Hole. 7", 20 ppf, J-55, STC Casing. Circulate cement to surface.
BASE MAIN COAL	3533	3300	<input type="checkbox"/>	325	
PC TONGUE	3583	3250	<input type="checkbox"/>		
Total Depth	3620	3213	<input type="checkbox"/>		6-1/4" hole possibly underreamed to 9.5". Optional Liner: 5.5", 15.5#, J-55 LTC - left uncemented.
BASE LOWEST COAL	3713	3120	<input type="checkbox"/>		
PCCF	3715	3118	<input type="checkbox"/>		
Reference Wells:					
Reference Type	Well Name	Comments			
Logging Program:					
Intermediate Logs:	<input type="checkbox"/> Log only if show <input type="checkbox"/> GR/ILD <input type="checkbox"/> Triple Combo				
TD Logs:	<input type="checkbox"/> Triple Combo <input type="checkbox"/> Dipmeter <input type="checkbox"/> RFT <input type="checkbox"/> Sonic <input type="checkbox"/> VSP <input type="checkbox"/> TDT				
Additional Information:					

Comments: Zones - Carson National Forest

General/Work Description - Carson National Forest

Mud Log from intermediate casing shoe to TD will be obtained.

Drilling Mud Program:

Surface: spud mud

Intermediate: fresh water mud with bentonite and polymer as needed

Below Intermediate: air/mist drilling media with foamer, polymer, & corrosion inhibitor as needed

Printed on: 9/16/2004 1:47:48 PM

TD includes 80 feet sump/rathole & COPC will comply with the BLM's Conditions of Approval for the proposed sump/rathole in this non-producing Pictured Cliffs formation.

San Juan 30-5 # 249A

SURFACE CASING :

Drill Bit Diameter	12.25"	
Casing Outside Diameter	9.625"	Casing Inside Diam. 9.001"
Casing Weight	32.3	ppf
Casing Grade	H-40	
Shoe Depth	230'	
Cement Yield	1.24	cuft/sk
Excess Cement	125	%
Cement Required	147	sx

SHOE 230', 9.625", 32.3 ppf, H-40 STC

INTERMEDIATE CASING :

Drill Bit Diameter	8.75"	
Casing Outside Diameter	7"	Casing Inside Diam. 6.456"
Casing Weight	20	ppf
Casing Grade	J-55	
Shoe Depth	3413'	
Lead Cement Yield	2.91	cuft/sk
Lead Cement Excess	160	%
Tail Cement Length	315'	
Tail Cement Yield	1.38	cuft/sk
Tail Cement Excess	160	%
Lead Cement Required	399	sx
Tail Cement Required	100	sx

LINER TOP 3393'

SHOE 3413', 7", 20 ppf, J-55

LINER BOTTOM 3620' (Uncemented)

San Juan 30-5 # 249A		
	Surf. Csg	Int. Csg
OD	9.625	7
ID	9.001	6.456
Depth	230	3413
Hole Diam	12.25	8.75
% Excess Lead		160
% Excess Tail	125	160
Lead Yield		2.91
Tail Yield	1.21	1.33
Ft of Tail Slurry	230	315
Top of Tail Slurry	0	3098
Top of Lead Slurry	N/A	0
Mud Wt (ppg)	8.9	9.0
Mud Type	WBM	WBM

Surface Casing						
	Ft	Cap	XS Factor	bbls	cuft	sx
Open Hole Annulus	230	0.055804	2.25	28.9	162.1	134.0
Shoe Track Volume	40	0.078735	1	3.1	17.7	13.3
Total				32.0	179.8	147.3

Intermediate Casing						
	Ft	Cap	XS Factor	bbls	cuft	sx
Lead Open Hole Annulus	2868	0.026786	2.6	199.7	1121.4	385.4
Lead Cased Hole Annulus	220	0.031116	1	6.8	38.4	13.2
Lead Total				206.6	1159.8	398.6
Tail Open Hole Annulus	315	0.026786	2.6	21.9	123.2	92.6
Tail Shoe Track Volume	42	0.040505	1	1.7	9.6	7.2
Tail Total				23.6	132.7	99.8

San Juan 30-5 # 249A		
9-5/8 Surface Casing		
Cement Recipe	Class C Standard Cement	
	+ 3% Calcium Chloride	
	+0.25 lb/sx Flocele	
Cement Volume	147	sc
Cement Yield	1.21	cuft/sx
Slurry Volume	179.8	cuft
	32.0	bbls
Cement Density	15.6	ppg
Water Required	5.29	gal/sx

San Juan 30-5 # 249A

7" Intermediate Casing		
Lead Slurry		
Cement Recipe	Standard Cement	
	+ 3% Econolite (Lost Circulation Additive)	
	+ 10 lb/sx Gilsonite (Lost Circ. Additive)	
	+ 0.25 lb/sx Flocele (Lost Circ. Additive)	
Cement Required	399	sx
Cement Yield	2.91	cuft/sx
Slurry Volume	1159.8	cuft
	206.6	bbls
Cement Density	11.5	ppg
Water Required	16.88	gal/sx

7" Intermediate Casing		
Tail Slurry		
Cement Slurry	50 / 50 POZ: Standard Cement	
	+ 2% Bentonite (Light Weight Additive)	
	+ 5 lbm/sk Gilsonite (Lost Circ. Additive)	
	+ 0.25 lbm/sk Flocele (lost Circ. Additive)	
	+ 2% Calcium Chloride (Accelerator)	
Cement Required	100	sx
Cement Yield	1.33	cuft/sx
Slurry Volume	132.7	cuft
	23.6	bbls
Cement Density	13.5	ppg
Water Required	5.36	gal/sx

San Juan 30-5 #249A

SURFACE CASING :

Drill Bit Diameter	12.25 "	
Casing Outside Diameter	9.625 "	9.001
Casing Weight	32.3 ppf	
Casing Grade	H-40	
Shoe Depth	230 '	40 '
Cement Yield	4.16 cuft/sk	
Excess Cement	125 %	
Casing Capacity	0.0787 bbl/ft	0.4419 cuft/ft
Hole / Casing Annulus Capacity	0.0558 bbl/ft	0.3132 cuft/ft

Cement Required 147 sx

SHOE 230 ', 9.625 ", 32.3 ppf, H-40

INTERMEDIATE CASING :

Drill Bit Diameter	8.75 "	
Casing Outside Diameter	7 "	6.456
Casing Weight	20 ppf	
Casing Grade	J-55	
Shoe Depth	3413 '	
Lead Cement Yield	2.61 cuft/sk	
Lead Cement Excess	160 %	
Tail Cement Length	300 '	42 '
Tail Cement Yield	1.27 cuft/sk	
Tail Cement Excess	160 %	
Casing Capacity	0.0405 bbl/ft	0.2273 cuft/ft
Casing / Casing Annulus Capacity	0.0311 bbl/ft	0.1746 cuft/ft
Hole / Casing Annulus Capacity	0.0268 bbl/ft	0.1503 cuft/ft

Lead Cement Required 447 sx

Tail Cement Required 100 sx

LINER TOP 3393 '

SHOE 3413 ', 7 ", 20 ppf, J-55

LINER BOTTOM 3620 ' (Uncemented)

BLOWOUT PREVENTER ARRANGEMENT & PROGRAM

For Drilling to Intermediate Casing Point & Setting 7" Intermediate Casing

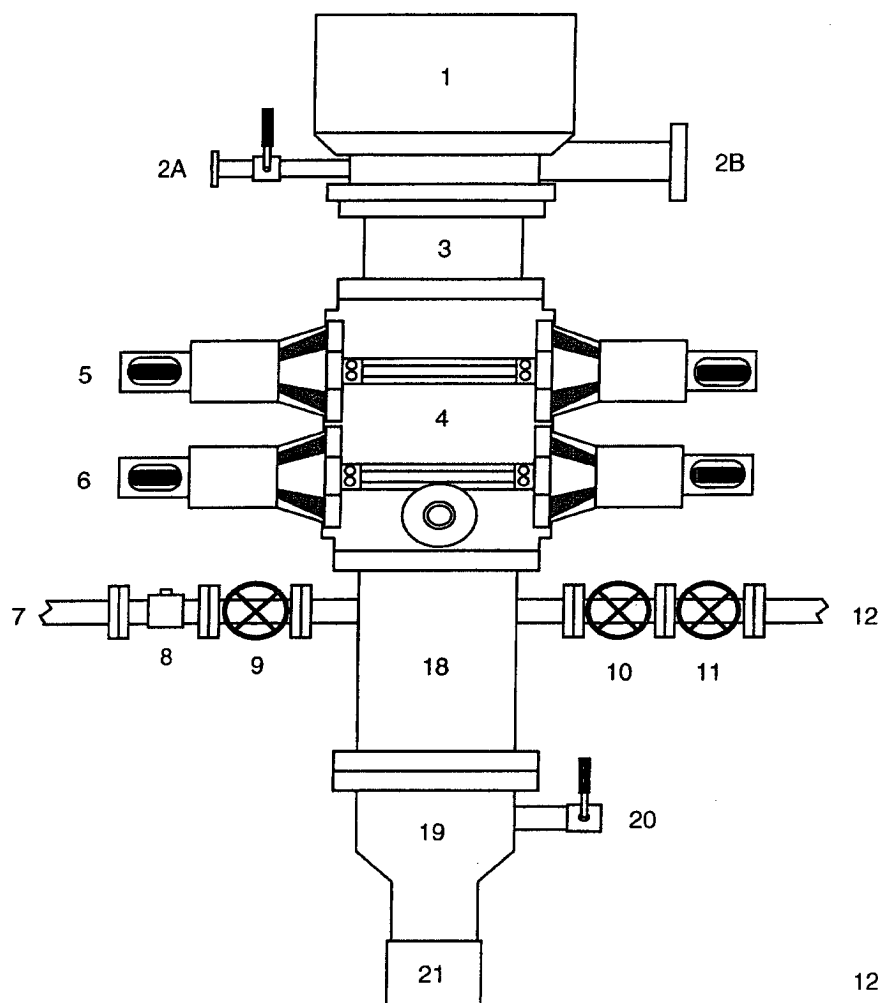

1. Rotating Head
- 2A. Fill-up Line & valve
- 2B. Flowline
3. Spacer Spool
4. Double Ram BOP (11", 3000 psi)
5. Pipe Rams
6. Blind Rams
7. Kill Line
8. Kill Line Check Valve
9. Kill Line Valve
10. Inner Choke Line Valve (3")
11. Outer Choke Line Valve (3")
12. Choke Line (3")
13. Variable Choke
14. Choke Line Valve (2")
15. Panic Line Valve (3")
16. Choke Manifold Pressure Gauge
17. Choke Line (2")
18. Mud Cross Spacer Spool
19. Casing Head "A" Section
20. Casing Head "A" Section 2" Valve
21. 9 5/8" Casing Collar

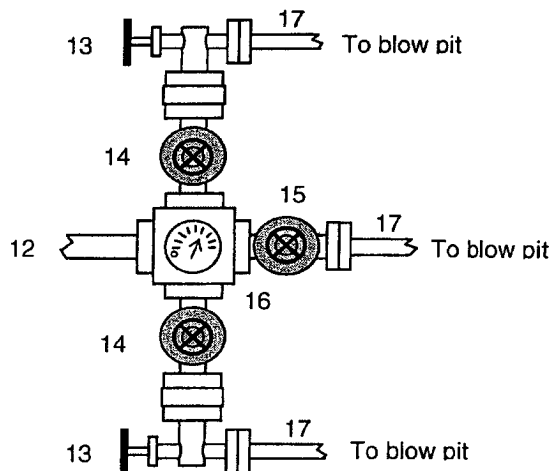

A 12-1/4" hole will be drilled to approximately 220' and the 9-5/8" surface casing will be run and cemented. The Casing Head "A" Section will be screwed onto the 9-5/8" surface casing stub. The BOP will be installed on the Casing Head "A" Section. A test plug will be set in the wellhead and the pipe rams and choke manifold will be tested to 200 psi to 300 psi (low pressure test) for 10 minutes and to 1000 psi (high pressure test) for 10 minutes. Then the test plug will be removed, and the **9-5/8" casing will be pressure tested** against closed blind rams to 200 psi to 300 psi for 10 minutes and to **1000 psi for 30 minutes** (this value is one 44% of the minimum internal yield pressure of the 9-5/8" casing). (Note: per regulatory requirements we will wait on cement at least 8 hrs after placement before testing the 9-5/8" surface casing). Then an 8-3/4" hole will be drilled to intermediate casing point and 7" intermediate casing will be run and cemented.

In addition to the equipment in the above diagram the following equipment will comprise the BOP system:

1. Upper Kelly cock Valve with handle
2. Stab-in TIW valve for all drillstrings in use

BLOWOUT PREVENTER ARRANGEMENT & PROGRAM

For Cavitation Program

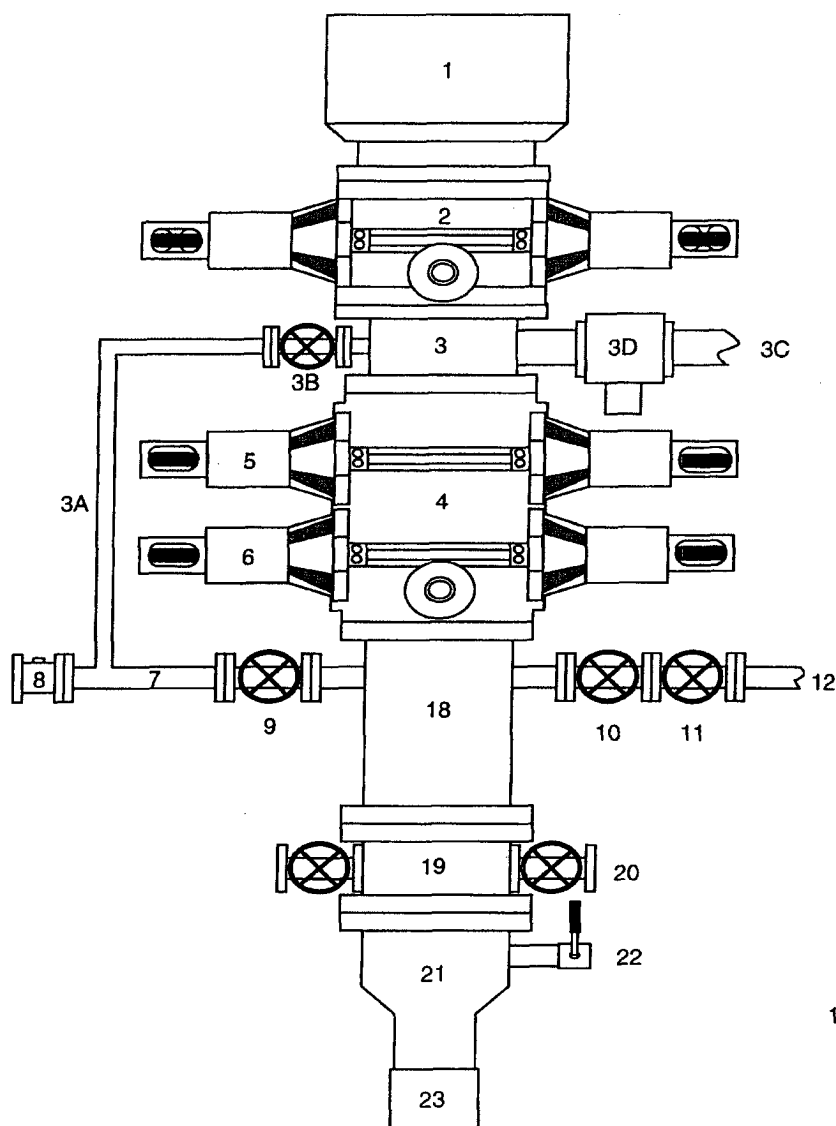

1. Stripping Head
2. Single Ram BOP (7-1/16", 3M)
3. Mud Cross
- 3A. Equalizing Line (2")
- 3B. Wing Valve (2-1/16", 3M)
- 3C. Blooie Line (2 ea, 5" OD)
- 3D. HCR Valve (1 ea per line, 4-1/16")
4. Double Ram BOP (7-1/16", 3M)
5. Pipe Rams
6. Blind Rams
7. Kill Line
8. Kill Line Check Valve
9. Kill Line Valve
10. Inner Choke Line Valve (3")
11. Outer Choke Line Valve (3")
12. Choke Line (3")
13. Variable Choke
14. Choke Line Valve (2")
15. Panic Line Valve (3")
16. Choke Manifold Pressure Gauge
17. Vent Line (2")
18. Spacer Spool
19. Tubing Head
20. Tubing Head Valves (2- 9/16")
21. Casing Head "A" Section
22. Casing Head "A" Section 2" Valve
23. 9-5/8" Casing Collar

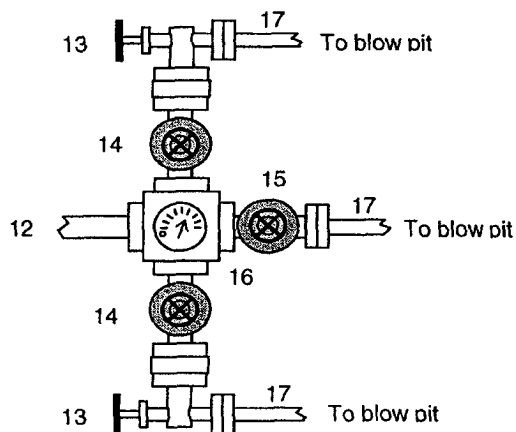

This BOP arrangement and test program is for the cavitation program. The BOP will be installed on the tubing head. The 7" casing will be pressure tested against closed blind rams to 200 psi to 300 psi for 10 minutes and to 1800 psi for 30 minutes - this test pressure is 48% of the minimum internal yield strength of 3740 psi for the 7", 20#, J-55, STC casing. The pipe rams and choke manifold will be tested to 200 psi to 300 psi (low pressure test) for 10 minutes and to 1800 psi (high pressure test) for 10 minutes - This test will be done with a test plug or possibly without a test plug (ie against casing). If we conduct this test without a test plug we will ensure that we have sufficient drillstring weight in the hole to exceed the upward force generated by the test.

We use a power swivel and air/mist to drill the 6-1/4" hole in our cavitation program. We do not use a kelly. In addition to the equipment in the above diagram the following equipment will comprise the BOP system:

1. String floats will be used inside the drillpipe
2. Stab-in TIW valve for all drillstrings in use
3. Each blooie line is equipped with a hydraulically controlled valve (HCR valve).