

Submit 3 Copies To Appropriate District Office.
District I
1625 N. French Dr., Hobbs, NM 88240
District II
1301 W. Grand Ave., Artesia, NM 88210
District III
1000 Rio Brazos Rd., Aztec, NM 87410
District IV
1220 S. St. Francis Dr., Santa Fe, NM 87505

State of New Mexico
Energy, Minerals and Natural Resources

Form C-103
May 27, 2004

OIL CONSERVATION DIVISION
1220 South St. Francis Dr.
Santa Fe, NM 87505

SUNDRY NOTICES AND REPORTS ON WELLS (DO NOT USE THIS FORM FOR PROPOSALS TO DRILL OR TO DEEPEN OR PLUG BACK TO A DIFFERENT RESERVOIR. USE "APPLICATION FOR PERMIT" (FORM C-101) FOR SUCH PROPOSALS.)		WELL API NO. 30-039-24642
1. Type of Well: Oil Well <input type="checkbox"/> Gas Well <input checked="" type="checkbox"/> Other <input type="checkbox"/>		5. Indicate Type of Lease STATE <input type="checkbox"/> FEE <input checked="" type="checkbox"/>
2. Name of Operator BLACK HILLS GAS RESOURCES, INC.		6. State Oil & Gas Lease No.
3. Address of Operator: c/o Agent, Mike Pippin LLC 3104 N. Sullivan, Farmington, NM 87401 505-327-4573		7. Lease Name or Unit Agreement Name SIMMS COM 1876
4. Well Location Unit Letter <u>B</u> : <u>790</u> feet from the <u>North</u> line and <u>1500</u> feet from the <u>East</u> line Section <u>24</u> Township <u>30N</u> Range <u>4W</u> NMPM Rio Arriba County		8. Well Number: #6
11. Elevation (Show whether DR, RKB, RT, GR, etc.) 7068' GL		9. OGRID Number: 013925
Pit or Below-grade Tank Application <input type="checkbox"/> or Closure <input type="checkbox"/>		10. Pool name or Wildcat East Blanco Pictured Cliffs <u>72400 NE/4</u>
Pit type _____ Depth to Groundwater _____ Distance from nearest fresh water well _____ Distance from nearest surface water _____		
Pit Liner Thickness: <u>12</u> mil Below-Grade Tank: Volume _____ bbls; Construction Material _____		

12. Check Appropriate Box to Indicate Nature of Notice, Report or Other Data

NOTICE OF INTENTION TO:
PERFORM REMEDIAL WORK ☐ PLUG AND ABANDON ☐
TEMPORARILY ABANDON ☐ CHANGE PLANS ☐
PULL OR ALTER CASING ☐ MULTIPLE COMPL ☐

SUBSEQUENT REPORT OF:
REMEDIAL WORK ☐ ALTERING CASING ☐
COMMENCE DRILLING OPNS. ☐ P AND A ☐
CASING/CEMENT JOB ☐

OTHER: ☐

OTHER: RECOMPLETE TO PICTURED CLIFFS ☒

13. Describe proposed or completed operations. (Clearly state all pertinent details, and give pertinent dates, including estimated date of starting any proposed work). SEE RULE 1103. For Multiple Completions: Attach wellbore diagram of proposed completion or recompletion.

This is part of the Black Hills Permit Clean-up Program.

9/13/05: MIRUSU. TIH w/pkr & set @ 3735'. Pressure test from 3735' to 4000' to 1500 psi-OK. Reset pkr @ 3550'. Pressure test from 3550'-surface to 1500 psi-OK. Sq FRTC perfs w/41 sx cmt. Drill out cmt & pressure test sq job to 600 psi-OK.

Perf PC @ 3746'-52', 3755'-57', 3762'-66', 3768'-70' w/2-0.41" spf. Frac PC down 2-7/8" N-80 frac string w/67,180# sand in 75Q slick foam. Clean out after frac to PBTD 4039'. Land 2-3/8" 4.7# J-55 tbg @ 3756' w/1.78" "R" nipple @ 3746'. Release rig 9/23/05.



I hereby certify that the information above is true and complete to the best of my knowledge and belief. I further certify that any pit or below-grade tank has been/will be constructed or closed according to NMOCD guidelines ☒ a general permit ☐ or an (attached) alternative OCD-approved plan ☐.

SIGNATURE Mike Pippin TITLE Agent, Petroleum Engineer DATE 6/15/06
Type or print name Mike Pippin E-mail address: mike@pippinllc.com Telephone No.: 505-327-4573

For State Use Only
APPROVED BY: H. Villanueva
Conditions of Approval (if any):

DEPUTY OIL & GAS INSPECTOR, DIST. 8 DATE JUN 16 2006

Submit to Appropriate
District Office
State Lease - 4 copies
Fed Lease - 3 copies

State of New Mexico
Energy, Minerals and Natural Resources Department

Form C-102
Revised 1-1-89

OIL CONSERVATION DIVISION
P.O. Box 2088
Santa Fe, New Mexico 87504-2088

DISTRICT I
P.O. Box 1980, Hobbs, NM 88240

DISTRICT II
P.O. Box 100, Artesia, NM 88210

DISTRICT III
5000 Rio Grande Rd., Aztec, NM 87410

WELL LOCATION AND ACREAGE DEDICATION PLAT

All Distances must be from the outer boundaries of the section

Operator Black Hills Gas Resources			Lease SIMS COM		Well No. 6
Unit Letter B	Section 24	Township 30 N	Range 4 W	County NMPM Rio Arriba	
Actual Footage Location of Well: 790 feet from the North line and 1500 feet from the East line					
Ground level Elev. 7068	Production Formation Pictured Cliffs	Pool East Blanco Pictured Cliffs		Dedicated Acreage: 160 NE/4 Acres	
<p>1. Outline the acreage dedicated to the subject well by colored pencil or hatchure marks on the plat below.</p> <p>2. If more than one lease is dedicated to the well, outline each and identify the ownership thereof (both as to working interest and royalty).</p> <p>3. If more than one lease of different ownership is dedicated to the well, have the interest of all owners been consolidated by communication, unitization, force-pooling, etc.? <input type="checkbox"/> Yes <input type="checkbox"/> No If answer is "yes" type of consolidation COMMUNITIZATION</p> <p>If answer is "no" list the owners and tract descriptions which have actually been consolidated. (Use reverse side of this form if necessary.)</p> <p>No allowable will be assigned to the well until all interests have been consolidated (by communication, unitization, force-pooling, or otherwise) or until a non-standard well, eliminating such interest, has been approved by the Division.</p>					

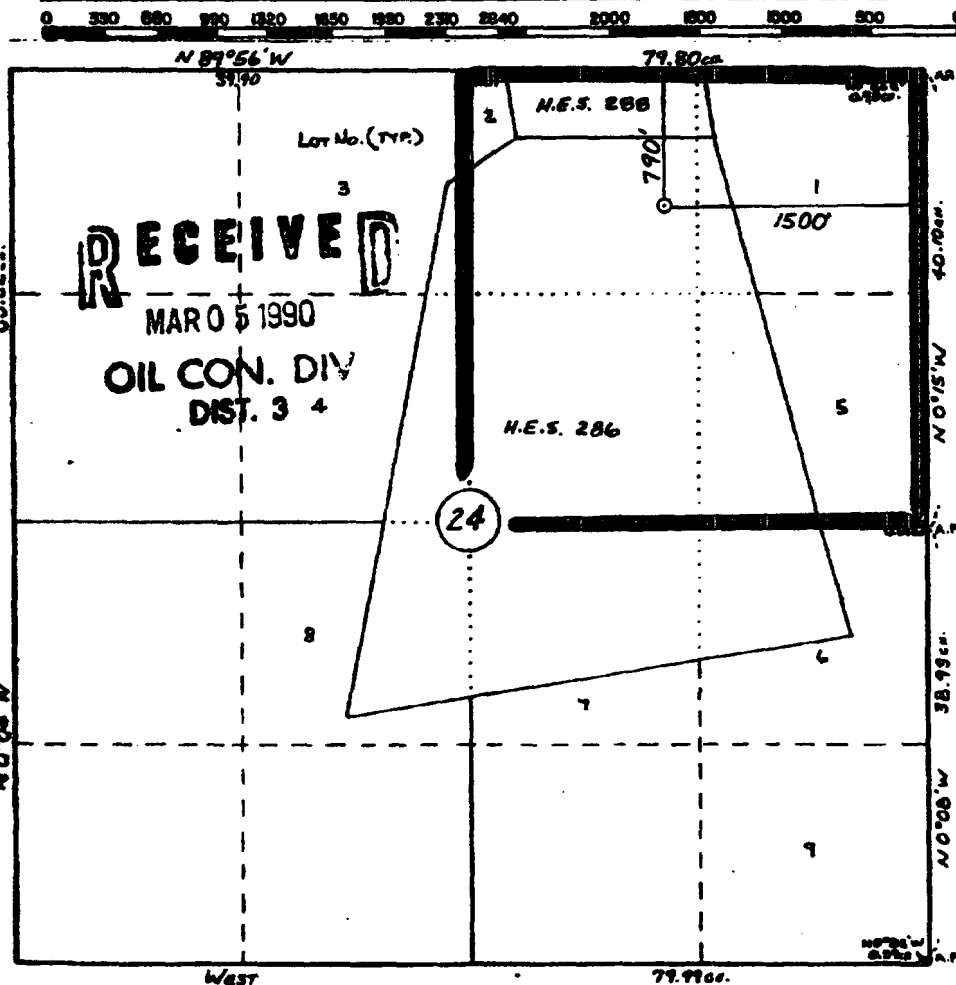

OPERATOR CERTIFICATION

I hereby certify that the information contained herein is true and complete to the best of my knowledge and belief.

Sig *Mike Pippin*
Printed Name **Mike Pippin**
Position **Petroleum Engineer**
Company **Agent - Black Hills**
Date **6/15/06**

SURVEYOR CERTIFICATION

I hereby certify that the well location shown on this plat was plotted from field notes of actual surveys made by me or under my supervision, and that the same is true and correct to the best of my knowledge and belief.

2-1-90

Date Surveyed
William E. Mahnke II

Signature *WILLIAM E. MAHNKE II*
Professional Land Surveyor
New Mexico
#8466
8466
PROFESSIONAL LAND SURVEYOR