

District I
1625 N. French Dr., Hobbs, NM 88240
District II
1301 W. Grand Avenue, Artesia, NM 88210
District III
1000 Rio Brazos Road, Aztec, NM 87410

State of New Mexico
Energy Minerals and Natural Resources

Form C-144
June 1, 2004

District IV
1220 S. St. Francis Dr., Santa Fe, NM 87505

Oil Conservation Division
1220 South St. Francis Dr.
Santa Fe, NM 87505

For drilling and production facilities, submit to
appropriate NMOCD District Office.
For downstream facilities, submit to Santa Fe
office

Pit or Below-Grade Tank Registration or Closure

Is pit or below-grade tank covered by a "general plan"? Yes ☒ No ☐

Type of action: Registration of a pit or below-grade tank ☐ Closure of a pit or below-grade tank ☒

Operator: <u>XTO ENERGY INC.</u> Telephone: <u>(505)-324-1090</u> e-mail address: _____	
Address: <u>2700 FARMINGTON AVE.. BLDG. K. SUITE 1. FARMINGTON. NM 87401</u>	
Facility or well name: <u>BELL, J. F. #2E</u>	API #: <u>30-045- 25266</u> U/L or Qtr/Qtr <u>P</u> Sec <u>3</u> T <u>30N</u> R <u>13W</u>
County: <u>SAN JUAN</u> Latitude <u>36.83735</u> Longitude <u>108.18597</u> NAD: 1927 <input type="checkbox"/> 1983 <input checked="" type="checkbox"/> Surface Owner Federal <input checked="" type="checkbox"/> State <input type="checkbox"/> Private <input type="checkbox"/> Indian <input type="checkbox"/>	
Pit Type: Drilling <input type="checkbox"/> Production <input type="checkbox"/> Disposal <input checked="" type="checkbox"/> <u>ABANDONED</u> Workover <input type="checkbox"/> Emergency <input type="checkbox"/> Lined <input type="checkbox"/> Unlined <input checked="" type="checkbox"/> Liner type: Synthetic <input type="checkbox"/> Thickness _____ mil Clay <input type="checkbox"/> Pit Volume _____ bbl	Below-grade tank Volume: _____ bbl Type of fluid: _____ Construction material: <u>NA</u> Double-walled, with leak detection? Yes <input type="checkbox"/> If <u>NA</u> , explain why not. _____
Depth to ground water (vertical distance from bottom of pit to seasonal high water elevation of ground water.)	Less than 50 feet (20 points) 50 feet or more, but less than 100 feet (10 points) 0 100 feet or more (0 points)
Wellhead protection area: (Less than 200 feet from a private domestic water source, or less than 1000 feet from all other water sources.)	Yes (20 points) No (0 points) 0
Distance to surface water: (horizontal distance to all wetlands, playas, irrigation canals, ditches, and perennial and ephemeral watercourses.)	Less than 200 feet (20 points) 200 feet or more, but less than 1000 feet (10 points) 10 1000 feet or more (0 points)
Ranking Score (Total Points) 10	

If this is a pit closure: (1) attach a diagram of the facility showing the pit's relationship to other equipment and tanks. (2) Indicate disposal location: (check the onsite box if you are burying in place) onsite ☒ offsite ☐ If offsite, name of facility _____. (3) Attach a general description of remedial action taken including remediation start date and end date. (4) Groundwater encountered: No ☒ Yes ☐ If yes, show depth below ground surface _____ ft. and attach sample results. (5) Attach soil sample results and a diagram of sample locations and excavations.

Additional Comments: <u>PIT LOCATED APPROXIMATELY 150 FT. N10W FROM WELL HEAD</u>
<u>PIT EXCAVATION: WIDTH NA ft., LENGTH NA ft., DEPTH NA ft.</u>
<u>PIT REMEDIATION: CLOSE AS IS: <input checked="" type="checkbox"/>, LANDFARM: <input type="checkbox"/>, COMPOST: <input type="checkbox"/>, STOCKPILE: <input type="checkbox"/>, OTHER <input type="checkbox"/> (explain)</u>
Cubic yards: <u>NA</u>

I hereby certify that the information above is true and complete to the best of my knowledge and belief. I further certify that the above-described pit or below-grade tank has been/will be constructed or closed according to NMOCD guidelines ☒, a general permit ☐, or an alternative OCD-approved plan ☒.

Date: 12/01/04

Printed Name/Title Jeff Blagg – P.E. # 11607 Signature Jeff Blagg

Your certification and NMOCD approval of this application/closure does not relieve the operator of liability should the contents of the pit or tank contaminate ground water or otherwise endanger public health or the environment. Nor does it relieve the operator of its responsibility for compliance with any other federal, state, or local laws and/or regulations.

Approval: DEPUTY OIL & GAS INSPECTOR, DIST. 4 Signature Bruce D. Smith Date: MAR 27 2006

CLIENT: XTO
BLAGG ENGINEERING, INC.
P.O. BOX 87, BLOOMFIELD, NM 87413
(505) 632-1199
LOCATION NO: CT 126COCR NO: 13317**FIELD REPORT: PIT CLOSURE VERIFICATION**PAGE No: 1 of 1
 LOCATION: NAME: J.F. BELL WELL #: 2E TYPE: ABANDON
 QUAD/UNIT: P SEC: 3 TWP: 30N RNG: 13W PM: NM CNTY: SJ ST: NM
 QTR/FOOTAGE: 940'S/1020'E EISE CONTRACTOR: NONE

 DATE STARTED: 11-30-04
 DATE FINISHED: 11-30-04
ENVIRONMENTAL SPECIALIST: JCBEXCAVATION APPROX. NA FT. x NA FT. x NA FT. DEEP. CUBIC YARDAGE: 0DISPOSAL FACILITY: NA REMEDIATION METHOD: CLOSE AS ISLAND USE: RANGE - BLM LEASE: NM-028226 C FORMATION: DK**FIELD NOTES & REMARKS:**PIT LOCATED APPROXIMATELY 150 FT. N10W FROM WELLHEAD.DEPTH TO GROUNDWATER: >100 NEAREST WATER SOURCE: >1000 NEAREST SURFACE WATER: <1000NMOCD RANKING SCORE: 10 NMOCD TPH CLOSURE STD: 1000 PPM**SOIL AND EXCAVATION DESCRIPTION:**
 OVM CALIB. READ. = 52.7 ppm
 OVM CALIB. GAS = 100 ppm RF = 0.52
 TIME: 1430 am/pm DATE: 11-30-04
SOIL TYPE: SAND / SILTY SAND / SILT / SILTY CLAY / CLAY / GRAVEL / OTHERSOIL COLOR: Yellow TanCOHESION (ALL OTHERS): NON COHESIVE / SLIGHTLY COHESIVE / COHESIVE / HIGHLY COHESIVECONSISTENCY (NON COHESIVE SOILS): LOOSE / FIRM / DENSE / VERY DENSE

PLASTICITY (CLAYS): NON PLASTIC / SLIGHTLY PLASTIC / COHESIVE / MEDIUM PLASTIC / HIGHLY PLASTIC

DENSITY (COHESIVE CLAYS & SILTS): SOFT / FIRM / STIFF / VERY STIFF / HARD

MOISTURE: DRY / SLIGHTLY MOIST / MOIST / WET / SATURATED / SUPER SATURATEDDISCOLORATION/STAINING OBSERVED: YES NO EXPLANATION - @ 4' BG - 4 1/2' BG TH #1 ONLYHC ODOR DETECTED: YES / NO EXPLANATION -SAMPLE TYPE: GRAB COMPOSITE - # OF PTS. —

ADDITIONAL COMMENTS:

ABANDON PIT - Full-Filled in w/ sediment from ARRIDO Runoff. USE HAND Auger to test. ORIGINAL Pit Bottom ~ 4' BG - THIN BENT. LAYER @ that depth.
FIELD 418.1 CALCULATIONS**SCALE**

0 FT

N

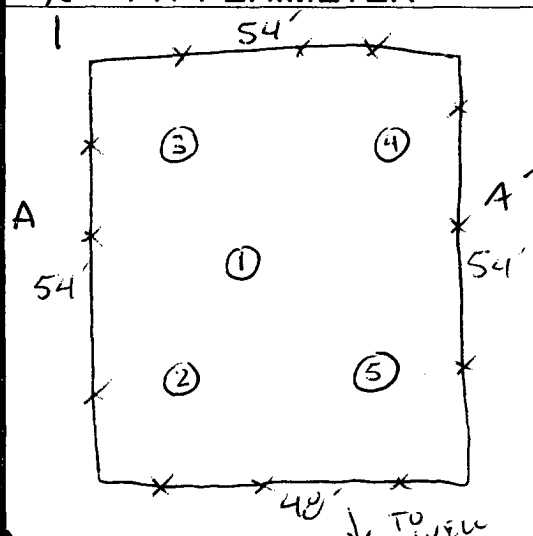
PIT PERIMETER**OVM READING**

SAMPLE ID	FIELD HEADSPACE (ppm)
1 @ 4'	44
2 @ 6 1/2'	0.0
3 @ 6 1/2'	0.0
4 @ 6 1/2'	0.0
5 @ 7'	0.0
1 @ 7'	11

LAB SAMPLES

SAMPLE ID	ANALYSIS	TIME
1 @ 7'	TPH	1340
	<u>PASSED</u>	

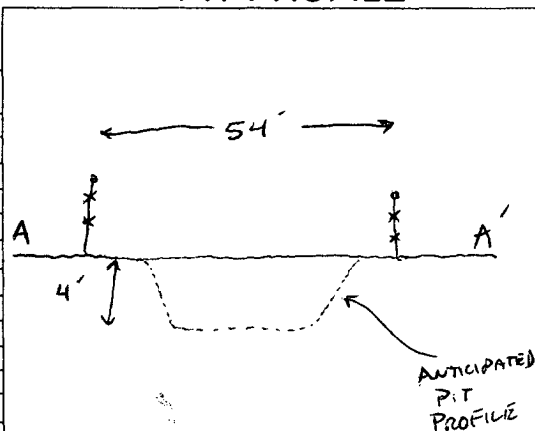
PIT PROFILE
 P.D. = PIT DEPRESSION; B.G. = BELOW GRADE; B = BELOW
 T.H. = TEST HOLE; ~ = APPROX; T.B. = TANK BOTTOM

TRAVEL NOTES:

CALLOUT: 11-30-04ONSITE: 11-30-04

ENVIROTECH LABS

PRACTICAL SOLUTIONS FOR A BETTER TOMORROW

EPA METHOD 8015 Modified Nonhalogenated Volatile Organics Total Petroleum Hydrocarbons

Client:	Blagg / XTO	Project #:	94034-010
Sample ID:	1 @ 7'	Date Reported:	12-01-04
Laboratory Number:	31327	Date Sampled:	11-30-04
Chain of Custody No:	13317	Date Received:	12-01-04
Sample Matrix:	Soil	Date Extracted:	12-01-04
Preservative:	Cool	Date Analyzed:	12-01-04
Condition:	Cool and Intact	Analysis Requested:	8015 TPH

Parameter	Concentration (mg/Kg)	Det. Limit (mg/Kg)
Gasoline Range (C5 - C10)	ND	0.2
Diesel Range (C10 - C28)	ND	0.1
Total Petroleum Hydrocarbons	ND	0.2

ND - Parameter not detected at the stated detection limit.

References: Method 8015B, Nonhalogenated Volatile Organics, Test Methods for Evaluating Solid Waste, SW-846, USEPA, December 1996.

Comments: J. F. Bell #2E Abandon Pit.

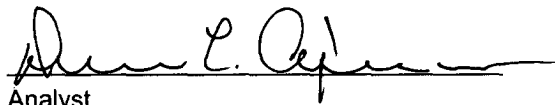
Analyst

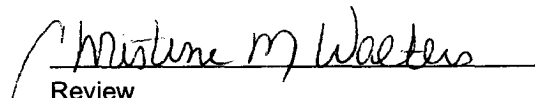
Review