

**UNITED STATES
DEPARTMENT OF THE INTERIOR
BUREAU OF LAND MANAGEMENT**

Sundry Notices and Reports on Wells

1. Type of Well
GAS

2. Name of Operator
CONOCOPHILLIPS

3. Address & Phone No. of Operator

PO Box 4289, Farmington, NM 87499 (505) 326-9700

4. Location of Well, Footage, Sec., T, R, M

Surf. Unit B (NWNE), 100' FNL & 1330' FEL, Section 3, T30N, R6W, NMPM

Proposed BH - Unit O (SWSE), 1000' FSL & 1430' FEL, Sec. 34, T31N, R6W, NMPM

2006 JUN 27 8M 9 45

Lease Number

NMSF-078999

If Indian, All. or

Tribe Name

7. Unit Agreement Name

San Juan 31-6 Unit

8. Well Name & Number

SJ 31-6 Unit #218A

9. API Well No.

30-039-29422

10. Field and Pool

Basin FC

Rio Arriba Co., NM

12. CHECK APPROPRIATE BOX TO INDICATE NATURE OF NOTICE, REPORT, OTHER DATA

Type of Submission

☒ Notice of Intent

☐ Subsequent Report

☐ Final Abandonment

Type of Action

☐ Abandonment

☐ Recompletion

☐ Plugging

☐ Casing Repair

☐ Altering Casing

☐ Change of Plans

☐ New Construction

☐ Non-Routine Fracturing

☐ Water Shut off

☐ Conversion to Injection

☒ Other

13. Describe Proposed or Completed Operations

A few of the pages in the APD don't reflect the correct information. Please find the following information to make the APD reflect the correct information pertaining to the location of the well. The cut & fill diagram, directions to the well, proposed p/i route, emergency response area, cathodic protection plan. The arch and EA reports submitted for the APD were for the correct footages and the Conditions of Approval have the right footages.

14. I hereby certify that the foregoing is true and correct.

Signed

Patsy Clugston

Patsy Clugston

Title Sr. Regulatory Specialist

Date 6/23/06

(This space for Federal or State Office use)

APPROVED BY Original Signed: Stephen Mason Title _____

Date JUN 23 2006

CONDITION OF APPROVAL, if any:

Title 18 U.S.C. Section 1001, makes it a crime for any person knowingly and willfully to make any department or agency of the United States any false, fictitious or fraudulent statements or representations as to any matter within its jurisdiction

NMOCD

g

CONOCOPHILLIPS COMPANY SAN JUAN 31-6 UNIT #218A
 100' FNL & 1330' FEL, SECTION 3, T30N, R06W, NMPM
 RIO ARRIBA COUNTY, NEW MEXICO ELEVATION: 6443'

LATITUDE: 36.84856° N
 LONGITUDE: 107.44517° W
 DATUM: NAD27

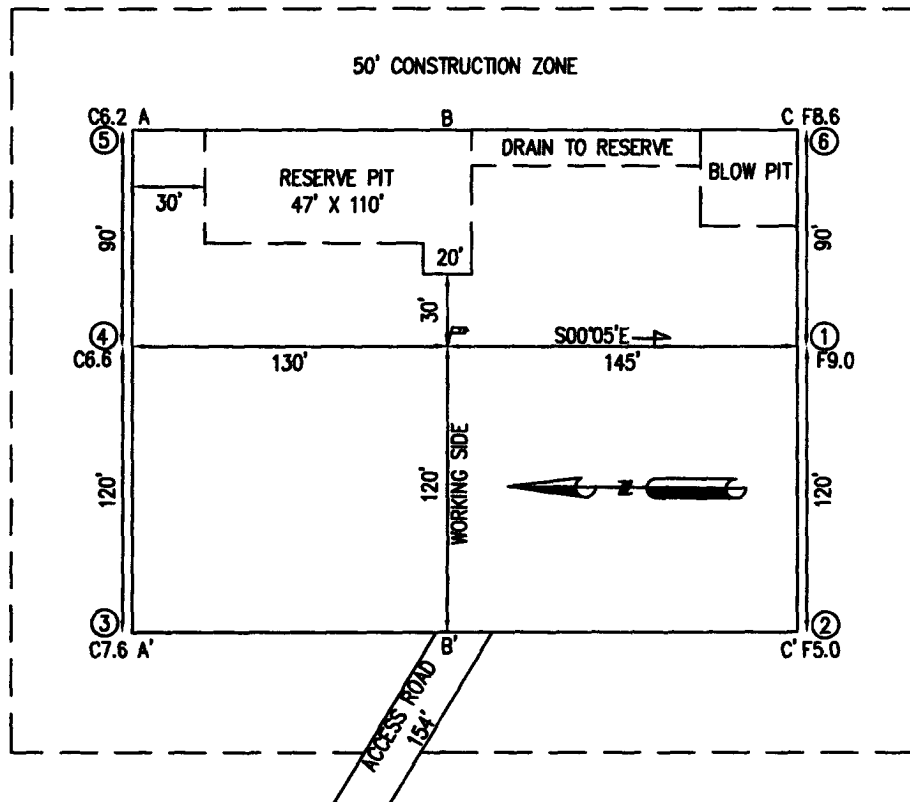

PLAT NOTE:
 SURFACE OWNER
 BLM

A-A'						
6453'						
6443'						
6433'						

B-B'						
6453'						
6443'						
6433'						

C-C'						
6453'						
6443'						
6433'						