

District I  
1625 N. French Dr., Hobbs, NM 88240  
District II  
1301 W. Grand Avenue, Artesia, NM 88210  
District III  
1000 Rio Brazos Road, Aztec, NM 87410  
District IV  
1220 S. St. Francis Dr., Santa Fe, NM 87505

State of New Mexico  
Energy Minerals and Natural Resources

Form C-144  
June 1, 2004

Oil Conservation Division  
1220 South St. Francis Dr.  
Santa Fe, NM 87505

For drilling and production facilities, submit to appropriate NMOCD District Office.  
For downstream facilities, submit to Santa Fe office

**Pit or Below-Grade Tank Registration or Closure**

Is pit or below-grade tank covered by a "general plan"? Yes ☒ No ☐

Type of action: Registration of a pit or below-grade tank ☐ Closure of a pit or below-grade tank ☒

Operator: Pure Resources Telephone: 970-259-1374 e-mail address: \_\_\_\_\_  
Address: 463 Turner Drive, Durango CO 81303 Facility or well name: Rincon 295 API #: 300 3924716 U/LH 1645 FNL/ 1125 FEL Sec 11 T 26N R 7W  
County: Rio Arriba Latitude \_\_\_\_\_ Longitude \_\_\_\_\_ NAD: 1927 ☐ 1983 ☐  
Surface Owner: Federal ☒ State ☐ Private ☐ Indian ☐

**Pit**

Type: Drilling ☐ Production ☒ Disposal ☐

Workover ☐ Emergency ☐

Lined ☐ Unlined ☒

Liner type: Synthetic ☐ Thickness \_\_\_\_\_ mil Clay ☐

Pit Volume \_\_\_\_\_ bbl

**Below-grade tank**

Volume: \_\_\_\_\_ bbl Type of fluid: \_\_\_\_\_

Construction material: \_\_\_\_\_

Double-walled, with leak detection? Yes ☐ If not, explain why not. \_\_\_\_\_

Depth to ground water (vertical distance from bottom of pit to seasonal high water elevation of ground water.)

Less than 50 feet

(20 points)

50 feet or more, but less than 100 feet

(10 points)

100 feet or more X

( 0 points) X

Wellhead protection area: (Less than 200 feet from a private domestic water source, or less than 1000 feet from all other water sources.)

Yes

(20 points)

No X

( 0 points) X

Distance to surface water: (horizontal distance to all wetlands, playas, irrigation canals, ditches, and perennial and ephemeral watercourses.)

Less than 200 feet

(20 points)

200 feet or more, but less than 1000 feet

(10 points)

1000 feet or more X

( 0 points) X

**Ranking Score (Total Points)**

0

- If this is a pit closure:** (1) Attach a diagram of the facility showing the pit's relationship to other equipment and tanks. (2) Indicate disposal location: (check the onsite box if you are burying in place) onsite ☒ offsite ☐ If offsite, name of facility: \_\_\_\_\_ (3) Attach a general description of remedial action taken including remediation start date and end date. (4) Groundwater encountered: No ☒ Yes ☐ If yes, show depth below ground surface \_\_\_\_\_ ft. and attach sample results. (5) Attach soil sample results and a diagram of sample locations and excavations.

Additional Comments: Decommissioned Separator Pit. Separator was removed.

I hereby certify that the information above is true and complete to the best of my knowledge and belief. I further certify that the above-described pit or below-grade tank has been/will be constructed or closed according to NMOCD guidelines ☒, a general permit ☐, or an (attached) alternative OCD-approved plan ☐.

Date: 9/30/05

Printed Name/Title John Hagstrom as Agent for Pure Resources

Signature [Signature]

Your certification and NMOCD approval of this application/closure does not relieve the operator of liability should the contents of the pit or tank contaminate ground water or otherwise endanger public health or the environment. Nor does it relieve the operator of its responsibility for compliance with any other federal, state, or local laws and/or regulations.

Approval:

Printed Name/Title DEPUTY OIL & GAS INSPECTOR, DIST. 03

Signature [Signature]

Date: JUL 21 2006



June 27, 2005

SMA Project: 5115310

RE: Sampling activities for Pit Closure at the Rincon 295. Unit h, Sec. 11, T 26N, R 7W, Fruitland Coal, Rio Arriba County NM. Fed Lease SF079160. API 3003924716.

On June 14, 2005, SMA mobilized to the unlined separator pit at the Rincon 295. The dimensions of the unlined pit are approximately 20 X 20 X 4 feet.

On June 14, 2005, SMA collected a soil sample from the center pit bottom for field analysis by Photo Ionization Detector (PID). A four-point composite soil sample was collected from the sidewalls for field analysis by PID. The center pit bottom sample showed a PID reading of 37.3 units and the sidewall composite sample showed a PID reading of 33.8 units. Soil samples for closure were collected for laboratory analysis. Samples were analyzed for Diesel Range Organics (DRO), and Gasoline Range Organics (GRO). Based on Field Screening with a PID, BTEX was not analyzed by laboratory methods. The laboratory analysis of the closure samples showed hydrocarbon levels of:

June 7, 2005	DRO ppm	GRO ppm	Benzene ppm	BTEX ppm
4 Point Sidewall	BDL	BDL	NA	NA
Center Pit Bottom	BDL	BDL	NA	NA

BDL: Below Detection Limits

NA: Not Analyzed

Remedial excavation is not needed based on laboratory analysis of soil samples. On behalf of our client, Pure Resources, SMA requests closure for this pit. Groundwater was not encountered.

Respectfully submitted,

John Hagstrom  
Environmental Technician  
**Souder, Miller and Associates**

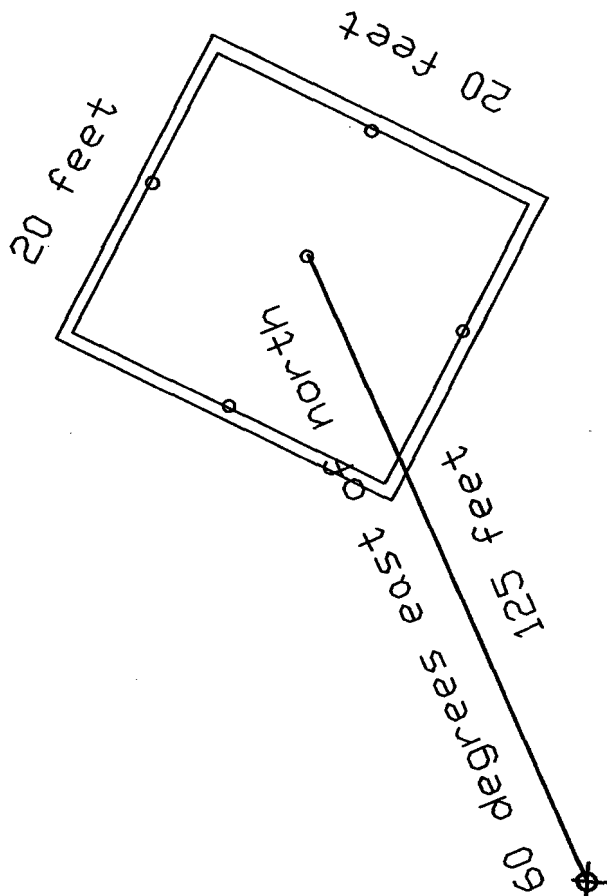

NTS

# LEGEND

Wellhead

Sampling Point



612 E. MURRAY DR.  
FARMINGTON, NM 87401  
PH. (505) 326-5667  
FAX (505) 327-1498

Rincon 295  
1645 FNL, 1125 FEL, S11, T26N, R7W  
API 3003924716  
Rio Arriba County, NM

APPROVED:	DATE:
DRWN BY: JPH	DATE: 9/29/05
CHK'D BY:	DATE:
PROJECT NO: 5115310	SHEET: 1 OF 1

612 E. Murray Drive  
Farmington, NM 87499

Off: (505) 327-1072

FAX: (505) 327-1496

*iiná bá*

P.O. Box 3788  
Shiprock, NM 87420

Off: (505) 368-4065

**ANALYTICAL REPORT**

Date: 29-Jun-05

**CLIENT:** Souder, Miller & Associates  
**Work Order:** 0506031  
**Project:** Pure Resources Rincon 295 Pit/5115310  
**Lab ID:** 0506031-001A

**Client Sample Info:** Rincon 295 Pit  
**Client Sample ID:** Rincon 295 SW 4PT  
**Collection Date:** 6/14/2005 11:00:00 AM  
**Matrix:** SOIL

Parameter	Result	PQL	Qual	Units	DF	Date Analyzed
<b>DIESEL RANGE ORGANICS</b>		<b>SW8015B</b>		Analyst: <b>JEM</b>		
T/R Hydrocarbons: C10-C28	ND	25.0		mg/Kg	1	6/28/2005
Surr: o-Terphenyl	88.7	57-136		%REC	1	6/28/2005
<b>GASOLINE RANGE ORGANICS</b>		<b>SW8015B</b>		Analyst: <b>JEM</b>		
T/R Hydrocarbons: C6-C10	ND	4.50		mg/Kg	25	6/24/2005
Surr: Trifluorotoluene	114	84-149		%REC	25	6/24/2005

**Qualifiers:** ND - Not Detected at the Practical Quantitation Limit  
J - Analyte detected below Practical Quantitation Limit  
B - Analyte detected in the associated Method Blank  
H - Parameter exceeded Maximum Allowable Holding Time

S - Spike Recovery outside accepted recovery limits  
R - RPD outside accepted precision limits  
E - Value above Upper Quantitation Limit - UQL

Page 1 of 2

612 E. Murray Drive  
Farmington, NM 87499

Off: (505) 327-1072

FAX: (505) 327-1496

*iiná bá*

P.O. Box 3788  
Shiprock, NM 87420

Off: (505) 368-4065

## ANALYTICAL REPORT

Date: 29-Jun-05

**CLIENT:** Souder, Miller & Associates

**Work Order:** 0506031

**Project:** Pure Resources Rincon 295 Pit/5115310

**Lab ID:** 0506031-002A

**Client Sample Info:** Rincon 295 Pit

**Client Sample ID:** Rincon 295 CP

**Collection Date:** 6/14/2005 11:02:00 AM

**Matrix:** SOIL

Parameter	Result	PQL	Qual	Units	DF	Date Analyzed
<b>DIESEL RANGE ORGANICS</b>		<b>SW8015B</b>		Analyst: JEM		
T/R Hydrocarbons: C10-C28	ND	25.0		mg/Kg	1	6/28/2005
Surr: o-Terphenyl	96.2	57-136		%REC	1	6/28/2005
<b>GASOLINE RANGE ORGANICS</b>		<b>SW8015B</b>		Analyst: JEM		
T/R Hydrocarbons: C6-C10	ND	4.50		mg/Kg	25	6/24/2005
Surr: Trifluorotoluene	88.7	84-149		%REC	25	6/24/2005

**Qualifiers:**  
ND - Not Detected at the Practical Quantitation Limit  
J - Analyte detected below Practical Quantitation Limit  
B - Analyte detected in the associated Method Blank  
H - Parameter exceeded Maximum Allowable Holding Time

S - Spike Recovery outside accepted recovery limits  
R - RPD outside accepted precision limits  
E - Value above Upper Quantitation Limit - UQL

Page 2 of 2