

District I
1625 N. French Dr., Hobbs, NM 88240
District II
1301 W. Grand Avenue, Artesia, NM 88210
District III
1000 Rio Brazos Road, Aztec, NM 87410
District IV
1220 S. St. Francis Dr., Santa Fe, NM 87505

State of New Mexico
Energy Minerals and Natural Resources

Oil Conservation Division
1220 South St. Francis Dr.
Santa Fe, NM 87505

Form C-144
June 1, 2004

For drilling and production facilities, submit to appropriate NMOCD District Office.
For downstream facilities, submit to Santa Fe office

Pit or Below-Grade Tank Registration or Closure

Is pit or below-grade tank covered by a "general plan"? Yes ☐ No ☐

Type of action: Registration of a pit or below-grade tank ☐ Closure of a pit or below-grade tank ☒

Operator: Pure Resources Telephone: 970-259-1374 e-mail address: _____
Address: 463 Turner Drive, Durango CO 81303 Facility or well name: Rincon 263 API #: 300 3924773 U/L H 1369 FNL/ 1015 FEL Sec 19 T 27N R 6W
County: Rio Arriba Latitude _____ Longitude _____ NAD: 1927 ☐ 1983 ☐
Surface Owner: Federal ☒ State ☐ Private ☐ Indian ☐

Pit

Type: Drilling ☐ Production ☒ Disposal ☐

Workover ☐ Emergency ☐

Lined ☐ Unlined ☒

Liner type: Synthetic ☐ Thickness _____ mil Clay ☐

Pit Volume _____ bbl

Below-grade tank

Volume: _____ bbl Type of fluid: _____

Construction material: _____

Double-walled, with leak detection? Yes ☐ If not, explain why not: _____

Depth to ground water (vertical distance from bottom of pit to seasonal high water elevation of ground water.)

Less than 50 feet

(20 points)

50 feet or more, but less than 100 feet

(10 points)

100 feet or more X

(0 points) X

Wellhead protection area: (Less than 200 feet from a private domestic water source, or less than 1000 feet from all other water sources.)

Yes

(20 points)

No X

(0 points) X

Distance to surface water: (horizontal distance to all wetlands, playas, irrigation canals, ditches, and perennial and ephemeral watercourses.)

Less than 200 feet

(20 points)

200 feet or more, but less than 1000 feet

(10 points)

1000 feet or more X

(0 points) X

Ranking Score (Total Points)

0

- If this is a pit closure:** (1) Attach a diagram of the facility showing the pit's relationship to other equipment and tanks. (2) Indicate disposal location: (check the onsite box if you are burying in place) onsite ☒ offsite ☐ If offsite, name of facility: (3) Attach a general description of remedial action taken including remediation start date and end date.
(4) Groundwater encountered: No ☒ Yes ☐ If yes, show depth below ground surface _____ ft. and attach sample results.
(5) Attach soil sample results and a diagram of sample locations and excavations.

Additional Comments: Decommissioned Separator Pit. Separator was removed.

I hereby certify that the information above is true and complete to the best of my knowledge and belief. I further certify that the above-described pit or below-grade tank has been/will be constructed or closed according to NMOCD guidelines ☒, a general permit ☐, or an (attached) alternative OCD-approved plan ☐.

Date: 7/2/05

Printed Name/Title John Hagstrom as Agent for Pure Resources

Signature [Signature]

Your certification and NMOCD approval of this application/closure does not relieve the operator of liability should the contents of the pit or tank contaminate ground water or otherwise endanger public health or the environment. Nor does it relieve the operator of its responsibility for compliance with any other federal, state, or local laws and/or regulations.

Approval:

DEPUTY OIL & GAS INSPECTOR, DIST. 4

Printed Name/Title

Signature [Signature]

Date:

JUL 21 2006



June 22, 2005

SMA Project: 5115310

RE: Sampling activities for Pit Closure at the Rincon 263. Unit H, Sec. 19, T 27N, R 6W, Fruitland Coal, Rio Arriba County NM. Fed Lease SF079366. API 3003924773.

On May 25, 2005, SMA mobilized to the unlined **separator pit** at the Rincon 263. The dimensions of the unlined pit are approximately 20 X 20 X 4 feet.

On May 25, 2005, SMA collected a soil sample from the center pit bottom for field analysis by Photo Ionization Detector (PID). A four-point composite soil sample was collected from the sidewalls for field analysis by PID. The center pit bottom sample showed a PID reading of 0.7 units and the sidewall composite sample showed a PID reading of 1.0 units. Soil samples for closure were collected for laboratory analysis. Samples were analyzed for Diesel Range Organics (DRO), and Gasoline Range Organics (GRO). Based on Field Screening with a PID, BTEX was not analyzed by laboratory methods. The laboratory analysis of the closure samples showed hydrocarbon levels of:

May 25, 2005	PID Units	DRO ppm	GRO ppm	BTEX ppm
4 Point Sidewall	1.0	BDL	BDL	NA
Center Pit Bottom	0.7	BDL	BDL	NA

BDL: Below Detection Limits

NA: Not Analyzed

No remedial excavation is needed based on laboratory analysis of soil samples. On behalf of our client, Pure Resources, SMA requests closure for this pit. Groundwater was not encountered.

Respectfully submitted,

John Hagstrom
Environmental Technician
Souder, Miller and Associates

SUBJECT RINCON 263

PROJECT 5115310

PAGE 1

CLIENT PURE RESOURCES

DATE 5/25/05

BY JPH

CHECKED

BY

1369 ENL/1015 FEL S 19, T 27 N, R 6 W, RA SFD 79364

P10

1230

1235

SW

CP

1.0

0.7

NTS

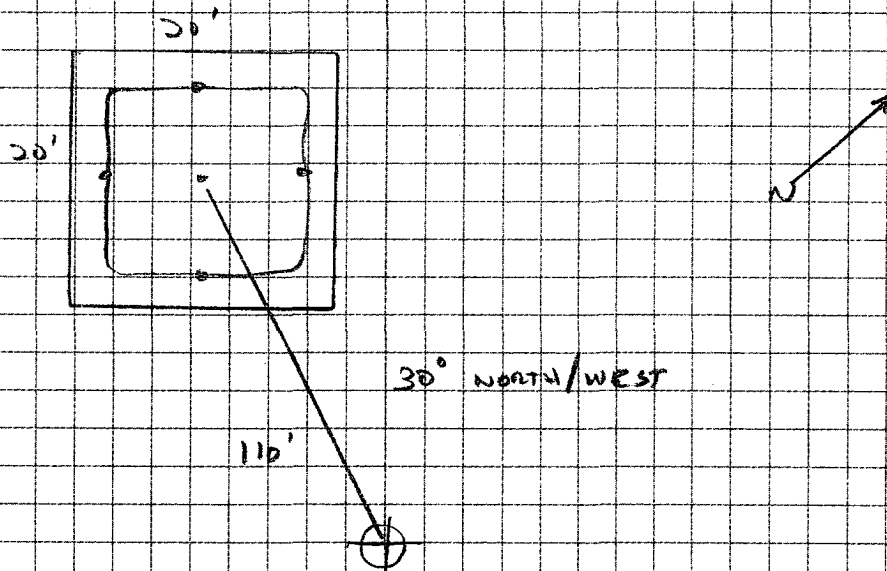

612 E. Murray Drive
Farmington, NM 87499



P.O. Box 3788
Shiprock, NM 87420

Off: (505) 327-1072

FAX: (505) 327-1496

Off: (505) 368-4065

ANALYTICAL REPORT

Date: 14-Jun-05

CLIENT: Souder, Miller & Associates

Work Order: 0505048

Project: Pure Resources Rincon 263 Pit / 5115310

Lab ID: 0505048-001A

Client Sample Info: Pure Resources Rincon 263 Pit

Client Sample ID: Rincon 263 SW

Collection Date: 5/25/2005 12:30:00 PM

Matrix: SOIL

Parameter	Result	PQL	Qual	Units	DF	Date Analyzed
DIESEL RANGE ORGANICS		SW8015B		Analyst: JEM		
T/R Hydrocarbons: C10-C28	ND	25.0		mg/Kg	1	6/7/2005
Surr: o-Terphenyl	66.4	57-136		%REC	1	6/7/2005
GASOLINE RANGE ORGANICS		SW8015B		Analyst: JEM		
T/R Hydrocarbons: C6-C10	ND	4.50		mg/Kg	25	6/7/2005
Surr: Trifluorotoluene	88.8	84-149		%REC	25	6/7/2005

Qualifiers:

ND - Not Detected at the Practical Quantitation Limit

J - Analyte detected below Practical Quantitation Limit

B - Analyte detected in the associated Method Blank

H - Parameter exceeded Maximum Allowable Holding Time

S - Spike Recovery outside accepted recovery limits

R - RPD outside accepted precision limits

E - Value above Upper Quantitation Limit - UQL

612 E. Murray Drive
Farmington, NM 87499

iiná bá

P.O. Box 3788
Shiprock, NM 87420

Off: (505) 327-1072

FAX: (505) 327-1496

Off: (505) 368-4065

ANALYTICAL REPORT

Date: 14-Jun-05

CLIENT: Souder, Miller & Associates

Client Sample Info: Pure Resources Rincon 263 Pit

Work Order: 0505048

Client Sample ID: Rincon 263 CP

Project: Pure Resources Rincon 263 Pit / 5115310

Collection Date: 5/25/2005 12:53:00 PM

Lab ID: 0505048-002A

Matrix: SOIL

Parameter	Result	PQL	Qual	Units	DF	Date Analyzed
DIESEL RANGE ORGANICS		SW8015B		Analyst: JEM		
T/R Hydrocarbons: C10-C28	ND	25.0		mg/Kg	1	6/7/2005
Surr: o-Terphenyl	99.7	57-136		%REC	1	6/7/2005
GASOLINE RANGE ORGANICS		SW8015B		Analyst: JEM		
T/R Hydrocarbons: C6-C10	ND	4.50		mg/Kg	25	6/7/2005
Surr: Trifluorotoluene	88.8	84-149		%REC	25	6/7/2005

Qualifiers:

ND - Not Detected at the Practical Quantitation Limit

S - Spike Recovery outside accepted recovery limits

J - Analyte detected below Practical Quantitation Limit

R - RPD outside accepted precision limits

B - Analyte detected in the associated Method Blank

E - Value above Upper Quantitation Limit - UQL

H - Parameter exceeded Maximum Allowable Holding Time

Page 2 of 2