

UNITED STATES  
DEPARTMENT OF THE INTERIOR  
BUREAU OF LAND MANAGEMENT

2005 AUG 4 AM 10:23

FORM APPROVED  
OMB No. 1004-0137  
Expires March 31, 2007



APPLICATION FOR PERMIT TO DRILL OR REENTER

1a. Type of work: <input checked="" type="checkbox"/> DRILL <input type="checkbox"/> REENTER		6. Lease Serial No. SF 079003	
1b. Type of Well: <input type="checkbox"/> Oil Well <input checked="" type="checkbox"/> Gas Well <input type="checkbox"/> Other <input type="checkbox"/> Single Zone <input type="checkbox"/> Multiple Zone		6. If Indian, Allottee or Tribe Name	
2. Name of Operator Devon Energy Production Company, L.P.		7. If Unit or CA Agreement, Name and No. Northeast Blanco Unit	
3a. Address PO Box 6459 Farmington, NM 87419		8. Lease Name and Well No. NEBU 466A	
3b. Phone No. (include area code) 505-632-0244		9. API Well No. 30-039-29614	
4. Location of Well (Report location clearly and in accordance with any State requirements*) At surface SW SE NW NE, Unit B, 25' FNL & T, 950' FEL Unit D 10' FSL 1790' FEL Sec 34 T31N R7W At proposed prod. zone SE SE, Unit P, 970' FSL & 1,270' FEL, Sec. 34, T31N, R7W		10. Field and Pool, or Exploratory Basin Fruitland Coal	
11. Sec., T. R. M. or Blk. and Survey or Area Sec 34 T31N R7W Sec. 3, T30N, R7W		12. County or Parish Rio Arriba	
13. State NM		14. Distance in miles and direction from nearest town or post office* Approximately 36.6 miles	
15. Distance from proposed* location to nearest property or lease line, ft. (Also to nearest drig. unit line, if any) 25'		16. No. of acres in lease 2560 Acres	
17. Spacing Unit dedicated to this well 320 Acres		18. Distance from proposed location* to nearest well, drilling, completed, applied for, on this lease, ft.	
19. Proposed Depth 3578' MO		20. BLM/BIA Bond No. on file	
21. Elevations (Show whether DF, KDB, RT, GL, etc.) GR 6292		22. Approximate date work will start* 10/02/2005	
23. Estimated duration Unknown		24. Attachments	

The following, completed in accordance with the requirements of Onshore Oil and Gas Order No.1, shall be attached to this form:

1. Well plat certified by a registered surveyor.
2. A Drilling Plan.
3. A Surface Use Plan (if the location is on National Forest System Lands, the SUPO shall be filed with the appropriate Forest Service Office).
4. Bond to cover the operations unless covered by an existing bond on file (see Item 20 above).
5. Operator certification
6. Such other site specific information and/or plans as may be required by the authorized officer.

25. Signature <i>M.S. Zimmerman</i>	Name (Printed/Typed) Melisa Zimmerman	Date 8-2-05
Title Senior Operations Technician		
Approved by (Signature) <i>M. Zimmerman</i>	Name (Printed/Typed)	Date 8/4/06
Title AFM		
Office FFO		

Application approval does not warrant or certify that the applicant holds legal or equitable title to those rights in the subject lease which would entitle the applicant to conduct operations thereon.  
Conditions of approval, if any, are attached.

Title 18 U.S.C. Section 1001 and Title 43 U.S.C. Section 1212, make it a crime for any person knowingly and willfully to make to any department or agency of the United States any false, fictitious or fraudulent statements or representations as to any matter within its jurisdiction.

\*(Instructions on page 2)

HOLD C104 FOR Directional Survey

NMOCD

District I  
PO Box 1980, Hobbs NM 88241-1980  
District II  
PO Drawer KK, Artesia, NM 87211-0719  
District III  
1000 Rio Brazos Rd., Aztec, NM 87410  
District IV  
PO Box 2088, Santa Fe, NM 87504-2088

State of New Mexico  
Energy, Minerals & Natural Resources Department

OIL CONSERVATION DIVISION  
PO Box 2088  
Santa Fe, NM 87504-2088

Form C-102  
Revised February 21, 1994

Instructions on back  
Submit to Appropriate District Office  
State Lease - 4 Copies  
Fee Lease - 3 Copies

☐ AMENDED REPORT

WELL LOCATION AND ACREAGE DEDICATION PLAT

<sup>1</sup> API Number <b>30-039-29614</b>		<sup>2</sup> Pool Code <b>74629</b>	<sup>3</sup> Pool Name <b>Basin Fruitland Coal</b>
<sup>4</sup> Property Code <b>19641</b>	<sup>5</sup> Property Name <b>NEBU</b>		<sup>6</sup> Well Number <b>#466A</b>
<sup>7</sup> OGRID No. <b>6137</b>	<sup>8</sup> Operator Name <b>Devon Energy Production Company, L.P.</b>		<sup>9</sup> Elevation <b>6292</b>

<sup>10</sup> Surface Location

UL or Lot No. <b>O</b>	Section <b>34</b>	Township <b>31 N</b>	Range <b>7 W</b>	Lot Idn	Feet from the <b>70</b>	North/South line <b>SOUTH</b>	Feet from the <b>1790</b>	East/West line <b>EAST</b>	County <b>Rio Arriba</b>
---------------------------	----------------------	-------------------------	---------------------	---------	----------------------------	----------------------------------	------------------------------	-------------------------------	-----------------------------

<sup>11</sup> Bottom Hole Location If Different From Surface

<sup>7</sup> UL or lot no. <b>P</b>	Section <b>34</b>	Township <b>31 N</b>	Range <b>7 W</b>	Lot Idn	Feet from the <b>970</b>	North/South line <b>SOUTH</b>	Feet from the <b>1270</b>	East/West line <b>EAST</b>	County <b>Rio Arriba</b>
--	----------------------	-------------------------	---------------------	---------	-----------------------------	----------------------------------	------------------------------	-------------------------------	-----------------------------

<sup>12</sup> Dedicated Acres <b>320</b>	<sup>13</sup> Joint or Infill	<sup>14</sup> Consolidation Code	<sup>15</sup> Order No.
---	-------------------------------	----------------------------------	-------------------------

NO ALLOWABLE WILL BE ASSIGNED TO THIS COMPLETION UNTIL ALL INTERESTS HAVE BEEN CONSOLIDATED  
OR A NON-STANDARD UNIT HAS BEEN APPROVED BY THE DIVISION

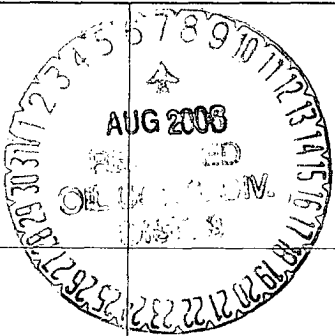
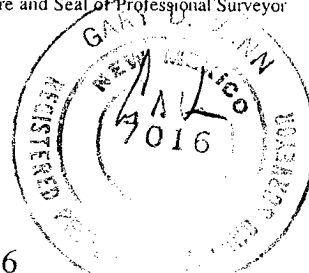
	<p><b>34</b></p>		<p><b>17 OPERATOR CERTIFICATION</b> I hereby certify that the information contained herein is true and complete to the best of my knowledge and belief.</p> <p><i>M.S. Zimmerman</i> Signature <b>Melisa S. Zimmerman</b> Printed Name <b>Sr. Operations Technician</b> Title <b>June 20, 2006</b> Date</p>
	<p><b>18 SURVEYOR CERTIFICATION</b> I hereby certify that the well location shown on this plat was plotted from field notes of actual surveys made by me or under my supervision, and that the same is true and correct to the best of my belief.</p> <p><b>Restated: March 07, 2006</b> <b>September 22, 2004</b> Date of Survey</p> <p>Signature and Seal of Professional Surveyor   </p> <p><b>7016</b> Certificate Number</p>		
<p><b>Bottom Hole Location</b> 970' F/SL 1270' F/EL</p> <p>Azimuth - 30°01' 1039'</p> <p>70' 1790'</p>			

8

Submit 3 Copies To Appropriate District Office  
District I  
1625 N. French Dr., Hobbs, NM 88240  
District II  
1301 W. Grand Ave., Artesia, NM 88210  
District III  
1000 Rio Brazos Rd., Aztec, NM 87410  
District IV  
1220 S. St. Francis Dr., Santa Fe, NM 87505

State of New Mexico  
Energy, Minerals and Natural Resources  
OIL CONSERVATION DIVISION  
1220 South St. Francis Dr.  
Santa Fe, NM 87505

Form C-103  
March 4, 2004

WELL API NO. <b>30-039-29614</b>	
5. Indicate Type of Lease STATE <input type="checkbox"/> FEE <input type="checkbox"/>	
6. State Oil & Gas Lease No. SF 079003	
7. Lease Name or Unit Agreement Name NORTHEAST BLANCO UNIT	
8. Well Number 466A	
9. OGRID Number 6137	
10. Pool name or Wildcat Basin Fruitland Coal	
SUNDRY NOTICES AND REPORTS ON WELLS (DO NOT USE THIS FORM FOR PROPOSALS TO DRILL OR TO DEEPEN OR PLUG BACK TO A DIFFERENT RESERVOIR. USE "APPLICATION FOR PERMIT" (FORM C-101) FOR SUCH PROPOSALS.) 1. Type of Well: Oil Well <input type="checkbox"/> Gas Well <input checked="" type="checkbox"/> Other	
2. Name of Operator Devon Energy Production Company, L.P.	
3. Address of Operator PO Box 6459, Navajo Dam, NM 87419	
4. Well Location Unit Letter <b>O</b> : <b>70</b> feet from the <b>South</b> line and <b>1790</b> feet from the <b>East</b> line Section <b>34</b> Township <b>30N</b> Range <b>7W</b> NMPM County - Rio Arriba	
11. Elevation (Show whether DR, RKB, RT, GR, etc.) GR 6,278'	
Pit or Below-grade Tank Application (For pit or below-grade tank closures, a form C-144 must be attached) Pit Location: UL <b>B</b> Sect <b>3</b> Twp <b>30N</b> Rng <b>7W</b> Pit type <b>Drilling</b> Depth to Groundwater <b>&gt;100'</b> Distance from nearest fresh water well <b>&gt;1000'</b> Distance from nearest surface water <b>&gt;1000'</b> Below-grade Tank Location UL _____ Sect _____ Twp _____ Rng _____ ; feet from the _____ line and _____ feet from the _____ line	

12. Check Appropriate Box to Indicate Nature of Notice, Report or Other Data	
NOTICE OF INTENTION TO: PERFORM REMEDIAL WORK <input type="checkbox"/> PLUG AND ABANDON <input type="checkbox"/> TEMPORARILY ABANDON <input type="checkbox"/> CHANGE PLANS <input type="checkbox"/> PULL OR ALTER CASING <input type="checkbox"/> MULTIPLE COMPLETION <input type="checkbox"/> OTHER: CONSTRUCT DRILLING PIT <input checked="" type="checkbox"/>	SUBSEQUENT REPORT OF: REMEDIAL WORK <input type="checkbox"/> ALTERING CASING <input type="checkbox"/> COMMENCE DRILLING OPNS. <input type="checkbox"/> PLUG AND ABANDONMENT <input type="checkbox"/> CASING TEST AND CEMENT JOB <input type="checkbox"/> OTHER: <input type="checkbox"/>
13. Describe proposed or completed operations. (Clearly state all pertinent details, and give pertinent dates, including estimated date of starting any proposed work). SEE RULE 1103. For Multiple Completions: Attach wellbore diagram of proposed completion or recompletion.	
14. <b>Devon Energy will be constructing a lined drilling pit. The closure of said pit will be in accordance with the NMOCD regulations with the cutting of the liner applying to the BLM rules.</b>	
I hereby certify that the information above is true and complete to the best of my knowledge and belief. I further certify that any pit or below-grade tank has been/will be constructed or closed according to NMOCD guidelines <input checked="" type="checkbox"/> , a general permit <input type="checkbox"/> or an (attached) alternative OCD-approved plan <input type="checkbox"/> .	
SIGNATURE <u>M. S. Zimmerman</u> TITLE <u>Sr. Operations Technician</u> DATE <u>8-2-05</u>	
Type or print name <u>Melisa Zimmerman</u> E-mail address: <u>Melisa.zimmerman@dvn.com</u> Telephone No. <u>405-552-7917</u>	

(This space for State use)

APPROVED BY [Signature] TITLE DEPUTY OIL & GAS INSPECTOR, DIST. 41 DATE AUG 07 2005  
Conditions of approval, if any:

**PAD LAYOUT PLAN & PROFILE**  
**DEVON ENERGY PRODUCTION COMPANY, L.P.**

Nebu # 466A  
 70' F/SL 1790' F/EL  
 SEC. 34, T31N, R7W, N.M.P.M.  
 RIO ARRIBA COUNTY, NEW MEXICO

Lat: 36.84958°  
 Long: 107.55541° (83)

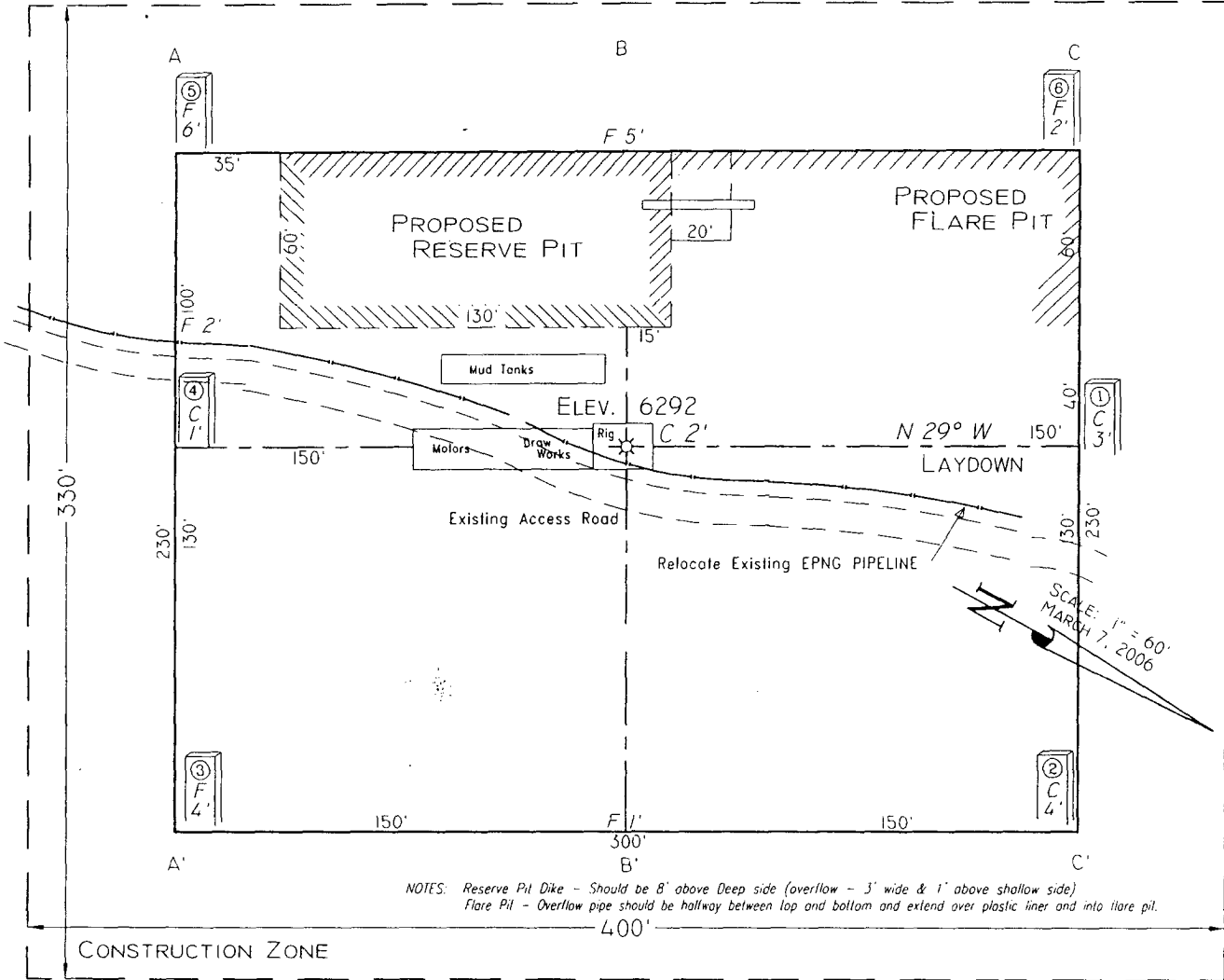

Area of Construction Zone - 330'x400' or 3.03 acres, more or less.

SCALE: 1"=60'-HORIZ.  
 1"=40'-VERT.

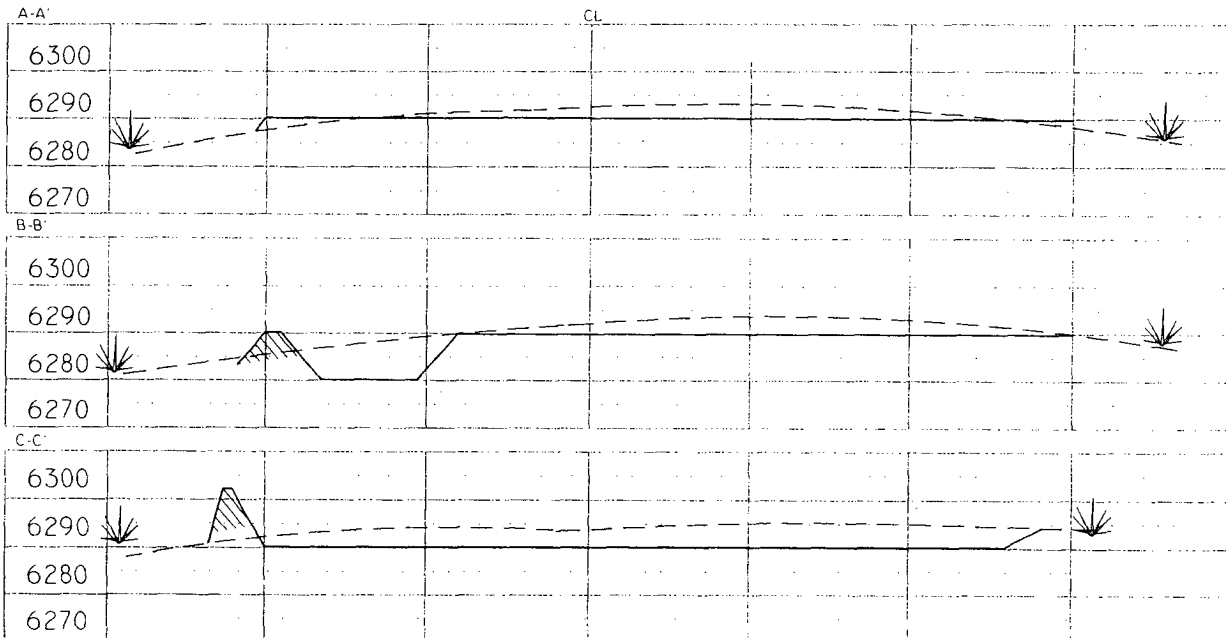

NOTE: Contractor should call One-Call for location of any marked or unmarked buried pipelines or cables on well pad and/or access road at least two (2) working days prior to construction.

Cuts and fills shown are approximate - final finished elevation is to be adjusted so earthwork will balance. Corner stakes are approximate and do not include additional areas needed for sideslopes and drainages. Final Pad Dimensions are to be verified by Contractor.

VANN SURVEYS  
 P. O. Box 1306  
 Farmington, NM

**NEBU 466A  
Unit B 3-30N-7W  
San Juan Co., NM**

**DRILLING PLAN**

**1. ESTIMATED TOPS OF IMPORTANT GEOLOGIC MARKERS & ANTICIPATED WATER, OIL, GAS OR MINERAL FORMATIONS:**

<b>Formation</b>	<b>TVD (ft)</b>	<b>TMD (ft)</b>	<b>Hydrocarbon/Water Bearing Zones</b>
San Jose	Surface	Surface	
Ojo Alamo	2105	2381	Aquifer
Kirtland	2218	2501	
Fruitland	2692	2982	Gas
Fruitland 1 <sup>st</sup> Coal	2912	3202	Gas
Pictured Cliffs Tongue	3094	3384	Gas
Pictured Cliffs Main	3188	3478	Gas
<b>PTD</b>	<b>3288</b>	<b>3578</b>	

All shows of fresh water and minerals will be adequately protected and reported. A 100' sump will be drilled into the Picture cliffs. A mud logger will be on location collecting samples and measuring gas levels. Should the Picture Cliffs interval appear to be productive the sump will be filled with cuttings and abandoned

**2. PRESSURE CONTROL EQUIPMENT:**

All well control equipment shall be in accordance with Onshore Order #2 for 2M systems.

The minimum specifications for pressure control equipment that will be provided are included on the attached schematic diagram, which shows the size, and pressure ratings.

- 2000# BOP With Pipe Rams and 2000# BOP With Blind Rams

Auxiliary equipment to be used:

- Upper kelly cock with handle available.

The manifold includes appropriate valves and adjustable chokes. The kill line will have one check valve. Ram type preventers will be pressure tested to full working pressure (utilizing a test plug) or 70% of the internal yield pressure (without a test plug) at:

- Initial installation

- Whenever any seal subject to test pressure is broken
- Following related repairs
- At 30 day intervals

Pipe and blind rams shall be activated each trip.

A BOPE pit level drill will be conducted weekly for each drilling crew.  
All tests and drills will be recorded in the drilling log.

The accumulator will have sufficient capacity to close all rams and retain 200 psi above pre-charge pressure without the use of closing unit pumps.

Master controls will be at the accumulator. Anticipated bottom hole pressure is 1000 psi.

### 3. **CASING & CEMENTING PROGRAM:**

A. The proposed casing program will be as follows:

TVD	TMD	Hole Size	Size	Grade	Weight	Thread	Condition
0-285	0-285	12-1/4"	9-5/8"	H-40	32#	STC	New
0-2692	0-2982	8-3/4"	7"	J-55	23#	LTC	New
0- TD	0- TD	6-1/4"	5-1/2"*	J-55	15.5 #	LTC	New

The 9-5/8" surface pipe will be tested to 750 psi. All casing strings below the surface shoe shall be pressure tested to 0.22 psi/ft. of casing string length or 1500 psi, whichever is greater, but not to exceed 70% minimum internal yield.

**Surface:** The bottom three joints of the surface casing will have a minimum of one centralizer per joint and one centralizer every joint thereafter (Total 5 centralizers estimated)

**7" Casing:** The bottom three joints of the 7" casing will have a minimum of one centralizer per joint and one centralizer every fifth joint thereafter to above Ojo Alamo with turbolizers below and throughout the Ojo Alamo. (Total 12 centralizers, 3 turbolizers estimated).

B. The proposed cementing program will be as follows:

**Surface String:** 9-5/8" Surface cemented in a 12-1/4" hole at 285'.  
32.3# H-40 ST&C 8 Rnd  
Saw tooth guide shoe  
Cemented with 200 sacks Class B mixed at 15.6 ppg w/.25 pps  
Celloflake, 2% calcium chloride. Yeild 1.19 ft3/sx. \*  
Cement designed to circulate to surface.

*\* Minor variations possible due to existing hole conditions*

**Production String:** 7" Production casing cemented in an 8-3/4" hole  
 23# J-55 LT&C 8 Rnd  
 Float collar  
 Joint  
 Float Shoe  
 Cement with  
**Lead:** 500 sacks Class B 50/50 POZ, 3% gel, 5# gilsonite, 1/4"# Flocele, .1% CFR 3, .2% Halad 344, yield 1.47 ft3/sx.  
**Tail:** 25 sx Class 'B'. 1.18 ft3/sx. \*  
 Cement designed to circulate to surface.  
 Pending hole conditions, cement baskets may be installed above TD

*\* Minor variations possible due to existing hole conditions.*

**Liner:** 5-1/2" liner\*  
 15.5# J-55 LT&C 8 Rnd  
 Shoe  
 Not Cemented

\* May not be run pending hole conditions.  
 If well does not respond to proposed to completion, the 5 1/2 " liner will be cemented using 300 sacks class B 50/50 POZ, 3% gel, 5# gilsonite, 1/4"# Flocele, .1% CFR 3, .2% Halad 344, yield 1.47 ft3/sx. \*\*

**\*\* Minor variations possible due to existing hole conditions**

#### 4. DRILLING FLUIDS PROGRAM:

TVD	TMD	Type	Weight (ppg)	Viscosity	pH	Water Loss	Remarks
0-285	0-285	Spud	8.4-9.0	29-70	8.0	NC	FW gel,
285-2692	285-2982	LSND	8.4-9.0	29-70	8.0	10-12	LCM as needed
2775 - TD	3842 - TD	Air					Foam as needed

NC = no control

Sufficient quantities of mud material will be maintained on site or be readily accessible for the purpose of assuring well control. SPR will be recorded on daily drilling report after mudding up. Visual mud monitoring will be conducted during operations.

**5. EVALUATION PROGRAM:**

**Wireline Logs:** None

**Mud Logs:** mud logging in Fruitland Coal.

**Survey:** Deviation surveys will be taken every 500' from 0-TD of 8 ¾" hole or first succeeding bit change.

**Cores:** None anticipated.

**DST's:** None anticipated.

**6. ABNORMAL CONDITIONS:**

The Fruitland Coal will be encountered in the 8 ¾" hole. Estimated formation pressure is 300 psi. No other abnormal pressures and/or temperatures are expected. No hydrogen sulfide should be present.

**7. OTHER INFORMATION:**

The anticipated starting date and duration of the operation will be as follows:

Starting Date:	Upon Approval
Duration:	20 days

If the well is completed as a dry hole or as a producer, Well Completion or Recompletion Report and Log (Form 3160-4) will be submitted within 30 days after completion of the well or after completion of operations being performed, in accordance with 43 CFR 3160. Copies of all logs, core descriptions, core analyses, well test data, geologic summaries, sample descriptions, daily drilling reports, daily completion reports, and all other surveys or data obtained and compiled during the drilling, completion, and/or workover operations, will be submitted directly to the Authorized Officer or filed with Form 3160-4.



# Well Control Equipment 2,000 psi Configuration

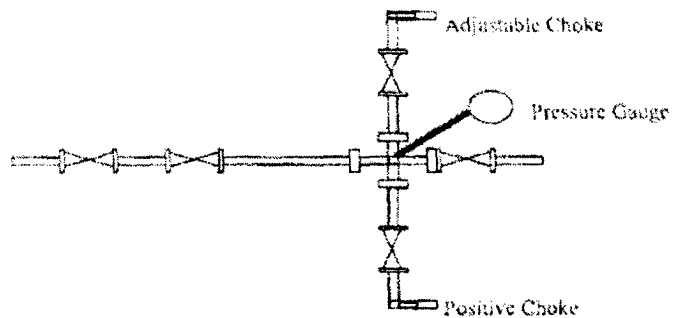
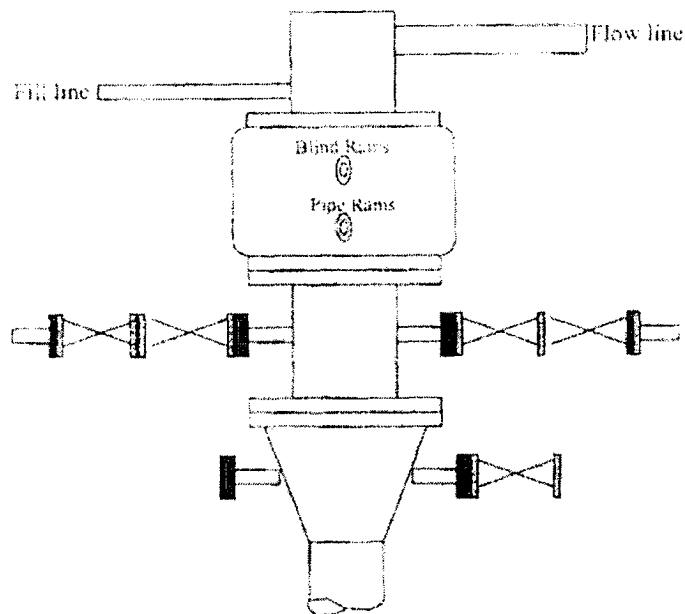

All well control equipment designed to meet or exceed the Onshore Oil and Gas Order No. 2, BLM 43 CTR 3160 requirements for 2M systems.

UNITED STATES  
DEPARTMENT OF THE INTERIOR  
BUREAU OF LAND MANAGEMENT

**SUNDRY NOTICES AND REPORTS ON WELLS**

*Do not use this form for proposals to drill or to re-enter an abandoned well. Use Form 3160-3 (APD) for such proposals.*

FORM APPROVED  
OMB No. 1004-0137  
Expires: March 31, 2007

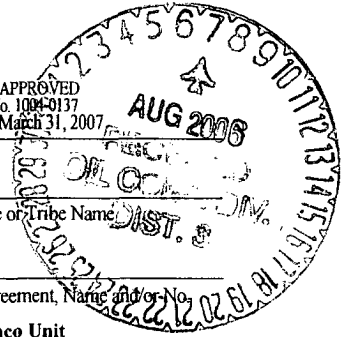

5. Lease Serial No.  
SF 079003

6. If Indian, Allottee or Tribe Name:

7. If Unit or CA/Agreement, Name and/or No.  
Northeast Blanco Unit

8. Well Name and No.  
NEBU 466A

9. API Well No.  
3003929614

10. Field and Pool, or Exploratory Area  
Basin Fruitland Coal

11. County or Parish, State  
Rio Arriba, NM

**SUBMIT IN TRIPLICATE- Other instructions on reverse side.**

1. Type of Well  
☐ Oil Well ☒ Gas Well ☐ Other

2. Name of Operator  
Devon Energy Production Company, L.P.

3a. Address  
PO Box 6459, Navajo Dam, NM 87419

3b. Phone No. (include area code)  
405-552-7917

4. Location of Well (Footage, Sec., T., R., M., or Survey Description)  
SL: 70' FSL & 1,790' FEL, SW SE, Unit O, Sec. 34, T31N- R7W  
BHL: 970' FSL & 1,270' FEL, SE SE, Unit P. Sec. 34, T31N- R7W

**12. CHECK APPROPRIATE BOX(ES) TO INDICATE NATURE OF NOTICE, REPORT, OR OTHER DATA**

TYPE OF SUBMISSION	TYPE OF ACTION			
<input checked="" type="checkbox"/> Notice of Intent	<input type="checkbox"/> Acidize	<input type="checkbox"/> Deepen	<input type="checkbox"/> Production (Start/Resume)	<input type="checkbox"/> Water Shut-Off
<input type="checkbox"/> Subsequent Report	<input type="checkbox"/> Alter Casing	<input type="checkbox"/> Fracture Treat	<input type="checkbox"/> Reclamation	<input type="checkbox"/> Well Integrity
<input type="checkbox"/> Final Abandonment Notice	<input type="checkbox"/> Casing Repair	<input type="checkbox"/> New Construction	<input type="checkbox"/> Recomplete	<input checked="" type="checkbox"/> Other Surface
	<input type="checkbox"/> Change Plans	<input type="checkbox"/> Plug and Abandon	<input type="checkbox"/> Temporarily Abandon	Location Change
	<input type="checkbox"/> Convert to Injection	<input type="checkbox"/> Plug Back	<input type="checkbox"/> Water Disposal	

13. Describe Proposed or Completed Operation (clearly state all pertinent details, including estimated starting date of any proposed work and approximate duration thereof. If the proposal is to deepen directionally or recomplate horizontally, give subsurface locations and measured and true vertical depths of all pertinent markers and zones. Attach the Bond under which the work will be performed or provide the Bond No. on file with BLM/BIA. Required subsequent reports shall be filed within 30 days following completion of the involved operations. If the operation results in a multiple completion or recompletion in a new interval, a Form 3160-4 shall be filed once testing has been completed. Final Abandonment Notices shall be filed only after all requirements, including reclamation, have been completed, and the operator has determined that the site is ready for final inspection.)

Devon Energy Production Company, L.P. gives notification of well depth change. Attached is a copy of the new C-102, Survey, Plot, and Drilling Plan.

14. I hereby certify that the foregoing is true and correct  
Name (Printed/Typed)

Melisa Zimmerman

Title Senior Operations Technician

Signature

Date 6-20-06

**THIS SPACE FOR FEDERAL OR STATE OFFICE USE**

Approved by

Title

Date

Conditions of approval, if any, are attached. Approval of this notice does not warrant or certify that the applicant holds legal or equitable title to those rights in the subject lease which would entitle the applicant to conduct operations thereon.

Office

Title 18 U.S.C. Section 1001 and Title 43 U.S.C. Section 1212, make it a crime for any person knowingly and willfully to make to any department or agency of the United States any false, fictitious or fraudulent statements or representations as to any matter within its jurisdiction.

(Instructions on page 2)

NMOCD

Company: Devon Energy  
 Lease/Well: NEBU # 466A  
 Location: Rio Arriba County  
 State/Country: NM

