

RCVD DEC13'06

OIL CONS. DIV.
DIST. 3Form 3160-5
(April 2004)UNITED STATES
DEPARTMENT OF THE INTERIOR
BUREAU OF LAND MANAGEMENTFORM APPROVED
OMB No. 1004-0137
Expires: March 31, 2007

SUNDRY NOTICES AND REPORTS ON WELLS

Do not use this form for proposals to drill or to re-enter an
abandoned well. Use Form 3160-3 (APD) for such proposals.

SUBMIT IN TRIPLICATE- Other instructions on reverse side.

1. Type of Well <input type="checkbox"/> Oil Well <input checked="" type="checkbox"/> Gas Well <input type="checkbox"/> Other		5. Lease Serial No. Jicarilla Contract 95
2. Name of Operator Energen Resources Corporation		6. If Indian, Allottee or Tribe Name Jicarilla Apache
3a. Address 2198 Bloomfield Hwy, Farmington, NM	3b. Phone No. (include area code) 505-325-6800	7. If Unit or CA/Agreement, Name and/or No. 21289
4. Location of Well (Footage, Sec., T., R., M., or Survey Description) 2340' FNL, 990' FWL, Section 35, T27N, R3W, NMPM		8. Well Name and No. Jicarilla 95 #3C
		9. API Well No. 30-039-26548
		10. Field and Pool, or Exploratory Area Blanco MV/ WC 37N3W35 Mancos
		11. County or Parish, State Rio Arriba, NM

12. CHECK APPROPRIATE BOX(ES) TO INDICATE NATURE OF NOTICE, REPORT, OR OTHER DATA

TYPE OF SUBMISSION	TYPE OF ACTION			
<input checked="" type="checkbox"/> Notice of Intent	<input type="checkbox"/> Acidize	<input type="checkbox"/> Deepen	<input type="checkbox"/> Production (Start/Resume)	<input type="checkbox"/> Water Shut-Off
<input type="checkbox"/> Subsequent Report	<input type="checkbox"/> Alter Casing	<input type="checkbox"/> Fracture Treat	<input type="checkbox"/> Reclamation	<input type="checkbox"/> Well Integrity
<input type="checkbox"/> Final Abandonment Notice	<input type="checkbox"/> Casing Repair	<input type="checkbox"/> New Construction	<input type="checkbox"/> Recomplete	<input checked="" type="checkbox"/> Other DHC Blanco MV/ WC 37N3W35 Mancos
	<input type="checkbox"/> Change Plans	<input type="checkbox"/> Plug and Abandon	<input type="checkbox"/> Temporarily Abandon	
	<input type="checkbox"/> Convert to Injection	<input type="checkbox"/> Plug Back	<input type="checkbox"/> Water Disposal	

13. Describe Proposed or Completed Operation (clearly state all pertinent details, including estimated starting date of any proposed work and approximate duration thereof. If the proposal is to deepen directionally or recompleat horizontally, give subsurface locations and measured and true vertical depths of all pertinent markers and zones. Attach the Bond under which the work will be performed or provide the Bond No. on file with BLM/BIA. Required subsequent reports shall be filed within 30 days following completion of the involved operations. If the operation results in a multiple completion or recompleat in a new interval, a Form 3160-4 shall be filed once testing has been completed. Final Abandonment Notices shall be filed only after all requirements, including reclamation, have been completed, and the operator has determined that the site is ready for final inspection.)

Energen Resources Corporation requests administrative approval to downhole commingle the Blanco Mesa Verde (MV), and WC27N3W35; Mancos pools in the subject well. It is our intent to commingle the two zones to increase the economic potential of this well. The well is currently on a plunger lift system, and we believe it is the most economical method to recover gas and oil from the subject well. We identify this method to improve the overall efficiency of the well. We may have to place well on a beam pump if production demands require it.

1. MIRU and POOH with tubing strings.

2. TIH with work string and clean out with mill past CIBP and WC27N3W35; Mancos perforations to lower CIBP.

i) CIBP set @ 7200'

ii) Perforations set @ 7262'-7808'

iii) CIBP set @ 7958'

3. TOH with work string and mill.

4. TIH w/ 2-3/8" production tubing to WC27N3W35; Mancos Mid-perforations or there about.

5. Swab well in and place on artificial lift.

6. Based on historical production allocation for gas is 71% Mesa Verde, 29% WC27N3W35; Mancos. Oil will be allocated 36% Mesa Verde, 64% WC27N3W35; Mancos.

14. I hereby certify that the foregoing is true and correct
Name (Printed/Typed)

Justin Stolorow

Title District Engineer

Signature

Date

No order yet DHC-3833 12/14/06

12-8-06

THIS SPACE FOR FEDERAL OR STATE OFFICE USE

Approved by

Joe Hunt

Title Geo

Date 12-12-06

Conditions of approval, if any, are attached. Approval of this notice does not warrant or certify that the applicant holds legal or equitable title to those rights in the subject lease which would entitle the applicant to conduct operations thereon.

Office FDO

Title 18 U.S.C. Section 1001 and Title 43 U.S.C. Section 1212, make it a crime for any person knowingly and willfully to make to any department or agency of the United States any false, fictitious or fraudulent statements or representations as to any matter within its jurisdiction.

(Instructions on page 2)

NMOC

District I
1625 N. French Drive, Hobbs, NM 88240

District II
1301 W. Grand Avenue, Artesia, NM 88210

District III
Well
1000 Rio Brazos Road, Aztec, NM 87410

District IV
1220 S. St. Francis Dr., Santa Fe, NM 87505

State of New Mexico
Energy, Minerals and Natural Resources Department

Form C-107A
Revised June 10, 2003

Oil Conservation Division
1220 South St. Francis Dr.

APPLICATION TYPE
 X Single

Santa Fe, New Mexico 87505

 Establish Pre-Approved Pools
EXISTING WELLBORE
 X Yes No

APPLICATION FOR DOWNHOLE COMMINGLING

Energen Resources

2198 Bloomfield Highway, Farmington, New Mexico 87401

Operator Jicarilla 95	3C	Address E Section 35, T27N, R3W N.M.P.M	Rio Arriaba
Lease 162928	Well No. 21289	Unit Letter-Section-Township-Range 30-039-26548	County X
OGRID No. _____	Property Code _____	API No. _____	Lease Type: <u> </u> Federal <u> </u> State <u> </u> Fee

DATA ELEMENT	UPPER ZONE	INTERMEDIATE ZONE	LOWER ZONE
Pool Name	Blanco Mesaverde	N/A	WC27N3W35; Mancos
Pool Code	72319	N/A	97058
Top and Bottom of Pay Section (Perforated or Open-Hole Interval)	5637' to 6160'	N/A	7262' to 7808'
Method of Production (Flowing or Artificial Lift)	Artificial Lift - Plunger	N/A	Artificial Lift - Plunger
Bottomhole Pressure (Note: Pressure data will not be required if the bottom perforation in the lower zone is within 150% of the depth of the top perforation in the upper zone)	N/A within 150%	N/A	N/A within 150%
Oil Gravity or Gas BTU (Degree API or Gas BTU)	1,238 BTU	N/A	1,328BTU
Producing, Shut-In or New Zone	Producing	N/A	Shut-In
Date and Oil/Gas/Water Rates of Last Production. (Note: For new zones with no production history, applicant shall be required to attach production estimates and supporting data.)	Date: 12/7/06 Rates: 0.4 BOPD/150 MCFPD/1.0 BWPD	Date: N/A Rates: N/A	Date: 01/29/02 Rates: 0.7 BOPD/60 MCFPD/5.0 BWPD
Fixed Allocation Percentage (Note: If allocation is based upon something other than current or past production, supporting data or explanation will be required.)	Oil Gas 36 % 71 %	Oil N/A Gas N/A % %	Oil Gas 64 % 29 %

ADDITIONAL DATA

Are all working, royalty and overriding royalty interests identical in all commingled zones? Yes X No
If not, have all working, royalty and overriding royalty interest owners been notified by certified mail? Yes No

Are all produced fluids from all commingled zones compatible with each other? Yes X No

Will commingling decrease the value of production? Yes No X

If this well is on, or communitized with, state or federal lands, has either the Commissioner of Public Lands or the United States Bureau of Land Management been notified in writing of this application? Yes X No

NMOCD Reference Case No. applicable to this well: _____

Attachments:

- C-102 for each zone to be commingled showing its spacing unit and acreage dedication.
- Production curve for each zone for at least one year. (If not available, attach explanation.)
- For zones with no production history, estimated production rates and supporting data.
- Data to support allocation method or formula.
- Notification list of working, royalty and overriding royalty interests for uncommon interest cases.
- Any additional statements, data or documents required to support commingling.

PRE-APPROVED POOLS

If application is to establish Pre-Approved Pools, the following additional information will be required:

List of other orders approving downhole commingling within the proposed Pre-Approved Pools
List of all operators within the proposed Pre-Approved Pools
Proof that all operators within the proposed Pre-Approved Pools were provided notice of this application.
Bottomhole pressure data.

I hereby certify that the information above is true and complete to the best of my knowledge and belief.

SIGNATURE Justin M. Stolworthy TITLE District Engineer DATE 12-8-06

TYPE OR PRINT NAME Justin M. Stolworthy TELEPHONE NO. (505) 325-6800

E-MAIL ADDRESS jstolwor@energen.com

District I

1625 N. French Dr., Hobbs, NM 88240

District II

1301 W. Grand Avenue, Artesia, NM 88210

District III

1000 Rio Brazos Rd., Aztec, NM 87410

District IV

1220 S. St. Francis Dr., Santa Fe, NM 87505

State of New Mexico

Energy, Minerals & Natural Resources Department

OIL CONSERVATION DIVISION

1220 South St. Francis Dr.

Santa Fe, NM 87505

Form C-102

Revised June 10, 2003

Submit to Appropriate District Office

State Lease - 4 Copies

Fee Lease - 3 Copies

☐ AMENDED REPORT

WELL LOCATION AND ACREAGE DEDICATION PLAT

¹ API Number 30-039-26548	² Pool Code 72319/97058	³ Pool Name Blanco Mesaverde/ WC27N3W35; Mancos
⁴ Property Code 21289	⁵ Property Name Jicarilla 95	⁶ Well Number 3C
⁷ OGRID No. 162928	⁸ Operator Name Energen Resources Corporation	⁹ Elevation 7215'

¹⁰ Surface Location

UL or lot no. E	Section 35	Township 27N	Range 3W	Lot Idn	Feet from the 2340	North/South line North	Feet from the 990	East/West line West	County Rio Arriba
--------------------	---------------	-----------------	-------------	---------	-----------------------	---------------------------	----------------------	------------------------	----------------------

¹¹ Bottom Hole Location If Different From Surface

UL or lot no.	Section	Township	Range	Lot Idn	Feet from the	North/South line	Feet from the	East/West line	County
¹² Dedicated Acres 320/160	¹³ Joint or Infill	¹⁴ Consolidation Code	¹⁵ Order No.						

NO ALLOWABLE WILL BE ASSIGNED TO THIS COMPLETION UNTIL ALL INTERESTS HAVE BEEN CONSOLIDATED OR A NON-STANDARD UNIT HAS BEEN APPROVED BY THE DIVISION

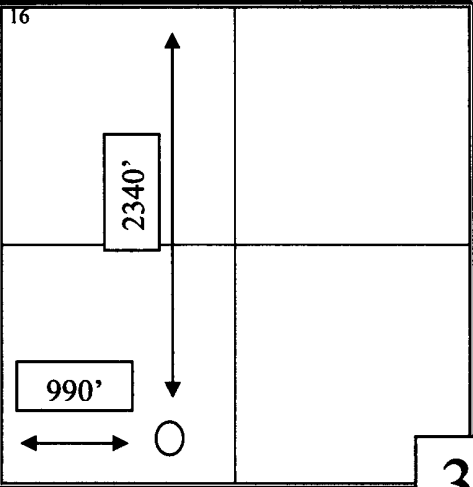
¹⁶ 			

¹⁷ OPERATOR CERTIFICATION

I hereby certify that the information contained herein is true and complete to the best of my knowledge and belief.

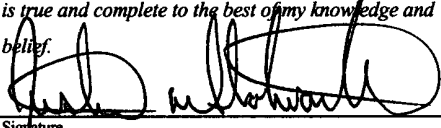
Signature

Justin M. Stolworthy
Printed Name

District Engineer jstolwor@energen.com

Title and E-mail Address

12-8-06
Date

¹⁸ SURVEYOR CERTIFICATION

I hereby certify that the well location shown on this plat was plotted from field notes of actual surveys made by me or under my supervision, and that the same is true and correct to the best of my belief.

June 29, 2000

Date of Survey

Signature and Seal of Professional Surveyor:

Neale C. Edwards

NM 6857

Certificate Number

Energen Resources Corp.
Jicarilla 95 #3C
Offset Operator/ Ownership Plat
Blanco Mesa Verde/WC27N3W35; Mancos
Downhole Commingling

Township 27 N, Range 3 W

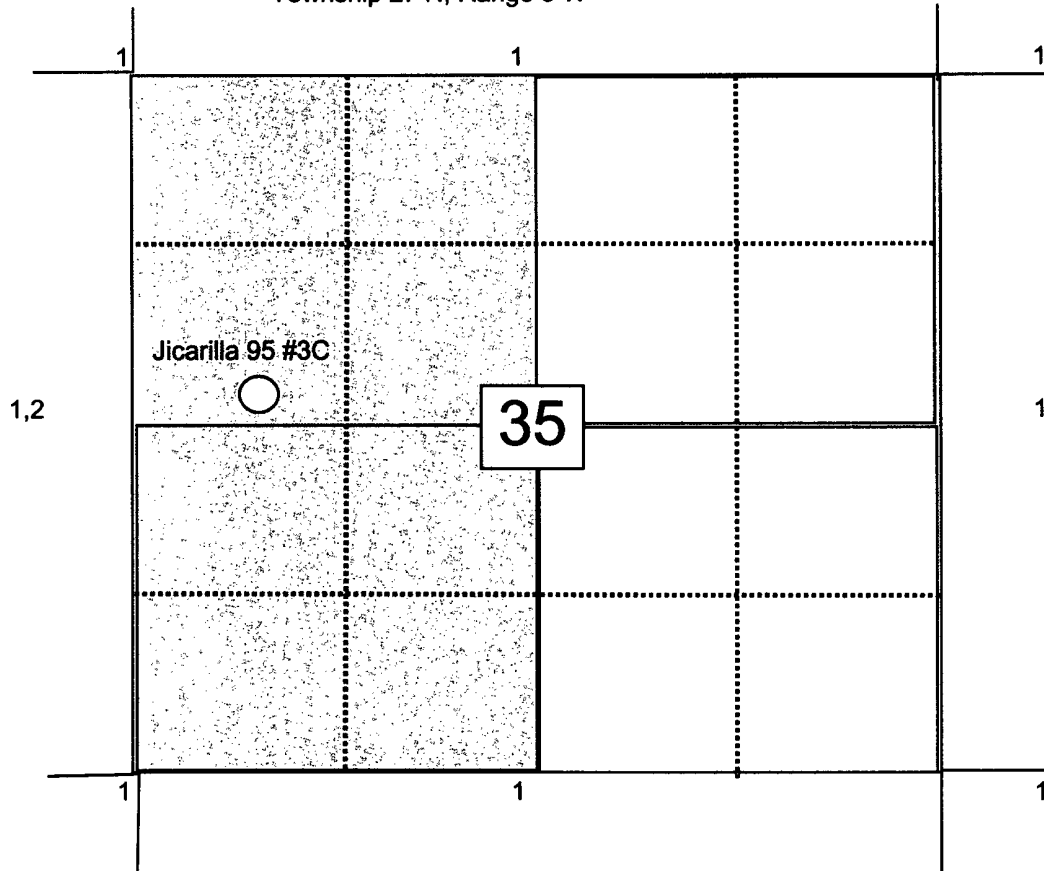

- 1) Energen Resources
- 2) Williams Production

Jicarilla 95 #3C Blanco MV/ WC27N3W35; Mancos

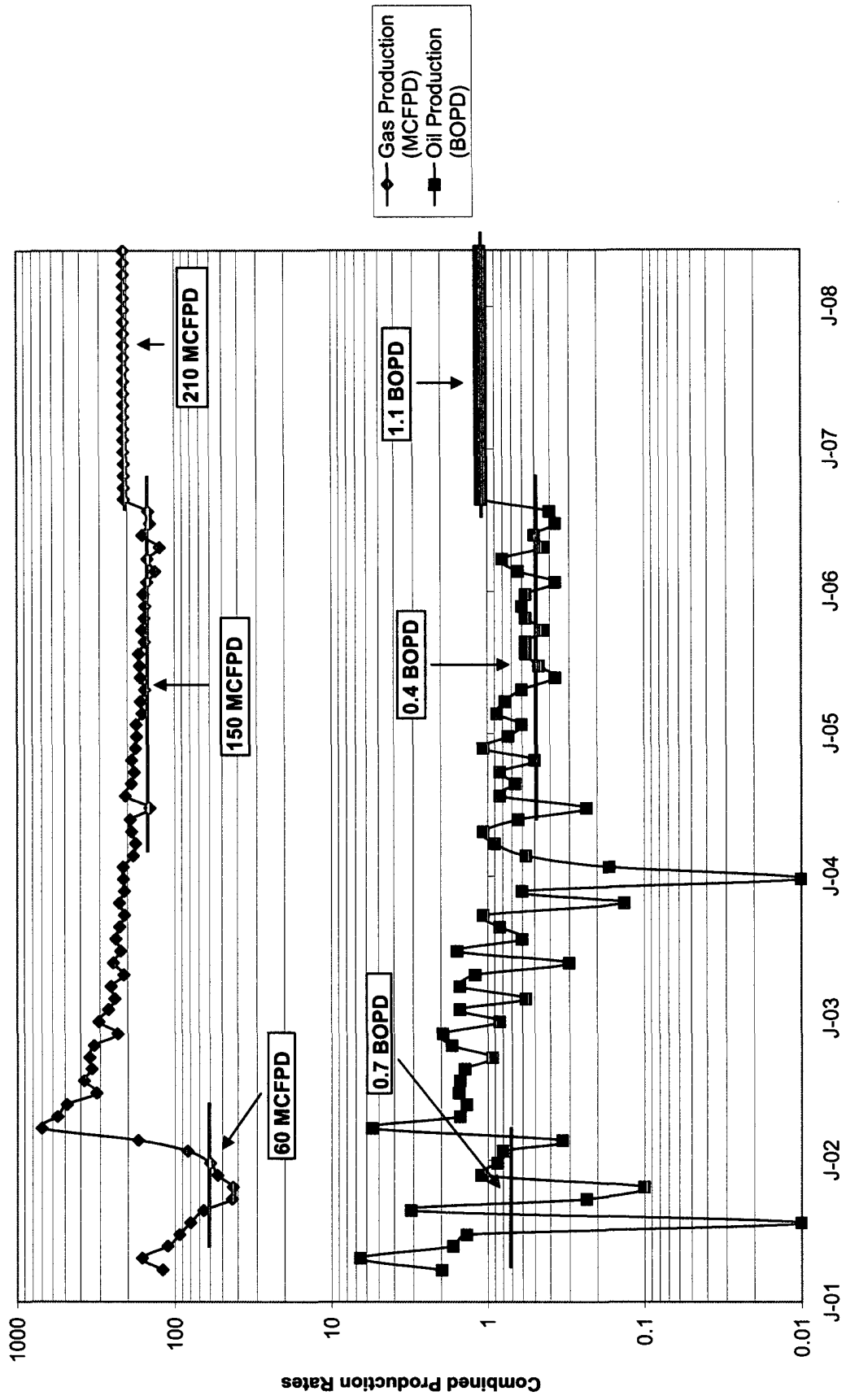

Lease Name: JICARILLA 95
 County, State: RIO ARBA, NM
 Operator: ENERGEN RESOURCES CORPORATION
 Field: WILDCAT
 Reservoir: MANCOS
 Location: 35 27N 3W SE SW NW

JICARILLA 95 - WILDCAT 3C

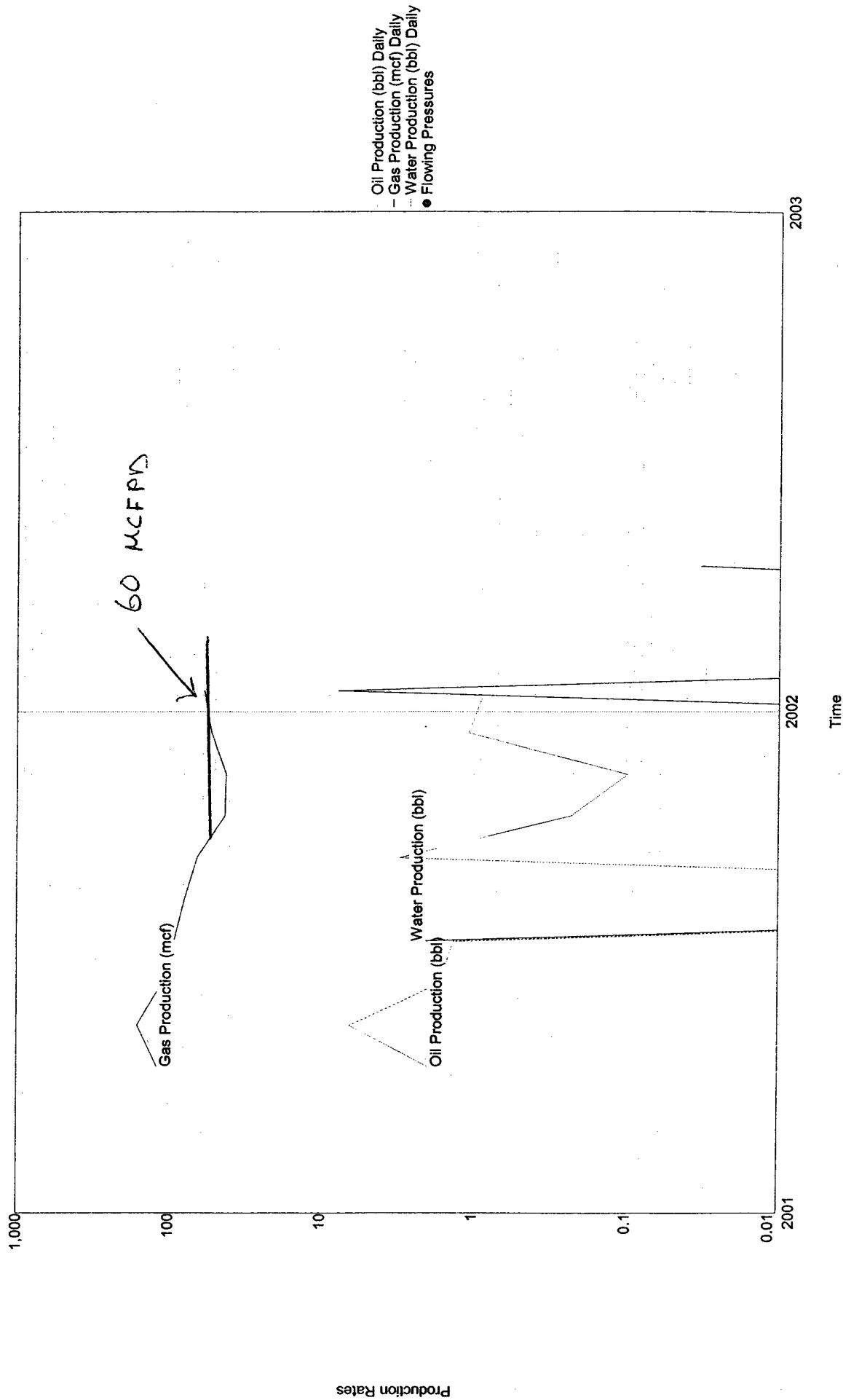

Lease Name: JICARILLA 95
County, State: RIO ARBA, NM
Operator: ENERGEN RESOURCES CORPORATION
Field: BLANCO
Reservoir: MESAVERDE
Location: 35 27N 3W SE SW NW

JICARILLA 95 - BLANCO 3C

