

District I

1625 N. French Dr., Hobbs, NM 88240

District II

1301 W. Grand Ave., Artesia, NM 88210

District III

1000 Rio Brazos Rd., Aztec, NM 87410

District IV

1220 S. St. Francis Dr., Santa Fe, NM 87505

State of New Mexico  
Energy, Minerals and Natural Resources

OIL CONSERVATION DIVISION  
1220 South St. Francis Dr.  
Santa Fe, NM 87505

Form C-103  
May 27, 2004

WELL API NO. 30-039-24642
5. Indicate Type of Lease STATE <input type="checkbox"/> FEE <input checked="" type="checkbox"/>
6. State Oil & Gas Lease No.
7. Lease Name or Unit Agreement Name SIMMS COM 1876
8. Well Number: #6
9. OGRID Number: 013925
10. Pool name or Wildcat Cabresto Canyon Tertiary Ext.

SUNDRY NOTICES AND REPORTS ON WELLS  
(DO NOT USE THIS FORM FOR PROPOSALS TO DRILL OR TO DEEPEN OR PLUG BACK TO A DIFFERENT RESERVOIR. USE "APPLICATION FOR PERMIT" (FORM C-101) FOR SUCH PROPOSALS.)

1. Type of Well: Oil Well ☐ Gas Well ☒ Other

2. Name of Operator

BLACK HILLS GAS RESOURCES, INC.

3. Address of Operator: c/o Agent, Mike Pippin LLC

3104 N. Sullivan, Farmington, NM 87401 505-327-4573

4. Well Location

Unit Letter B : 790 feet from the North line and 1500 feet from the East line

Section 24 Township 30N Range 4W NMPM Rio Arriba County

11. Elevation (Show whether DR, RKB, RT, GR, etc.)  
7068' GL

Pit or Below-grade Tank Application ☐ or Closure ☐

Pit type \_\_\_\_\_ Depth to Groundwater \_\_\_\_\_ Distance from nearest fresh water well \_\_\_\_\_ Distance from nearest surface water \_\_\_\_\_

Pit Liner Thickness: 12 mil Below-Grade Tank: Volume \_\_\_\_\_ bbls; Construction Material \_\_\_\_\_

12. Check Appropriate Box to Indicate Nature of Notice, Report or Other Data

NOTICE OF INTENTION TO:

PERFORM REMEDIAL WORK ☐ PLUG AND ABANDON ☐  
TEMPORARILY ABANDON ☐ CHANGE PLANS ☐  
PULL OR ALTER CASING ☐ MULTIPLE COMPL ☐

OTHER: Plugback & Open Tertiary ☒

SUBSEQUENT REPORT OF:

REMEDIAL WORK ☐ ALTERING CASING ☐  
COMMENCE DRILLING OPNS. ☐ P AND A ☐  
CASING/CEMENT JOB ☐

OTHER: ☐

13. Describe proposed or completed operations. (Clearly state all pertinent details, and give pertinent dates, including estimated date of starting any proposed work). SEE RULE 1103. For Multiple Completions: Attach wellbore diagram of proposed completion or recompletion.

Black Hills Gas Resources plans to plugback the Pictured Cliffs, run a CBL log, & open the Tertiary to production.

RCVD FEB22'07

OIL CONS. DIV.

DIST. 3

I hereby certify that the information above is true and complete to the best of my knowledge and belief. I further certify that any pit or below-grade tank has been/will be constructed or closed according to NMOCD guidelines ☒, a general permit ☐ or an (attached) alternative OCD-approved plan ☐.

SIGNATURE Mike Pippin TITLE Agent, Petroleum Engineer DATE 2/22/07

Type or print name Mike Pippin E-mail address: mike@pippinllc.com Telephone No.: 505-327-4573

For State Use Only

APPROVED BY: [Signature] TITLE DEPUTY OIL & GAS INSPECTOR, DIST. 3 DATE FEB 22 2007

Conditions of Approval (if any): please send procedure for approval

# OIL CONSERVATION DIVISION

**P.O. Box 2088**  
**Santa Fe, New Mexico 87504-2088**

**DISTRICT I**  
P.O. Box 1980, Hobbs, NM 88240

**DISTRIBUTE**  
**P.O. Drawer DD, Artesia, NM 88210**

**DISTRICT III**  
1000 Rio Grande Rd., Aztec, NM 87410

# WELL LOCATION AND ACREAGE DEDICATION PLAT

**All Distances must be from the outer boundaries of the section**

Operator <b>Black Hills Gas Resources</b>			Lease <b>SIMS COM</b>		Well No. <b>6</b>
Unit Letter <b>B</b>	Section <b>24</b>	Township <b>30 N</b>	Range <b>4 W</b>	County <b>NMPM Rio Arriba</b>	
Actual Footage Location of Well: <b>790</b> feet from the <b>North</b> line and <b>1500</b> feet from the <b>East</b> line					
Ground level Elev. <b>7068</b>	Producing Formation <b>Tertiary</b>		Pool <b>Cabresto Canyon Tertiary Ext.</b>		Dedicated Acreage: <b>160 NE/4 Acres</b>
<p>1. Outline the acreage dedicated to the subject well by colored pencil or hatchure marks on the plat below. <b>30-039-24642</b></p> <p>2. If more than one lease is dedicated to the well, outline each and identify the ownership thereof (both as to working interest and royalty).</p> <p>3. If more than one lease of different ownership is dedicated to the well, have the interest of all owners been consolidated by communitization, unitization, force-pooling, etc? <b>COMMUNITIZATION</b></p> <p><input type="checkbox"/> Yes <input type="checkbox"/> No If answer is "yes" type of consolidation</p> <p>If answer is "no" list the owners and tract descriptions which have actually been consolidated. (Use reverse side of this form if necessary).</p> <p>No allowable will be assigned to the well until all interests have been consolidated (by communitization, unitization, forced-pooling, or otherwise) or until a non-standard unit, eliminating such interest, has been approved by the Division.</p>					

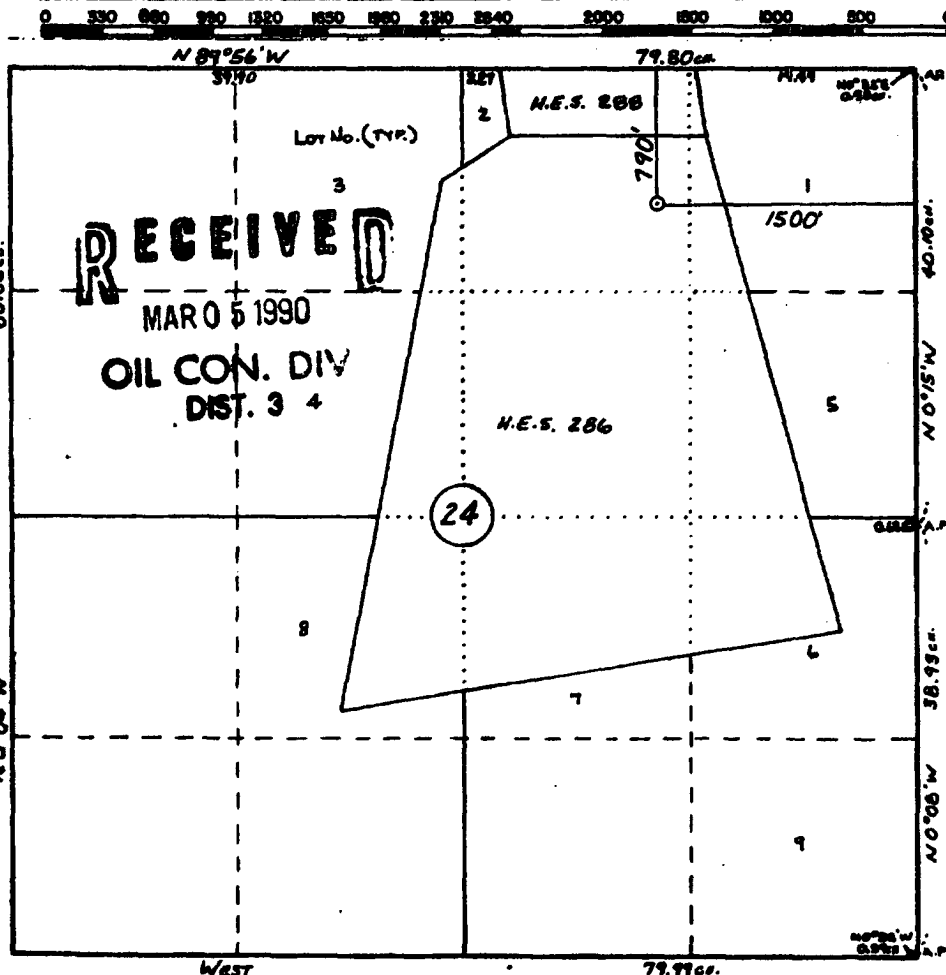

### OPERATOR CERTIFICATION

I hereby certify that the information contained herein is true and complete to the best of my knowledge and belief.

Sig	
Printed Name	Mike Pippin
Position	Petroleum Engineer
Company	Agent - Black Hills
Date	2/22/07

### SURVEYOR CERTIFICATION

I hereby certify that the well location shown on this plat was plotted from field notes of actual surveys made by me or under my supervision, and that the same is true and correct to the best of my knowledge and belief.

2-1-90

**Date Surveyed**  
**William F. Mahnke II**

Signature & Seal of MAHN

