

UNITED STATES
DEPARTMENT OF THE INTERIOR
BUREAU OF LAND MANAGEMENT

RCVD FEB28'07

OIL CONS. DIV.

DIST. 3

APPLICATION FOR PERMIT TO DRILL, DEEPEN, OR PLUG BACK

1a. Type of Work DRILL	5. Lease Number SF-078357 Unit Reporting Number
1b. Type of Well GAS	6. If Indian, All. or Tribe
2. Operator BURLINGTON RESOURCES Oil & Gas Company, LP	7. Unit Agreement Name
3. Address & Phone No. of Operator PO Box 4289, Farmington, NM 87499 (505) 326-9700	8. Farm or Lease Name Marshall 9. Well Number #2M
4. Location of Well Unit D (NWNW), 1290' FNL & 665' FWL, Latitude 36° 34.74011 N Longitude 107° 46.91550 W	10. Field, Pool, Wildcat Basin DK/Blanco MV 11. Sec., Twn, Rge, Mer. (NMPM) Sec. 15, T27N, R9W API # 30-045- 34159
14. Distance in Miles from Nearest Town 28 miles	12. County San Juan 13. State NM
15. Distance from Proposed Location to Nearest Property or Lease Line 665'	
16. Acres in Lease	17. Acres Assigned to Well 319.44 - (N/2) 320
18. Distance from Proposed Location to Nearest Well, Drig. Compl, or Applied for on this Lease 655' Four Starr Marshall A 4/PC	
19. Proposed Depth 6762'	20. Rotary or Cable Tools Rotary
21. Elevations (DF, FT, GR, Etc.) 6145' GL	22. Approx. Date Work will Start
23. Proposed Casing and Cementing Program See Operations Plan attached	
24. Authorized by: <u>Rhonda Rogers</u> Rhonda Rogers (Regulatory Technician)	NOTIFY AZTEC OCT 24hrs IN TIME TO WITNESS Cement T-30-07 Date

PERMIT NO. _____ APPROVAL DATE _____
APPROVED BY [Signature] TITLE Acting AFM DATE 2/22/07
Minerals

Archaeological Report attached

Threatened and Endangered Species Report attached

NOTE: This format is issued in lieu of U.S. BLM Form 3160-3

Title 18 U.S.C. Section 1001, makes it a crime for any person knowingly and willfully to make to any department or agency of the United States any false, fictitious or fraudulent statements or presentations as to any matter within its jurisdiction.

Type

DRILLING OPERATIONS AUTHORIZED ARE
SUBJECT TO COMPLIANCE WITH ATTACHED
"GENERAL REQUIREMENTS".

NMOCD

3/2/07

This action is subject to technical and
procedural review pursuant to 43 CFR 3165.3
and appeal pursuant to 43 CFR 3165.4

DISTRICT I
1626 N. French Dr., Hobbs, N.M. 88240

DISTRICT II
811 South First, Artesia, N.M. 88210

DISTRICT III
1060 Rio Brazos Rd., Aztec, N.M. 87410

DISTRICT IV
2040 South Pacheco, Santa Fe, NM 87505

State of New Mexico
Energy, Minerals & Natural Resources Department

OIL CONSERVATION DIVISION
2040 South Pacheco
Santa Fe, NM 87505

RCVD FEB28'07

OIL CONS. DIV.

Form C-102
Revised August 15, 2000

Submit to Appropriate District Office
State Lease - 4 Copies
Fee Lease - 3 Copies

☐ AMENDED REPORT

WELL LOCATION AND ACREAGE DEDICATION PLAT

¹ API Number 30-045- 34159	² Pool Code 72319/71599	³ Pool Name MESA VERDE/DAKOTA
⁴ Property Code 7289	⁵ Property Name MARSHALL	⁶ Well Number 2M
⁷ OGRIID No. 14538	⁸ Operator Name BURLINGTON RESOURCES O&G CO LP	⁹ Elevation 6145'

¹⁰ Surface Location

UL or lot no.	Section	Township	Range	Lot Idn	Feet from the	North/South line	Feet from the	East/West line	County
D	15	27N	9W		1290'	NORTH	665'	WEST	SAN JUAN

¹¹ Bottom Hole Location If Different From Surface

UL or lot no.	Section	Township	Range	Lot Idn	Feet from the	North/South line	Feet from the	East/West line	County
D									
¹² Dedicated Acres 320 349.44 Acres - (N/2)			¹³ Joint or Infill		¹⁴ Consolidation Code		¹⁵ Order No.		

NO ALLOWABLE WILL BE ASSIGNED TO THIS COMPLETION UNTIL ALL INTERESTS HAVE BEEN CONSOLIDATED
OR A NON-STANDARD UNIT HAS BEEN APPROVED BY THE DIVISION

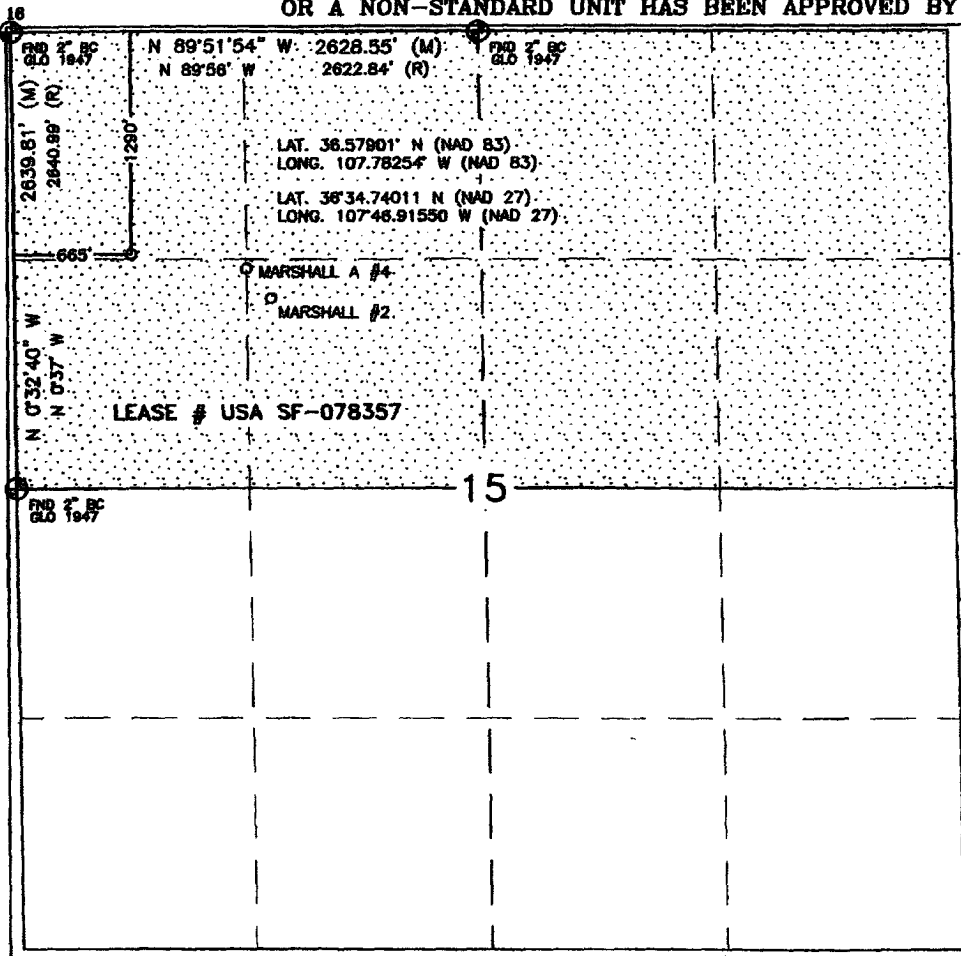

¹⁷ OPERATOR CERTIFICATION

I hereby certify that the information contained herein is true and complete to the best of my knowledge and belief.

Rhonda Rogers
Signature
Rhonda Rogers

Printed Name
Regulatory Technician
Title
October 23 2006
Date

¹⁸ SURVEYOR CERTIFICATION

I hereby certify that the well location shown on this plat was plotted from field notes of actual surveys made by me or under my supervision, and that the same is true and correct to the best of my belief.

SEPTEMBER 27, 2006

Date of Survey

Signature and Seal of Professional Surveyor:

David R. Russell
DAVID R. RUSSELL
NEW MEXICO
REGISTERED PROFESSIONAL LAND SURVEYOR
10201

Certificate Number

10201

District I

1625 N. French Dr., Hobbs, NM 88240

District II

1301 W. Grand Ave., Artesia, NM 88210

District III

1000 Rio Brazos Rd., Aztec, NM 87410

District IV

1220 S. St. Francis Dr., Santa Fe, NM 87505

Energy, Minerals and Natural Resources

OIL CONSERVATION DIVISION

1220 South St. Francis Dr.

Santa Fe, NM 87505

May 27, 2004

WELL API NO.

30-045- **34159**

5. Indicate Type of Lease

STATE ☐

FEE ☐

6. State Oil & Gas Lease No.

USA SF-078357

7. Lease Name or Unit Agreement Name

Marshall

8. Well Number

#2M

9. OGRID Number

14538

10. Pool name or Wildcat

Blanco Mesaverde / Basin Dakota

SUNDRY NOTICES AND REPORTS ON WELLS
(DO NOT USE THIS FORM FOR PROPOSALS TO DRILL OR TO DEEPEN OR PLUG BACK TO A DIFFERENT RESERVOIR. USE "APPLICATION FOR PERMIT" (FORM C-101) FOR SUCH PROPOSALS.)

1. Type of Well:

Oil Well ☐

Gas Well ☒

Other

2. Name of Operator

BURLINGTON RESOURCES OIL & GAS COMPANY LP

3. Address of Operator

3401 E. 30TH STREET, FARMINGTON, NM 87402

4. Well Location

Unit Letter D : 1290' feet from the North line and 665' feet from the West line
Section 15 Township 27N Rng 9W NMPM County San Juan

11. Elevation (Show whether DR, RKB, RT, GR, etc.)

6145'

Pit or Below-grade Tank Application

☐ or Closure ☐

Pit type New Drill Depth to Groundwater >100' Distance from nearest fresh water well

>1000' Distance from nearest surface water

Pit Liner Thickness:

12

mil

Below-Grade Tank: Volume

bbls;

Construction Material

12. Check Appropriate Box to Indicate Nature of Notice, Report or Other Data

NOTICE OF INTENTION TO:

PERFORM REMEDIAL WORK ☐

TEMPORARILY ABANDON ☐

PULL OR ALTER CASING ☐

PLUG AND ABANDON ☐

CHANGE PLANS ☐

MULTIPLE COMPL ☐

OTHER:

New Drill

☒

SUBSEQUENT REPORT OF:

REMEDIAL WORK ☐

COMMENCE DRILLING OPNS. ☐

CASING/CEMENT JOB ☐

ALTERING CASING ☐

P AND A ☐

OTHER: ☐

13. Describe proposed or completed operations. (Clearly state all pertinent details, and give pertinent dates, including estimated date of starting any proposed work). SEE RULE 1103. For Multiple Completions: Attach wellbore diagram of proposed completion or recompletion.

New Drill, Lined:

Burlington Resources proposes to construct a new drilling pit and an associated vent/flare pit. Based on Burlington's interpretation of the Ecosphere's risk ranking criteria, the new drilling pit will be a lined pit as detailed in Burlington's Revised Drilling / Workover Pit Construction / Operation Procedures dated November 11, 2004 on file at the NMOCD office. A portion of the vent/flare pit will be designed to manage fluids and that portion will be lined as per the risk ranking criteria. Burlington Resources anticipates closing these pits according to the Drilling / Workover Pit Closure Procedure dated August 2, 2004 on file at the NMOCD office.

I hereby certify that the information above is true and complete to the best of my knowledge and belief. I further certify that any pit or below-grade tank has been/will be constructed or closed according to NMOCD guidelines ☐, a general permit ☒ or an (attached) alternative OCD-approved plan ☐.

SIGNATURE

Kandis Roland

TITLE

Regulatory Technician

DATE

1/30/2007

Type or print name

Kandis Roland

E-mail address:

kburns@br-inc.com

Telephone No.

505-326-9701

For State Use Only

APPROVED BY

[Signature]

TITLE

DEPUTY OIL & GAS INSPECTOR, DIST. **III**

DATE

2/28/07

Conditions of Approval (if any):

LATITUDE: 36.57901°N
 LONGITUDE: 107.78254°W
 DATUM: NAD 83

BURLINGTON RESOURCES O&G CO LP

MARSHALL #2M

1290' FNL & 665' FWL

LOCATED IN THE NW/4 NW/4 OF

SECTION 15, T27N, R9W, N.M.P.M.,

SAN JUAN COUNTY, NEW MEXICO

GROUND ELEVATION: 6145', NAVD 88

FINISHED PAD ELEVATION: 6145.8', NAVD 88

SLOPES TO BE CONSTRUCTED TO
 MATCH THE ORIGINAL CONTOURS
 AS CLOSE AS POSSIBLE.

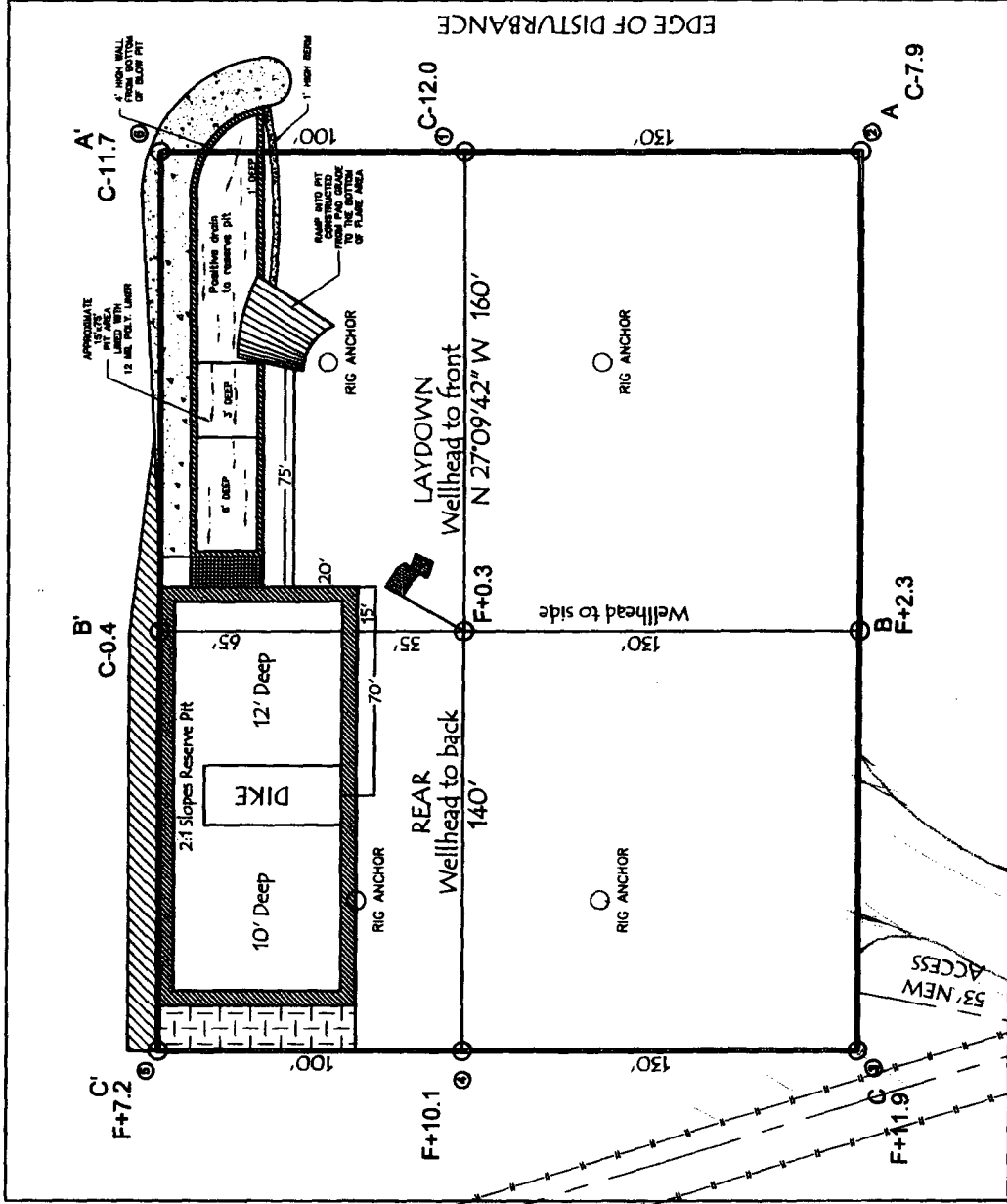
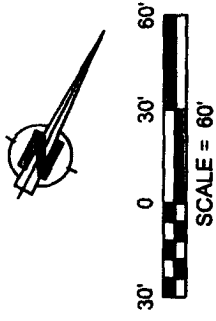

NOTE:
 RESERVE PIT DIKE: TO BE 8' ABOVE DEEP SIDE (OVERFLOW - 3' WIDE AND 1' ABOVE SHALLOW SIDE).
 RUSSELL SURVEYING, INC. IS NOT LIABLE FOR UNDERGROUND UTILITIES OR PIPELINES.
 CONTRACTOR SHOULD CALL ONE-CALL FOR LOCATION OF ANY MARKED OR UNMARKED, BURIED PIPELINES OR
 CABLES ON WELL PAD, IN CONSTRUCTION ZONE AND/OR ACCESS ROAD AT LEAST TWO (2) WORKING DAYS PRIOR
 TO CONSTRUCTION.

330' x 400' = 3.03 ACRES OF DISTURBANCE
 SCALE: 1" = 60'
 JOB No.: COPC045
 DATE: 10/03/06

Russell Surveying
 1409 W. Aztec Blvd. #5
 Aztec, New Mexico 87410
 (505) 334-8637

LATITUDE: 36.57901°N
LONGITUDE: 107.78254°W
DATUM: NAD 83

BURLINGTON RESOURCES O&G CO LP

MARSHALL #2M
1290' FNL & 665' FWL
LOCATED IN THE NW/4 NW/4 OF
SECTION 15, T27N, R9W, N.M.P.M.,
SAN JUAN COUNTY, NEW MEXICO
GROUND ELEVATION: 6145', NAVD 88
FINISHED PAD ELEVATION: 6145.8', NAVD 88

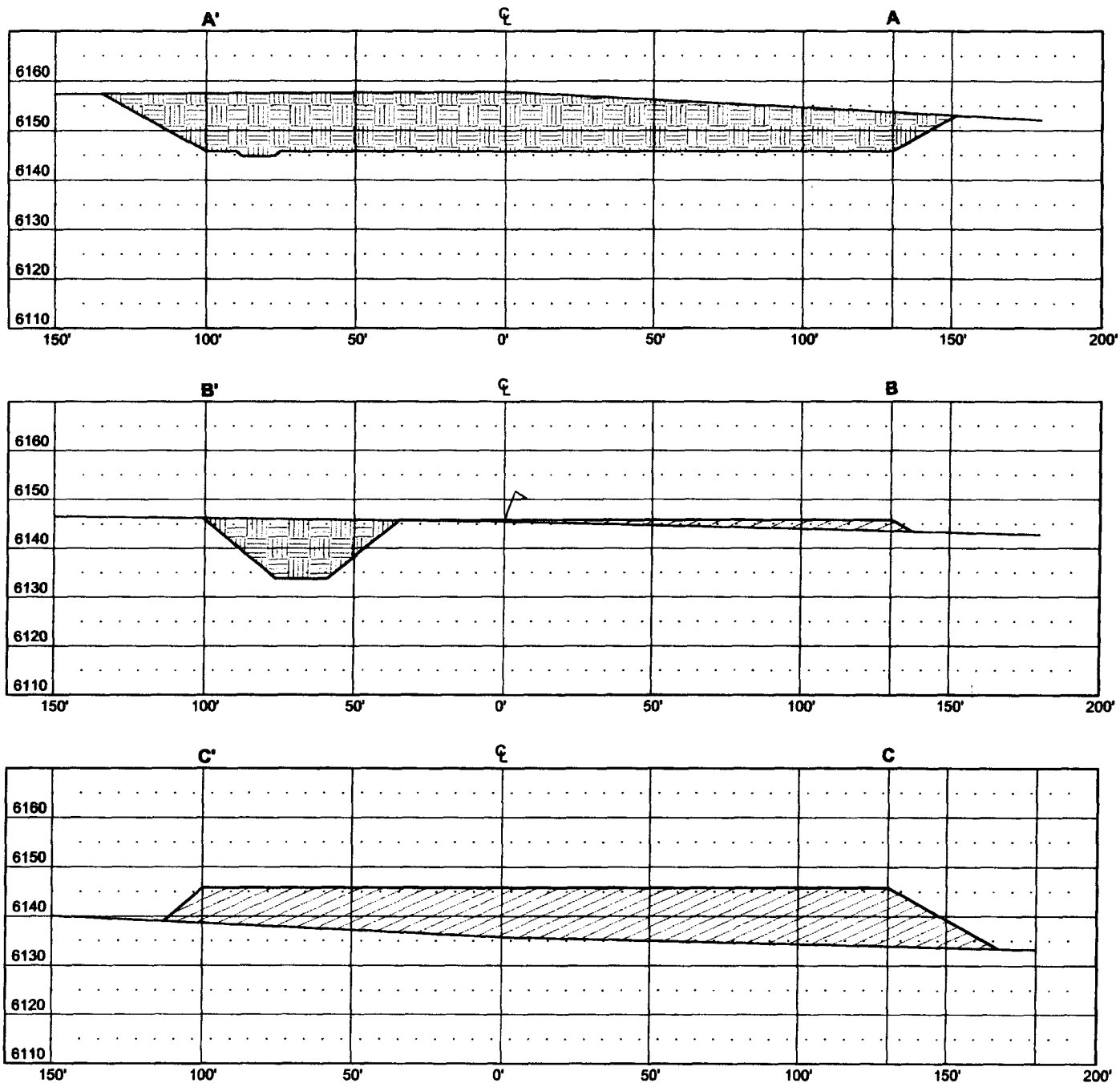

THIS DIAGRAM IS AN ESTIMATE OF DIRT BALANCE AND IS NOT INTENDED TO BE AN EXACT MEASURE OF VOLUME

VERT. SCALE: 1" = 30'
HORZ. SCALE: 1" = 50'
JOB No.: COPC045
DATE: 10/03/06

 CUT
 FILL



Russell Surveying
1409 W. Aztec Blvd. #5
Aztec, New Mexico 87410
(505) 334-8637

PROJECT PROPOSAL - New Drill / Sidetrack

San Juan Business Unit

MARSHALL 2M

Lease:	AFE #: WAN.ZA2.7963/WAN.ZA2.7964			AFE \$:
Field Name: hBR_SAN JUAN	Rig: Aztec Rig 711	State: NM	County: SAN JUAN	API #:
Geoscientist: Riley, Brook	Phone: +1 505-324-6108	Prod. Engineer:	Phone:	
Res. Engineer: McKee, Cory J	Phone: 505-326-9826	Proj. Field Lead:	Phone:	

Primary Objective (Zones):

Zone	Zone Name
R20002	MESAVERDE(R20002)
R20076	DAKOTA(R20076)

Location: Surface	Datum Code: NAD 27	Straight Hole		
Latitude: 36.579002	Longitude: -107.781925	X:	Y:	Section: 15
Footage X: 665 FWL	Footage Y: 1290 FNL	Elevation: 6145 (FT)	Township: 027N	
Tolerance:				

Location Type: Year Round	Start Date (Est.):	Completion Date:	Date In Operation:
Formation Data: Assume KB = 6157 Units = FT			

Formation Call & Casing Points	Depth (TVD in Ft)	SS (Ft)	Depletion (Yes/No)	BHP (PSIG)	BHT	Remarks
Surface Casing	216	5941	<input type="checkbox"/>			12-1/4 hole. 9 5/8" 32.3 ppf, H-40, STC casing. Cement with 175 cuft. Circulate cement to surface.
OJO ALAMO	1262	4895	<input type="checkbox"/>			
KIRTLAND	1327	4830	<input type="checkbox"/>			
FRUITLAND	1910	4247	<input type="checkbox"/>			Possible Gas
PICTURED CLIFFS	2130	4027	<input type="checkbox"/>			Gas
LEWIS	2282	3875	<input type="checkbox"/>			
Intermediate Casing	2432	3725	<input type="checkbox"/>			8 3/4" Hole. 7", 20 ppf, J-55, STC Casing. Cement with 540 cuft. Circulate cement to surface.
HUERFANITO BENTONITE	2632	3525	<input type="checkbox"/>			
CHACRA	3047	3110	<input type="checkbox"/>			
MASSIVE CLIFF HOUSE	3704	2453	<input type="checkbox"/>			Gas
MENEFEE	3794	2363	<input type="checkbox"/>			Gas
MASSIVE POINT LOOKOUT	4427	1730	<input type="checkbox"/>			Gas
MANCOS	4777	1380	<input type="checkbox"/>			
UPPER GALLUP	5624	533	<input type="checkbox"/>			
GREENHORN	6424	-267	<input type="checkbox"/>			
GRANEROS	6480	-323	<input type="checkbox"/>			
TWO WELLS	6524	-367	<input type="checkbox"/>			Gas
PAGUATE	6594	-437	<input type="checkbox"/>			Gas
UPPER CUBERO	6657	-500	<input type="checkbox"/>			Gas
LOWER CUBERO	6666	-509	<input type="checkbox"/>			Gas
ENCINAL	6719	-562	<input type="checkbox"/>			Gas Estimated bottom perf 6752.
TOTAL DEPTH DK	6762	-605	<input type="checkbox"/>	1700		6-1/4" Hole. 4-1/2", 10.6/11.6 ppf, J-55 STC/LTC casing. Cement with 600 cuft. Circulate cement a minimum of 100' inside the previous casing string.

Reference Wells:		
Reference Type	Well Name	Comments
Production	Marshall 2	NW15-27N-09W
Production	Bunny Et Al 1E	SW10-27N-09W

PROJECT PROPOSAL - New Drill / Sidetrack

MARSHALL 2M

Logging Program:

Intermediate Logs: ☐ Log only if show ☐ GR/ILD ☐ Triple Combo

TD Logs: ☐ Triple Combo ☐ Dipmeter ☐ RFT ☐ Sonic ☐ VSP ☐ TDT ☒ Other
GR / CBL

Additional Information:

Log Type	Stage	From (Ft)	To (Ft)	Tool Type/Name	Remarks
----------	-------	-----------	---------	----------------	---------

Comments: Location/Tops/Logging - DK 27N09W15NW2 AND MVNM027N009W15NW1 BHP ~ 1700#

Zones - DK 27N09W15NW2 AND MVNM027N009W15NW1

General/Work Description - NO LEWIS

BURLINGTON RESOURCES O&G CO LP

MARSHALL #2M

1290' FNL & 665' FWL

LOCATED IN THE NW/4 NW/4 OF
SECTION 15, T27N, R9W, N.M.P.M.,
SAN JUAN COUNTY, NEW MEXICO

DIRECTIONS

FROM BLOOMFIELD, NM, TRAVEL SOUTH ON U.S. HIGHWAY 550 15.5 MILES TO COUNTY ROAD 7225.
TURN LEFT ONTO COUNTY ROAD 7225 AND TRAVEL 12.0 MILES TO INTERSECTION.
TURN LEFT AND TRAVEL 1.1 MILES.
TURN LEFT AND TRAVEL 0.1 MILES.
TURN RIGHT AND TRAVEL 0.5 MILES TO 2 TRACK ROAD.
TURN RIGHT ONTO 2 TRACK AND TRAVEL 0.1 MILES TO FLAGGED ACCESS ON RIGHT..
WELL FLAG LOCATED AT LAT. 36.57901° N, LONG. 107.78254° W

JOB No.: COPC045
DATE: 10/03/06



Russell Surveying
1409 W. Aztec Blvd. #5
Aztec, New Mexico 87410
(505) 334-8637