

UNITED STATES
DEPARTMENT OF THE INTERIOR
BUREAU OF LAND MANAGEMENT

RCVD MAR9'07
OIL CONS. DIV.
DIST. 3

APPLICATION FOR PERMIT TO DRILL, DEEPEN, OR PLUG BACK

1a. Type of Work DRILL	5. Lease Number NMNM-02758 Unit Reporting Number
1b. Type of Well GAS	6. If Indian, All. or Tribe
2. Operator BURLINGTON RESOURCES Oil & Gas Company, LP	7. Unit Agreement Name
3. Address & Phone No. of Operator PO Box 4289, Farmington, NM 87499 (505) 326-9700	8. Farm or Lease Name Murphy D 9. Well Number #100
4. Location of Well Unit I (NESE), 1690' FSL & 1090' FEL, Latitude 36° 46.8341'N Longitude 107° 58.3504'W	10. Field, Pool, Wildcat Basin Fruitland Coal 11. Sec., Twn, Rge, Mer. (NMPM) I Sec. 27, 30N, R11W API # 30-045-34175
14. Distance in Miles from Nearest Town	12. County San Juan 13. State NM
15. Distance from Proposed Location to Nearest Property or Lease Line 1090'	
16. Acres in Lease	17. Acres Assigned to Well FC - 317.66 8/2
18. Distance from Proposed Location to Nearest Well, Drlg, Compl, or Applied for on this Lease	
19. Proposed Depth 2550'	20. Rotary or Cable Tools Rotary
21. Elevations (DF, FT, GR, Etc.) 5983' GL	22. Approx. Date Work will Start
23. Proposed Casing and Cementing Program See Operations Plan attached	NOTIFY AZTEC OCD 24hrs IN TIME TO WITNESS 2/15/07
24. Authorized by: <u>Patsy Wright</u> Sr. Regulatory Specialist	Date <u>2/15/07</u>

PERMIT NO.

APPROVAL DATE

APPROVED BY

TITLE

DATE

Archaeological Report attached

Threatened and Endangered Species Report attached

NOTE: This format is issued in lieu of U.S. BLM Form 3160-3

Title 18 U.S.C. Section 1001, makes it a crime for any person knowingly and willfully to make to any department or agency of the United States any false, fictitious or fraudulent statements or presentations as to any matter within its jurisdiction.

EXAMPLE 2 - SEE MASTER PLAN

This action is subject to technical and procedural review pursuant to 43 CFR 3165.3 and appeal pursuant to 43 CFR 3165.4

NMOCD 2/13/07

DRILLING OPERATIONS AUTHORIZED ARE SUBJECT TO COMPLIANCE WITH ATTACHED "GENERAL REQUIREMENTS".

DISTRICT I

1625 N. French Dr., Hobbs, N.M. 88240

State of New Mexico
Energy, Minerals & Natural Resources Department

DISTRICT II

1301 W. Grand Avenue, Artesia, N.M. 88210

OIL CONSERVATION DIVISION

1220 South St. Francis Dr.
Santa Fe, N.M. 87505Revised October 12, 2005
Submit to Appropriate District Office

State Lease - 4 Copies

Fee Lease - 3 Copies

DISTRICT III

1000 Rio Brazos Rd., Aztec, N.M. 87410

DISTRICT IV

1220 S. St. Francis Dr., Santa Fe, N.M. 87505

☐ AMENDED REPORT

WELL LOCATION AND ACREAGE DEDICATION PLAT

API Number 30-045 - 34175		Pool Code 71629	Pool Name BASIN (FRUITLAND COAL)
Property Code 7330	Property Name MURPHY D		Well Number 100
Order No. 14538	Operator Name BURLINGTON RESOURCES OIL & GAS CO. LP.		Elevation 5983

10 Surface Location

UL or lot no.	Section	Township	Range	Lot kdn	Feet from the	North/South line	Feet from the	East/West line	County
1	27	30 N	11 W	(9)	1690	SOUTH	1090	EAST	SAN JUAN

11 Bottom Hole Location If Different From Surface

UL or lot no.	Section	Township	Range	Lot kdn	Feet from the	North/South line	Feet from the	East/West line	County

Dedicated Acres	Print or Initial	Consolidation Code	Order No.
317.76	5/6		

NO ALLOWABLE WILL BE ASSIGNED TO THIS COMPLETION UNTIL ALL INTERESTS HAVE BEEN CONSOLIDATED
OR A NON-STANDARD UNIT HAS BEEN APPROVED BY THE DIVISION

16 S 88°02'12" E 2590.60'	2590.60'	S 88°00'02" E 2588.31'	2588.31'	17 OPERATOR CERTIFICATION I hereby certify that the information contained herein is true and complete to the best of my knowledge and belief, and that this organization either owns a working interest or undivided mineral interest in the land including the proposed bottom hole location or has a right to drill this well at this location pursuant to a contract with an owner of such a mineral or working interest, or to a voluntary pooling agreement or a compulsory pooling order heretofore entered by the division. Signature: <u>Amanda Sanchez</u> Date: <u>12-21-06</u> Printed Name: <u>Amanda Sanchez</u>
LOTS 4	LOTS 3	LOTS 2	LOTS 1	
N 0°20'19" W 2675.93'	2675.93'	N 0°21'23" E 2659.72'	2659.72'	18 SURVEYOR CERTIFICATION I hereby certify that the well location shown on this plat was plotted from field notes of actual surveys made by me or under my supervision, and that the same is true and correct to the best of my belief. Date of Survey: <u>11/28/06</u> Signature and Seal of Professional Surveyor: <u>[Signature]</u> Certificate Number: <u>17078</u>
LOTS 5	LOTS 6	LOTS 7	LOTS 8	
SECTION 27 NAD 83 LAT: 36.780572° N LONG: 107.973129° W NAD 27 LAT: 36° 46.8341' N LONG: 107° 58.3504' W USA NM-02758				1690' 1690' 2595.27'
2675.06'	2675.06'	2675.06'	2675.06'	
LOTS 12	LOTS 11	LOTS 10	LOTS 9	1690' 1690' 2595.27'
LOTS 13	LOTS 14	LOTS 15	LOTS 16	
N 88°19'56" W 2585.27'	2585.27'	N 88°20'13" W 2595.27'	2595.27'	



District I

1625 N. French Dr., Hobbs, NM 88240

District II

1301 W. Grand Ave., Artesia, NM 88210

District III

1000 Rio Brazos Rd., Aztec, NM 87410

District IV

1220 S. St. Francis Dr., Santa Fe, NM 87505

Energy, Minerals and Natural Resources

OIL CONSERVATION DIVISION

1220 South St. Francis Dr.

Santa Fe, NM 87505

SUNDRY NOTICES AND REPORTS ON WELLS (DO NOT USE THIS FORM FOR PROPOSALS TO DRILL OR TO DEEPEN OR PLUG BACK TO A DIFFERENT RESERVOIR. USE "APPLICATION FOR PERMIT" (FORM C-101) FOR SUCH PROPOSALS.)		WELL API NO. 30-045- 34175
1. Type of Well: Oil Well <input type="checkbox"/> Gas Well <input checked="" type="checkbox"/> Other <input type="checkbox"/>		5. Indicate Type of Lease STATE <input type="checkbox"/> FEE <input type="checkbox"/>
2. Name of Operator BURLINGTON RESOURCES OIL & GAS COMPANY LP		6. State Oil & Gas Lease No. USA-NM-02758
3. Address of Operator 3401 E. 30TH STREET, FARMINGTON, NM 87402		7. Lease Name or Unit Agreement Name Murphy D
4. Well Location Unit Letter <u>I</u> : <u>1690'</u> feet from the <u>South</u> line and <u>1090'</u> feet from the <u>East</u> line Section <u>27</u> Township <u>30N</u> Rng <u>11W</u> NMPM County <u>San Juan</u>		8. Well Number 100
11. Elevation (Show whether DR, RKB, RT, GR, etc.) 5983'		9. OGRID Number 14538
Pit or Below-grade Tank Application <input type="checkbox"/> or Closure <input type="checkbox"/>		10. Pool name or Wildcat Basin Fruitland Coal
Pit type <u>New Drill</u> Depth to Groundwater <u>>100'</u> Distance from nearest fresh water well <u>>1000'</u> Distance from nearest surface water <u>>200'</u> Pit Liner Thickness: <u>12</u> mil Below-Grade Tank: Volume _____ bbls; Construction Material <u>>200'</u>		

12. Check Appropriate Box to Indicate Nature of Notice, Report or Other Data

NOTICE OF INTENTION TO:
 PERFORM REMEDIAL WORK ☐
 TEMPORARILY ABANDON ☐
 PULL OR ALTER CASING ☐

 PLUG AND ABANDON ☐
 CHANGE PLANS ☐
 MULTIPLE COMPL ☐

OTHER:

New Drill ☒**SUBSEQUENT REPORT OF:**
 REMEDIAL WORK ☐
 COMMENCE DRILLING OPNS. ☐
 CASING/CEMENT JOB ☐

 ALTERING CASING ☐
 P AND A ☐
OTHER: ☐

13. Describe proposed or completed operations. (Clearly state all pertinent details, and give pertinent dates, including estimated date of starting any proposed work). SEE RULE 1103. For Multiple Completions: Attach wellbore diagram of proposed completion or recompletion.

New Drill, Lined:

Burlington Resources proposes to construct a new drilling pit, an associated vent/flare pit and a pre-set mud pit (if required). Based on Burlington's interpretation of the Ecosphere's risk ranking criteria, the new drilling pit and pre-set mud pit will be lined pits as detailed in Burlington's Revised Drilling / Workover Pit Construction / Operation Procedures dated November 11, 2004 on file at the NMOCD office. A portion of the vent/flare pit will be designed to manage fluids and that portion will be lined as per the risk ranking criteria. Burlington Resources anticipates closing these pits according to the Drilling / Workover Pit Closure Procedure dated August 2, 2004 on file at the NMOCD office.

 I hereby certify that the information above is true and complete to the best of my knowledge and belief. I further certify that any pit or below-grade tank has been/will be constructed or closed according to NMOCD guidelines ☐, a general permit ☒ or an (attached) alternative OCD-approved plan ☐.

SIGNATURE

Patsy Clugston

TITLE

Sr. Regulatory Specialist

DATE

2/15/2007

Type or print name

Patsy Clugston

E-mail address:

pclugston@brc-inc.com

Telephone No.

505-326-9700

For State Use Only

APPROVED BY

[Signature]

TITLE

DEPUTY OIL & GAS INSPECTOR, DIST. #2

DATE

MAR 13 2007

Conditions of Approval (if any):

BURLINGTON RESOURCES OIL & GAS CO. LP.
MURPHY D 100 - 1690' FSL & 1090' FEL
SECTION 27, T-30-N, R-11-W, N.M.P.M., SAN JUAN COUNTY, N.M.
GROUND ELEVATION: 5983 - DATE: NOVEMBER 28, 2006

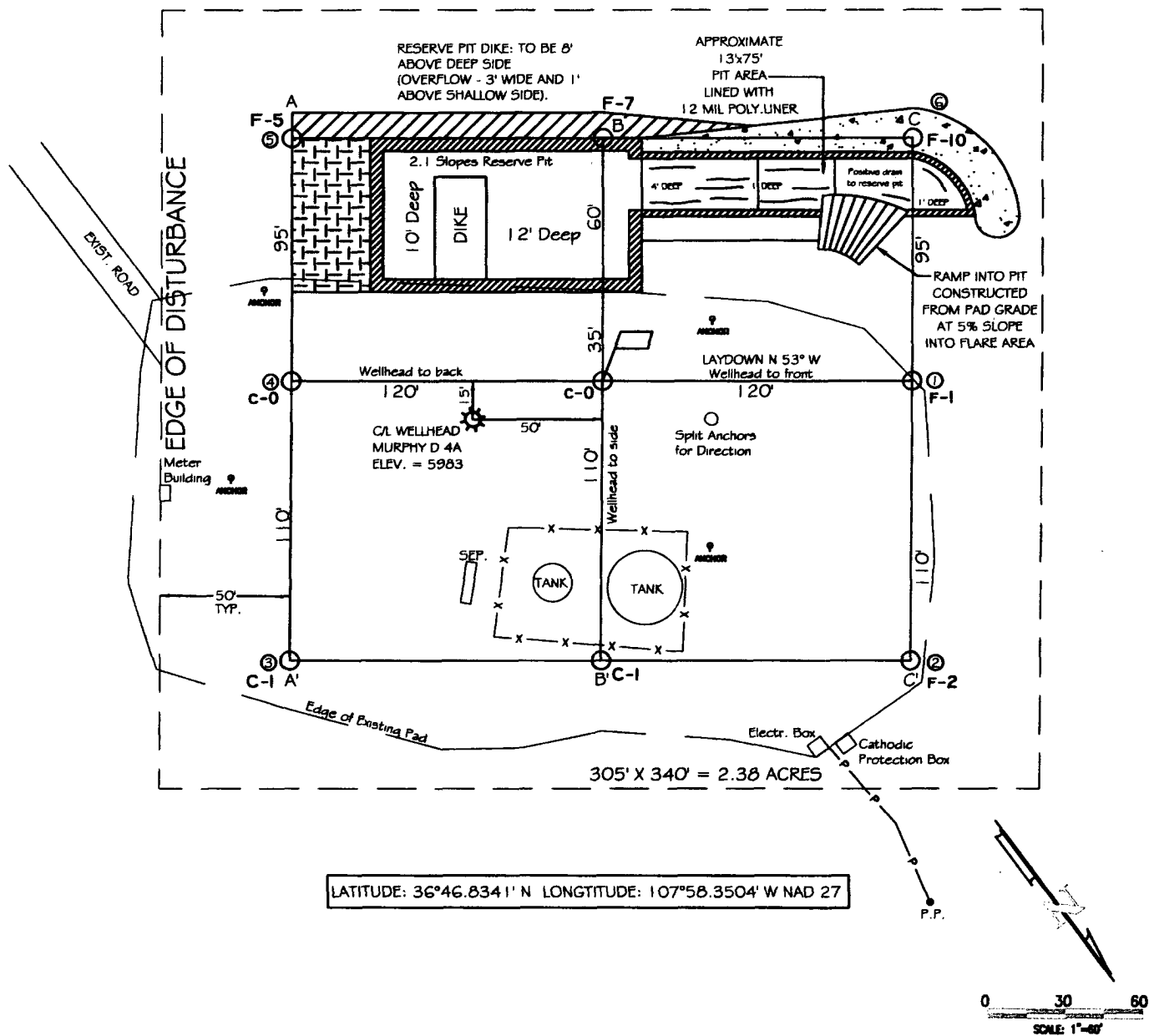

NOTES:

- 1.) CONTRACTOR SHOULD CALL "ONE-CALL" FOR LOCATION OF ANY MARKED OR UNMARKED BURIED PIPELINES OR CABLES ON WELLPAD AND OR ACCESS ROAD AT LEAST TWO (2) WORKING DAYS PRIOR TO CONST.
- 2.) UNITED FIELD SERVICES, INC. IS NOT LIABLE FOR UNDERGROUND UTILITIES OR PIPELINES.

SURVEYED: 11/28/06	REV. DATE:	APP. BY M.L.
DRAWN BY: H.S.	DATE DRAWN: 12/08/06	FILE NAME: 7358L01

UNITED
FIELD SERVICES INC.

P.O. BOX 3651
FARMINGTON, NM 87499
OFFICE: (505)334-0408

BURLINGTON RESOURCES OIL & GAS CO. LP.
MURPHY D 100 - 1690' FSL & 1090' FEL
SECTION 27, T-30-N, R-11-W, N.M.P.M., SAN JUAN COUNTY, N.M.
GROUND ELEVATION: 5983 - DATE: NOVEMBER 28, 2006

ELEVATION

A-A'

£

6000
5990
5980
5970
5960

B-B'

£

6000
5990
5980
5970
5960

C-C'

£

6000
5990
5980
5970
5960

1" = 60' - HORIZ.

1" = 30' - VERT.

NOTES:

1.) CONTRACTOR SHOULD CALL "ONE-CALL" FOR LOCATION OF ANY MARKED OR UNMARKED BURIED PIPELINES OR CABLES ON WELLPAD AND OR ACCESS ROAD AT LEAST TWO (2) WORKING DAYS PRIOR TO CONST.

2.) UNITED FIELD SERVICES, INC. IS NOT LIABLE FOR UNDERGROUND UTILITIES OR PIPELINES.

SURVEYED: 11/28/06

REV. DATE:

APP. BY M.L.

DRAWN BY: H.S.

DATE DRAWN: 12/08/06

FILE NAME: 7358C01

UNITED
FIELD SERVICES INC.

P.O. BOX 3651
FARMINGTON, NM 87499
OFFICE: (505)334-0408

PROJECT PROPOSAL - New Drill / Sidetrack

MURPHY D 100

Lease:		AFE #: WAN.CDR.7057		AFE \$:	
Field Name: hBR_SAN JUAN		Rig: Aztec Rig 580		State: NM	County: SAN JUAN
Geoscientist: Clark, Dave D		Phone: 505-326-9762		Prod. Engineer: Phone:	
Res. Engineer: Schlabaugh, Jim L		Phone: 505-326-9788		Proj. Field Lead: Phone:	

Primary Objective (Zones):

Zone	Zone Name
2035	FRUITLAND COAL
RCO087	FRUITLAND SAND(RCO087)

Location: Surface		Datum Code: NAD 27		Straight Hole	
Latitude: 36.780568	Longitude: -107.972507	X:	Y:	Section: 27	Range: 011W
Footage X: 1090 FEL		Footage Y: 1690 FSL		Elevation: 5983 (FT)	Township: 030N
Tolerance:					

Location Type: Year Round	Start Date (Est.):	Completion Date:	Date In Operation:
Formation Data: Assume KB = 5995 Units = FT			

Formation Call & Casing Points	Depth (TVD in Ft)	SS (Ft)	Depletion (Yes/No)	BHP (PSIG)	BHT	Remarks
SURFACE CSG	120	5875	<input type="checkbox"/>			8-3/4" hole 7" 20 ppf, J-55, STC, casing. Cement with 50 cuft. Circulate cement to surface.
OJO ALAMO	971	5024	<input type="checkbox"/>			Possible water
KIRTLAND	1095	4900	<input type="checkbox"/>			
FRUITLAND	2025	3970	<input type="checkbox"/>			Gas
PICTURED CLIFFS	2350	3645	<input type="checkbox"/>			Gas
Total Depth	2550	3445	<input type="checkbox"/>	400		6-1/4" hole 4-1/2" 10.5 ppf, J-55, STC casing. Cement with 392 cuft. Circulate cement to surface.

Reference Wells:

Reference Type	Well Name	Comments
----------------	-----------	----------

Logging Program:

Intermediate Logs: ☐ Log only if show ☐ GR/ILD ☐ Triple Combo

TD Logs: ☐ Triple Combo ☐ Dipmeter ☐ RFT ☐ Sonic ☐ VSP ☐ TDT ☒ Other
GR/CBL

Additional Information:

Log Type	Stage	From (Ft)	To (Ft)	Tool Type/Name	Remarks
----------	-------	-----------	---------	----------------	---------

Comments: Location/Tops/Logging - FCNM030N011W27SW1 and FSNM030N011W27SW1 Twin offset is Murphy D 4 SE27-30N-11W.

Zones - FCNM030N011W27SW1 and FSNM030N011W27SW1

General/Work Description - MAKE SURE COST INCLUDE JET PUMP