

1-30-039-06798  
2-30-039-06797

418412

DATA SHEET FOR DEEP GROUND BED CATHODIC PROTECTION WELLS  
NORTHWESTERN NEW MEXICO  
(Submit 3 copies to OCD Aztec Office)

Operator MERIDIAN OIL Location: Unit SW Sec. 34 Twp 27 Rng 6

Name of Well/Wells or Pipeline Serviced REUTER #1, #2

cps 707w

Elevation 6505' Completion Date 11/15/65 Total Depth 340' Land Type\* N/A

Casing, Sizes, Types & Depths N/A

If Casing is cemented, show amounts & types used N/A

If Cement or Bentonite Plugs have been placed, show depths & amounts used  
N/A

Depths & thickness of water zones with description of water when possible:  
Fresh, Clear, Salty, Sulphur, Etc. N/A

**RECEIVED**

MAY 31 1991.

Depths gas encountered: N/A

**OIL CON. DIV.**  
**DIST. 3**

Type & amount of coke breeze used: 4800 lbs.

Depths anodes placed: 280', 274', 268', 262', 256', 250', 244', 238', 100', 94'

Depths vent pipes placed: 110' of 3/4" HOSE

Vent pipe perforations: N/A

Remarks: gb #1

If any of the above data is unavailable, please indicate so. Copies of all logs, including Drillers Log, Water Analyses & Well Bore Schematics should be submitted when available. Unplugged abandoned wells are to be included.

\*Land Type may be shown: F-Federal; I-Indian; S-State; P-Fee.  
If Federal or Indian, add Lease Number.

WELL CASING  
 CATHODIC PROTECTION CONSTRUCTION REPORT  
 DAILY LOG

Date 11-15-65

Well Name <b>Reuter #1 &amp; 2</b>			CPS No. <b>707W</b>			
Location <b>SW 34-27-6</b>			Work Order No. <b>164 52506 54183-50-20</b>			
Anode Hole Depth <b>340</b>	Total Drilling Rig Time <b>25 Hrs</b>	Type & Size Bit Used <b>7 7/8, 93216 = 340'</b>		No. Sacks Mud Used <b>0</b>		
No. Sacks Lost Circulation Mat'l Used <b>0</b>	Anode Depth		# 1 <b>280</b>	# 2 <b>274</b>	# 3 <b>268</b>	# 4 <b>262</b>
Total Lbs. Coke Used <b>4800</b>	Anode Output (Volts)		# 1 <b>2.2</b>	# 2 <b>4.2</b>	# 3 <b>4.0</b>	# 4 <b>3.5</b>
Total Circuit Resistance Volts <b>11.6</b>	Amps <b>12.2</b>	Ohms <b>0.95</b>	No. Ft. Surface Cable Conduit <b>685</b>			

Drilling Log (Attach Hereto)

Remarks: Static 600 W #2 = .70    600' SW #1 = .67  
3/4" Plastic Hose to #9 Anode = 110' = 4 lbs Chem. to Hole  
8 Anodes = 1.8m  
# 30Y 20A Good All Rectifier Ser. 65C6675 - 3 Neg

All Construction Completed

*Arreals*  
 (Signature)

GROUND BED LAYOUT SKETCH

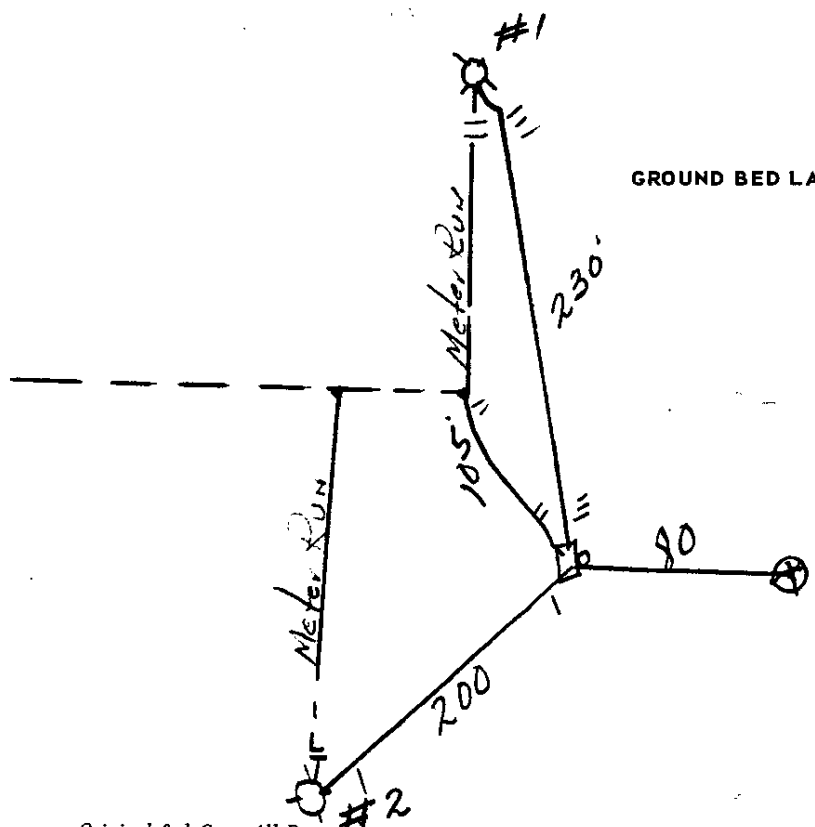

3057 #8 WIFE

707 (10)

DRILLING DEPARTMENT

DAILY DRILLING REPORT

LEASE: WELL NO. 10-11-65 RIG NO. D-8 REPORT NO. DATE 11-12-65

MORNING

DAYLIGHT

EVENING

Driller				Total Men In Crew				Driller				Total Men In Crew			
FROM	TO	FORMATION	WT. BIT	R.P.M.	FROM	TO	FORMATION	WT. BIT	R.P.M.	FROM	TO	FORMATION	WT. BIT	R.P.M.	
15	15														
15	15														
15	15														

BIT NO.	SERIAL NO.	SIZE	TYPE	MAKE	MUD RECORD			MUD RECORD			MUD RECORD			
					NO. DC	SIZE	LENG.	NO. DC	SIZE	LENG.	NO. DC	SIZE	LENG.	
95016			nut											

TIME	Wt.	Vis.	MUD RECORD		MUD RECORD		MUD RECORD	
			NO. DC	SIZE	NO. DC	SIZE	NO. DC	SIZE

FROM	TO	TIME BREAKDOWN		TIME BREAKDOWN		TIME BREAKDOWN	

REMARKS - 11-10-65 11:10 AM to 11:11 AM. Drilled post hole + Drilled 15 1/2" hole. 11-11-65 10:45 AM to 11:12-65 5:45 AM. Drilled post hole + Drilled 15 1/2" hole. 11-12-65 11:12 AM to 11:15 AM. Drilled post hole + Drilled 15 1/2" hole. 11-12-65 11:15 AM to 11:18 AM. Drilled post hole + Drilled 15 1/2" hole. 11-12-65 11:18 AM to 11:21 AM. Drilled post hole + Drilled 15 1/2" hole. 11-12-65 11:21 AM to 11:24 AM. Drilled post hole + Drilled 15 1/2" hole. 11-12-65 11:24 AM to 11:27 AM. Drilled post hole + Drilled 15 1/2" hole. 11-12-65 11:27 AM to 11:30 AM. Drilled post hole + Drilled 15 1/2" hole. 11-12-65 11:30 AM to 11:33 AM. Drilled post hole + Drilled 15 1/2" hole. 11-12-65 11:33 AM to 11:36 AM. Drilled post hole + Drilled 15 1/2" hole. 11-12-65 11:36 AM to 11:39 AM. Drilled post hole + Drilled 15 1/2" hole. 11-12-65 11:39 AM to 11:42 AM. Drilled post hole + Drilled 15 1/2" hole. 11-12-65 11:42 AM to 11:45 AM. Drilled post hole + Drilled 15 1/2" hole. 11-12-65 11:45 AM to 11:48 AM. Drilled post hole + Drilled 15 1/2" hole. 11-12-65 11:48 AM to 11:51 AM. Drilled post hole + Drilled 15 1/2" hole. 11-12-65 11:51 AM to 11:54 AM. Drilled post hole + Drilled 15 1/2" hole. 11-12-65 11:54 AM to 11:57 AM. Drilled post hole + Drilled 15 1/2" hole. 11-12-65 11:57 AM to 12:00 AM. Drilled post hole + Drilled 15 1/2" hole.

SIGNED

Company Supervisor

*[Signature]*