

#67 30-039-07890
#420 30-039-24178907

DATA SHEET FOR DEEP GROUND BED CATHODIC PROTECTION WELLS
NORTHWESTERN NEW MEXICO
(Submit 3 copies to OCD Aztec Office)

Operator MERIDIAN OIL INC. Location: Unit NE Sec. 12 Twp 30 Rng 7

Name of Well/Wells or Pipeline Serviced SAN JUAN 30-6 UNIT #67. #420

cps 1940w

Elevation 6274' Completion Date 4/6/63 Total Depth 140' Land Type* N/A

Casing, Sizes, Types & Depths N/A

If Casing is cemented, show amounts & types used N/A

If Cement or Bentonite Plugs have been placed, show depths & amounts used
N/A

Depths & thickness of water zones with description of water when possible:
Fresh, Clear, Salty, Sulphur, Etc. N/A

Depths gas encountered: N/A

Type & amount of coke breeze used: 935 lbs.

Depths anodes placed: 105', 99', 93', 78', 45'

Depths vent pipes placed: N/A

Vent pipe perforations: N/A

Remarks: gb #1

Gb #1 & Gb #2 & Gb #3

If any of the above data is unavailable, please indicate so. Copies of all logs, including Drillers Log, Water Analyses & Well Bore Schematics should be submitted when available. Unplugged abandoned wells are to be included.

*Land Type may be shown: F-Federal; I-Indian; S-State; P-Fee.
If Federal or Indian, add Lease Number.

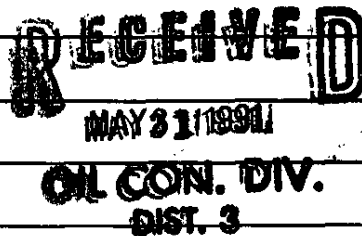

WELL CATHODIC
CATHODIC PROTECTION CONSTRUCTION REPORT
DAILY LOG

WELL NAME Hansen No 3 H DATE 4-6-60
LOG NO. 25 UNIT # 67
WORK ORDER NUMBER 189-40542-50-02
ANODE HOLE DEPTH 1640
TOTAL DRILLING DEPTH 6 Hrs
DRILLING TIME FOR ANODE HOLE DEPTH
TYPE AND SIZE BIT USED 6 1/4 Rock W.M. 2 1/2
NUMBER SACKS MUD USED 0
NUMBER SACKS LOSS CIRCULATION MAT'L USED 0
ANODE DEPTHS #1 105 , #2 90 , #3 93 , #4 78 5 45
TOTAL LBS. COKE USED 935 (11 Sacks)
ANODE OUTPUTS #1 2.6 VOLTS , #2 2.0 , #3 2.0 , #4 2.4 5.2
TOTAL CIRCUIT RESISTANCE: VOLTS 12.2 AMPERES 7.2 OHMS 1.7
NUMBER FEET SURFACE CABLE CONDUCTOR 380

DRILLING LOG (ATTACH HERETO).

FORMATION LOG (ATTACH HERETO).

REMARKS: Slide 2/3 73 R 600 South
Installed 20V 12A Rectifier
Good All Ser. No. 6246225
Assigned Tag # 1634

ALL CONSTRUCTION COMPLETED

Daniel
SIGNATURE

GROUND BED LAYOUT SKETCH

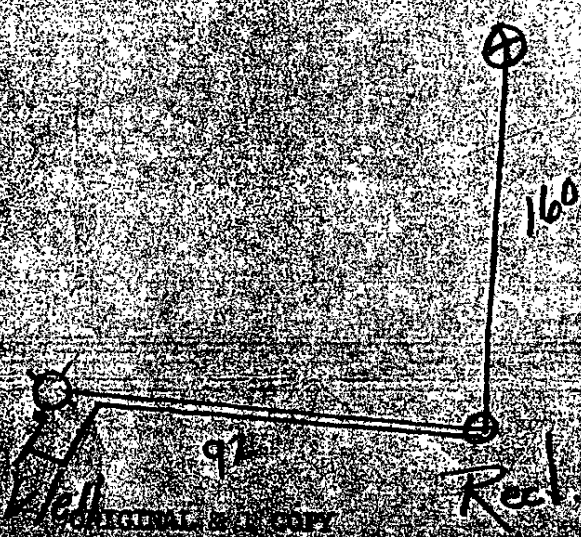

ORIGINAL & COPY
ALL REPORTS

