

Submit 3 Copies To Appropriate District Office  
District I  
1625 N. French Dr., Hobbs, NM 88240  
District II  
301 W. Grand Ave., Artesia, NM 88210  
District III  
1000 Rio Brazos Rd., Aztec, NM 87410  
District IV  
1220 S. St. Francis Dr., Santa Fe, NM 87505

State of New Mexico  
Energy, Minerals and Natural Resources

Form C-103  
March 4, 2004

OIL CONSERVATION DIVISION  
1220 South St. Francis Dr.  
Santa Fe, NM 87505

WELL API NO. 30-039-30223
5. Indicate Type of Lease STATE <input type="checkbox"/> FEE <input type="checkbox"/>
6. State Oil & Gas Lease No. Federal Lease# USA SF-079302-A
7. Lease Name or Unit Agreement Name Sanchez A
8. Well Number #2M
9. OGRID Number 14538
10. Pool name or Wildcat Blanco MV- 72319 / Basin DK - 71599

SUNDRY NOTICES AND REPORTS ON WELLS  
(DO NOT USE THIS FORM FOR PROPOSALS TO DRILL OR TO DEEPEN OR PLUG BACK TO A DIFFERENT RESERVOIR. USE "APPLICATION FOR PERMIT" (FORM C-101) FOR SUCH PROPOSALS.)

1. Type of Well:  
Oil Well ☐ Gas Well ☒ Other

2. Name of Operator  
**Burlington Resources Oil & Gas Company LP**

3. Address of Operator  
**P.O. Box 4289, Farmington, NM 87499-4289**

4. Well Location

Unit Letter N : 1235 feet from the South line and 1870 feet from the West line

Section 20 Township 26N Range 6W NMPM Rio Arriba County

11. Elevation (Show whether DR, RKB, RT, GR, etc.)  
6714'

12. Check Appropriate Box to Indicate Nature of Notice, Report or Other Data  
NOTICE OF INTENTION TO:

PERFORM REMEDIAL WORK ☐ PLUG AND ABANDON ☐

TEMPORARILY ABANDON ☐ CHANGE PLANS ☐

PULL OR ALTER CASING ☐ MULTIPLE COMPLETION ☐

OTHER: Commingled ☒

SUBSEQUENT REPORT OF:

REMEDIAL WORK ☐ ALTERING CASING ☐

COMMENCE DRILLING OPNS. ☐ PLUG AND ABANDONMENT ☐

CASING TEST AND CEMENT JOB ☐

OTHER: ☐

13. Describe proposed or completed operations. (Clearly state all pertinent details, and give pertinent dates, including estimated date of starting any proposed work). SEE RULE 1103. For Multiple Completions: Attach wellbore diagram of proposed completion or recompletion.

It is intended to drill and complete the subject well in the Blanco Mesaverde (Pool Code 72319) and the Basin Dakota (Pool Code 71599). The production will be commingled according to Oil Conservation Division Order Number 11363. Allocation and methodology will be provided after the well is completed. Commingling will not reduce the value of production. The Bureau of Land Management Office has been notified in writing of this application.

Interest is common, no notification is necessary.

RCVD APR 11 07  
OIL CONS. DIV.  
DIST. 3

0402577

I hereby certify that the information above is true and complete to the best of my knowledge and belief. I further certify that any pit or below-grade tank has been/will be constructed or closed according to NMOCD guidelines ☐, a general permit ☐ or an (attached) alternative OCD-approved plan ☐.

SIGNATURE Rhonda Rogers TITLE Regulatory Technician DATE 4-11-07

Type or print name Rhonda Rogers E-mail address: rogerrs@conocophillips.com Telephone No. 505-599-4018

(This space for State use)

APPROVED BY [Signature] TITLE DEPUTY OIL & GAS INSPECTOR, DIST. 3 DATE APR 11 2007  
Conditions of approval, if any:

10

DISTRICT I  
1225 N. French Dr., Hobbs, N.M. 88240

DISTRICT II  
611 South First, Artesia, N.M. 88203

DISTRICT III  
1000 E. Henson Rd., Aztec, N.M. 87410

DISTRICT IV  
2040 South Pacheco, Santa Fe, NM 87505

State of New Mexico  
Energy, Minerals & Natural Resources Department

OIL CONSERVATION DIVISION  
2040 South Pacheco  
Santa Fe, NM 87505

Form C-102  
Revised August 15, 2000

Submit to Appropriate District Office  
State Lease - 4 Copies  
Fee Lease - 3 Copies

2007 MAR -8 PM 3:03

RECEIVED

☐ AMENDED REPORT

WELL LOCATION AND ACREAGE DEDICATION PLAT

*API Number 30-039- <b>30223</b>	*Well Code 72319/71599	*Well Name MESA VERDE/DAKOTA
*Property Code 7496 <b>7476</b>	*Property Name SANCHEZ A	*Well Number 2M
*Well No. 14538	*Operator Name BURLINGTON RESOURCES O&G CO LP	*Wellbore 6714'

20 Surface Location

TL or lat. no.	Section	Township	Range	Lot No.	Feet from the	North/South line	Feet from the	East/West line	County
N	20	28N	9W		1255'	SOUTH	1870'	WEST	ROO ARIZONA

21 Bottom Hole Location if Different From Surface

TL or lat. no.	Section	Township	Range	Lot No.	Feet from the	North/South line	Feet from the	East/West line	County
N									
*Estimated Acres 310 Acres (MV/DK)			*Joint or hole		*Computation Code		*Order No.		

NO ALLOWABLE WILL BE ASSIGNED TO THIS COMPLETION UNTIL ALL INTERESTS HAVE BEEN CONSOLIDATED  
OR A NON-STANDARD UNIT HAS BEEN APPROVED BY THE DIVISION

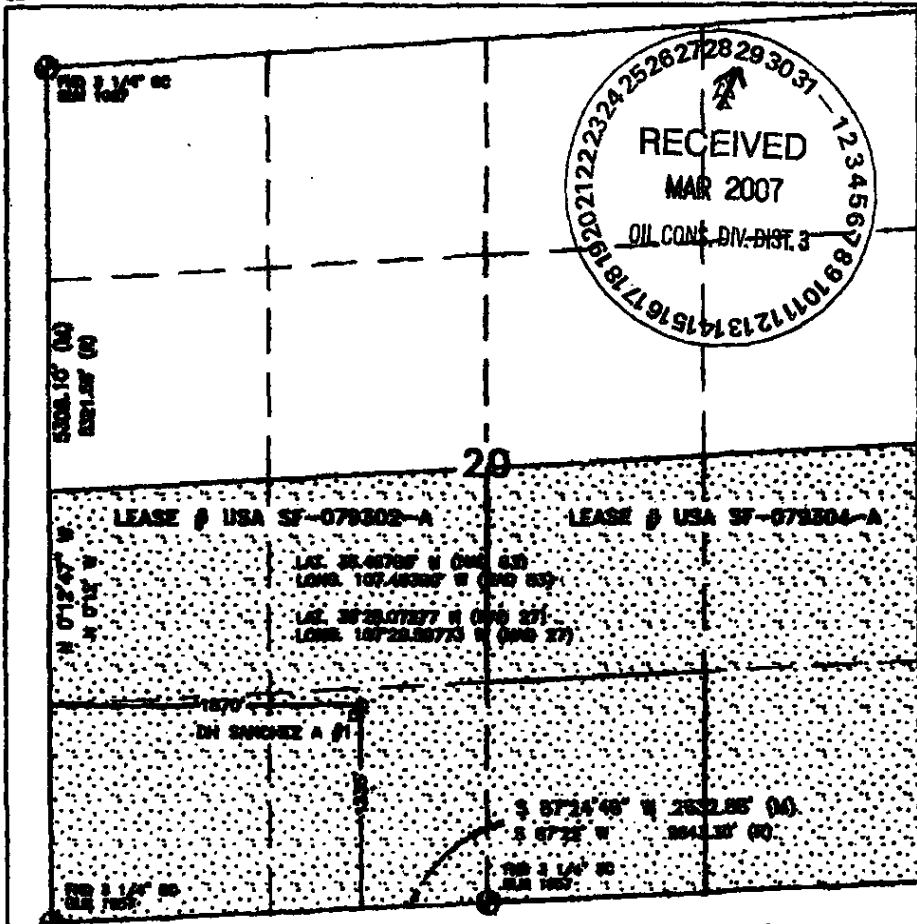

17 OPERATOR CERTIFICATION

I hereby certify that the information contained herein is true and complete to the best of my knowledge and belief.

*Kandis Roland*  
Signature

Kandis Roland

Regulatory Technician

February 15, 2007

18 SURVEYOR CERTIFICATION

I hereby certify that the well location shown on this plat was plotted from field notes of actual surveys made by me or under my supervision, and that the same are true and correct to the best of my belief.

SEPTEMBER 27, 2006

Date of Survey

Signature and Seal of Registered Surveyor

*David R. Russell*



DAVID RUSSELL

Certificate Number 10201