

30-039-07991

Form 9-331 C  
(May 1963)

ARMINGTON OFFICE COPY

SUBMIT IN TRIPLICATE\*  
(Other instructions on  
reverse side)approved.  
Budget Bureau No. 42-R1425.UNITED STATES  
DEPARTMENT OF THE INTERIOR  
GEOLOGICAL SURVEY

## APPLICATION FOR PERMIT TO DRILL, DEEPEN, OR PLUG BACK

## 1a. TYPE OF WORK

DRILL ☒DEEPEN ☐PLUG BACK ☐

## b. TYPE OF WELL

OIL  
WELL ☐GAS  
WELL ☒

OTHER

SINGLE  
ZONE ☐MULTIPLE  
ZONE ☐

## 2. NAME OF OPERATOR

Belco Petroleum Corporation

## 3. ADDRESS OF OPERATOR

630 Third Avenue New York, New York

## 4. LOCATION OF WELL (Report location clearly and in accordance with any State requirements.\*)

At surface

1040' FNL &amp; 1040' FWL Section 26, T32N, R5W

At proposed prod. zone

Same

## 14. DISTANCE IN MILES AND DIRECTION FROM NEAREST TOWN OR POST OFFICE\*

69 Miles to Blanco, New Mexico

## 15. DISTANCE FROM PROPOSED\*

LOCATION TO NEAREST  
PROPERTY OR LEASE LINE, FT.  
(Also to nearest drlg. line, if any)

Unknown

## 16. NO. OF ACRES IN LEASE

480

## 18. DISTANCE FROM PROPOSED LOCATION\*

TO NEAREST WELL, DRILLING, COMPLETED,  
OR APPLIED FOR, ON THIS LEASE, FT.

Unknown

## 19. PROPOSED DEPTH

8900'

17. NO. OF ACRES ASSIGNED  
TO THIS WELL

## 20. ROTARY OR CABLE TOOLS

Rotary

## 21. ELEVATIONS (Show whether DF, RT, GR, etc.)

7107' N.G.

## 22. APPROX. DATE WORK WILL START\*

May 15, 1965

## 23.

## PROPOSED CASING AND CEMENTING PROGRAM

SIZE OF HOLE	SIZE OF CASING	WEIGHT PER FOOT	SETTING DEPTH	QUANTITY OF CEMENT
15"	10-3/4"	32.75#	300'	200 sks or cement to surface
7-7/8"	4 1/2" or 5 1/2"	9.5# or 14.0#	8900'	600 sks or cement to top Mesaverde

Request permission to drill an 8900' Dakota Test. A 9" hole will be drilled to 1000' and ream to 15" to approximately 300'. 10-3/4" casing will be cemented to surface. A 7-7/8" hole will be drilled to total depth and 4 1/2" or 5 1/2" casing will be cemented through all pay zones. Safe equipment and operating procedures will be used.

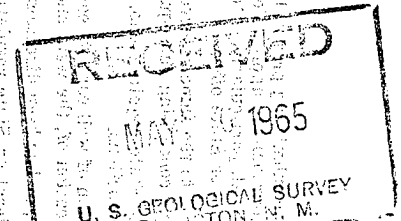
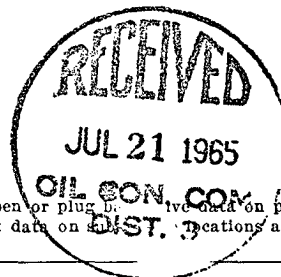

IN ABOVE SPACE DESCRIBE PROPOSED PROGRAM: If proposal is to deepen or plug back, give data on present productive zone and proposed new productive zone. If proposal is to drill or deepen directionally, give pertinent data on location and measured and true vertical depths. Give blowout preventer program, if any.

## 24.

SIGNED

*L. H. Wilkey*TITLE Drilling Superintendent

DATE

May 3, 1965

(This space for Federal or State office use)

PERMIT NO.

APPROVED

APPROVAL DATE

APPROVED BY

CONDITIONS OF APPROVAL, IF ANY

MAY 6 1965

TITLE

RICHARD B. KRAHL  
ACTING DISTRICT ENGINEER

\*See Instructions On Reverse Side

OPERATIONS BY:

☐ RECORD LESSEE☐ D. OF O. ON FILE☒ D. OF O. ATTACHED

BOND COVERAGE

☐ \$5,000 ATTACHED☐ \$5,000 ON FILE☒ LESSEE'S NATION-WIDE☐ OPERATOR'S NATION-WIDE

HALL C-104 for C-102 ad

NEW MEXICO OIL CONSERVATION COMMISSION  
WELL LOCATION AND ACREAGE DEDICATION PLAT

Form C-102  
Supersedes C-128  
Effective 1-1-65

All distances must be from the outer boundaries of the Section.

Operator <b>Belco Petroleum Corp.</b>			Lease <b>Carracas Mesa Unit</b>		Well No. <b>1</b>
Unit Letter	Section <b>26</b>	Township <b>32 N</b>	Range <b>5 W</b>	County <b>Rio Arriba</b>	
Actual Footage Location of Well: <b>1040</b> feet from the <b>North</b> line and <b>1040</b> feet from the <b>West</b> line					
Ground Level Elev: <b>7107</b>	Producing Formation <b>Dakota</b>		Pool <b>Basin Dakota</b>		Dedicated Acreage: <b>320</b> Acres

1. Outline the acreage dedicated to the subject well by colored pencil or hachure marks on the plat below.
2. If more than one lease is dedicated to the well, outline each and identify the ownership thereof (both as to working interest and royalty).
3. If more than one lease of different ownership is dedicated to the well, have the interests of all owners been consolidated by communitization, unitization, force-pooling, etc?

☒ Yes ☐ No

If answer is "yes," type of consolidation Federal Unit

If answer is "no," list the owners and tract descriptions which have actually been consolidated. (Use reverse side of this form if necessary.)

No allowable will be assigned to the well until all interests have been consolidated (by communitization, unitization, forced-pooling, or otherwise) or until a non-standard unit, eliminating such interests, has been approved by the Commission.

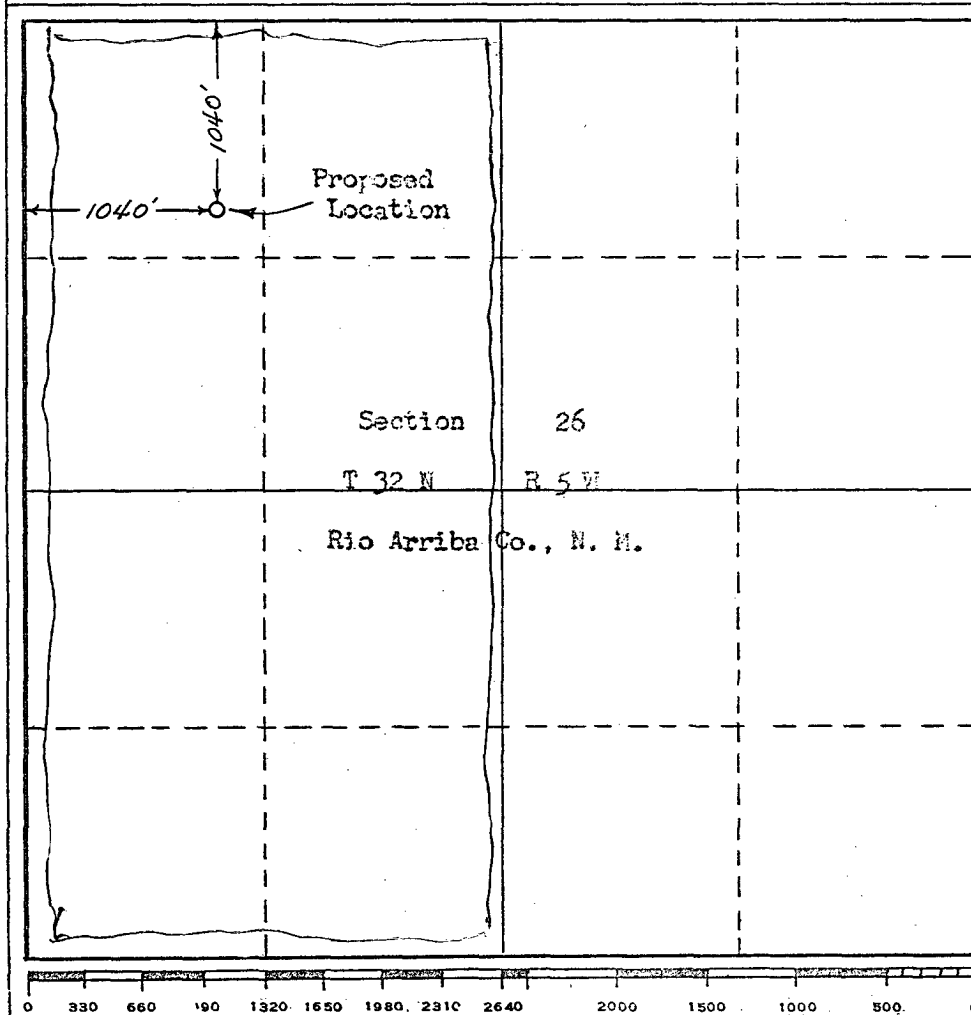

CERTIFICATION

I hereby certify that the information contained herein is true and complete to the best of my knowledge and belief.

Name S. J. Trekey  
Position Drilling Supt  
Company Belco Pet. Corp  
Date July 29-1965

I hereby certify that the well location shown on this plat was plotted from field notes of actual surveys made by me or under my supervision, and that the same is true and correct to the best of my knowledge and belief.

Date Surveyed  
April 20, 1965

Registered Professional Engineer  
and/or Land Surveyor

Frederick H. Reed  
Certificate No. N. M. # 3795