

(SUBMIT IN TRIPLICATE)

UNITED STATES
DEPARTMENT OF THE INTERIOR
GEOLOGICAL SURVEY

30-045-07489

Budget Bureau No. 42-R358.4.
Form Approved.Land Office Santa FeLease No. SF 047017-B & AUnit SW/4 NE/4 Sec. 13,
T-28N, R-11W, N.M.P.M.
San Juan County, New Mexico

SUNDRY NOTICES AND REPORTS ON WELLS

NOTICE OF INTENTION TO DRILL.....	<input checked="" type="checkbox"/>	SUBSEQUENT REPORT OF WATER SHUT-OFF.....	
NOTICE OF INTENTION TO CHANGE PLANS.....		SUBSEQUENT REPORT OF SHOOTING OR ACIDIZING.....	
NOTICE OF INTENTION TO TEST WATER SHUT-OFF.....		SUBSEQUENT REPORT OF ALTERING CASING.....	
NOTICE OF INTENTION TO RE-DRILL OR REPAIR WELL.....		SUBSEQUENT REPORT OF RE-DRILLING OR REPAIR.....	
NOTICE OF INTENTION TO SHOOT OR ACIDIZE.....		SUBSEQUENT REPORT OF ABANDONMENT.....	
NOTICE OF INTENTION TO PULL OR ALTER CASING.....		SUPPLEMENTARY WELL HISTORY.....	
NOTICE OF INTENTION TO ABANDON WELL.....			

(INDICATE ABOVE BY CHECK MARK NATURE OF REPORT, NOTICE, OR OTHER DATA)

September 21, 1962

Angel Peak
Well No. 21-B/ is located 1630 ft. from [N] line and 1850 ft. from [E] line of sec. 13
SW/4 NE/4 Sec. 13 28-N 11-W N.M.P.M.
(1/4 Sec. and Sec. No.) (Twp.) (Range) (Meridian)
Wildcat San Juan New Mexico
(Field) (County or Subdivision) (State or Territory)

The elevation of the derrick floor above sea level is 5815 ft. G.L.

DETAILS OF WORK

(State names of and expected depths to objective sands; show sizes, weights, and lengths of proposed casings; indicate mudding jobs, cementing points, and all other important proposed work)

1. The objective sand is the Entrada Formation anticipated at approx. 7500 ft.
2. Proposed casing program: 250' 10-3/4" OD 32.75#, H-40 cemented to surface.
7500' 4-1/2" OD 10.50#, J-55 cemented w/300 sacks.
3. Run 4-1/2" Stage Collar, set below Pictured Cliff formation, cement w/300 sacks.
4. Rotary tools will be employed from surface to T.D. Pipe will be set at approx. 7500'.
5. Estimated T.D. 7500'.
6. Well will be sand-fraced in an effort to stimulate production.
7. If the Entrada is productive, the well will be dually completed in both the Entrada and Dakota formation and 5-1/2" casing run.
8. If the Entrada is non-productive, the well will be plugged back and completed in the Dakota Formation, and 4-1/2" casing run.

(NOTE: This Intent supersedes Intent filed 9/14/62)

I understand that this plan of work must receive approval in writing by the Geological Survey before operations may be commenced.

Company SOUTHERN UNION PRODUCTION COMPANYAddress P. O. Box 808Farmington, New MexicoBy El M. M. M.

Title _____

NEW MEXICO OIL CONSERVATION COMMISSION

Well Location and Acreage Dedication Plat

Section A.

Date September 21, 1962

Operator SOUTHERN UNION PRODUCTION CO. Lease ANGEL PEAK
Well No. 21 B Unit Letter G Section 13 Township 28 N Range 11 W NMFM
Located 1630 Feet From north Line, 1850 Feet From east Line
County San Juan G. L. Elevation 5815 Dedicated Acreage North $\frac{1}{4}$ (320) Acres
Name of Producing Formation STRADA Pool East Dakota HYDROCARBON

1. Is the Operator the only owner* in the dedicated acreage outlined on the plat below?
Yes XX No .
2. If the answer to question one is "no," have the interests of all the owners been consolidated by communitization agreement or otherwise? Yes No . If answer is "yes," Type of Consolidation
3. If the answer to question two is "no," list all the owners and their respective interests below:

Owner

Land Description

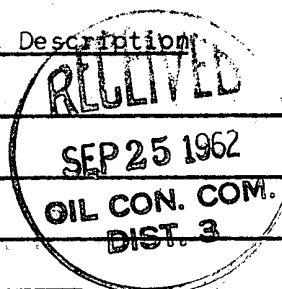

Section B

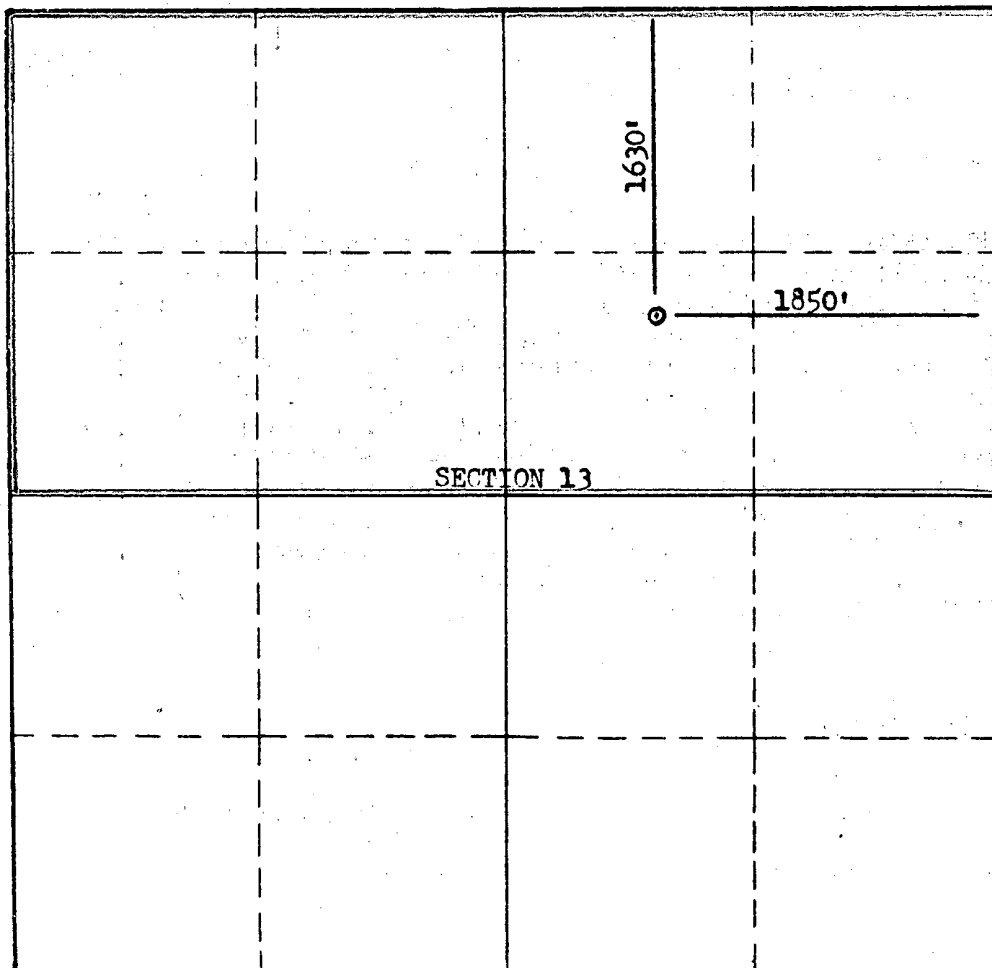

This is to certify that the information in Section A above is true and complete to the best of my knowledge and belief.

SOUTHERN UNION PRODUCTION CO.

(Operator)

L. S. Muennink

(Representative)

L. S. Muennink

P.O. Box 608, Farmington, U.H.

Address

This is to certify that the well location shown on the plat in Section B was plotted from field notes of actual surveys made by me or under my supervision and that the same is true and correct to the best of my knowledge and belief.

Date Surveyed Sept. 20, 1962

Stephen H. Kinney
STEPHEN H. KINNEY

Registered Professional
Engineer and/or Land Surveyor.

Certificate No. 1803

(See instructions for completing this form on the reverse side)