

NEW MEXICO OIL CONSERVATION COMMISSION  
Well Location and Acreage Dedication Plat

Section A.

Date September 21, 1962

Operator SOUTHERN UNION PRODUCTION CO. Lease ANGEL PEAK  
Well No. 21 B Unit Letter G Section 13 Township 28 N Range 11 W NMPM  
Located 1630 Feet From north Line, 1850 Feet From east Line  
County San Juan G. L. Elevation 5815 Dedicated Acreage North 1/4 (320) Acres  
Name of Producing Formation WATKINS Pool BASIN AND RANGE WATKINS

1. Is the Operator the only owner\* in the dedicated acreage outlined on the plat below?  
Yes XX No     .
2. If the answer to question one is "no," have the interests of all the owners been consolidated by communitization agreement or otherwise? Yes      No     . If answer is "yes," Type of Consolidation
3. If the answer to question two is "no," list all the owners and their respective interests below:

Owner

Land Description

Section B

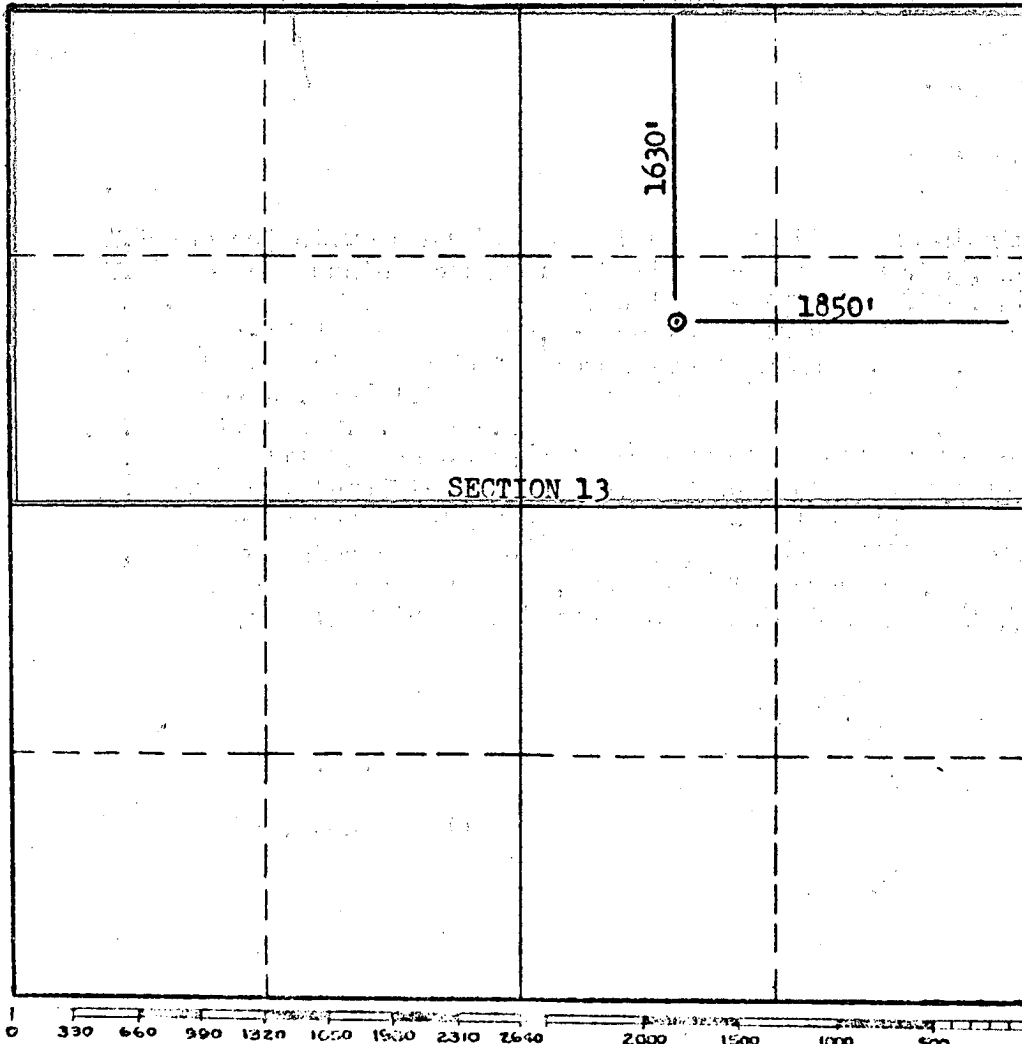

This is to certify that the information in Section A above is true and complete to the best of my knowledge and belief.

SOUTHERN UNION PRODUCTION CO.

(Operator)

L. S. McNeill

(Representative)

L. S. McNeill

P.O. Box 603, Farmington, N.M.

Address

This is to certify that the well location shown on the plat in Section B was plotted from field notes of actual surveys made by me or under my supervision and that the same is true and correct to the best of my knowledge and belief.

Date Surveyed Sept. 20, 1962

Stephen H. Kinney

Registered Professional Engineer and/or Land Surveyor.

Certificate No. 1803

(See instructions for completing this form on the reverse side)