

District I  
1625 N. French Dr., Hobbs, NM 88240  
District II  
1301 W. Grand Avenue, Artesia, NM 88210  
District III  
1000 Rio Brazos Road, Aztec, NM 87410  
District IV  
1220 S St Francis Dr., Santa Fe, NM 87505

State of New Mexico  
Energy Minerals and Natural Resources

Form C-144  
June 1, 2004

Oil Conservation Division

1220 South St. Francis Dr.  
Santa Fe, NM 87505

For drilling and production facilities, submit to  
appropriate NMOCD District Office.

For downstream facilities, submit to Santa Fe  
office

Pit or Below-Grade Tank Registration or Closure

Is pit or below-grade tank covered by a "general plan"? Yes ☒ No ☐

Type of action: Registration of a pit or below-grade tank ☐ Closure of a pit or below-grade tank ☒

Operator: BURLINGTON RESOURCES OIL & GAS COMPANY LP Telephone 505-326-9530 e-mail address thomppp@conocophillips.com  
Address 3401 E 30TH STREET, FARMINGTON, NM 87402 Formation: MV  
Facility or well name: San Juan 28-4 Unit 28A API #: 30-039-27626 U/L or Qtr/Qtr D Sec 19 T 28N R 4W  
County Rio Arriba Latitude 36°39'2 Longitude 107°17'9 NAD: 1927 ☒ 1983 ☐ Surface Owner Federal ☒ State ☐ Private ☐ Indian ☐

Pit  
Type: Drilling ☒ Production ☐ Disposal ☐  
Workover ☐ Emergency ☐  
Lined ☒ Unlined ☐  
Liner type: Synthetic ☐ Thickness 12 mil Clay ☐  
Pit Volume bbl

Below-grade tank  
Volume: bbl Type of fluid: RCVD MAY4'07  
Construction material: OIL CONS. DIV.  
Double-walled, with leak detection? Yes ☐ If not, explain why not DIST. 3

Depth to ground water (vertical distance from bottom of pit to seasonal high water elevation of ground water.)	Less than 50 feet 50 feet or more, but less than 100 feet 100 feet or more	(20 points) (10 points) ( 0 points)	0
Wellhead protection area: (Less than 200 feet from a private domestic water source, or less than 1000 feet from all other water sources.)	Yes No	(20 points) ( 0 points)	0
Distance to surface water: (horizontal distance to all wetlands, playas, irrigation canals, ditches, and perennial and ephemeral watercourses.)	Less than 200 feet 200 feet or more, but less than 1000 feet 1000 feet or more	(20 points) (10 points) ( 0 points)	0
Ranking Score (Total Points)		0	

If this is a pit closure: (1) attach a diagram of the facility showing the pit's relationship to other equipment and tanks. (2) Indicate disposal location: (check the onsite box if you are burying in place) onsite ☒ offsite ☐ If offsite, name of facility (3) Attach a general description of remedial action taken including remediation start date and end date. (4) Groundwater encountered: No ☐ Yes ☐ If yes, show depth below ground surface ft. and attach sample results. (5) Attach soil sample results and a diagram of sample locations and excavations. 6) Pit Closed 10/30/06

Additional Comments:  
See attached well pad diagram for direction and distance of pit from well head  
Original C103 Pit permitted under 30-039-07388

I hereby certify that the information above is true and complete to the best of my knowledge and belief. I further certify that the above-described pit or below-grade tank has been/will be constructed or closed according to NMOCD guidelines ☐, a general permit ☒, or an (attached) alternative OCD-approved plan ☐.

Date: 5/2/07

Printed Name/Title: Patsy Clugston / Regulatory Spec Signature Patsy Clugston

Your certification and NMOCD approval of this application/closure does not relieve the operator of liability should the contents of the pit or tank contaminate ground water or otherwise endanger public health or the environment. Nor does it relieve the operator of its responsibility for compliance with any other federal, state, or local laws and/or regulations.

Approval: Deputy Oil & Gas Inspector,  
District #3

Printed Name/Title Signature Date: JUL 25 2007

# MESAVERDE/DAKOTA LAYOUT

50'  
CONSTRUCTION ZONE

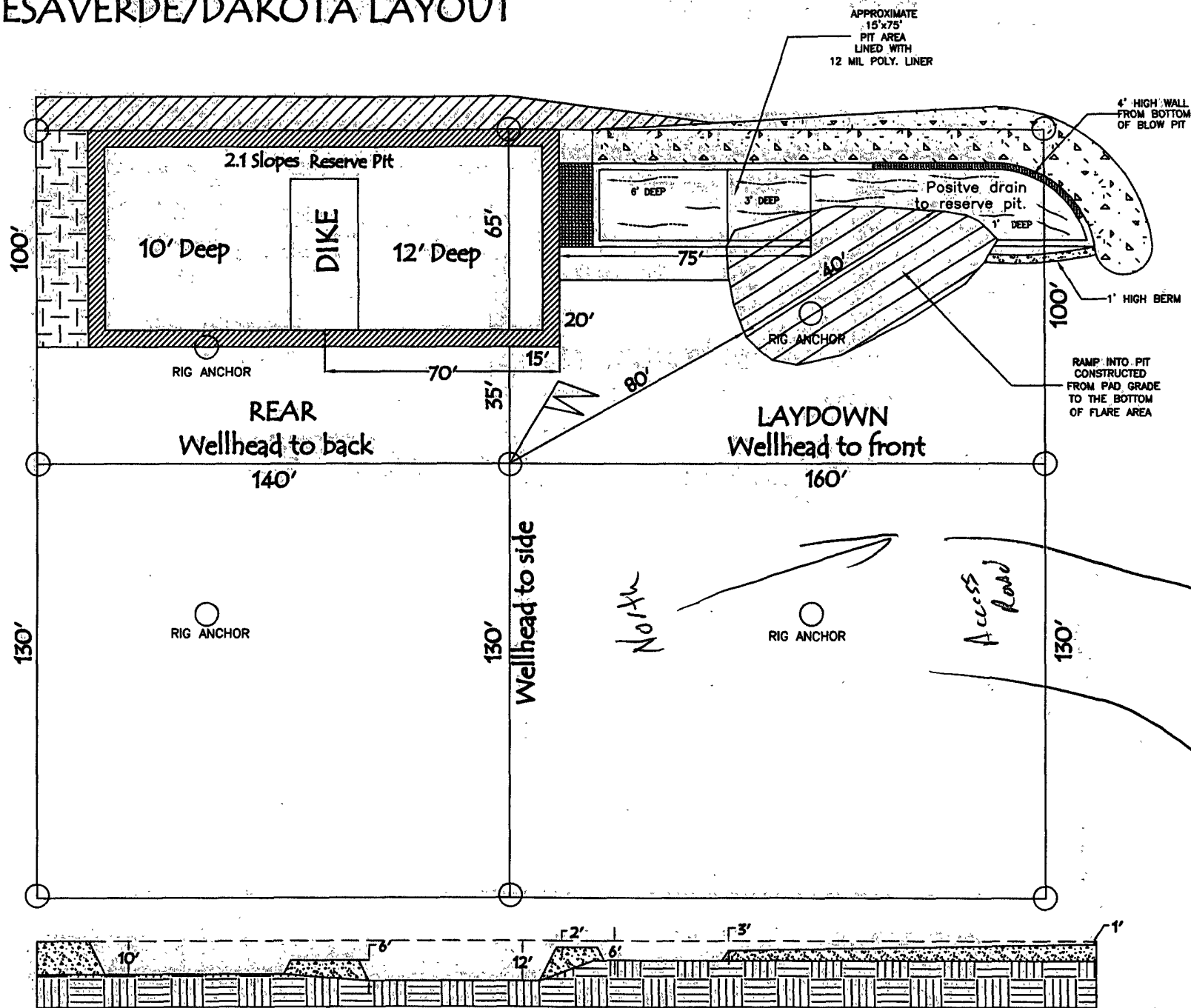

PIT CROSS SECTION