

4604
DAY #1 → 30-045-08245
DAY #7 → 30-045-20908
DAY #201 → 30-045-26986

DATA SHEET FOR DEEP GROUND BED CATHODIC PROTECTION WELLS
NORTHWESTERN NEW MEXICO
(Submit 3 copies to OCD Aztec Office)

Operator MERIDIAN OIL Location: Unit SW Sec. 17 Twp 29 Rng 8

Name of Well/Wells or Pipeline Serviced DAY #1, DAY #7, DAY #201

cps 80w

Elevation 6400' Completion Date 11/27/62 Total Depth 185' Land Type* N/A

Casing, Sizes, Types & Depths N/A

If Casing is cemented, show amounts & types used N/A

If Cement or Bentonite Plugs have been placed, show depths & amounts used

N/A

Depths & thickness of water zones with description of water when possible:

Fresh, Clear, Salty, Sulphur, Etc. N/A

Depths gas encountered: N/A

Type & amount of coke breeze used: 1105 lbs.

Depths anodes placed: 163', 157', 142', 93', 45', 37'

Depths vent pipes placed: N/A

Vent pipe perforations: N/A

Remarks: gb #1, #2, #3, #4

RECEIVED
MAY 31 1991
OIL CON. D
DIST. 3

If any of the above data is unavailable, please indicate so. Copies of all logs, including Drillers Log, Water Analyses & Well Bore Schematics should be submitted when available. Unplugged abandoned wells are to be included.

*Land Type may be shown: F-Federal; I-Indian; S-State; P-Fee.
If Federal or Indian, add Lease Number.

WELL CASING
CATHODIC PROTECTION CONSTRUCTION REPORT
DAILY LOG

DATE 11-27-62

WELL NAME Billie Day #1 CPS NO. 806

LOCATION 17-29N-8W

WORK ORDER NUMBER 184-40542-50-02

ANODE HOLE DEPTH 185'

TOTAL 1060 5423
TOTAL DRILLING RIG TIME 8 1/2

DRILLING TIME FOR RECTIFIER POLE HOLE 0

TYPE AND SIZE BIT USED _____

NUMBER SACKS MUD USED 0

NUMBER SACKS LOST CIRCULATION MAT'L USED 0

ANODE DEPTHS #1 163', #2 157', #3 142', #4 93' 5' 45' 6' 37'

TOTAL LBS. COKE USED 1105 165 13 SACKS

ANODE OUTPUTS 12.4 VOLTS, #1 1.1, #2 2.5, #3 2.0A, #4 1.5A 5.2.6 6.1.2

TOTAL CIRCUIT RESISTANCE: VOLTS 12 AMPERES 6.5 OHMS 1.85

NUMBER FEET SURFACE CABLE CONDUIT 420' 1087'

DRILLING LOG (ATTACH HERETO).

FORMATION LOG (ATTACH HERETO).

REMARKS: Static 9/5 79 600' NW

4 Anodes = 2.7 Ω

5 Anodes = 2.2 Ω

ALL CONSTRUCTION COMPLETED

B. Paulik
SIGNATURE

GROUND BED LAYOUT SKETCH

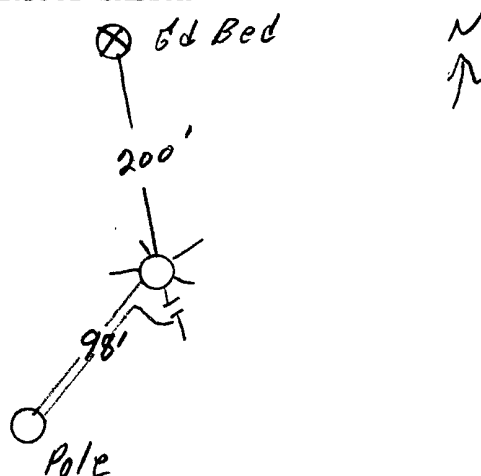

ORIGINAL & 1 COPY
ALL REPORTS

EL PASO NATURAL GAS COMPANY
DRILLING DEPARTMENT

DAILY DRILLING REPORT

Billy Day #1

LEASE

WELL NO.

CONTRACTOR

RIG NO. A-4

REPORT NO.

DATE NOV. 27 1962

MORNING						DAYLIGHT						EVENING					
Driller		Total Men In Crew				Driller		Total Men In Crew				Driller		Total Men In Crew			
FROM	TO	FORMATION	WT-BIT	R.P.M.	FROM	TO	FORMATION	WT-BIT	R.P.M.	FROM	TO	FORMATION	WT-BIT	R.P.M.			
0	40	30 shale	7072														
40	50	100 sand & shale	X														
50	100	110 sand & shale	X														
100	110	125 sand	X														
110	125	140 shale	X														
125	140	155 sand															
140	155	185 shale															
BIT NO.	NO. DC	SIZE	LENG.	BIT NO.	NO. DC	SIZE	LENG.	BIT NO.	NO. DC	SIZE	LENG.						
SERIAL NO.	SERIAL NO.	STANDS	SERIAL NO.	SERIAL NO.	SERIAL NO.	STANDS	SERIAL NO.	SERIAL NO.	SERIAL NO.	STANDS	SERIAL NO.						
SIZE	SIZE	SINGLES	SIZE	SIZE	SIZE	SINGLES	SIZE	SIZE	SIZE	SINGLES	SIZE						
TYPE	TYPE	DOWN ON KELLY	TYPE	TYPE	TYPE	DOWN ON KELLY	TYPE	TYPE	TYPE	DOWN ON KELLY	TYPE						
MAKE	MAKE	TOTAL DEPTH	MAKE	MAKE	MAKE	TOTAL DEPTH	MAKE	MAKE	MAKE	TOTAL DEPTH	MAKE						
MUD RECORD		MUD, ADDITIVES USED AND RECEIVED				MUD RECORD		MUD, ADDITIVES USED AND RECEIVED				MUD RECORD		MUD, ADDITIVES USED AND RECEIVED			
Time	Wt.	Vis.	Time	Wt.	Vis.	Time	Wt.	Vis.	Time	Wt.	Vis.						
FROM	TO	TIME BREAKDOWN				FROM	TO	TIME BREAKDOWN				FROM	TO	TIME BREAKDOWN			
REMARKS -					REMARKS - 7 HRS					REMARKS - 3 loads watch 1 hr carry over NOV. 26 THIS NOV. 27 7 HRS moved to new location							

SIGNED: Toolpusher

____ Company Supervisor

400