

4287

30-045-11825

DATA SHEET FOR DEEP GROUND BED CATHODIC PROTECTION WELLS  
NORTHWESTERN NEW MEXICO  
(Submit 3 copies to OCD Aztec Office)

Operator TENNECO Location: Unit SW Sec. 27 Twp 31 Rng 9

Name of Well/Wells or Pipeline Serviced SCHWERDTFEGER #1R

cps 397w

Elevation 6070' Completion Date 6/12/63 Total Depth 160' Land Type\* N/A

Casing, Sizes, Types & Depths N/A

If Casing is cemented, show amounts & types used N/A

If Cement or Bentonite Plugs have been placed, show depths & amounts used  
N/A

Depths & thickness of water zones with description of water when possible:  
Fresh, Clear, Salty, Sulphur, Etc. N/A

Depths gas encountered: N/A

Type & amount of coke breeze used: 1600 lbs.

Depths anodes placed: 105', 95', 88', 82', 76'

Depths vent pipes placed: N/A

Vent pipe perforations: N/A

Remarks: gb #1 not a MERIDIAN well.

**RECEIVED**

MAY 31 1991

**OIL CON. DIV**  
DIST

If any of the above data is unavailable, please indicate so. Copies of all logs, including Drillers Log, Water Analyses & Well Bore Schematics should be submitted when available. Unplugged abandoned wells are to be included.

\*Land Type may be shown: F-Federal; I-Indian; S-State; P-Fee.  
If Federal or Indian, add Lease Number.

WELL CASING  
CATHODIC PROTECTION CONSTRUCTION REPORT  
DAILY LOG

DATE 6-12-63

WELL NAME SCHWEDT Feger #1

CPS NO. 397-W

LOCATION 29-31N-9W

WORK ORDER NUMBER 184-40542-50-02

ANODE HOLE DEPTH 160'

TOTAL DRILLING RIG TIME 4 1/2 hrs

DRILLING TIME FOR RECTIFIER POLE HOLE 0

TYPE AND SIZE BIT USED \_\_\_\_\_

NUMBER SACKS MUD USED 0

NUMBER SACKS LOST CIRCULATION MAT'L USED 0

ANODE DEPTHS #1 105', #2 95', #3 88', #4 82 5 76'

TOTAL LBS. COKE USED 1600 lbs 16 SACKS

ANODE OUTPUTS 12 VOLTS, #1 3.0, #2 4.1, #3 4.3, #4 4.6 5 3.5

TOTAL CIRCUIT RESISTANCE: VOLTS 10.6 AMPERES 8.5 OHMS 1.25

NUMBER FEET SURFACE CABLE ~~CORRECT~~ 307'

DRILLING LOG (ATTACH HERETO).

FORMATION LOG (ATTACH HERETO).

REMARKS: Static G/S = .70 R 600' NW

Installed Good-All Rect 28V-12A ser# 6206127  
total wire plowed to #1X = 1720 ft. #8.

ALL CONSTRUCTION COMPLETED

E. Paulik

SIGNATURE

GROUND BED LAYOUT SKETCH

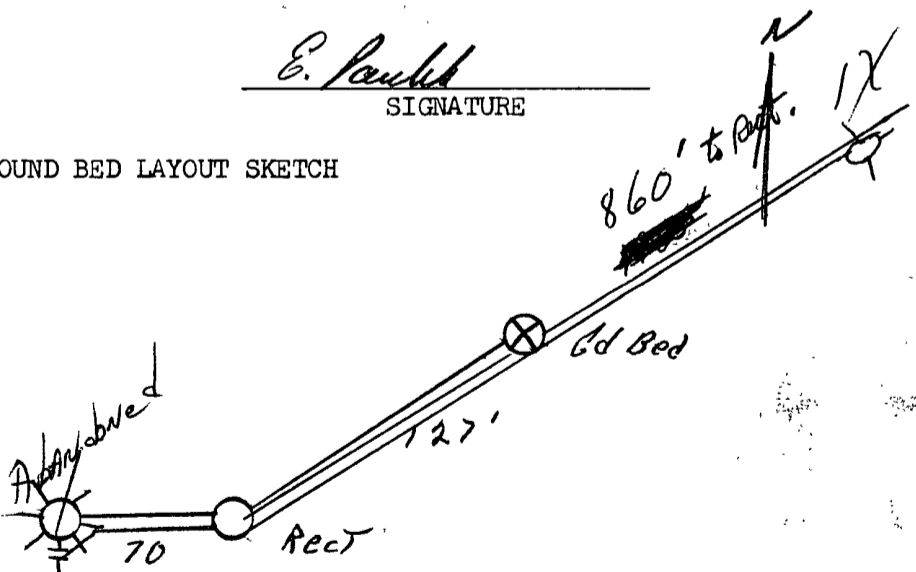

ORIGINAL & 1 COPY  
REPORTS

635

LEASED **Ward** WELL NO. **1** CONTINATOR **LE. WILSON** RIG NO. **D-2** REPORT NO. **2912** DATE **6-10-63**

MORNING

DAYEIGHT

EVENING

Driller				Total Man In Crew				Driller				Total Man In Crew			
FROM	TO	FORMATION	WT. BIT	R.P.M.	FROM	TO	FORMATION	WT. BIT	R.P.M.	FROM	TO	FORMATION	WT. BIT	R.P.M.	
0	78	S.	1759												
78	105	S.S.H.	"												
105	140	S.S.H.	"												
130	160	S.S.H.	"												
BIT NO. <b>6759X</b> SERIAL NO.				NO. DC. SIZE LENG. NO. DC. SIZE LENG.				NO. DC. SIZE LENG. NO. DC. SIZE LENG.				NO. DC. SIZE LENG. NO. DC. SIZE LENG.			
SIZE <b>6 1/4</b> TYPE <b>Rock</b> MAKE <b>W.M.</b>				SINGLES DOWN ON KELLY TOTAL DEPTH <b>160'</b>				SINGLES DOWN ON KELLY TOTAL DEPTH				SINGLES DOWN ON KELLY TOTAL DEPTH			
MUD RECORD TIME: WI. VIS.				MUD ADDITIVES USED AND RECEIVED				MUD RECORD TIME: WI. VIS.				MUD ADDITIVES USED AND RECEIVED			
FROM TO TIME BREAKDOWN				FROM TO TIME BREAKDOWN				FROM TO TIME BREAKDOWN				FROM TO TIME BREAKDOWN			
REMARKS - <b>2 Loads water!</b>				REMARKS -				REMARKS -				REMARKS -			
<b>Five set up TIME 9:00 AM</b> <b>Finished mix at 9:00 PM</b>				<b>Rig Time 4 1/2 hrs.</b>											

SIGNED: *[Signature]*

Company Supervisor: *[Signature]*