

District I  
1625 N French Dr., Hobbs, NM 88240  
District II  
1301 W Grand Avenue, Artesia, NM 88210  
District III  
1000 Rio Brazos Road, Aztec, NM 87410  
District IV  
1220 S St Francis Dr., Santa Fe, NM 87505

State of New Mexico  
Energy Minerals and Natural Resources

Form C-144  
June 1, 2004

Oil Conservation Division  
1220 South St. Francis Dr.  
Santa Fe, NM 87505

For drilling and production facilities, submit to appropriate NMOCD District Office.  
For downstream facilities, submit to Santa Fe office

**Pit or Below-Grade Tank Registration or Closure**

Is pit or below-grade tank covered by a "general plan"? Yes ☒ No ☐

Type of action Registration of a pit or below-grade tank ☐ Closure of a pit or below-grade tank ☒

Operator Koch Exploration Company, LLC Telephone (505) 334-9111 e-mail address clark23j@kochind.com  
Address PO Box 489 Aztec, NM 87410  
Facility or well name Seymour 722 API # 30-045-28093 U/L or Qtr/Qtr L Sec 24 T 31N R 9W  
County San Juan Latitude 36 52.806 Longitude 107.44.31 NAD 1927 ☐ 1983 ☐  
Surface Owner Federal ☒ State ☐ Private ☐ Indian ☐

<b>Pit</b> Type: Drilling <input type="checkbox"/> Production <input type="checkbox"/> Disposal <input type="checkbox"/> Workover <input checked="" type="checkbox"/> Emergency <input type="checkbox"/> Lined <input checked="" type="checkbox"/> Unlined <input type="checkbox"/> Liner type Synthetic <input checked="" type="checkbox"/> Thickness <u>12</u> mil Clay <input type="checkbox"/> Pit Volume _____ bbl	<b>Below-grade tank</b> Volume _____ bbl Type of fluid _____ Construction material _____ Double-walled, with leak detection? Yes <input type="checkbox"/> If not, explain why not _____
Depth to ground water (vertical distance from bottom of pit to seasonal high water elevation of ground water)	Less than 50 feet (20 points) 50 feet or more, but less than 100 feet (10 points) X 100 feet or more (0 points) 0 points
Wellhead protection area: (Less than 200 feet from a private domestic water source, or less than 1000 feet from all other water sources)	Yes (20 points) X No (0 points) 0 points
Distance to surface water: (horizontal distance to all wetlands, playas, irrigation canals, ditches, and perennial and ephemeral watercourses.)	Less than 200 feet (20 points) X 200 feet or more, but less than 1000 feet (10 points) 10 points 1000 feet or more (0 points)
	<b>Ranking Score (Total Points)</b> 10 points

**If this is a pit closure:** (1) Attach a diagram of the facility showing the pit's relationship to other equipment and tanks. (2) Indicate disposal location. (check the onsite box if you are burying in place) onsite ☒ offsite ☐ If offsite, name of facility \_\_\_\_\_ (3) Attach a general description of remedial action taken including remediation start date and end date (4) Groundwater encountered No ☒ Yes ☐ If yes, show depth below ground surface \_\_\_\_\_ ft. and attach sample results. (5) Attach soil sample results and a diagram of sample locations and excavations.

Additional Comments	<b>CLOSURE</b>	<b>RCVD JUL 25 '07</b>
		<b>OIL CONS. DIV.</b>
		<b>DIST. 3</b>

I hereby certify that the information above is true and complete to the best of my knowledge and belief. I further certify that the above-described pit or below-grade tank has been/will be constructed or closed according to NMOCD guidelines ☐, a general permit ☒, or an (attached) alternative OCD-approved plan ☐.

Date 07/24/07

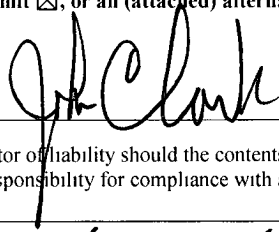
Printed Name/Title John Clark, District Superintendent Signature 

Your certification and NMOCD approval of this application/closure does not relieve the operator of liability should the contents of the pit or tank contaminate ground water or otherwise endanger public health or the environment. Nor does it relieve the operator of its responsibility for compliance with any other federal, state, or local laws and/or regulations

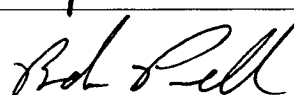
Approval: **Deputy Oil & Gas Inspector, District #3**  
Printed Name/Title \_\_\_\_\_ Signature  Date AUG 30 2007

**KOCH EXPLORATION COMPANY LLC**  
**Seymour 722**  
**S24, T31N, R9W**  
**1415' FSL & 915' FWL - ELEVATION 6151'**

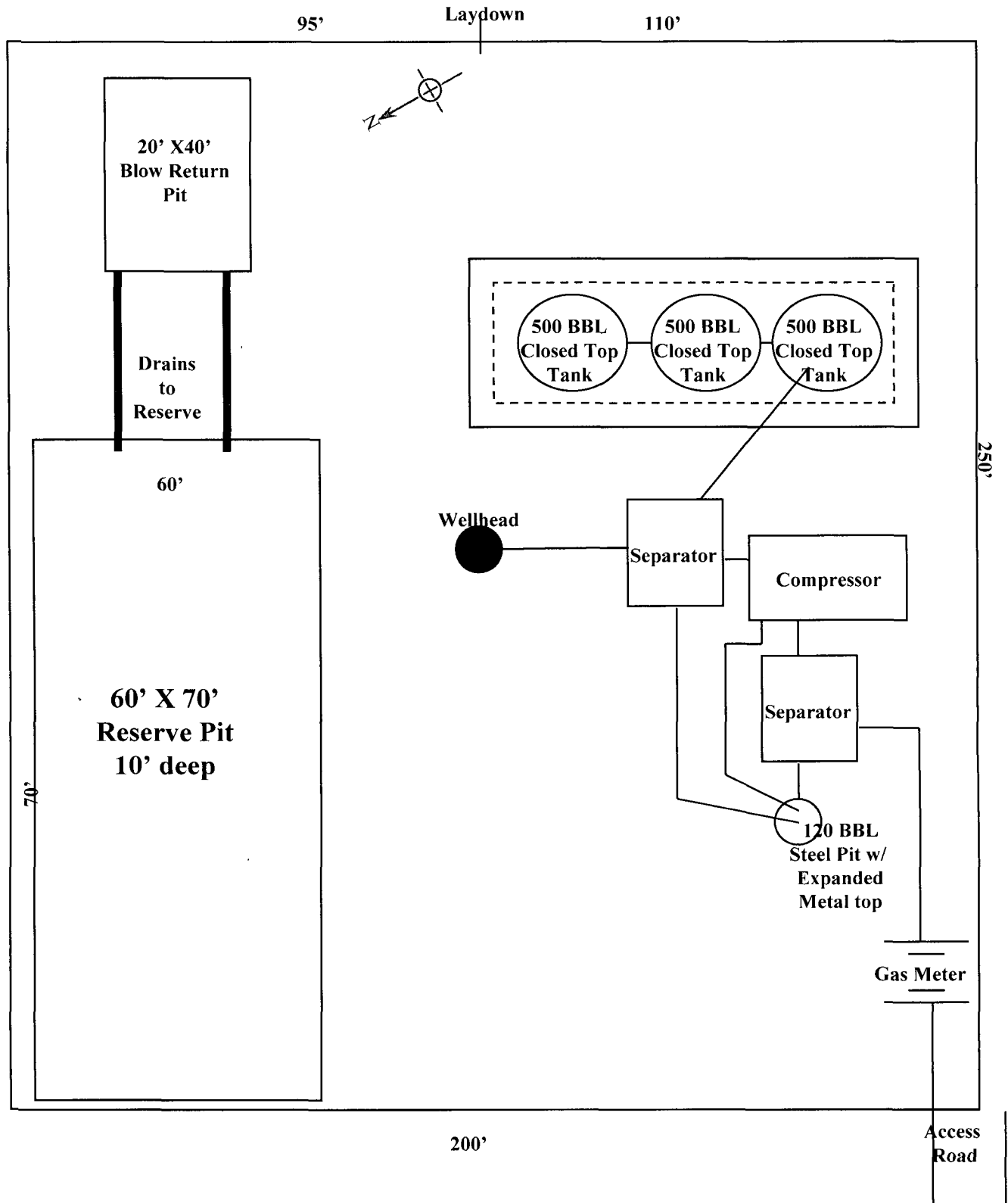

**SEYMOUR 722**

S24 T31N R9W, 1415' FSL & 915' FWL

San Juan Co., New Mexico

API No. 30-045-28093 Lease SF 078505

Upon completion of deepening well bore remaining liquids were removed from pit by truck to an approved disposal facility.

Prior to closing the pit, liner was cut off at mud level. The excess liner was hauled to a licensed disposal.

July 4, 2007 the remaining waste in pit was encapsulated. This was accomplished by covering the remaining waste and liner with earthen materials. Surface area where pit was located was contoured according to BLM requirements, and will be seeded with recommended BLM seed mixture.