

UNITED STATES
DEPARTMENT OF THE INTERIOR
BUREAU OF LAND MANAGEMENT

FORM APPROVED
OMB No. 1004-0137
Expires March 31, 2007

SUNDRY NOTICES AND REPORTS ON WELLS

Do not use this form for proposals to drill or to re-enter an abandoned well. Use Form 3160-3 (APD) for such proposals.

SUBMIT IN TRIPLICATE- Other instructions on reverse side.

1. Type of Well
☐ Oil Well ☒ Gas Well ☐ Other

2. Name of Operator **Devon Energy Production Company, L.P.**

3a. Address
20 N. Broadway, Oklahoma City, OK 73102

3b. Phone No. (include area code)
405-552-7917

4. Location of Well (Footage, Sec., T., R., M., or Survey Description)

**SL: 1,575' FNL & 1,105' FEL, SE NE, Unit H, Sec. 29, T30N, R7W
BHL: 900' FNL & 900' FEL, NE NE, Unit A, Sec. 29, T30N, R7W**

5. Lease Serial No
SF 079060

6. If Indian, Allottee or Tribe Name

7. If Unit or CA/Agreement, Name and/or No
Northeast Blanco Unit

8. Well Name and No.
NEBU 345

9. API Well No.

30-039-30315

10. Field and Pool, or Exploratory Area
Basin Dakota/La Jara Pictured Cliffs

11. County or Parish, State

Rio Arriba, NM

12. CHECK APPROPRIATE BOX(ES) TO INDICATE NATURE OF NOTICE, REPORT, OR OTHER DATA

TYPE OF SUBMISSION	TYPE OF ACTION			
<input checked="" type="checkbox"/> Notice of Intent	<input type="checkbox"/> Acidize	<input type="checkbox"/> Deepen	<input type="checkbox"/> Production (Start/Resume)	<input type="checkbox"/> Water Shut-Off
<input checked="" type="checkbox"/> Subsequent Report	<input type="checkbox"/> Alter Casing	<input type="checkbox"/> Fracture Treat	<input type="checkbox"/> Reclamation	<input type="checkbox"/> Well Integrity
<input type="checkbox"/> Final Abandonment Notice	<input type="checkbox"/> Casing Repair	<input type="checkbox"/> New Construction	<input type="checkbox"/> Recomplete	<input checked="" type="checkbox"/> Other Pool Change
	<input type="checkbox"/> Change Plans	<input type="checkbox"/> Plug and Abandon	<input type="checkbox"/> Temporarily Abandon	
	<input type="checkbox"/> Convert to Injection	<input type="checkbox"/> Plug Back	<input type="checkbox"/> Water Disposal	

13. Describe Proposed or Completed Operation (clearly state all pertinent details, including estimated starting date of any proposed work and approximate duration thereof. If the proposal is to deepen directionally or recomplete horizontally, give subsurface locations and measured and true vertical depths of all pertinent markers and zones. Attach the Bond under which the work will be performed or provide the Bond No. on file with BLM/BIA. Required subsequent reports shall be filed within 30 days following completion of the involved operations. If the operation results in a multiple completion or recompletion in a new interval, a Form 3160-4 shall be filed once testing has been completed. Final Abandonment Notices shall be filed only after all requirements, including reclamation, have been completed, and the operator has determined that the site is ready for final inspection.)

Devon Energy Production Company, L.P. gives notification of pool code correction. Attached is a copy of the corrected Well Location and Acreage Dedication Plat, C-102.

RCVD SEP 25 '07

OIL CONS. DIV.

DIST. 3

RECEIVED

SEP 17 2007

Bureau of Land Management
Farmington Field Office

ACCEPTED FOR RECORD

SEP 24 2007

FARMINGTON FIELD OFFICE
BY **T. Salinas**

14. I hereby certify that the foregoing is true and correct
Name (Printed/Typed)

Melisa Castro

Title **Senior Staff Operations Technician**

Signature

[Signature]

Date

September 10, 2007

THIS SPACE FOR FEDERAL OR STATE OFFICE USE

Approved by

Conditions of approval, if any, are attached. Approval of this notice does not warrant or certify that the applicant holds legal or equitable title to those rights in the subject lease which would entitle the applicant to conduct operations thereon.

Title

Date

Office

Title 18 U.S.C. Section 1001 and Title 43 U.S.C. Section 1212, make it a crime for any person knowingly and willfully to make to any department or agency of the United States any false, fictitious or fraudulent statements or representations as to any matter within its jurisdiction.

(Instructions on page 2)

NMOCD

District I
PO Box 1980, Hobbs NM 88241-1980
District II
PO Drawer KK, Artesia, NM 87211-0719
District III
1000 Rio Brazos Rd., Aztec, NM 87410
District IV
PO Box 2088, Santa Fe, NM 87504-2088

State of New Mexico
Energy, Minerals & Natural Resources Department

OIL CONSERVATION DIVISION
PO Box 2088
Santa Fe, NM 87504-2088

Form C-102
Revised February 21, 1994
Instructions on back
Submit to Appropriate District Office
State Lease - 4 Copies
Fee Lease - 3 Copies

☐ AMENDED REPORT

WELL LOCATION AND ACREAGE DEDICATION PLAT

¹ API Number	² Pool Code	³ Pool Name
	71599/96199	Basin Dakota / La Jara Pictured Cliffs
⁴ Property Code	⁵ Property Name	⁶ Well Number
19641	NEBU	# 345
⁷ OGRID No	⁸ Operator Name	⁹ Elevation
6137	Devon Energy Production Company, L.P.	6340

¹⁰ Surface Location

UL or Lot No	Section	Township	Range	Lot Idn	Feet from the	North/South line	Feet from the	East/West line	County
H	29	30 N	7 W		1575	NORTH	1105	EAST	Rio Arriba

¹¹ Bottom Hole Location If Different From Surface

¹² UL or lot no	Section	Township	Range	Lot Idn	Feet from the	North/South line	Feet from the	East/West line	County
A	29	30 N	7 W		900	NORTH	900	EAST	Rio Arriba

¹² Dedicated Acres	¹³ Joint or Infill	¹⁴ Consolidation Code	¹⁵ Order No.
320 - 472 DK 160 - 45 1/4 PC			

NO ALLOWABLE WILL BE ASSIGNED TO THIS COMPLETION UNTIL ALL INTERESTS HAVE BEEN CONSOLIDATED
OR A NON-STANDARD UNIT HAS BEEN APPROVED BY THE DIVISION

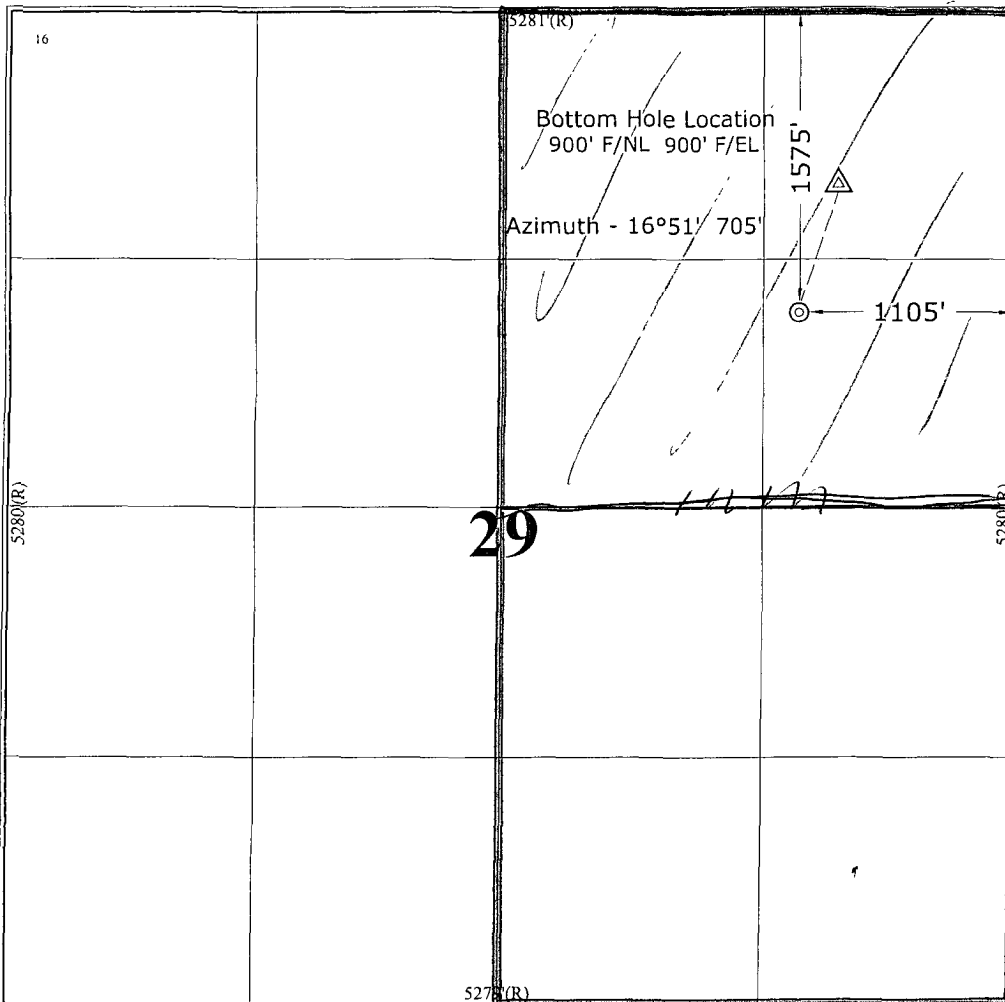

¹⁷ OPERATOR CERTIFICATION
I hereby certify that the information contained herein is true and complete to the best of my knowledge and belief

Signature: *[Signature]*
Printed Name: Melisa S. Castro
Title: Sr. Staff Operations Technician
Date: September 10, 2007

¹⁸ SURVEYOR CERTIFICATION
I hereby certify that the well location shown on this plat was plotted from field notes of actual surveys made by me or under my supervision, and that the same is true and correct to the best of my belief

July 10, 2006
Date of Survey
Signature and Seal of Professional Surveyor

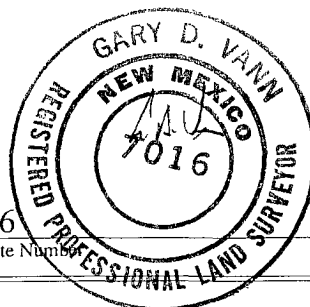

7016
Certificate Number