

**UNITED STATES  
DEPARTMENT OF THE INTERIOR  
BUREAU OF LAND MANAGEMENT**

## Sundry Notices and Reports on Wells

1. Type of Well  
GAS

2. Name of Operator  
**ConocoPhillips**

3. Address & Phone No. of Operator

PO Box 4289, Farmington, NM 87499 (505) 326-9700

4. Location of Well, Footage, Sec., T, R, M

Surf: Unit K (NESW), 1390' FSL & 1430' FWL, Section 11, T27N, R7W, NMPM

BH: Unit J (NWSE), 1590' FSL & 2400' FEL, Section 11, T27N, R7W, NMPM

**RECEIVED**

OCT 17 2007

Bureau of Land Management  
Farmington Field Office

5. Lease Number  
SF-078972
6. If Indian, All. or  
Tribe Name
7. Unit Agreement Name  
San Juan 28-7 Unit
8. Well Name & Number
9. San Juan 28-7 Unit 157G  
API Well No.
- 30-039-30134
10. Field and Pool
11. County and State  
Rio Arriba Co., NM

**12. CHECK APPROPRIATE BOX TO INDICATE NATURE OF NOTICE, REPORT, OTHER DATA**

## Type of Submission

- ☒ Notice of Intent  
☐ Subsequent Report  
☐ Final Abandonment

## Type of Action

- ☐ Abandonment ☐ Change of Plans  
☐ Plugging ☐ Non-Routine Fracturing  
☐ Casing Repair ☐ Water Shut off  
☐ Altering Casing ☐ Conversion to Injection

☒ Other - move location

**13. Describe Proposed or Completed Operations**

ConocoPhillips wants to move this location from Surface of 1380' FSL & 1410' FWL to Surf: 1390' FSL & 1430' FWL.  
To accommodate wellhead and pit.

Cement will be adjusted according.

Attached are a new C-102 (plat), cut & fill, TOPO & driving directions.

RCWD OCT 19 '07  
OIL CONS. DIV.  
DIST. 3

**14. I hereby certify that the foregoing is true and correct.**

Signed Rhonda Rogers Rhonda Rogers Title Regulatory Technician Date 10/17/07

(This space for Federal or State Office use)

APPROVED BY Opie Press Title EPTL Date 10/18/07

CONDITION OF APPROVAL, if any:

Title 18 U.S.C. Section 1001, makes it a crime for any person knowingly and willfully to make any department or agency of the United States any false, fictitious or fraudulent statements or representations as to any matter within its jurisdiction

**NMOC**

10

## District I

1625 N French Dr., Hobbs, NM 88240

## District II

1301 W. Grand Avenue, Artesia, NM 88210

## District III

1000 Rio Brazos Rd., Aztec, NM 87410

## District IV

1220 S. St. Francis Dr., Santa Fe, NM 87505

State of New Mexico  
Energy, Minerals & Natural Resources Department  
OIL CONSERVATION DIVISION  
1220 South St. Francis Dr.  
Santa Fe, NM 87505

Form C-102

Revised October 12, 2005

Submit to Appropriate District Office

State Lease - 7 Copies

Fee Lease - 3 Copies

☐ AMENDED REPORT

## WELL LOCATION AND ACREAGE DEDICATION PLAT

<sup>1</sup> API Number 30-039-30134	<sup>2</sup> Pool Code 72319/71599	<sup>3</sup> Pool Name MESAVERDE / DAKOTA
<sup>4</sup> Property Code 31739	<sup>5</sup> Property Name SAN JUAN 28-7 UNIT	<sup>6</sup> Well Number 157G
<sup>7</sup> OGRID No. 217817	<sup>8</sup> Operator Name CONOCOPHILLIPS COMPANY	<sup>9</sup> Elevation 6642

<sup>10</sup> SURFACE LOCATION

UL or lot no.	Section	Township	Range	Lot Idn	Feet from the	North/South line	Feet from the	East/West line	County
K	11	27-N	7-W		1390	SOUTH	1430	WEST	RIO ARriba

<sup>11</sup> Bottom Hole Location If Different From Surface

UL or lot no.	Section	Township	Range	Lot Idn	Feet from the	North/South line	Feet from the	East/West line	County
J	11	27-N	7-W		1590	SOUTH	2400	EAST	RIO ARriba

<sup>12</sup> Dedicated Acres 320.0 E/2	<sup>13</sup> Joint or Infill	<sup>14</sup> Consolidation Code	<sup>15</sup> Order No.
--	-------------------------------	----------------------------------	-------------------------

NO ALLOWABLE WILL BE ASSIGNED TO THIS COMPLETION UNTIL ALL INTERESTS HAVE BEEN  
CONSOLIDATED OR A NON-STANDARD UNIT HAS BEEN APPROVED BY THE DIVISION

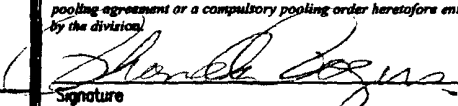
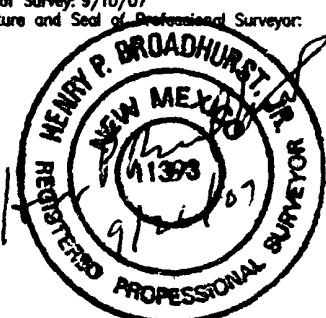
<sup>16</sup> <div style="text-align: center;"> <b>E/2 DEDICATED ACREAGE</b>  <b>SF-078972</b>  <b>SECTION 11,</b>  <b>T-27-N, R-7-W</b> </div>				<sup>17</sup> <b>OPERATOR CERTIFICATION</b> <i>I hereby certify that the information contained herein is true and complete to the best of my knowledge and belief, and that this organization either owns a working interest or unleased mineral interest in the land including the proposed bottom hole location or has a right to drill this well at this location pursuant to a contract with an owner of such a mineral or working interest, or to a voluntary pooling agreement or a compulsory pooling order heretofore entered by the division.</i>  Signature Rhonda Rogers Printed Name Regulatory Technician Title and E-mail Address 10/17/07 Date	
(M) (R) 2608.3' 2608.0' <b>WELL FLAG</b> <b>NAD 83</b> <b>LAT: 36.585704° N</b> <b>LONG: 107.547811° W</b> <b>NAD 27</b> <b>LAT: 36°35.141751' N</b> <b>LONG: 107°32.832295' W</b> 1430'		<b>BOTTOM HOLE</b> <b>NAD 83</b> <b>LAT: 36.586380° N</b> <b>LONG: 107.542846° W</b> <b>NAD 27</b> <b>LAT: 36°35.181100' N</b> <b>LONG: 107°32.534368' W</b> 2400'		<sup>18</sup> <b>SURVEYOR CERTIFICATION</b> <i>I hereby certify that the well location shown on this plat was plotted from field notes of actual surveys made by me or under my supervision, and that the same is true and correct to the best of my belief.</i> Date of Survey: 9/10/07 Signature and Seal of Professional Surveyor:  Certificate Number: NM 11393	
1'44'28" E 1'54' E N N S 88°34' W S 88°23'46" W		1390' 1590'		5295.8' (R) 5292.0' (M)	

# CONOCOPHILLIPS COMPANY

SAN JUAN 28-7 UNIT #157G

1390' FSL, 1430' FWL

SECTION 11, T-27-N, R-7-W, N.M.P.M.,

RIO ARriba COUNTY, NEW MEXICO

ELEV.: 6642 NAVD88

NO NEW ACCESS

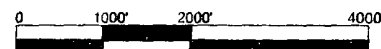
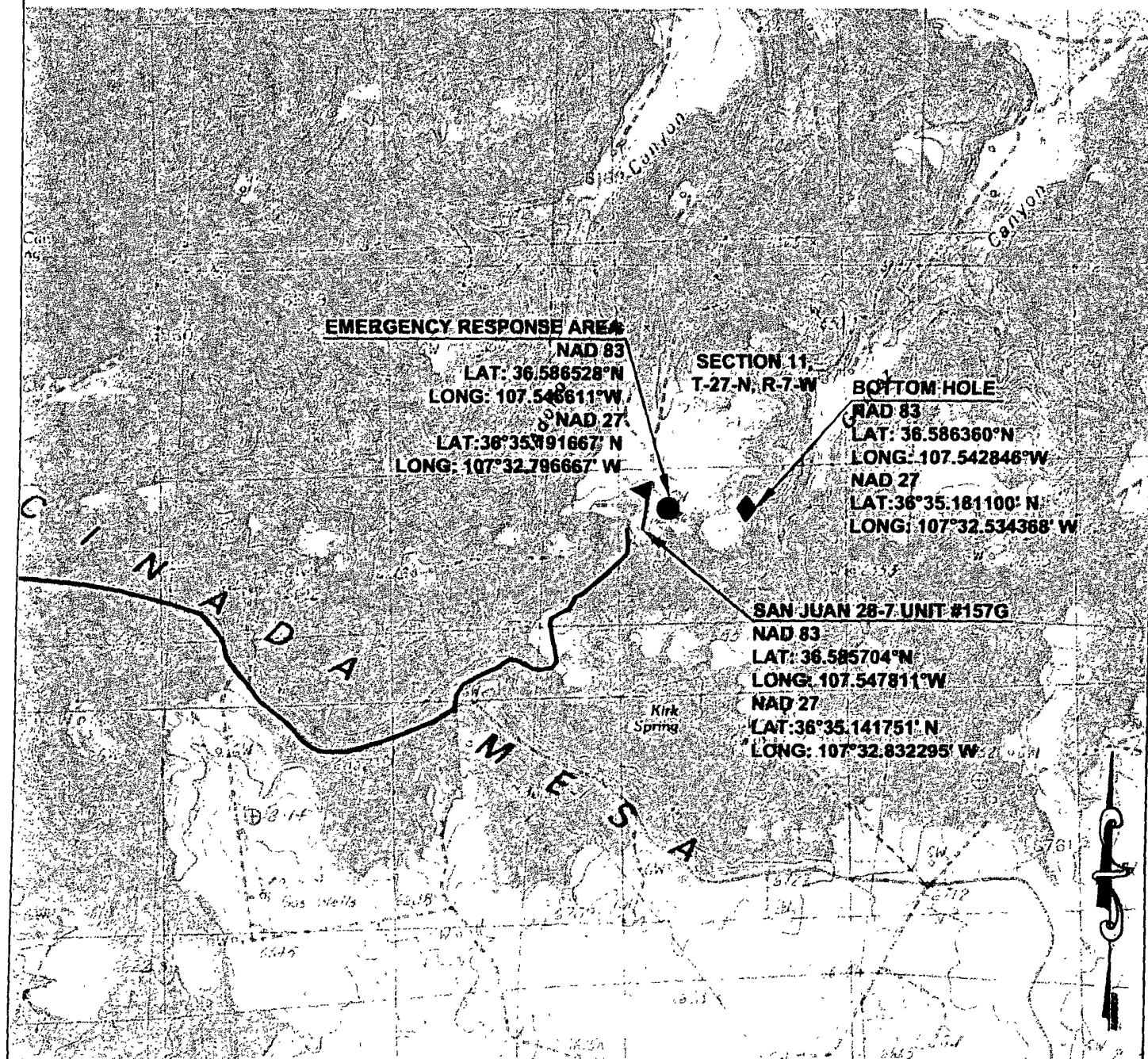

NOTE:

## REVISIONS

NO.	DESCRIPTION	REVISED BY	DATE
1	ISSUED FOR REVIEW	LH	7/17/07
2	WELL MOVE	TJR	9/10/07

**CCI**

P O BOX 328  
BLOOMFIELD, NM, 87413  
PHONE: (505) 325-7707

**CHENAULT CONSULTING INC.**

# CONOCOPHILLIPS COMPANY

SAN JUAN 28-7 UNIT #157G

1390' FSL, 1430' FWL

SECTION 11, T-27-N, R-7-W, N.M.P.M.,  
RIO ARriba COUNTY, NEW MEXICO

GROUND ELEV.: 6642 NAVD88 DATE: SEPTEMBER 10, 2007

NO NEW ACCESS

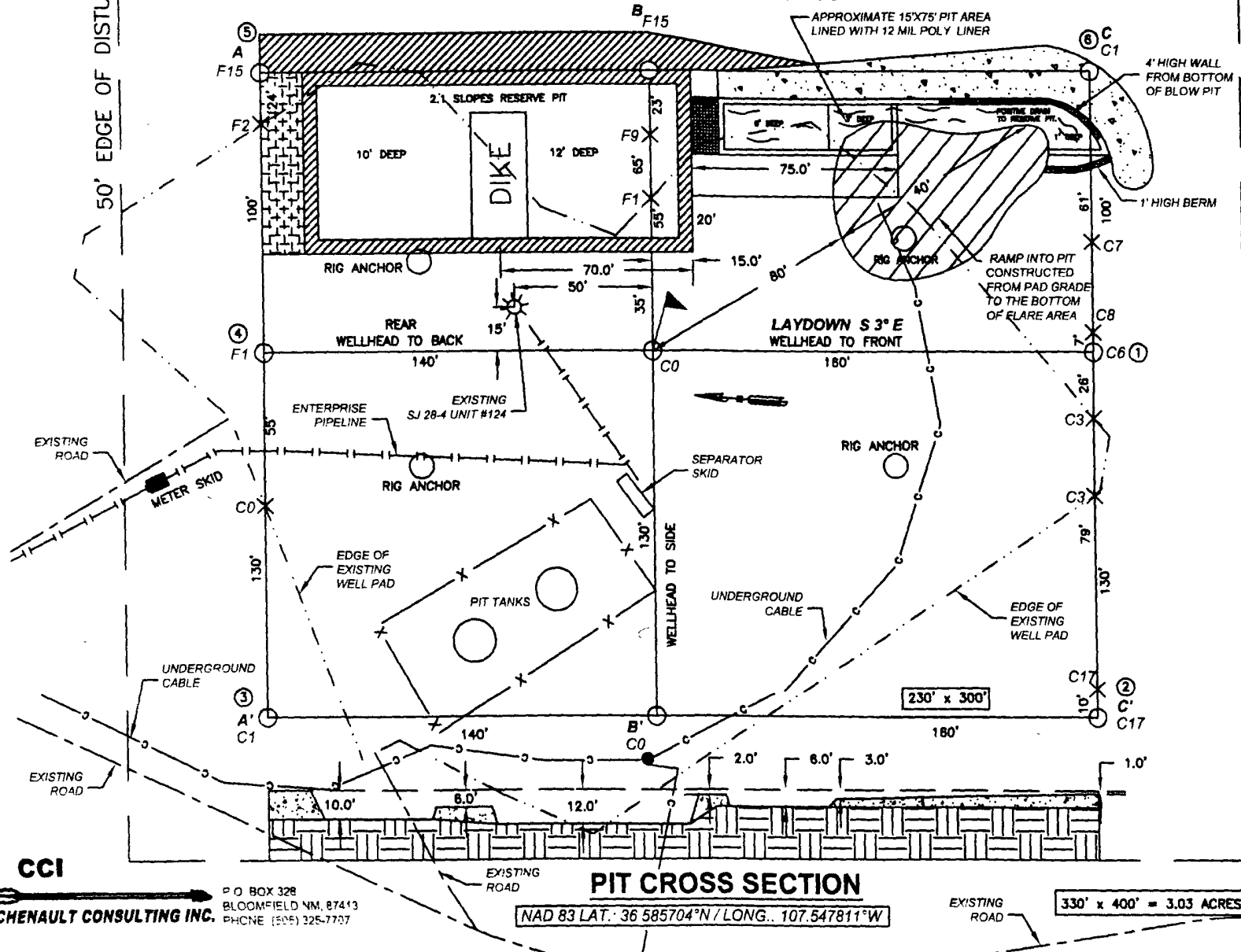

NOTES:

1. RESERVE PIT DIKE: TO BE 8' ABOVE DEEP SIDE (OVERFLOW-3' WIDE AND 1' ABOVE SHALLOW SIDE).
2. C.C.I. SURVEYS IS NOT LIABLE FOR UNDERGROUND UTILITIES OR PIPELINES. CONTRACTOR SHOULD CALL ONE-CALL FOR LOCATION OF ANY MARKED OR UNMARKED BURIED PIPELINES OR CABLES ON WELL PAD AND OR ACCESS ROAD AT LEAST TWO (2) WORKING DAYS PRIOR TO CONSTRUCTION.

**CONOCOPHILLIPS COMPANY**  
**SAN JUAN 28-7 UNIT #157G**  
 1390' FSL, 1430' FWL  
**SECTION 11, T-27-N, R-7-W, N.M.P.M.,**  
**RIO ARriba COUNTY, NEW MEXICO**  
 ELEV.: 6642 NAVD88

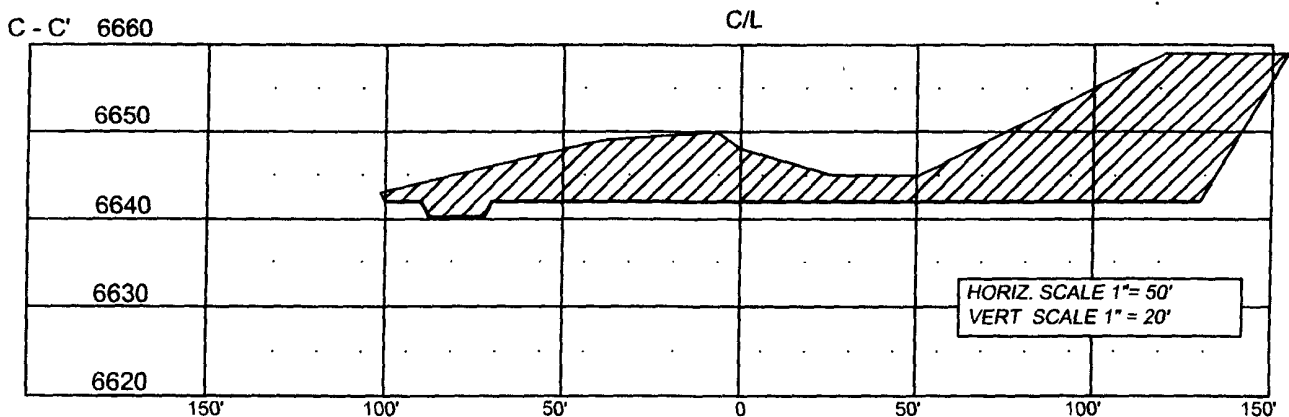
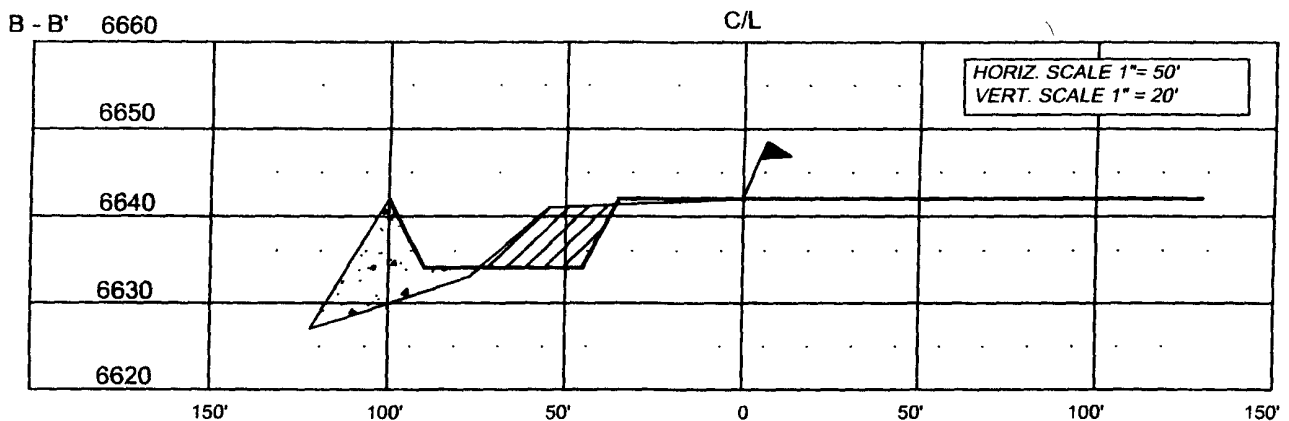
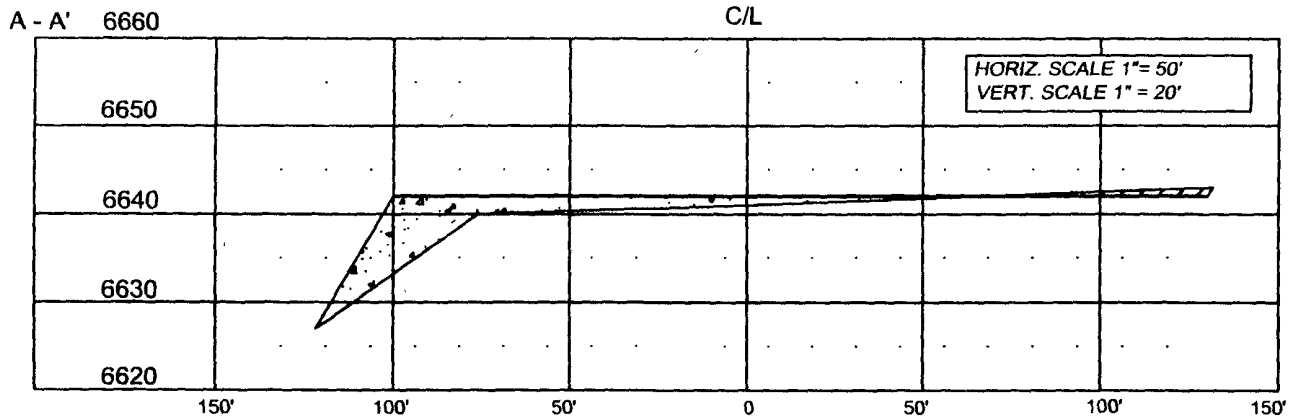

NOTE: CCI IS NOT LIABLE FOR UNDERGROUND UTILITIES OR PIPELINES.

CONTRACTOR SHOULD CALL ONE-CALL FOR LOCATION OF ANY MARKED OR UNMARKED BURIED PIPELINES OR CABLES ON WELL PAD AND OR ACCESS ROAD PRIOR TO CONSTRUCTION.

REVISIONS			
NO.	DESCRIPTION	REVISED BY	DATE
1	ISSUED FOR REVIEW	L.H.	7/17/07
2	WELL MOVE	TJR	9/10/07

**CCI**  
 P.O. BOX 328  
 BLOOMFIELD, NM, 87413  
 PHONE: (505) 325-7707  
**CHENault CONSULTING INC.**

# **CONOCOPHILLIPS COMPANY**

---

**SAN JUAN 28-7 UNIT #157G**

**1390' FSL, 1430' FWL**

**SECTION 11, T-27-N, R-7-W, N.M.P.M.,**

**RIO ARriba COUNTY, NEW MEXICO**

**NAD 83 LAT.: 36.585704' N LONG.: 107.547811' W**

**GROUND ELEV.: 6642 DATE: SPETMEBER 10, 2007**

**NO NEW ACCESS**

- FROM INTERSECTION OF STATE HWY. 64 & C.R. 4450 (LARGO CANYON RD.)
- TURN SOUTHEASTERLY ON C.R. 4450 AND GO 9.2 MILES TO "10 MILE BRIDGE"
- CROSS BRIDGE (CARRIZO CANYON WASH).
- TURN LEFT (SOUTHEASTERLY) AND CONTINUE ON MAIN ROAD ALONG SOUTH SIDE OF CARRIZO WASH AND KEEP RIGHT, INTO CANYON LEADING UP TO GOULD PASS.
- CONTINUE ON MAIN ROAD SOUTHWESTERLY FOR 9.9 MILES TO AN EXISTING "Y" IN THE ROAD.
- TURN RIGHT (SOUTHEASTERLY) AND GO 2 MILES ALONG TOP OF RIDGE.
- TURN LEFT (NORTHEASTERLY), JUST BEFORE BURLINGTON GOULD PASS WATER WELL SITE. AND GO 0.8 MILE.
- TURN RIGHT TO EXISTING WELL LOCATION (SAN JUAN 28-7 UNIT #124)
- WELL STAKED AS TWIN ON THIS LOCATION.