

**UNITED STATES
DEPARTMENT OF THE INTERIOR
BUREAU OF LAND MANAGEMENT**

Sundry Notices and Reports on Wells

GAS

RECEIVED**OCT 16 2007**Bureau of Land Management
Farmington Field Office

2. Name of Operator

ConocoPhillips

3. Address & Phone No. of Operator

PO Box 4289, Farmington, NM 87499 (505) 326-9700

4. Location of Well, Footage, Sec., T, R, M

Unit G. 2280' FNL & 1780' FEL, Sec. 30, T28N, R7W, NMPM

5. Lease Number
SF-078500-A
Tribe Name

7. Unit Agreement Name

8. San Juan 28-7 Unit
Well Name & Number9. San Juan 28-7 Unit #249G
API Well No.10. 30-039- 30339
Field and PoolBasin DK / Blanco MV
11. County and State
Rio Arriba, NM

12. CHECK APPROPRIATE BOX TO INDICATE NATURE OF NOTICE, REPORT, OTHER DATA

Type of Submission

☒ Notice of Intent☐ Subsequent Report☐ Final Abandonment

Type of Action

☐ Abandonment☐ Recompletion☐ Plugging☐ Casing Repair☐ Altering Casing☐ Change of Plans☐ New Construction☐ Non-Routine Fracturing☐ Water Shut off☐ Conversion to Injection☒ Other - Access road & wellpad approval

13. Describe Proposed or Completed Operations

ConocoPhillips wishes to be granted permission to build and utilize the subject well pad and access road on Federal lands. This is a directional drill well that we are applying for an APD with the State NMOCDD since the bottomhole location is on FEE. We feel that the San Juan 28-7 Unit agreements approved by the BLM covers our rights to utilize the well pad and access road to drill and complete this well.

Attached you will find the plat, topo, well pad diagram, case recordation showing that the Lease on which the surface location lies is included in the 28-7 Unit. Included also are the Biological Survey Report and the copy of the arch report we have on file for this access road and well pad. This well is also located within the SJ 28-7 Unit Participating Area (PA) for MV and for DK which indicates that all wells in the PA have the same interest ownership for wells on State or Federal lands.

RCVD NOV 19 '07**OIL CONS. DIV.****DIST. 3**

14. I hereby certify that the foregoing is true and correct.

Signed

Patsy Clugston

Patsy Clugston

Title Regulatory Specialist

Date 10/15/07

(This space for Federal or State Office use)

APPROVED BY

Bruce

Title EPTC

Date 11/15/07

CONDITION OF APPROVAL, if any:

Title 18 U.S.C. Section 1001, makes it a crime for any person knowingly and willfully to make any department or agency of the United States any false, fictitious or fraudulent statements or representations as to any matter within its jurisdiction

NMOCDD

DISTRICT I
1625 N. French Dr., Hobbs, N.M. 88240

State of New Mexico
Energy, Minerals & Natural Resources Department

Form C-102
Revised October 12, 2005

DISTRICT II
1301 West Grand Avenue, Artesia, N.M. 88210

OIL CONSERVATION DIVISION

Submit to Appropriate District Office
State Lease - 4 Copies
Fee Lease - 3 Copies

DISTRICT III
1000 Rio Brazos Rd., Aztec, N.M. 87410

1220 South St. Francis Dr.
Santa Fe, NM 87505

DISTRICT IV
1220 S. St. Francis Dr., Santa Fe, NM 87505

☐ AMENDED REPORT

WELL LOCATION AND ACREAGE DEDICATION PLAT

¹ API Number 30-039-30339	² Pool Code 71599/72319	³ Pool Name BASIN DAKOTA/BLANCO MESAVERDE
⁴ Property Code 31739	⁵ Property Name SAN JUAN 28-7 UNIT	⁶ Well Number 249G
⁷ OGRID No. 217817	⁸ Operator Name CONOCOPHILLIPS COMPANY	⁹ Elevation 5947'

¹⁰ Surface Location

UL or lot no.	Section	Township	Range	Lot Idn	Feet from the	North/South line	Feet from the	East/West line	County
G	30	28-N	7-W		2280'	NORTH	1780'	EAST	RIO ARRIBA

¹¹ Bottom Hole Location If Different From Surface

UL or lot no.	Section	Township	Range	Lot Idn	Feet from the	North/South line	Feet from the	East/West line	County
I	30	28-N	7-W		2070'	SOUTH	575'	EAST	RIO ARRIBA

¹² Dedicated Acres 320.00	¹³ Joint or Infill	¹⁴ Consolidation Code	¹⁵ Order No.
---	-------------------------------	----------------------------------	-------------------------

NO ALLOWABLE WILL BE ASSIGNED TO THIS COMPLETION UNTIL ALL INTERESTS HAVE BEEN CONSOLIDATED
OR A NON-STANDARD UNIT HAS BEEN APPROVED BY THE DIVISION

16

<p>LAT: 36°37.9952' N. LONG: 107°36.6778' W. NAD 1927</p>	<p>SF-078500-A</p>	<p>S 89° 55' 41" W 2628.92'</p>
<p>LAT: 36.633261' N. LONG: 107.611905' W. NAD 1983 Surface</p>	<p>2280'</p>	<p>S 00° 03' 21" W 2841.51'</p>
<p>30</p>	<p>Surface</p>	<p>1780'</p>
<p>LAT: 36°37.8414' N. LONG: 107°36.4309' W. NAD 1927</p>	<p>FEE</p>	<p>Bottom Hole 575'</p>
<p>LAT: 36.630697' N. LONG: 107.607790' W. NAD 1983 Bottom Hole</p>	<p>SF-078500-A</p>	<p>2070'</p>
		<p>N 0° 05' 06" W 2846.75'</p>
		<p>S 89° 58' 08" W 2827.45'</p>

17 OPERATOR CERTIFICATION

I hereby certify that the information contained herein is true and complete to the best of my knowledge and belief, and that this organization either owns a working interest or unleased mineral interest in the land including the proposed bottom hole location or has a right to drill this well at this location pursuant to a contract with an owner of such a mineral or a working interest, or to a voluntary pooling agreement or a compulsory pooling order heretofore entered by the division.

Patsy Clugston
Signature
Patsy Clugston
Printed Name

18 SURVEYOR CERTIFICATION

I hereby certify that the well location shown on this plat was plotted from field notes of actual surveys made by me or under my supervision, and that the same is true and correct to the best of my belief.

5-23-07
Date of Survey
GLEN W. RUSSELL
Signature
GLEN W. RUSSELL
Professional Surveyor
15703
Certificate Number

CONOCOPHILLIPS COMPANY

SAN JUAN 28-7 UNIT 249G

2280' FNL & 1780' FEL

SEC. 30, T28N R7W, NMPM

RIO ARRIBA COUNTY, NEW MEXICO

APD MAP

50' NEW BLM ACCESS

ERA

36.63359N

107.61016W

NAD 83

SAN JUAN 28-7 UNIT 249G

EXISTING ACCESS

50' NEW BLM ACCESS

0 5 1 MILE

0 1000 FEET 0 500 1000 METERS

Printed from TOPOI ©2001 National Geographic Holdings (www.topo.com)

CONOCOPHILLIPS COMPANY.

SAN JUAN 28-7 UNIT 249G, 2280' FNL & 1780' FEL
SECTION 30, T-28-N, R-7-W, NMPM, RIO ARriba COUNTY, NM
GROUND ELEVATION: 5947', DATE: MAY 10, 2007

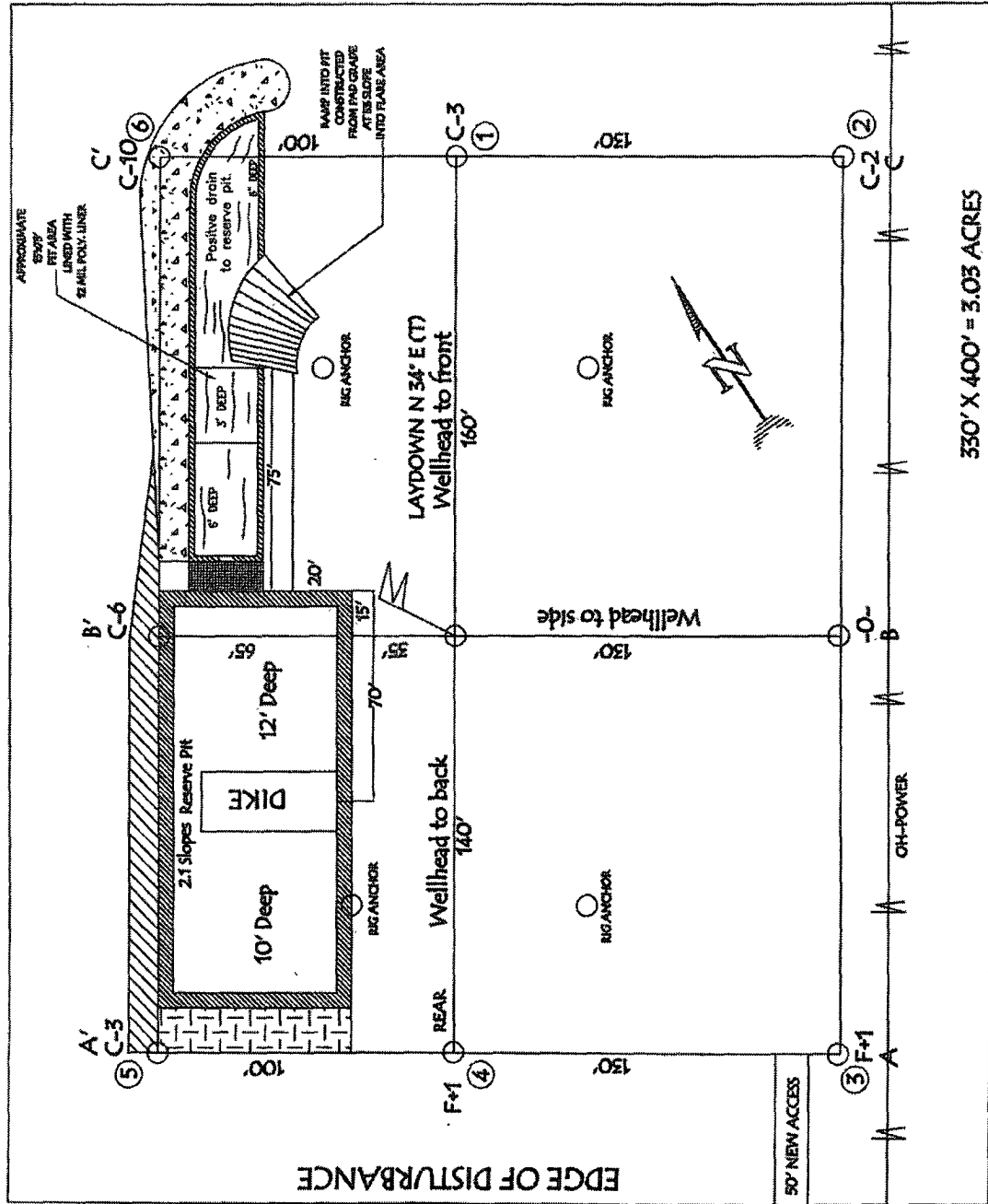

RESERVE PIT DIKE: TO BE 8' ABOVE DEEP SIDE (OVERFLOW - 5' WIDE AND 1' ABOVE SHALLOW SIDE).

NOTE: VECTOR SURVEYS LLC IS NOT LIABLE FOR UNDERGROUND UTILITIES OR PIPELINES.
CONTRACTOR SHOULD CALL ONE-CALL FOR LOCATION OF ANY MARKED OR UNMARKED BURIED
PIPELINES OR CABLES ON WELL PAD AND OR ACCESS ROAD AT LEAST TWO (2) WORKING DAYS PRIOR TO CONSTRUCTION.

LATITUDE: 36° 37.9952'N LONGITUDE: 107° 36.6778'W NAD27