

RCVD NOV 20 '07

OIL CONS. DIV.
DIST. 3Form 3160-3
(April 2004)UNITED STATES
DEPARTMENT OF THE INTERIOR
BUREAU OF LAND MANAGEMENT

APPLICATION FOR PERMIT TO DRILL OR REENTER

FORM APPROVED
OMB No. 1004-0137
Expires March 31, 2007

2007 MAR 6 PM 2:06

5. Lease Serial No.
SF 079060

6. If Indian, Allottee or Tribe Name

BLM
210 EAST HUNTINGTON NM7. If Unit or CA Agreement, Name and No.
Northeast Blanco Unit8. Lease Name and Well No.
NEBU 19N

9. API Well No.

30-039-30216

10. Field and Pool, or Exploratory
Basin Dakota/S Los Pinos F/S P/C

11. Sec, T, R, M. or Blk and Survey or Area

P Sec. 20-30N-7W

12. County or Parish
Rio Arriba13. State
NM1a. Type of work: ☒ DRILL ☐ REENTER1b. Type of Well: ☐ Oil Well ☒ Gas Well ☐ Other ☐ Single Zone ☐ Multiple Zone2. Name of Operator
Devon Energy Production Company, L.P.3a. Address PO Box 6459
Farmington, NM 874193b. Phone No. (include area code)
405-552-7917

4. Location of Well (Report location clearly and in accordance with any State requirements *)

At surface 1,225' FSL & 785' FEL, Unit P, SE SE

At proposed prod zone 800' FSL & 1,880' FEL, Unit O, SW SE

14. Distance in miles and direction from nearest town or post office*
Approximately 31.3 miles15. Distance from proposed*
location to nearest
property or lease line, ft.
(Also to nearest drg unit line, if any) 785'16. No. of acres in lease
2236.44 Acres17. Spacing Unit dedicated to this well
E/2-320 Acres & SE/4-160 Acres18. Distance from proposed location*
to nearest well, drilling, completed,
applied for, on this lease, ft.19. Proposed Depth
8,456'

20. BLM/BIA Bond No. on file

21. Elevations (Show whether DF, KDB, RT, GL, etc)
GR 6,732'22. Approximate date work will start*
06/01/200723. Estimated duration
Unknown

24. Attachments

The following, completed in accordance with the requirements of Onshore Oil and Gas Order No.1, shall be attached to this form:

- Well plat certified by a registered surveyor.
- A Drilling Plan.
- A Surface Use Plan (if the location is on National Forest System Lands, the SUPO shall be filed with the appropriate Forest Service Office).
- Bond to cover the operations unless covered by an existing bond on file (see Item 20 above).
- Operator certification
- Such other site specific information and/or plans as may be required by the authorized officer.

25. Signature

Name (Printed/Typed)
Melisa Castro

Date

3-2-07

Title

Senior Staff Operations Technician

Approved by (Signature)

Name (Printed/Typed)

Date

11/19/07

Title

Office

Application approval does not warrant or certify that the applicant holds legal or equitable title to those rights in the subject lease which would entitle the applicant to conduct operations thereon.
Conditions of approval, if any, are attached.

Title 18 U.S.C. Section 1001 and Title 43 U.S.C. Section 1212, make it a crime for any person knowingly and willfully to make to any department or agency of the United States any false, fictitious or fraudulent statements or representations as to any matter within its jurisdiction.

*(Instructions on page 2)

H₂S POTENTIAL EXISTNOTIFY AZTEC OCD 24 HRS.
PRIOR TO CASING & CEMENTHOLD C104 FOR Directional survey and
as drilled C-102 form

NMOC

NOV 26 2007

B/K

AV

This action is subject to technical and
procedural review pursuant to 43 CFR 3165.3
and appeal pursuant to 43 CFR 3165.4DRILLING OPERATIONS AUTHORIZED ARE
SUBJECT TO COMPLIANCE WITH ATTACHED
"GENERAL REQUIREMENTS".

District I
PO Box 1980, Hobbs NM 88241-1980
District II
PO Drawer KK, Artesia, NM 87211-0719
District III
1000 Rio Brazos Rd., Aztec, NM 87410
District IV
PO Box 2088, Santa Fe, NM 87504-2088

State of New Mexico
Energy, Minerals & Natural Resources Department

OIL CONSERVATION DIVISION
PO Box 2088
Santa Fe, NM 87504-2088

Form C-102
Revised February 21, 1994

Instructions on back
Submit to Appropriate District Office
State Lease - 4 Copies
Fee Lease - 3 Copies

2007 MAR -6 PM 2:07

☐ AMENDED REPORT

WELL LOCATION AND ACREAGE DEDICATION PLAT

¹ API Number 30-039-30216	² Pool Code 71599/96199	³ Pool Name Basin Dakota / S Los Pinos F/S Pk
⁴ Property Code 19641	⁵ Property Name NEBU	⁶ Well Number # 19N
⁷ OGRID No 6137	⁸ Operator Name Devon Energy Production Company, L.P.	⁹ Elevation 6732

¹⁰ Surface Location

UL or Lot No	Section	Township	Range	Lot Idn	Feet from the	North/South line	Feet from the	East/West line	County
P	20	30 N	7 W		1225	SOUTH	785	EAST	Rio Arriba

¹¹ Bottom Hole Location If Different From Surface

UL or lot no	Section	Township	Range	Lot Idn	Feet from the	North/South line	Feet from the	East/West line	County
O	20	30 N	7 W		800	SOUTH	1880	EAST	Rio Arriba

¹² Dedicated Acres 6/2-320-DK 56/4-160-PC	¹³ Joint or Infill	¹⁴ Consolidation Code	¹⁵ Order No
--	-------------------------------	----------------------------------	------------------------

NO ALLOWABLE WILL BE ASSIGNED TO THIS COMPLETION UNTIL ALL INTERESTS HAVE BEEN CONSOLIDATED
OR A NON-STANDARD UNIT HAS BEEN APPROVED BY THE DIVISION

¹⁶ Lot 1 Lot 2	5275 (R)	5280 (R)	5281 (R)	5275 (R)	Bottom Hole Location 800' F/SL 1880' F/EL	Azimuth - 248°47'	1175'	785'	1225'	5280 (R)	¹⁷ OPERATOR CERTIFICATION I hereby certify that the information contained herein is true and complete to the best of my knowledge and belief Signature Melisa S. Castro Printed Name Sr. Staff Operations Technician Title March 2, 2007 Date
											¹⁸ SURVEYOR CERTIFICATION I hereby certify that the well location shown on this plat was plotted from field notes of actual surveys made by me or under my supervision, and that the same is true and correct to the best of my belief Restaked: November 7, 2006 July 13, 2006 Date of Survey Signature and Seal of Professional Surveyor GARY D. VANN NEW MEXICO REGISTERED PROFESSIONAL SURVEYOR 7016 Certificate Number

Submit 3 Copies To Appropriate District
Office
District I
1625 N. French Dr., Hobbs, NM 88240
District II
1301 W. Grand Ave., Artesia, NM 88210
District III
1000 Rio Brazos Rd., Aztec, NM 87410
District IV
1220 S. St. Francis Dr., Santa Fe, NM
87505

State of New Mexico
Energy, Minerals and Natural Resources

Form C-103
March 4, 2004

OIL CONSERVATION DIVISION
1220 South St. Francis Dr.
Santa Fe, NM 87505

WELL API NO. 30-039-30216
5. Indicate Type of Lease LEASE <input checked="" type="checkbox"/> STATE <input type="checkbox"/> FEE <input type="checkbox"/>
6. State Oil & Gas Lease No. SE 079060
7. Lease Name or Unit Agreement Name NORTHEAST BLANCO UNIT
8. Well Number 19N
9. OGRID Number 6137
10. Pool name or Wildcat Basin Dakota/S Los Pinos F/S Pictured Cliffs

SUNDRY NOTICES AND REPORTS ON WELLS
(DO NOT USE THIS FORM FOR PROPOSALS TO DRILL OR TO DEEPEN OR PLUG BACK TO A
DIFFERENT RESERVOIR. USE "APPLICATION FOR PERMIT" (FORM C-101) FOR SUCH
PROPOSALS.)

1. Type of Well:
Oil Well ☐ Gas Well ☒ Other

2. Name of Operator
Devon Energy Production Company, L.P.

3. Address of Operator
PO Box 6459, Navajo Dam, NM 87419

4. Well Location
Unit Letter **P** : **1,225** feet from the **South** line and **785** feet from the **East** line
Section **20** Township **30N** Range **7W** NMPM County - **Rio Arriba**

11. Elevation (Show whether DR, RKB, RT, GR, etc.)
GR 6,732'

Pit or Below-grade Tank Application (For pit or below-grade tank closures, a form C-144 must be attached)

Pit Location: UL **P** Sect **20** Twp **30N** Rng **7W** Pit type **Drilling** Depth to Groundwater **>100'** Distance from nearest fresh water well **>1000'**

Distance from nearest surface water **>1000'** Below-grade Tank Location UL **P** Sect **20** Twp **30N** Rng **7W** ;

feet from the **South** line and **785** feet from the **East** line

12. Check Appropriate Box to Indicate Nature of Notice, Report or Other Data
NOTICE OF INTENTION TO:

PERFORM REMEDIAL WORK ☐ PLUG AND ABANDON ☐

TEMPORARILY ABANDON ☐ CHANGE PLANS ☐

PULL OR ALTER CASING ☐ MULTIPLE COMPLETION ☐

OTHER: **CONSTRUCT DRILLING PIT** ☒

SUBSEQUENT REPORT OF:

REMEDIAL WORK ☐ ALTERING CASING ☐

COMMENCE DRILLING OPNS. ☐ PLUG AND ABANDONMENT ☐

CASING TEST AND CEMENT JOB ☐

OTHER: ☐

13. Describe proposed or completed operations. (Clearly state all pertinent details, and give pertinent dates, including estimated date of starting any proposed work). SEE RULE 1103. For Multiple Completions: Attach wellbore diagram of proposed completion or recompletion.

14.

Devon Energy will be constructing a lined drilling pit. The closure of said pit will be in accordance with the NMOCD regulations with the cutting of the liner applying to the BLM rules.

I hereby certify that the information above is true and complete to the best of my knowledge and belief. I further certify that any pit or below-grade tank has been/will be constructed or closed according to NMOCD guidelines ☒, a general permit ☐ or an (attached) alternative OCD-approved plan ☐.

SIGNATURE  TITLE Sr. Staff Operations Technician DATE 3-2-07

Type or print name Melisa Castro E-mail address: Melisa.castro@dvnm.com Telephone No. 405-552-7917

(This space for State use)

APPROVED BY  TITLE Deputy Oil & Gas Inspector,
District # 3 DATE NOV 26 2007

Conditions of approval, if any

PAD LAYOUT PLAN & PROFILE
DEVON ENERGY PRODUCTION COMPANY, L.P.

Nebu # 19N
1225' F/SL 785' F/EL
SEC. 20, T30N, R7W, N.M.P.M.
RIO ARriba COUNTY, NEW MEXICO

Lat: 36.79424°
Long: 107.58805° (83)

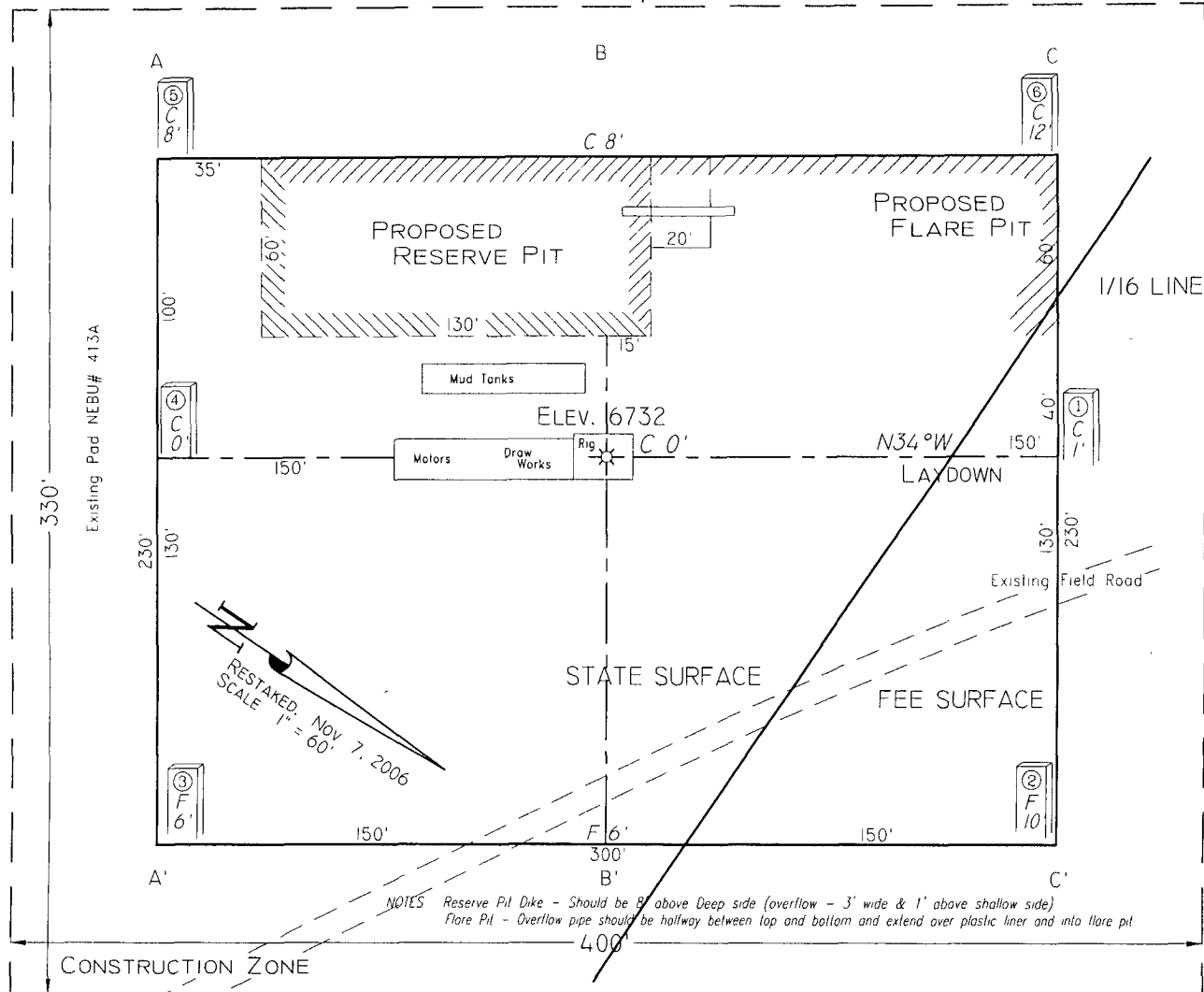

Area of Construction Zone - 330'x400' or 3.03 acres, more or less

SCALE 1"=60'-HORIZ
1"=40'-VERT

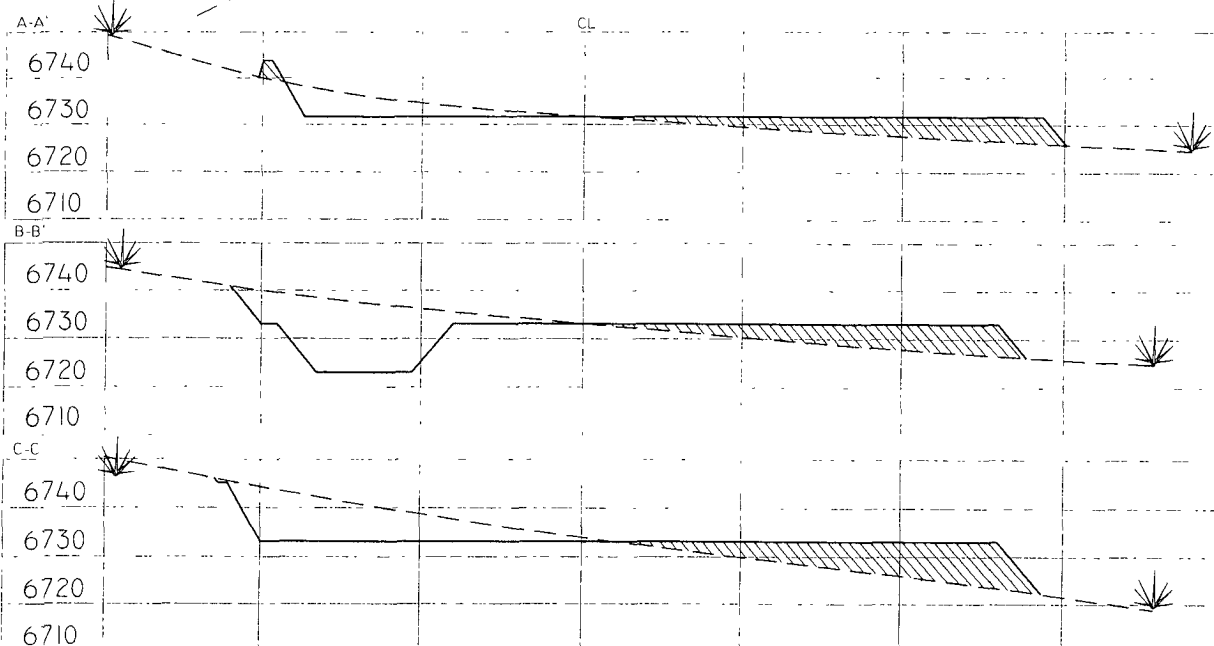

NOTE Contractor should call One-Call for location of any marked or unmarked buried pipelines or cables on well pad and/or access road at least two (2) working days prior to construction

Cuts and fills shown are approximate - final finished elevation is to be adjusted so earthwork will balance. Corner stakes are approximate and do not include additional areas needed for sideslopes and drainages. Final Pad Dimensions are to be verified by Contractor

VANN SURVEYS
P O Box 1306
Farmington, NM

**NEBU 19N
Unit P 20-30N-7W
San Juan Co., NM**

DRILLING PLAN

1. ESTIMATED TOPS OF IMPORTANT GEOLOGIC MARKERS & ANTICIPATED WATER, OIL, GAS OR MINERAL FORMATIONS:

Formation	TMD (ft)	TVD (ft)	Hydrocarbon/Water Bearing Zones
San Jose	Surface	Surface	
Ojo Alamo	2922	2714	Aquifer
Kirtland	3052	2835	
Fruitland	3494	3260	Gas
Fruitland 1 st Coal	3724	3487	Gas
Pictured Cliffs Tongue	3980	3743	Gas
Pictured Cliffs Main	3985	3748	Gas
Lewis	4055	3818	Gas
Intermediate TD	4155	3918	
Huefanito Bentonite	4652	4415	Gas
Chacra / Otera	4991	4754	Gas
Cliff House	5542	5305	Gas
Menefee	5852	5615	Gas
Point Lookout	6176	5939	Gas
Mancos	6523	6286	Gas
Gallup	7451	7214	Gas
Greenhorn	8140	7903	
Graneros	8199	7962	Gas
Paguate	8336	8099	
Cubero	8360	8123	
Oak Canyon	8420	8183	
Encinal Canyon	8443	8206	

TD	8456	8219	
----	------	------	--

*All shows of fresh water and minerals will be adequately protected and reported.

2. PRESSURE CONTROL EQUIPMENT:

All well control equipment shall be in accordance with Onshore Order #2 for 2M systems.

The minimum specifications for pressure control equipment that will be provided are included on the attached schematic diagram, with a size of 2", and pressure ratings.

- 2000# BOP With Pipe Rams and 2000# BOP With Blind Rams

Auxiliary equipment to be used:

- Upper kelly cock with handle available.

The manifold includes appropriate valves and adjustable chokes. The kill line will have one check valve. Ram type preventers will be pressure tested to full working pressure (utilizing a test plug) or 70% of the internal yield pressure (without a test plug) at:

- Initial installation
- Whenever any seal subject to test pressure is broken
- Following related repairs
- At 30 day intervals

Pipe and blind rams shall be activated each trip.

A BOPE pit level drill will be conducted weekly for each drilling crew.
All tests and drills will be recorded in the drilling log.

The accumulator will have sufficient capacity to close all rams and retain 200 psi above pre-charge pressure without the use of closing unit pumps.

Master controls will be at the accumulator. Anticipated bottom hole pressure is 3400 psi.

3. CASING & CEMENTING PROGRAM:

A. The proposed casing program will be as follows:

TMD	TVD	Hole Size	Size	Grade	Weight	Thread	Condition
0-285'	0-285'	12-1/4"	9-5/8"	H-40	32#	STC	New
0-4155	0-3818'	8-3/4"	7"	K-55	23#	LTC	New
0- TD	0- TD	6-1/4"	4-1/2"	J-55	11.6 #	LTC	New

The 9-5/8" surface pipe will be tested to 750 psi. All casing strings below the surface shoe shall be pressure tested to 0.22 psi/ft. of casing string length or 1500 psi, whichever is greater, but not to exceed 70% minimum internal yield.

Surface: The bottom three joints of the surface casing will have a minimum of one centralizer per joint and one centralizer every joint thereafter (Total 5 centralizers estimated)

Intermediate: The bottom three joints of the 7" casing will have a minimum of one centralizer per joint and one centralizer every fifth joint thereafter to above Ojo Alamo with turbolizers below and throughout the Ojo Alamo. (Total 12 centralizers, 3 turbolizers estimated).

Production: The bottom three joints will have a minimum of one centralizer per joint and one centralizer every fifth joint to 3500' (estimated 25 centralizers used). Centralizers will be open bow spring or basket bow spring type.

B. The proposed cementing program will be as follows:

Surface String: Cement will be circulated to surface.

Lead: 200 sx Class "B" with 100% Standard Cement, 2.00% CaCl₂, .25 #/sx Flocele. Density: 15.6 lb/gal; Yield: 1.18 cuft/sx; Water: 5.24 gal/sx

** Minor variations possible due to existing conditions*

Intermediate String: Cement will be circulated to surface.

Lead: 500 sx 50/50 Poz, Yd-1.45, Water Gal/sx 6.8, Mixed @ 13ppg Foamed W/ N2 Down To 9.0# Additives 2% Gel, 0.2% Versaset, 0.1% Diacel Lwl.

Tail: 75 sx 50/50 Poz, Yd-1.45, Water Gal/Sk 6.8, Additives 2% Gel, 0.2% Versaset, 0.1% Diacel Lwl.

** Minor variations possible due to existing conditions*

If hole conditions dictate, an alternate, cement design will be used:

Lead: 575 sx 50/50 Poz with 50% Class B Cement, 50% San Juan Poz, .4% Halad-344, .1% CFR-3, 3% Bentonite, 5#/sx Gilsonite, .25#/sx Flocele. Density: 13.0 lb/gal; Yield: 1.46 cuft/sx; Water: 6.42 gal/sx

Tail: 75 sx 50/50 Poz with 94#/sx Standard Cement, 0.3% Halad-344, .25 #/sx Flocele. Density: 15.6 lb/gal; Yield: 1.18 cuft/sx; Water: 5.23 gal/sx

** Minor variations possible due to existing conditions*

Production String: TOC designed to circulate 1000' into intermediate string, cement will tie into the intermediate casing as a minimum. Volumes may vary with actual well characteristics.

Lead: 250 sx 50/50 Poz with 2% Gel, 0.2% Halad, 0.1% CFR-3, 5 #/sx Gilsonite, 0.25 #/sx Flocele. Mixed at 13 ppg, 1.47 ft 3/sx foamed to 9 ppg, 2.18 ft 3/sx.

Tail: 450 sx 50/50 Poz with 50% Standard Cement, 50% San Juan Poz, 3% Bentonite, 1.40% Halad-9, .10% CFR-3, .10% HR-5, 5 #/sx Gilsonite, 0.25 #/sx Flocele. Density: 13.0 lb/gal; Yield: 1.47 cuft/sx; Water: 6.35 gal/sx *

** Minor variations possible due to existing conditions*

Actual volumes will be calculated and adjusted with caliper log prior to cementing.

4. DRILLING FLUIDS PROGRAM:

TMD Interval	TVD Interval	Type	Weight (ppg)	Viscosity	pH	Water Loss	Remarks
0-285'	0-285'	Spud-foam	8.4-9.0	29-70	8.0	NC	FW gel, LSND or stiff foam
285'-4,055'	285'-3,818'	Air				NC	
4,055' - TD	3,818' - TD	Air/N2 or Mud	8.5-9.0*	30-50	8.0-10.0	8-810cc @ TD	Low solids-non-dispersed. * min Wt. to control formation pressure

NC = no control

Sufficient quantities of mud material will be maintained on site or be readily accessible for the purpose of assuring well control. SPR will be recorded on daily drilling report after mudding up. Visual mud monitoring will be conducted during operations.

5. EVALUATION PROGRAM:

Logs: Density
Neutron
Induction

In the event open hole logs are not run in the well, a cased hole evaluation log will be run.

Survey: Deviation surveys will be taken every 500' from 0-TD or first succeeding bit change. The hole will be air drilled from intermediate casing point to TD. The equipment used in this type of operation will not allow for single shot surveys without considerable operational delays. A survey will be taken at TD. Similar wells in this area have not shown significant deviation in this section of the hole.

Cores: None anticipated.

DST's: None anticipated.

6. ABNORMAL CONDITIONS:

The Fruitland Coal will be encountered in the 8-3/4" hole. Estimated formation pressure is 300 psi. No other abnormal pressures and/or temperatures are expected. No hydrogen sulfide should be present.

7. OTHER INFORMATION:

The anticipated starting date and duration of the operation will be as follows:

Company: Devon Energy
Lease/Well: NEBU 19 N
Location: Rio Arriba County
State/Country: TX

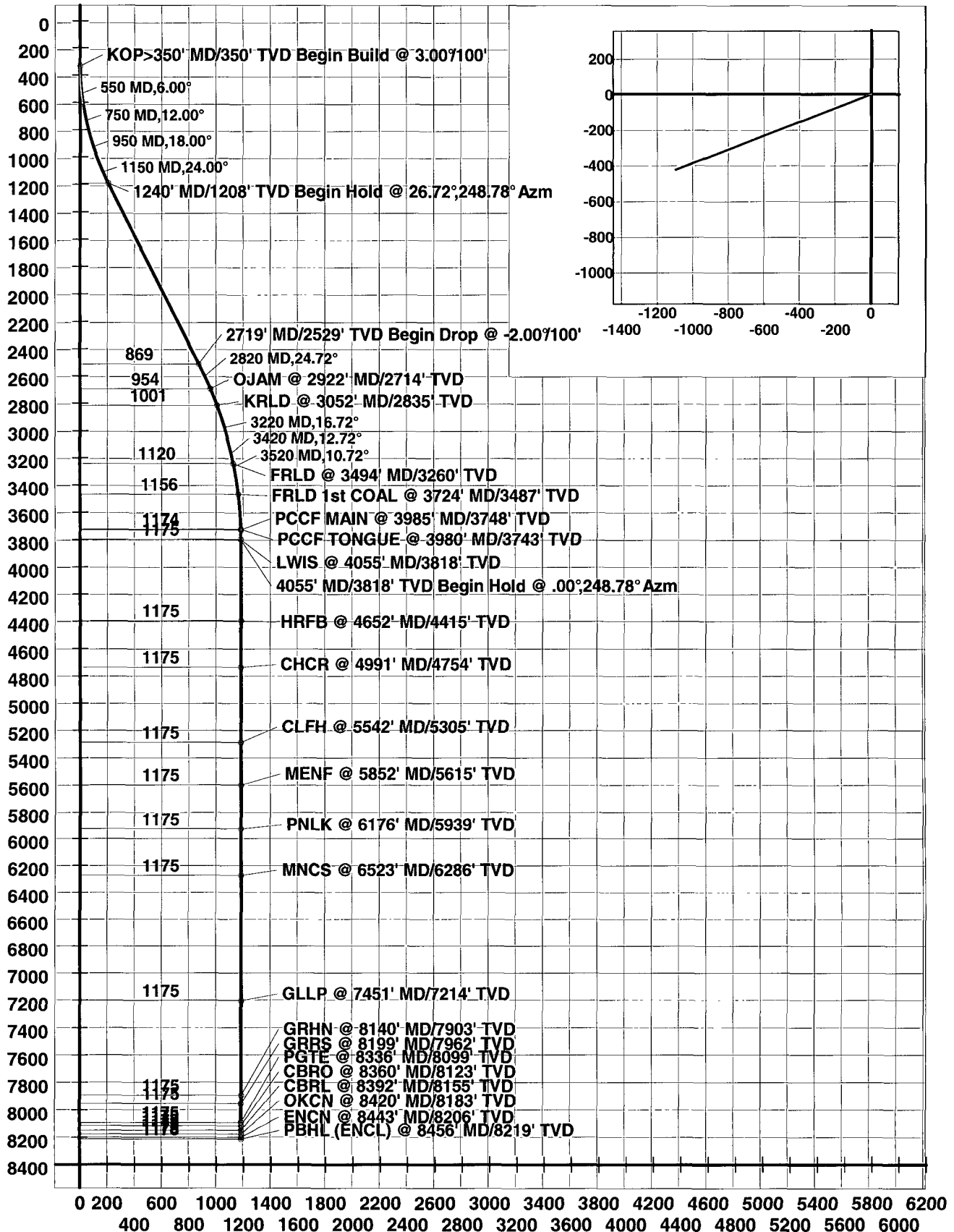

Well Control Equipment 2,000 psi Configuration

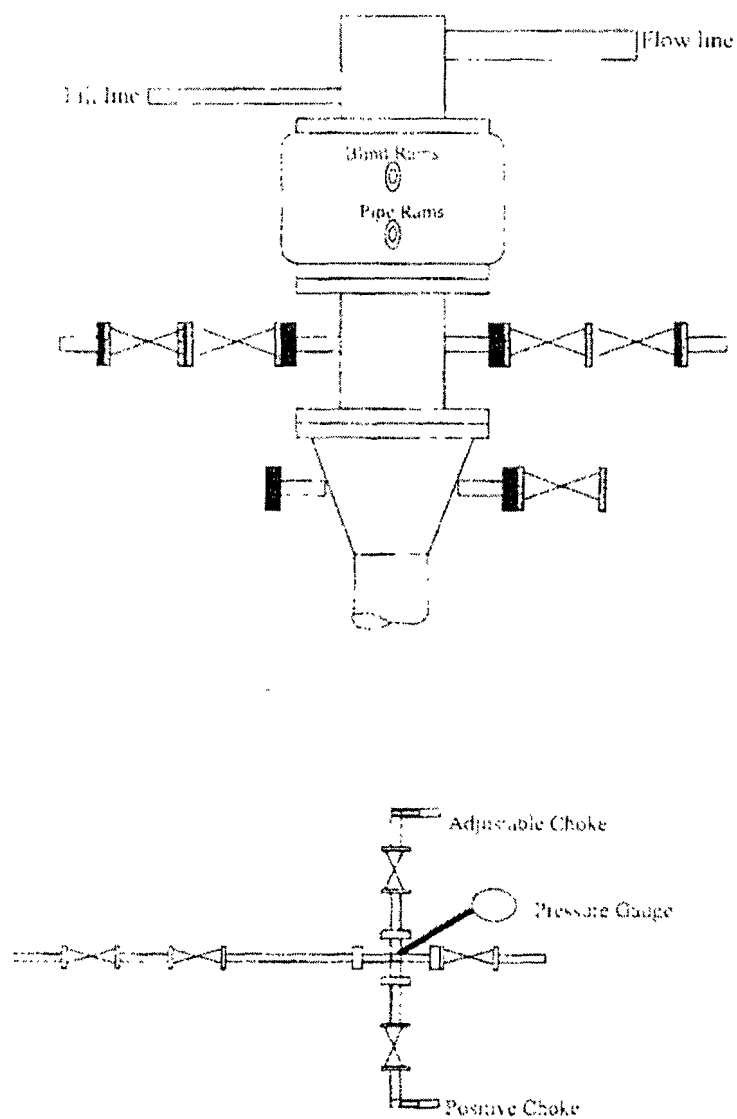

All well control equipment designed to meet or exceed the Onshore Oil and Gas Order No. 2, BLM 43 CTR 3150 requirements for 2M systems.