

District I
1625 N French Dr, Hobbs, NM 88240
District II
1301 W Grand Avenue, Artesia, NM 88210
District III
1000 Rio Brazos Road, Aztec, NM 87410
District IV
1220 S St Francis Dr., Santa Fe, NM 87505

State of New Mexico
Energy Minerals and Natural Resources

Form C-144
June 1, 2004

Oil Conservation Division
1220 South St. Francis Dr.
Santa Fe, NM 87505

For drilling and production facilities, submit to appropriate NMOCD District Office.
For downstream facilities, submit to Santa Fe office

Pit or Below-Grade Tank Registration or Closure

Is pit or below-grade tank covered by a "general plan"? Yes ☒ No ☐

Type of action Registration of a pit or below-grade tank ☐ Closure of a pit or below-grade tank ☒

Operator <u>XTO Energy Inc</u> Telephone <u>505-333-3100</u> e-mail address <u>kim_champlin@xtoenergy.com</u>		
Address <u>#382 County Road 3100, Aztec, NM 87410</u>		
Facility or well name <u>Bolack 28 #4E</u>	API # <u>30-045-32232</u>	U/L or Qtr/Qtr _____ Sec <u>28J</u> T <u>27N</u> R <u>11W</u>
County <u>San Juan</u>	Latitude _____	Longitude _____ NAD 1927 <input type="checkbox"/> 1983 <input type="checkbox"/>
Surface Owner Federal <input checked="" type="checkbox"/> State <input type="checkbox"/> Private <input type="checkbox"/> Indian <input type="checkbox"/>		
Pit Type Drilling <input checked="" type="checkbox"/> Production <input type="checkbox"/> Disposal <input type="checkbox"/> Workover <input type="checkbox"/> Emergency <input type="checkbox"/> Lined <input checked="" type="checkbox"/> Unlined <input type="checkbox"/> Liner type Synthetic <input type="checkbox"/> Thickness <u>12</u> mil Clay <input type="checkbox"/> Pit Volume _____ bbl	Below-grade tank Volume _____ bbl Type of fluid _____ Construction material _____ Double-walled, with leak detection? Yes <input type="checkbox"/> If not, explain why not _____	
Depth to ground water (vertical distance from bottom of pit to seasonal high water elevation of ground water)	Less than 50 feet 50 feet or more, but less than 100 feet 100 feet or more	(20 points) (10 points) (0 points) 0 Points
Wellhead protection area (Less than 200 feet from a private domestic water source, or less than 1000 feet from all other water sources)	Yes No	(20 points) (0 points) 0 Points
Distance to surface water (horizontal distance to all wetlands, playas, irrigation canals, ditches, and perennial and ephemeral watercourses)	Less than 200 feet 200 feet or more, but less than 1000 feet 1000 feet or more	(20 points) (10 points) (0 points) 0 Points
Ranking Score (Total Points)		0 Points

If this is a pit closure: (1) Attach a diagram of the facility showing the pit's relationship to other equipment and tanks (2) Indicate disposal location (check the onsite box if you are burying in place) onsite ☒ offsite ☐ If offsite, name of facility _____ (3) Attach a general description of remedial action taken including remediation start date and end date (4) Groundwater encountered No ☒ Yes ☐ If yes, show depth below ground surface _____ ft and attach sample results (5) Attach soil sample results and a diagram of sample locations and excavations

Additional Comments
The drilling reserve pit associated with the subject well was closed per NMOCD and BLM guidelines and in accordance with XTO's drilling pit closure plan.

I hereby certify that the information above is true and complete to the best of my knowledge and belief I further certify that the above-described pit or below-grade tank has been/will be constructed or closed according to NMOCD guidelines <input type="checkbox"/> , a general permit <input type="checkbox"/> , or an (attached) alternative OCD-approved plan <input type="checkbox"/> .		
Date <u>10/22/2007</u>	Signature <u>Kim Champlin</u>	
Printed Name/Title <u>Kim Champlin/Environmental Assistant</u>		
Your certification and NMOCD approval of this application/closure does not relieve the operator of liability should the contents of the pit or tank contaminate ground water or otherwise endanger public health or the environment. Nor does it relieve the operator of its responsibility for compliance with any other federal, state, or local laws and/or regulations		
Approval	Deputy Oil & Gas Inspector, District #3	Signature <u>Bob Bell</u>
Printed Name/Title		Date <u>NOV 28 2007</u>

1650' FSL & 1650' FRL
 Sec. 28, T27N, R11W, NMPM
 San Juan Co., NM

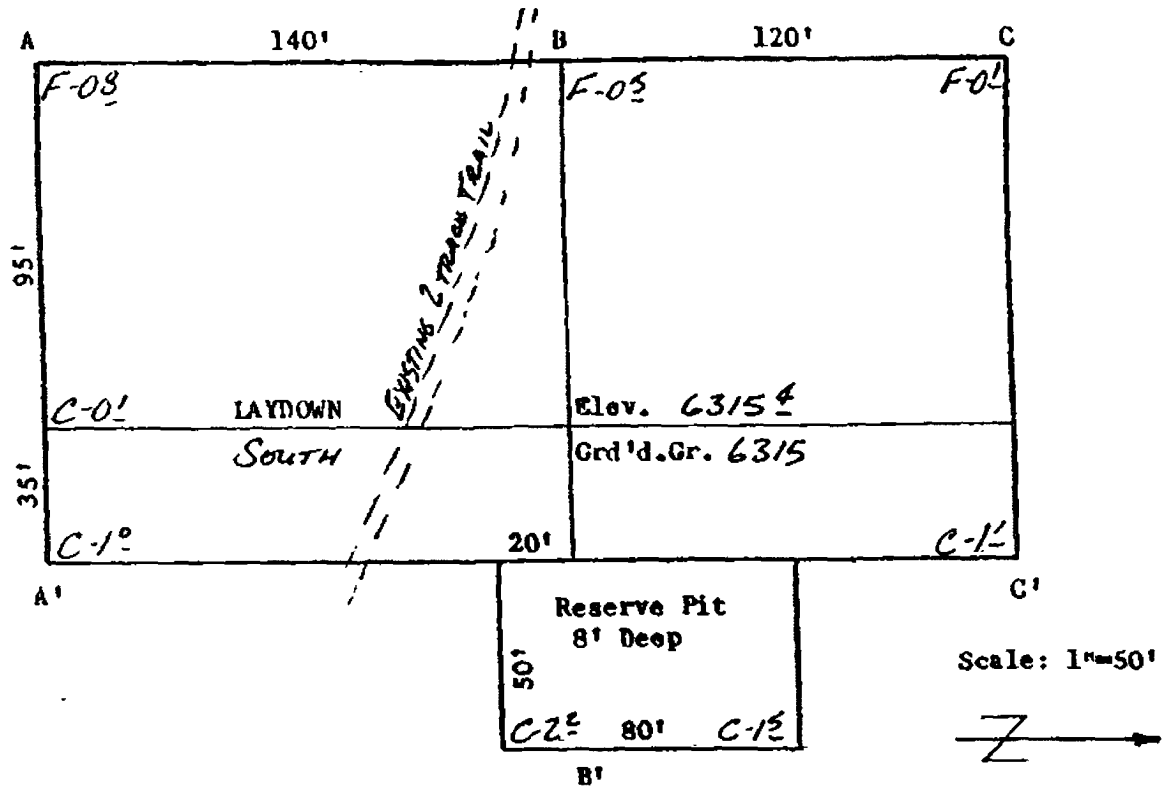

A-A'		Vert.: 1" = 30'		Horiz.: 1" = 100'		C/L	
6320							
6310							

B-B'		Vert.: 1" = 30'		Horiz.: 1" = 100'		C/L	
6320							
6310							

C-C'		Vert.: 1" = 30'		Horiz.: 1" = 100'		C/L	
6320							
6310							