

District I  
1625 N French Dr , Hobbs, NM 88240  
District II  
1301 W Grand Avenue, Artesia, NM 88210  
District III  
1000 Rio Brazos Road, Aztec, NM 87410  
District IV  
1220 S St Francis Dr , Santa Fe, NM 87505

State of New Mexico  
Energy Minerals and Natural Resources

Form C-144  
June 1, 2004

Oil Conservation Division  
1220 South St. Francis Dr.  
Santa Fe, NM 87505

For drilling and production facilities, submit to  
appropriate NMOCD District Office.  
For downstream facilities, submit to Santa Fe  
office

**Pit or Below-Grade Tank Registration or Closure**

Is pit or below-grade tank covered by a "general plan"? Yes ☒ No ☐

Type of action Registration of a pit or below-grade tank ☐ Closure of a pit or below-grade tank ☒

Operator <u>XTO Energy Inc.</u> Telephone <u>505-333-3100</u> e-mail address <u>kim_champlin@xtoenergy.com</u>	
Address <u>#382 County Road 3100, Aztec, NM 87410</u>	
Facility or well name <u>Apache Federal #16</u>	API # <u>30-039-29678</u> U/L or Qtr/Qtr _____ Sec <u>7J</u> T <u>24N</u> R <u>5W</u>
County <u>Rio Arriba</u>	Latitude <u>36.32444N</u> Longitude <u>107 39694W</u> NAD: 1927 <input checked="" type="checkbox"/> 1983 <input type="checkbox"/>
Surface Owner Federal <input type="checkbox"/> State <input type="checkbox"/> Private <input type="checkbox"/> Indian <input checked="" type="checkbox"/>	
RCVD NOV 7 '07	
<b>Pit</b> Type Drilling <input checked="" type="checkbox"/> Production <input type="checkbox"/> Disposal <input type="checkbox"/> Workover <input type="checkbox"/> Emergency <input type="checkbox"/> Lined <input checked="" type="checkbox"/> Unlined <input type="checkbox"/> Liner type Synthetic <input type="checkbox"/> Thickness <u>12</u> mil Clay <input type="checkbox"/> Pit Volume _____ bbl	<b>Below-grade tank</b> Volume _____ bbl Type of fluid _____ Construction material: _____ Double-walled, with leak detection? Yes <input type="checkbox"/> If not, explain why not _____
OIL CONS. DIV. DIST. 3	
Depth to ground water (vertical distance from bottom of pit to seasonal high water elevation of ground water )	Less than 50 feet (20 points) 50 feet or more, but less than 100 feet (10 points) 100 feet or more (0 points) <b>0 Points</b>
Wellhead protection area (Less than 200 feet from a private domestic water source, or less than 1000 feet from all other water sources )	Yes (20 points) No (0 points) <b>0 Points</b>
Distance to surface water (horizontal distance to all wetlands, playas, irrigation canals, ditches, and perennial and ephemeral watercourses )	Less than 200 feet (20 points) 200 feet or more, but less than 1000 feet (10 points) 1000 feet or more (0 points) <b>0 Points</b>
<b>Ranking Score (Total Points)</b> <b>0 Points</b>	

**If this is a pit closure:** (1) Attach a diagram of the facility showing the pit's relationship to other equipment and tanks (2) Indicate disposal location (check the onsite box if you are burying in place) onsite ☒ offsite ☐ If offsite, name of facility \_\_\_\_\_ (3) Attach a general description of remedial action taken including remediation start date and end date. (4) Groundwater encountered No ☒ Yes ☐ If yes, show depth below ground surface \_\_\_\_\_ ft and attach sample results (5) Attach soil sample results and a diagram of sample locations and excavations

Additional Comments:
The drilling reserve pit associated with the subject well was closed per NMOCD and BLM guidelines and in accordance with XTO's drilling pit closure plan.

I hereby certify that the information above is true and complete to the best of my knowledge and belief. I further certify that the above-described pit or below-grade tank has been/will be constructed or closed according to NMOCD guidelines ☐, a general permit ☐, or an (attached) alternative OCD-approved plan ☐.

Date 10/31/2007

Printed Name/Title Kim Champlin/Environmental Assistant

Signature

*Kim Champlin*

Your certification and NMOCD approval of this application/closure does not relieve the operator of liability should the contents of the pit or tank contaminate ground water or otherwise endanger public health or the environment. Nor does it relieve the operator of its responsibility for compliance with any other federal, state, or local laws and/or regulations.

Approval  
Printed Name/Title Deputy Oil & Gas Inspector,  
District #3

Signature

*[Signature]*

Date

**NOV 29 2007**

XTO ENERGY INC.  
 APACHE FEDERAL No. 16; 1585 FSL 1435 FEL  
 SECTION 7, T24N, R5W, N.M.P.M., RIO ARRIBA COUNTY, N. M.  
 GROUND ELEVATION: 6478, DATE: JULY 22, 2004

LAT: 36°19'28" N.  
 LONG: 107°23'49" W.  
 NAD 27.

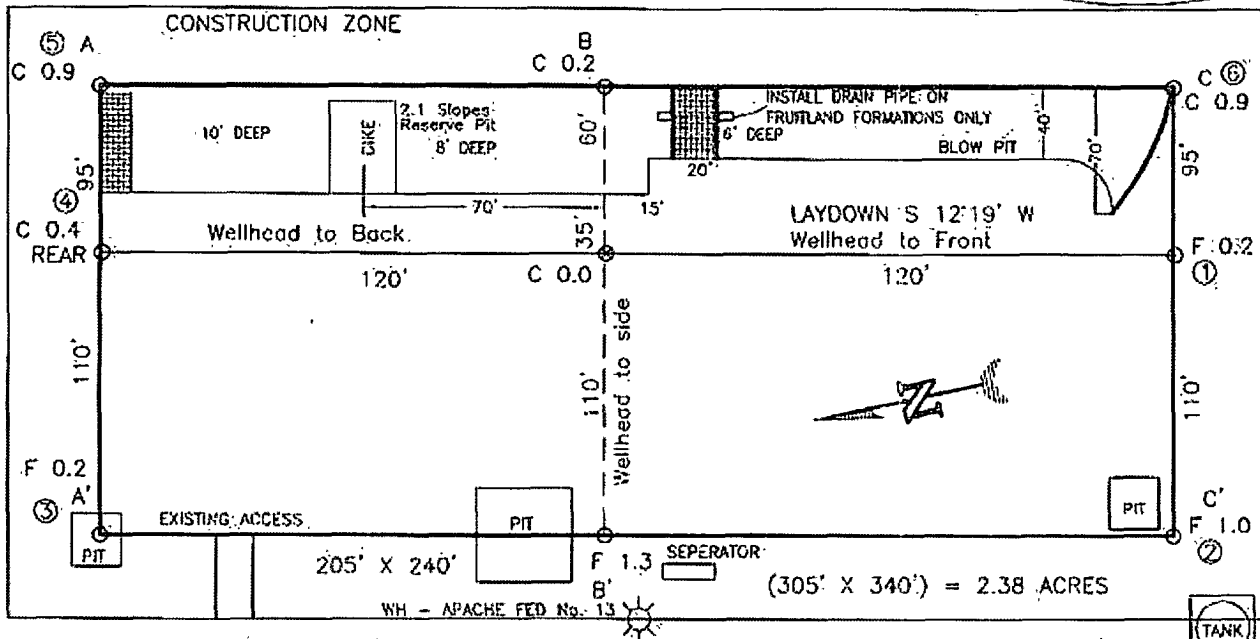

RESERVE PIT DIKE: TO BE 8' ABOVE DEEP SIDE (OVERFLOW - 3' WIDE AND 1' ABOVE SHALLOW SIDE).  
 BLOW PIT: OVERFLOW PIPE HALFWAY BETWEEN TOP AND BOTTOM AND TO EXTEND OVER PLASTIC LINER AND INTO BLOW PIT.

NOTE: DAGGETT ENTERPRISES, INC. IS NOT LIABLE FOR UNDERGROUND UTILITIES OR PIPELINES. NEW MEXICO ONE CALL TO BE NOTIFIED 48 HOURS PRIOR TO EXCAVATION OR CONSTRUCTION.

ELEV. A-A'

C/L

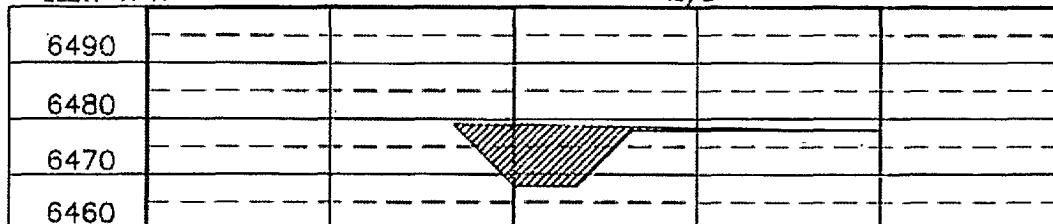

ELEV. B-B'

C/L

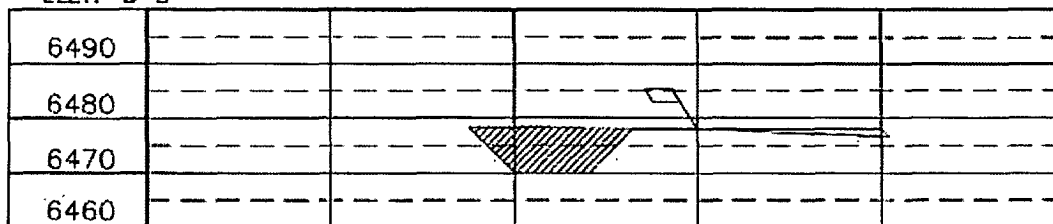

ELEV. C-C'

C/L

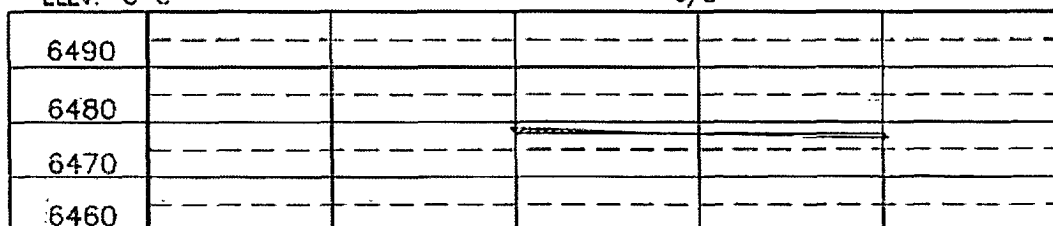

NOTE: CONTRACTOR SHOULD CALL ONE-CALL FOR LOCATION OF ANY MARKED OR UNMARKED BURIED PIPELINES OR CABLES ON WELL PAD AND/OR ACCESS ROAD AT LEAST TWO (2) WORKING DAYS PRIOR TO CONSTRUCTION.

Daggett Enterprises, Inc.

Surveying and Oil Field Services  
 P. O. Box 15068 • Farmington, NM 87401  
 Phone (505) 326-1772 • Fax (505) 326-6019  
 NEW MEXICO L.S. No. 14831



DATE: 07/26/04  
 DRAWN BY: A.C.  
 REVISION: CR349