

District I
1625 N French Dr, Hobbs, NM 88240
District II
1301 W Grand Avenue, Artesia, NM 88210
District III
1000 Rio Brazos Road, Aztec, NM 87410
District IV
1220 S St Francis Dr, Santa Fe, NM 87505

State of New Mexico
Energy Minerals and Natural Resources

Form C-144
June 1, 2004

Oil Conservation Division
1220 South St. Francis Dr.
Santa Fe, NM 87505

For drilling and production facilities, submit to
appropriate NMOCD District Office.
For downstream facilities, submit to Santa Fe
office

Pit or Below-Grade Tank Registration or Closure

Is pit or below-grade tank covered by a "general plan"? Yes ☐ No ☐

Type of action Registration of a pit or below-grade tank ☐ Closure of a pit or below-grade tank ☒

Operator <u>Koch Exploration Company, LLC</u> Telephone: <u>(505) 334-9111</u> e-mail address <u>clark23j@kochind.com or johnso4d@kochind.com</u>																																
Address <u>PO Box 489, Aztec, NM 87410</u>																																
Facility or well name: <u>Nordhaus 717S</u> API # <u>30-045-32629</u> U/L or Qtr/Qtr <u>F</u> Sec <u>13</u> T <u>31N</u> R <u>9W</u>																																
County: <u>San Juan</u> Latitude <u>36 53 597</u> Longitude <u>107 44 103</u> NAD: 1927 <input type="checkbox"/> 1983 <input type="checkbox"/>																																
Surface Owner Federal <input checked="" type="checkbox"/> State <input type="checkbox"/> Private <input type="checkbox"/> Indian <input type="checkbox"/>																																
Pit Type Drilling <input checked="" type="checkbox"/> Production <input type="checkbox"/> Disposal <input type="checkbox"/> Workover <input type="checkbox"/> Emergency <input type="checkbox"/> Lined <input checked="" type="checkbox"/> Unlined <input type="checkbox"/> Liner type Synthetic <input checked="" type="checkbox"/> Thickness <u>12</u> mil Clay <input type="checkbox"/> Pit Volume _____ bbl	Below-grade tank Volume _____ bbl Type of fluid: _____ Construction material: _____ Double-walled, with leak detection? Yes <input type="checkbox"/> If not, explain why not _____ <table border="1"><tr><td rowspan="3">Depth to ground water (vertical distance from bottom of pit to seasonal high water elevation of ground water)</td><td>X Less than 50 feet</td><td>(20 points)</td><td>20 points</td></tr><tr><td>50 feet or more, but less than 100 feet</td><td>(10 points)</td><td></td></tr><tr><td>100 feet or more</td><td>(0 points)</td><td></td></tr><tr><td rowspan="2">Wellhead protection area (Less than 200 feet from a private domestic water source, or less than 1000 feet from all other water sources)</td><td>Yes</td><td>(20 points)</td><td></td></tr><tr><td>X No</td><td>(0 points)</td><td>0 points</td></tr><tr><td rowspan="3">Distance to surface water (horizontal distance to all wetlands, playas, irrigation canals, ditches, and perennial and ephemeral watercourses)</td><td>Less than 200 feet</td><td>(20 points)</td><td></td></tr><tr><td>200 feet or more, but less than 1000 feet</td><td>(10 points)</td><td></td></tr><tr><td>X 1000 feet or more</td><td>(0 points)</td><td>0 points</td></tr><tr><td colspan="2">Ranking Score (Total Points)</td><td colspan="2">20 points</td></tr></table>	Depth to ground water (vertical distance from bottom of pit to seasonal high water elevation of ground water)	X Less than 50 feet	(20 points)	20 points	50 feet or more, but less than 100 feet	(10 points)		100 feet or more	(0 points)		Wellhead protection area (Less than 200 feet from a private domestic water source, or less than 1000 feet from all other water sources)	Yes	(20 points)		X No	(0 points)	0 points	Distance to surface water (horizontal distance to all wetlands, playas, irrigation canals, ditches, and perennial and ephemeral watercourses)	Less than 200 feet	(20 points)		200 feet or more, but less than 1000 feet	(10 points)		X 1000 feet or more	(0 points)	0 points	Ranking Score (Total Points)		20 points	
Depth to ground water (vertical distance from bottom of pit to seasonal high water elevation of ground water)	X Less than 50 feet		(20 points)	20 points																												
	50 feet or more, but less than 100 feet		(10 points)																													
	100 feet or more	(0 points)																														
Wellhead protection area (Less than 200 feet from a private domestic water source, or less than 1000 feet from all other water sources)	Yes	(20 points)																														
	X No	(0 points)	0 points																													
Distance to surface water (horizontal distance to all wetlands, playas, irrigation canals, ditches, and perennial and ephemeral watercourses)	Less than 200 feet	(20 points)																														
	200 feet or more, but less than 1000 feet	(10 points)																														
	X 1000 feet or more	(0 points)	0 points																													
Ranking Score (Total Points)		20 points																														

RCUD OCT 19 '07
OIL CONS. DIV.
DIST. 3

If this is a pit closure: (1) Attach a diagram of the facility showing the pit's relationship to other equipment and tanks (2) Indicate disposal location (check the onsite box if you are burying in place) onsite ☒ offsite ☐ If offsite, name of facility _____. (3) Attach a general description of remedial action taken including remediation start date and end date (4) Groundwater encountered No ☒ Yes ☐ If yes, show depth below ground surface _____ ft. and attach sample results (5) Attach soil sample results and a diagram of sample locations and excavations.

Additional Comments.	CLOSURE

I hereby certify that the information above is true and complete to the best of my knowledge and belief. I further certify that the above-described pit or below-grade tank has been/will be constructed or closed according to NMOCD guidelines ☐, a general permit ☒, or an (attached) alternative OCD-approved plan ☐.

Date 10/15/07

Printed Name/Title John Clark, District Superintendent Signature 

Your certification and NMOCD approval of this application/closure does not relieve the operator of liability should the contents of the pit or tank contaminate ground water or otherwise endanger public health or the environment Nor does it relieve the operator of its responsibility for compliance with any other federal, state, or local laws and/or regulations.

Approval.

Deputy Oil & Gas Inspector,
District #3

Printed Name/Title _____

Signature 

Date: NOV 29 2007

KOCH EXPLORATION COMPANY LLC
Nordhaus 717S
S13, T31N, R9W
1885' FNL & 1375' FWL - ELEVATION 6452'

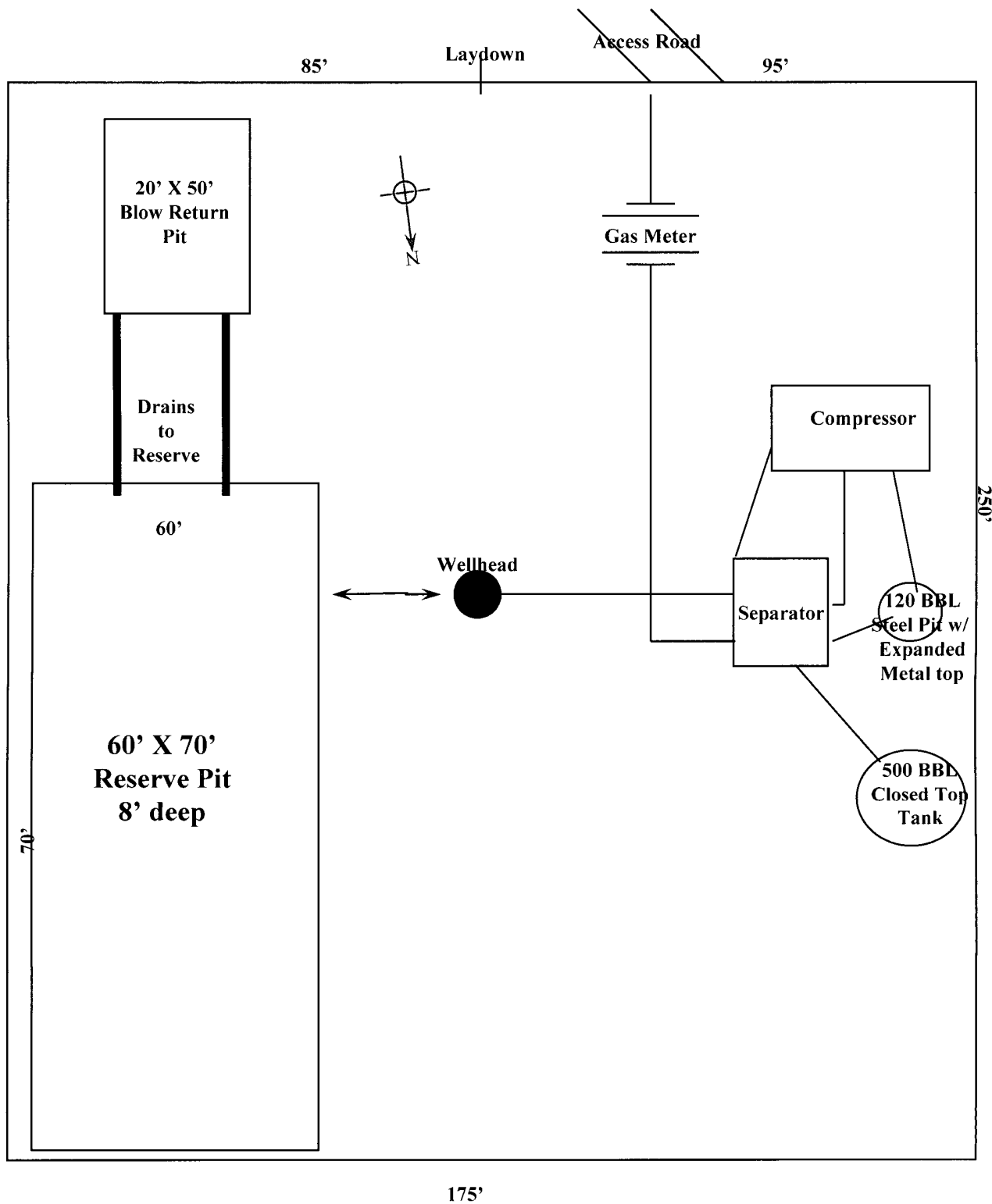

Nordhaus 717S

S13, T31N, R09W, 1885' FNL & 1375' FWL

San Juan Co., New Mexico

API No. 30-045-32629 Lease SF078508

Upon completion of drilling/completion remaining liquids were removed from pit by truck to an approved disposal facility.

Prior to closing the pit, liner was cut off at mud level. The excess liner was hauled to a licensed disposal.

August 20 through August 22, 2007 the remaining waste in pit was encapsulated. This was accomplished by covering the remaining waste and liner with earthen materials. Surface area where pit was located was contoured according to BLM requirements, and reseeded on September 24, 2007 with recommended BLM seed mixture.