

UNITED STATES
DEPARTMENT OF THE INTERIOR
BUREAU OF LAND MANAGEMENT

RCVD APR 17 '08

OIL CONS. DIV.

DIST. 3

APPLICATION FOR PERMIT TO DRILL, DEEPEN, OR PLUG BACK

1a. Type of Work DRILL	RECEIVED SEP 19 2007 Bureau of Land Management Farmington Field Office	5. Lease Number SF-078995
1b. Type of Well GAS		6. If Indian, All. or Tribe Unit Reporting Number NMNM-784213-DK NMNM-78421A-MV
2. Operator ConocoPhillips	7. Unit Agreement Name San Juan 31-6 Unit	
3. Address & Phone No. of Operator PO Box 4289, Farmington, NM 87499 (505) 326-9700	8. Farm or Lease Name	
4. Location of Well Surf: Unit E (SWNW), 1820' FNL & 65' FWL, BH: Unit H (SENE), 2200' FNL & 760' FEL, Surf: Latitude 36° 52.3667 N Longitude 107° 27.4983 W BH: Latitude 36° 52.1598 N Longitude 107° 27.7038 W	9. Well Number #39M	
10. Field, Pool, Wildcat Blanco MV/Basin DK	11. Sec., Twn, Rge, Mer. (NMPM) Surf: Sec. 27, T31N, R6W BH: Sec. 28, T31N, R6W API # 30-039-30364	
14. Distance in Miles from Nearest Town 50 miles/Blanco	12. County Rio Arriba	13. State NM
15. Distance from Proposed Location to Nearest Property or Lease Line 65'	17. Acres Assigned to Well MV/DK 320 E/2 Sec. 28	
16. Acres in Lease 1920	20. Rotary or Cable Tools Rotary	
18. Distance from Proposed Location to Nearest Well, Drlg, Compl, or Applied for on this Lease 435' from San Juan 31-6 231A	22. Approx. Date Work will Start BLM'S APPROVAL OR ACCEPTANCE OF THIS ACTION DOES NOT RELIEVE THE LESSEE AND OPERATOR FROM OBTAINING ANY OTHER AUTHORIZATION REQUIRED FOR OPERATIONS ON FEDERAL AND INDIAN LANDS	
19. Proposed Depth 7915' TVD/8066' TMD	24. Authorized by: Rhonda Rogers (Regulatory Technician) Date 9-19-07	

PERMIT NO.

APPROVAL DATE

APPROVED BY

TITLE

DATE

Archaeological Report attached

Threatened and Endangered Species Report attached

NOTE: This format is issued in lieu of U.S. BLM Form 3160-3

Title 18 U.S.C. Section 1001, makes it a crime for any person knowingly and willfully to make to any department or agency of the United States any false, fictitious or fraudulent statements or presentations as to any matter within its jurisdiction.

Example Master Plan Type 3

Bond Numbers ES-0048 and ES-0085

Hold C104

for Directional Survey

and "As Drilled" plat

DRILLING OPERATIONS AUTHORIZED ARE
SUBJECT TO COMPLIANCE WITH ATTACHED
"GENERAL REQUIREMENTS".

NMOC

APR 18 2008

This action is subject to technical and
procedural review pursuant to 43 CFR 3165.3
and appeal pursuant to 43 CFR 3165.4

DISTRICT 1
1625 N. French Dr., Hobbs, N.M. 88240

State of New Mexico
Energy, Minerals & Natural Resources Department

Form C-102
Revised October 12, 2005

DISTRICT II
1301 West Grand Avenue, Artesia, N.M. 88210

OIL CONSERVATION DIVISION
1220 South St. Francis Dr.
Santa Fe, NM 87505

RECEIVED
55
100-20027

DISTRICT III
1000 Rio Brazos Rd., Aztec, N.M. 87410

SEP 19 2007

DISTRICT IV
1220 S. St. Francis Dr., Santa Fe, NM 87505

Bureau of Land Management
Farmington Field Office

☐ AMENDED REPORT

WELL LOCATION AND ACREAGE DEDICATION PLAT

*API Number 30-039- 30364	*Pool Code 72319/71599	*Pool Name Blanco-Mesaverde / Basin Dakota
*Property Code 31328	*Property Name SAN JUAN 31-6 UNIT	*Well Number 39M
*OGRD No. 217817	*Operator Name CONOCOPHILLIPS COMPANY	*Elevation 6328'

¹⁰ Surface Location

UL or lot no.	Section	Township	Range	Lot Ida	Feet from the	North/South line	Feet from the	East/West line	County
E	27	31-N	6-W		1820'	NORTH	65'	WEST	RIO ARriba

11 Bottom Hole Location If Different From Surface

UL or lot no.	Section	Township	Range	Lot Idn	Feet from the	North/South line	Feet from the	East/West line	County
H	28	31-N	6-W		2200'	NORTH	760'	EAST	RIO ARriba

13 Dedicated Acres 320 acres E/2	14 Joint or Infill	15 Consolidation Code	16 Order No.
-------------------------------------	--------------------	-----------------------	--------------

NO ALLOWABLE WILL BE ASSIGNED TO THIS COMPLETION UNTIL ALL INTERESTS HAVE BEEN CONSOLIDATED
OR A NON-STANDARD UNIT HAS BEEN APPROVED BY THE DIVISION

18

N 89° 57' E
2638.02'

N 89° 40' E
2628.78'

LAT: 36°52.3039' N.
LONG: 107°27.6672' W.
NAD 1927

LAT: 36.871735° N.
LONG: 107.461725° W.
NAD 1983
Bottom Hole

2200'

760'

Bottom Hole

1820'

N 10° 02' E - 2840.00'

Surface
65'

28

SF-078995

27

LAT: 36°52.3667' N.
LONG: 107°27.4983' W.
NAD 1927

LAT: 36.872784° N.
LONG: 107.458905° W
NAD 1983
Surface

SECTION LINE

OPERATOR CERTIFICATION

I hereby certify that the information contained herein is true and complete to the best of my knowledge and belief, and that this organization either owns a working interest or unleased mineral interest in the land underlying the proposed bottom hole location or has a right to drill this well at this location pursuant to a contract with an owner of such a mineral or a working interest, or to a voluntary pooling agreement or a compulsory pooling order heretofore entered by the division.

Lucy V. Moore

Signature

Tracey N. Monroe/Regulatory

Printed Name Assistant

18 SURVEYOR CERTIFICATION

I hereby certify that the well location shown on this plat was plotted from field notes of actual surveys made by me or under my supervision, and that the same is true and correct to the best of my belief.

Date of Survey _____

Signature and Seal of International Supervisor.

Certificate Number

15703

District I

1625 N. French Dr., Hobbs, NM 88240

District II

1301 W. Grand Ave., Artesia, NM 88210

District III

1000 Rio Brazos Rd., Aztec, NM 87410

District IV

1220 S. St. Francis Dr., Santa Fe, NM 87505

Energy, Minerals and Natural Resources

OIL CONSERVATION DIVISION

1220 South St. Francis Dr.
Santa Fe, NM 87505

WELL API NO.

30-039- 303604

5. Indicate Type of Lease

STATE ☐FEE ☐

6. State Oil & Gas Lease No.

Federal Lease SF-078995

7. Lease Name or Unit Agreement Name

San Juan 31-6 Unit

8. Well Number

#39M

9. OGRID Number

217817

10. Pool name or Wildcat

Blanco MV/Basin DK

SUNDRY NOTICES AND REPORTS ON WELLS
(DO NOT USE THIS FORM FOR PROPOSALS TO DRILL OR TO DEEPEN OR PLUG BACK TO A DIFFERENT RESERVOIR. USE "APPLICATION FOR PERMIT" (FORM C-101) FOR SUCH PROPOSALS.)

1. Type of Well:

Oil Well ☐Gas Well ☒

Other

2. Name of Operator

ConocoPhillips

3. Address of Operator

3401 E. 30TH STREET, FARMINGTON, NM 87402

4. Well Location

Unit Letter E

:

1820'

feet from the

North

line and

65'

feet from the

West

line

Section 27

Township 31N

Rng 6W

NMPM

County

Rio Arriba

11. Elevation (Show whether DR, RKB, RT, GR, etc.)

6328'

Pit or Below-grade Tank Application

☐ or Closure ☐

Pit type New Drill

Depth to Groundwater

>100

Distance from nearest fresh water well

>1000'

Distance from nearest surface water

<1000

Pit Liner Thickness:

12

mil

Below-Grade Tank:

Volume

bbls;

Construction Material

12. Check Appropriate Box to Indicate Nature of Notice, Report or Other Data

NOTICE OF INTENTION TO:

PERFORM REMEDIAL WORK ☐PLUG AND ABANDON ☐TEMPORARILY ABANDON ☐CHANGE PLANS ☐PULL OR ALTER CASING ☐MULTIPLE COMPL ☐

OTHER:

New Drill

☒

SUBSEQUENT REPORT OF:

REMEDIAL WORK ☐ALTERING CASING ☐COMMENCE DRILLING OPNS. ☐P AND A ☐CASING/CEMENT JOB ☐OTHER: ☐

13. Describe proposed or completed operations. (Clearly state all pertinent details, and give pertinent dates, including estimated date of starting any proposed work). SEE RULE 1103. For Multiple Completions: Attach wellbore diagram of proposed completion or recompletion.

New Drill, lined:

ConocoPhillips proposes to construct a new drilling pit, an associated vent/flare pit and a pre-set mud pit (if required). Based on ConocoPhillips' interpretation of the Ecosphere's risk ranking criteria, the new drilling pit and pre-set mud pit will be unlined pits as detailed in ConocoPhillips' General Plan dated June 2005 on file at the NMOCD office. A portion of the vent/flare pit will be designed to manage fluids and that portion will be unlined as per the risk ranking criteria. ConocoPhillips anticipates closing these pits according to the November 1, 2004 Guidelines.

I hereby certify that the information above is true and complete to the best of my knowledge and belief. I further certify that any pit or below-grade tank has been/will be constructed or closed according to NMOCD guidelines ☐, a general permit ☒ or an (attached) alternative OCD-approved plan ☐.

SIGNATURE

TITLE

Regulatory Technician

DATE

9-19-07

Type or print name

Rhonda Rogers

E-mail address:

rogers@conocophillips.com

Telephone No.

505-599-4018

For State Use Only

APPROVED BY

TITLE

Deputy Oil & Gas Inspector,
District #3

DATE

APR 18 2008

Conditions of Approval (if any):

PROJECT PROPOSAL - New Drill / Sidetrack

San Juan Business Unit

SAN JUAN 31-6 UNIT 39M

DEVELOPMENT

Lease:		AFE #: WAN.CNV.7205				AFE \$:	
Field Name: 31-6		Rig: XXX 2009 Directional		State: NM	County: RIO ARRIBA		API #:
Geologist:		Phone:		Geophysicist:		Phone:	
Geoscientist: Glaser, Terry J		Phone: (832)486-2332		Prod. Engineer:		Phone:	
Res. Engineer: Pena, David Fernando		Phone: 832-486-2328		Proj. Field Lead: Fransen, Eric E.		Phone:	
Primary Objective (Zones):							
Zone	Zone Name						
R20002	MESAVERDE(R20002)						
R20076	DAKOTA(R20076)						
Location: Surface Datum Code: NAD 27 Deviated							
Latitude: 36.872778	Longitude: -107.458305	X:	Y:	Section: 27		Range: 006W	
Footage X: 65 FWL	Footage Y: 1820 FNL	Elevation: 6328	(FT)	Township: 031N			
Tolerance:							
Location: Bottom Hole Datum Code: NAD 27 Deviated							
Latitude: 36.871729	Longitude: -107.461121	X: 0.00	Y: 0.00	Section: 28		Range: 006W	
Footage X: 760 FEL	Footage Y: 2200 FSL	Elevation:	(FT)	Township: 031N			
Tolerance:							
Location Type: Restricted		Start Date (Est.): 1/1/2009		Completion Date:		Date In Operation:	
Formation Data: Assume KB = 6344 Units = FT							
Formation Call & Casing Points	Depth (TVD in Ft)	SS (Ft)	Depletion (Yes/No)	BHP (PSIG)	BHT	Remarks	
SURFACE CSG	213	6131	<input type="checkbox"/>			12-1/4" hole. 9 5/8" 32.3 ppf, H-40, STC casing. Cement with 170 cu. ft. Circulate cement to surface.	
OJAM	2343	4001	<input type="checkbox"/>			Possible water flows.	
KRLD	2443	3901	<input type="checkbox"/>				
FRLD	2910	3434	<input type="checkbox"/>			Possible gas.	
PCCF	3197	3147	<input type="checkbox"/>				
LEWS	3492	2852	<input type="checkbox"/>				
Intermediate Casing	3592	2752	<input type="checkbox"/>			8 3/4" Hole. 7", 23.0 ppf, L-80 ST&C casing. Cement with 843 cu. ft. Circulate cement to surface.	
CHRA	4495	1849	<input type="checkbox"/>				
CLFH	5322	1022	<input type="checkbox"/>			Gas; possibly wet	
MENF	5358	986	<input type="checkbox"/>			Gas.	
PTLK	5617	727	<input type="checkbox"/>	400		Gas.	
MNCS	5833	511	<input type="checkbox"/>				
GLLP	6916	-572	<input type="checkbox"/>			Gas. Possibly wet.	
GRHN	7648	-1304	<input type="checkbox"/>	2100		Gas possible, highly fractured	
GRRS	7696	-1352	<input type="checkbox"/>				
TWLS	7807	-1463	<input type="checkbox"/>			Gas	
PAGU	7811	-1467	<input type="checkbox"/>			Gas. Highly Fractured.	
CBBO	7818	-1474	<input type="checkbox"/>			Gas	
CBRL	7864	-1520	<input type="checkbox"/>				
TD	7915	-1571	<input type="checkbox"/>				

PROJECT PROPOSAL - New Drill / Sidetrack

San Juan Business Unit

SAN JUAN 31-6 UNIT 39M

DEVELOPMENT

TOTAL DEPTH DK	7915	-1571	<input type="checkbox"/>	6-1/4" hole. 4-1/2", 11.6#, L-80, LT&C casing. Cement with 588 cu. ft. Circulate cement a minimum of 100 ft. inside the previous casing string. No open hole logs. Cased hole TDT with GR to surface.
----------------	------	-------	--------------------------	---

Reference Wells:		
Reference Type	Well Name	Comments
Intermediate	San Juan 31-6 39	28-31N-6W-NE, KB = 6488

Logging Program:	
Intermediate Logs:	<input type="checkbox"/> Log only if show <input type="checkbox"/> GR/ILD <input type="checkbox"/> Triple Combo

TD Logs:	<input type="checkbox"/> Triple Combo <input type="checkbox"/> Dipmeter <input type="checkbox"/> RFT <input type="checkbox"/> Sonic <input type="checkbox"/> VSP <input type="checkbox"/> TDT <input checked="" type="checkbox"/> Other
CBL/GR	

Additional Information:					
Log Type	Stage	From (Ft)	To (Ft)	Tool Type/Name	Remarks

Comments: Location/Tops/Logging - MVNM031N006W28SE2 AND DK 31N06W28SE2

Zones - MVNM031N006W28SE2 AND DK 31N06W28SE2

General/Work Description - MV80/DK80 directional well

ConocoPhillips or its affiliates

Planning Report

Database:	EDM Central Planning	Local Co-ordinate Reference:	Well: SJ 31-6 #39M
Company:	ConocoPhillips Lower 48	TVD Reference:	Generic Rig KB @ 6343.0ft (Generic Rig)
Project:	San Juan Basin	MD Reference:	Generic Rig KB @ 6343.0ft (Generic Rig)
Site:	Russell's Site for Directional MV/DK wells	North Reference:	True
Well:	SJ 31-6 #39M	Survey Calculation Method:	Minimum Curvature
Wellbore:	SJ 31-6 #39M		
Design:	Principal		

Formations						
Measured Depth (ft)	Vertical Depth (ft)	Name	Lithology	Dip (d)	Dip Direction (d)	
2,439.1	2,343.0	Ojo		0.00		
2,546.1	2,443.0	Kirtland		0.00		
3,045.6	2,910.0	Fruitland		0.00		
3,345.1	3,197.0	Pictured Cliffs		0.00		
3,642.9	3,492.0	Lewis		0.00		
4,646.0	4,495.0	Chacra		0.00		
5,473.0	5,322.0	Mass Cliffhouse		0.00		
5,509.0	5,358.0	Menefee		0.00		
5,768.0	5,617.0	Point Lookout		0.00		
5,984.0	5,833.0	Mancos		0.00		
7,067.0	6,916.0	Upper Gallup		0.00		
7,799.0	7,648.0	Greenhorn		0.00		
7,847.0	7,696.0	Graneros		0.00		
7,958.0	7,807.0	Two Wells		0.00		
7,962.0	7,811.0	Paguate		0.00		
7,969.0	7,818.0	Cubero		0.00		
8,015.0	7,864.0	Lower Cubero		0.00		
8,066.0	7,915.0	TD		0.00		

SAN JUAN 31-6 UNIT 39M, 1820' FNL & 65' FWL
SECTION 27, T-31-N, R-6-W, NMPM, RIO ARriba COUNTY, NM

GROUND ELEVATION: 6528', DATE: AUGUST 22, 2006

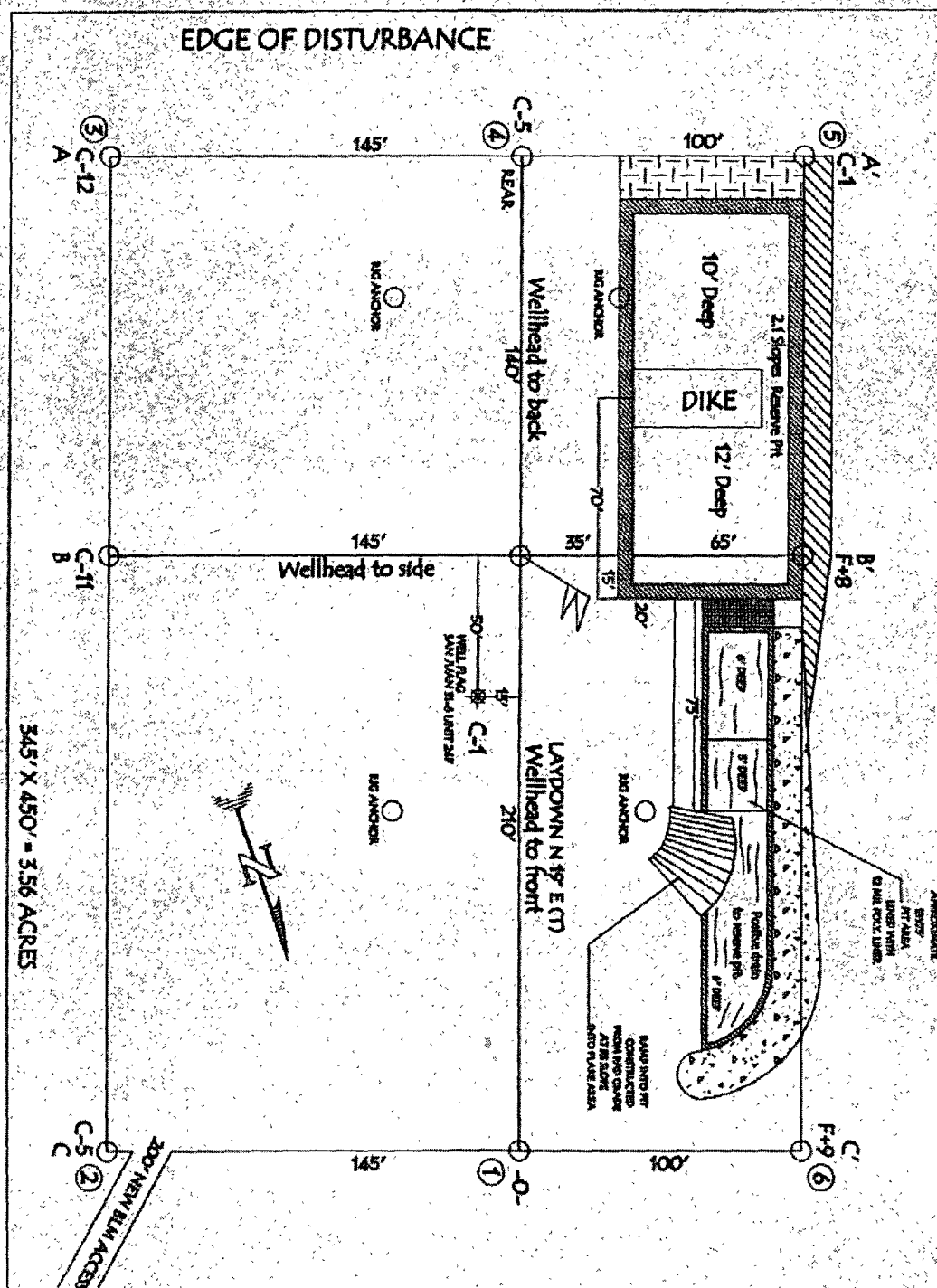

NOTE: VECTOR SURVEYS LLC IS NOT LIABLE FOR UNDERGROUND UTILITIES OR PIPELINES. CONTRACTOR SHOULD CALL ONE-CALL FOR LOCATION OF ANY MARKED OR UNMARKED BURIED PIPELINES OR CABLES ON WELL PAD AND OR ACCESS ROAD AT LEAST TWO (2) WORKING DAYS PRIOR TO CONSTRUCTION.

CONOCOPHILLIPS COMPANY

SAN JUAN 31-6 UNIT 39M, 1820' FNL & 65' FWL

SECTION 27, T-31-N, R-6-W, NMPM, RIO ARriba COUNTY, NM

GROUND ELEVATION: 6328', DATE: AUGUST 2, 2006

ELEV. A-A

CU

6345									
6335									
6325									
6315									

ELEV. B-B

CU

6345									
6335									
6325									
6315									

ELEV. C-C

CU

6345									
6335									
6325									
6315									

NOTE: VECTOR SURVEYS LLC IS NOT LIABLE FOR UNDERGROUND UTILITIES OR PIPELINES
CONTRACTOR SHOULD CALL ONE-CALL FOR LOCATION OF ANY MARKED OR UNMARKED BURIED
PIPILINES OR CABLES ON WELL PAD AND OR ACCESS ROAD AT LEAST TWO (2) WORKING DAYS PRIOR TO CONSTRUCTION.