

130-30-039-06831

198-30-039-20658

DATA SHEET FOR DEEP GROUND BED CATHODIC PROTECTION WELLS
NORTHWESTERN NEW MEXICO
(Submit 3 copies to OCD Aztec Office)

Operator Union Oil Company of California Location: Unit Sec. 32 Twp 27 Rng 6

Name of Well/Wells or Pipeline Serviced Rincon #130 DK/MV Rincon #198 PC

Elevation 6677' Completion Date 11-8-89 Total Depth 300' Land Type* S

Casing, Sizes, Types & Depths None

If Casing is cemented, show amounts & types used None

If Cement or Bentonite Plugs have been placed, show depths & amounts used
None

Depths & thickness of water zones with description of water when possible:

Fresh, Clear, Salty, Sulphur, Etc. Fresh 200' deep 30' thick MAY 14 1990

SEE ATTACHED SHEET

OIL CON. DIV. 1

DIST. 3

Depths gas encountered: NA

Type & amount of coke breeze used: Carbo 60 mettallurgical Coke 3700 lbs

Depths anodes placed: 205' to 235'

Depths vent pipes placed: 300'

Vent pipe perforations: 200' to 300'

Remarks: Unocal was the operator at the time this ground bed was installed.

First ground bed installed on this location.

If any of the above data is unavailable, please indicate so. Copies of all logs, including Drillers Log, Water Analyses & Well Bore Schematics should be submitted when available. Unplugged abandoned wells are to be included

*Land Type may be shown: F-Federal; I-Indian; S-State; P-Fee.
If Federal or Indian, add Lease Number.

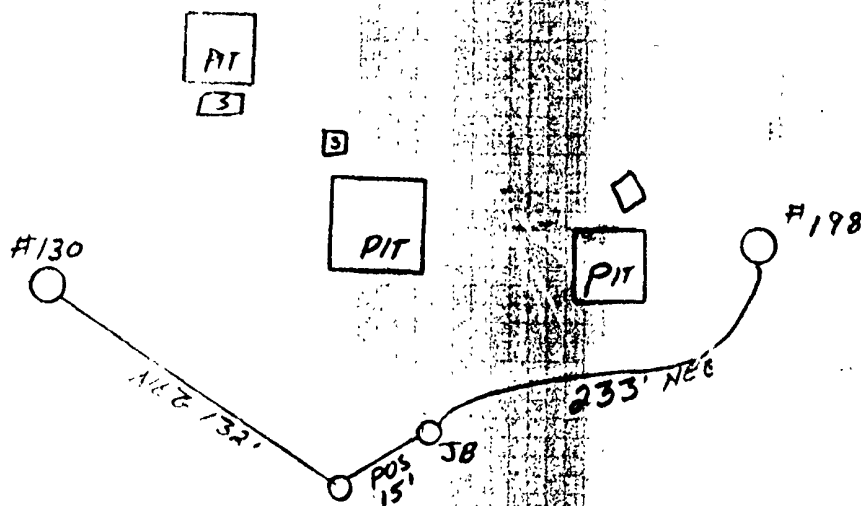
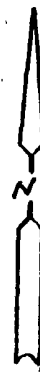

POS. 15'
NEG. 132' - WELL #130
NEG. 233' - WELL #198

CPS

Cathodic Protection Services

A LUKENS COMPANY

RINCON UNIT #198
" #130

DES. CF
DR. JK
SCALE NONE

CK
APP
DATE 12-11-89

DWG NO. REV.
00027-08

NO	REVISION	DATE

Catholic Protection Services Company
P. O. Box 388
Farmington, New Mexico 87499
1608 Schofield Lane
Farmington, New Mexico 87401
(505) 325-1946

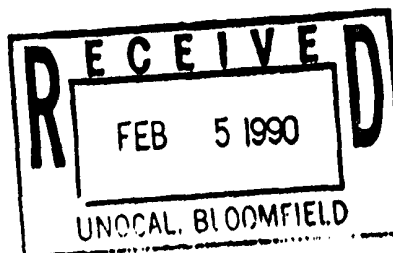

February 2, 1990

Unocal Corporation
3300 N. Butler, Suite 201
Farmington, NM 87401

Attention: Mr. Steve Gregory

Subject: Major Water Zones in Cathodic Protection Deep-Well Groundbeds

Dear Mr. Gregory:

Per your recent request for information concerning the cathodic protection deep-well groundbeds for your well casings in the San Juan Basin area, we are pleased to submit the following information.

Township & Range	Depths Ranging From Shallowest to Deepest	Average Depth	Average Thickness of Water Zone
T-25N - R-10W	110' - 140'	122.5'	20'
T-25N - R-11W	60' - 140'	93.3'	45'
T-26N - R-7W	80' - 150'	112.5'	30'
T-27N - R-7W	80' - 200'	123.3'	22.5'
T-27N - R-6W	80' - 200'	131.1'	30'

This data reflects information supplied by the drilling logs acquired at the time the wells were drilled. The depths shown are based on the type of sand which was being extruded from the drilled hole and the dampness of the sand.

The thickness of the water zones are determined by the change in the strata which was being drilled.

It has been a pleasure providing this information to your company. If you have any further questions or desire additional information, please do not hesitate to contact us.

Sincerely,

Catholic Protection Services Company

John Kerr, Corrosion Technician

cc: Mike Tabet

CPS
Catholic Protection Services
A LARSEN COMPANY