

14631

E

30-045-24367

DATA SHEET FOR DEEP GROUND BED CATHODIC PROTECTION WELLS
NORTHWESTERN NEW MEXICO
(Submit 3 copies to OCD Aztec Office)

Operator MERIDIAN OIL INC. Location: Unit F Sec. 18 Twp 31 Rng 8

Name of Well/Wells or Pipeline Serviced QUINN #5A

cps 6239w

Elevation N/A Completion Date 10/25/86 Total Depth 500' Land Type* N/A

Casing, Sizes, Types & Depths N/A

If Casing is cemented, show amounts & types used N/A

If Cement or Bentonite Plugs have been placed, show depths & amounts used
N/A

Depths & thickness of water zones with description of water when possible:
Fresh, Clear, Salty, Sulphur, Etc. 220' & 260'

Depths gas encountered: N/A

Type & amount of coke breeze used: 2500 lbs.

Depths anodes placed: 450', 390', 380', 370', 360', 350', 330', 320', 310', 300'

Depths vent pipes placed: 470'

Vent pipe perforations: 180'

Remarks: gb #1

RECEIVED
MAY 31 1987
OIL CON. DIV.
DIST. 3

If any of the above data is unavailable, please indicate so. Copies of all logs, including Drillers Log, Water Analyses & Well Bore Schematics should be submitted when available. Unplugged abandoned wells are to be included.

*Land Type may be shown: F-Federal; I-Indian; S-State; P-Fee.
If Federal or Indian, add Lease Number.

BURGE CORROSION SYSTEMS, INC.

P.O. BOX 1359 - PHONE 334-6141
AZTEC, NEW MEXICO 87410

Drilling Log (Attach Hereto)

W 739W

Completion Date October 25, 1986

Well Name Quinn #5-A		Location Union Texas Petroleum							
Type & Size Bit Used 6 3/4 inch		Work Order No.							
Anode Hole Depth 500 feet	Total Drilling Rig Time 6 hours	Total Lbs. Coke Used 2500 #		Lost Circulation Mat'l Used		No. Sacks Mud Used			
Anode Depth									
#1 450	#2 390	#3 380	#4 370	#5 360	#6 350	#7 330	#8 320	#9 310	#10 300
Anode Output (Amps)									
#1 2.8	#2 2.0	#3 2.7	#4 1.9	#5 3.6	#6 3.4	#7 2.2	#8 3.6	#9 2.9	#10 2.8
Anode Depth									
#11	#12	#13	#14	#15	#16	#17	#18	#19	#20
Anode Output (Amps)									
#11	#12	#13	#14	#15	#16	#17	#18	#19	#20
Total Circuit Resistance Volts 11.9	Amps 15.3	Ohms .78		No. 8 C.P. Cable Used 3750 feet		No. 2 C.P. Cable Used			

Remarks: Hole was not making enough water to fill hole and had to be filled in order to log. Used 470 feet of 1 inch vent pipe with 180 feet of perforations.

All Construction Completed

Coody Munbrun
(Signature)

GROUND BED LAYOUT SKETCH

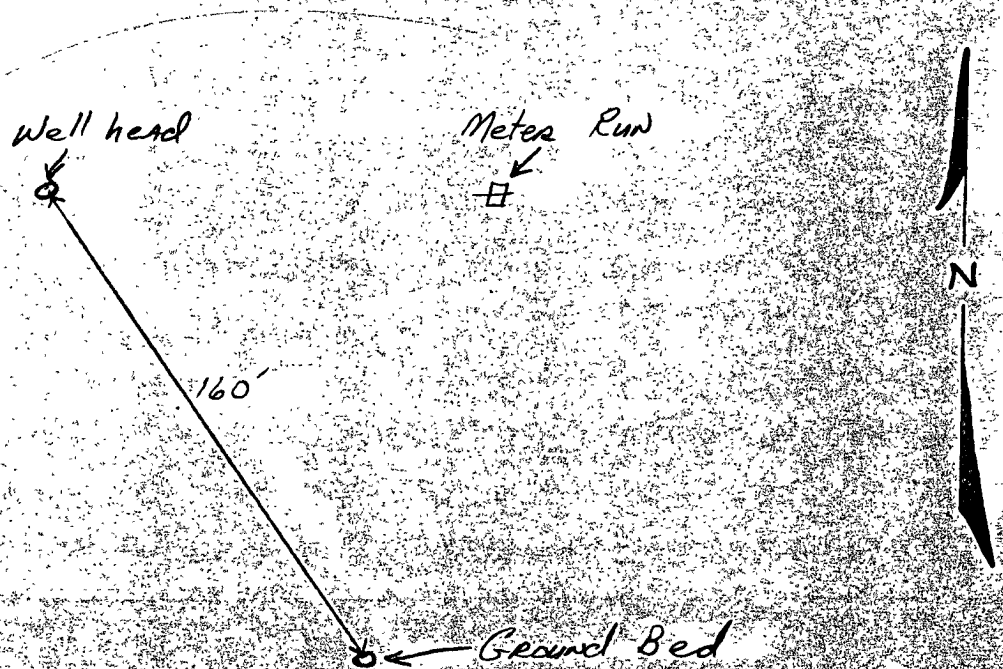

CORROSION CONTROL CO.

301 Ash

Artec, New Mexico

COMPANY UNOIN TEXAS PETROLEUM

DAILY DRILLING REPORT

OCT. 24

19 86

WELL NAME: QUINN 5-A	WELL NUMBER: 5-A	SECTION: 18	TOWNSHIP: 31	RANGE: 8
WATER AT Moisture 220 and 260'		FEET	HOLE MADE: 500'	

DESCRIPTION OF FORMATION

FROM	TO	FORMATION IS	COLOR
0	100	sandstone- bentonite	yell/white
100	120	blue sand	blue
120	160	sandstone	yellow
160	170	shale	blue
170	190	sandy shale	blue
190	220	shale	blue
220	240	sandstone	yellow
240	260	shale	blue
260	300	sandstone/ moisture	yellow
300	330	shale	blue
330	350	sandstone	yellow
350	370	shale	blue
370	400	sandy shale-sand } bentonite	blu/white
400	460	sandy bentonite-shale streamers	blu/white
460	500	sandy bentonite	white

REMARKS: Went to injection at 360' due to powder.

Brian E. Burge

Driller

Tool Dresser