

District I
1625 N. French Dr , Hobbs, NM 88240
District II
1301 W. Grand Avenue, Artesia, NM 88210
District III
1000 Rio Brazos Road, Aztec, NM 87410
District IV
1220 S. St Francis Dr., Santa Fe, NM 87505

State of New Mexico
Energy Minerals and Natural Resources

Form C-144
June 1, 2004

Oil Conservation Division
1220 South St. Francis Dr.
Santa Fe, NM 87505

For drilling and production facilities, submit to appropriate NMOCD District Office.
For downstream facilities, submit to Santa Fe office

Pit or Below-Grade Tank Registration or Closure

Is pit or below-grade tank covered by a "general plan"? Yes ☒ No ☐

Type of action: Registration of a pit or below-grade tank ☐ Closure of a pit or below-grade tank ☒

Operator U. S. Enercorp, Ltd Telephone: (210) 829-4888 e-mail address Katy@usenercorp.com
Address P. O. Box 17098, San Antonio, TX 78217
Facility or well name: Almagre Arroyo 30 #1 API #: 30-039-30083 U/L or Qtr/Qtr NESW Sec 30 T 24 North R 1 East
County: Rio Arriba Latitude 36.281820° N Longitude 106.876966° W NAD: 1927 ☐ 1983 ☒
Surface Owner: Federal ☐ State ☐ Private ☒ Indian ☐

RCVD MAR 18 '08

OIL CONS. DIV.

DIST. 3

Pit
Type: Drilling ☒ Production ☐ Disposal ☐
Workover ☐ Emergency ☐
Lined ☒ Unlined ☐
Liner type Synthetic ☒ Thickness 12 mil Clay ☐
Pit Volume 26,715 bbl

Below-grade tank
Volume: _____ bbl Type of fluid: _____
Construction material: _____
Double-walled, with leak detection? Yes ☐ If not, explain why not.

Depth to ground water (vertical distance from bottom of pit to seasonal high water elevation of ground water.)

Less than 50 feet	(20 points)
50 feet or more, but less than 100 feet	(10 points)
<u>100 feet or more</u>	(0 points)

Wellhead protection area (Less than 200 feet from a private domestic water source, or less than 1000 feet from all other water sources.)

Yes	(20 points)
<u>No</u>	(0 points)

Distance to surface water: (horizontal distance to all wetlands, playas, irrigation canals, ditches, and perennial and ephemeral watercourses.)

<u>Less than 200 feet</u>	(20 points)
200 feet or more, but less than 1000 feet	(10 points)
1000 feet or more	(0 points)

Ranking Score (Total Points)

20

If this is a pit closure: (1) Attach a diagram of the facility showing the pit's relationship to other equipment and tanks. (2) Indicate disposal location: (check the onsite box if you are burying in place) onsite ☒ offsite ☐ If offsite, name of facility _____. (3) Attach a general description of remedial action taken including remediation start date and end date. (4) Groundwater encountered No ☒ Yes ☐ If yes, show depth below ground surface _____ ft. and attach sample results. (5) Attach soil sample results and a diagram of sample locations and excavations

Additional Comments

Backfill of pit started 2-10-08 and was completed 2-25-08

I hereby certify that the information above is true and complete to the best of my knowledge and belief. I further certify that the above-described pit or below-grade tank has been/will be constructed or closed according to NMOCD guidelines ☒, a general permit ☐, or an (attached) alternative OCD-approved plan ☐.

Date: 3-15-08

Printed Name/Title Brian Wood / Consultant (Phone 505 466-8120)

Signature Brian Wood

Your certification and NMOCD approval of this application/closure does not relieve the operator of liability should the contents of the pit or tank contaminate ground water or otherwise endanger public health or the environment. Nor does it relieve the operator of its responsibility for compliance with any other federal, state, or local laws and/or regulations.

Approval. Deputy Oil & Gas Inspector,
Printed Name/Title District #3

Signature Bob Pell

Date

MAY 30 2008

NOTIFY
NEW MEXICO ONE-CALL
BEFORE COMMENCING
EXCAVATION!
(800) 321-2537



0 50 100
SCALE: 1"=100'

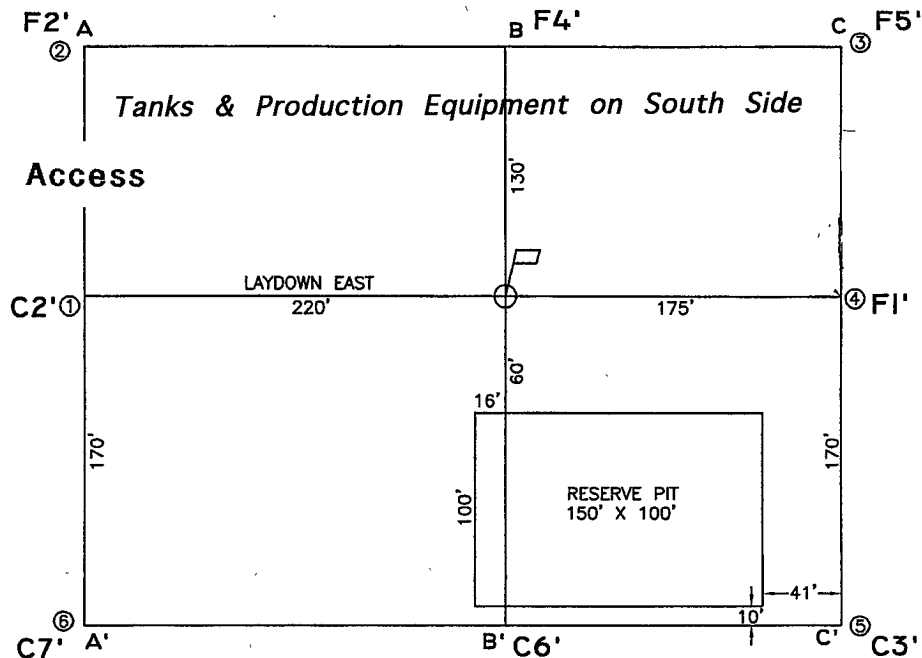

A-A' E

7230
7220
7210
7200
7190

B-B' E

7230
7220
7210
7200
7190

C-C' E

7230
7220
7210
7200
7190

CROSS SECTIONS
HORIZONTAL: 1"=100'
VERTICAL: 1"=10'

LEASE: ALMAGRE ARROYO 30 #1

FOOTAGE: 2605' FSL, 2400' FWL

SEC. 30 TWN. 24 N RNG. 1 E N.M.P.M.

LATITUDE: 36.281820° LONGITUDE: 106.876966°

ELEVATION: 7212

U.S. ENERCORP, LTD.
SAN ANTONIO, TEXAS

SURVEYED: 3/14/06

REV. DATE:

APP. BY R.P.

DRAWN BY: A.D.

DATE DRAWN: 3/30/06

FILE NAME: 6626C01



P.O. BOX 3651
FARMINGTON, NM 87499
OFFICE: (505) 334-0408