

District I
1625 N French Dr., Hobbs, NM 88240
District II
1301 W. Grand Avenue, Artesia, NM 88210
District III
1000 Rio Brazos Road, Aztec, NM 87410
District IV
1220 S. St. Francis Dr., Santa Fe, NM 87505

State of New Mexico
Energy Minerals and Natural Resources

Form C-144
June 1, 2004

Oil Conservation Division
1220 South St. Francis Dr.
Santa Fe, NM 87505

For drilling and production facilities, submit to appropriate NMOCD District Office.
For downstream facilities, submit to Santa Fe office

Pit or Below-Grade Tank Registration or Closure

Is pit or below-grade tank covered by a "general plan"? Yes ☒ No ☐

Type of action: Registration of a pit or below-grade tank ☐ Closure of a pit or below-grade tank ☒

Operator: WEST LARGO CORP. Telephone: (918) 492-3239 e-mail address: jpgarrett@tulsacoxmail.com
Address: 8801 S. Yale Ave., Suite 240 Tulsa, OK 74137-3535
Facility or well name: Federal 15 #1 API #: 30-045-34311 U/L or Qtr/Qtr F (SENW) Sec 15 T 28N R 9W
County: San Juan Latitude 36° 39.8287 N Longitude 107° 46.5808 W NAD 1927 ☒ 1983 ☐
Surface Owner: Federal ☒ State ☐ Private ☐ Indian ☐

Pit Type: Drilling <input checked="" type="checkbox"/> Production <input type="checkbox"/> Disposal <input type="checkbox"/> Workover <input type="checkbox"/> Emergency <input type="checkbox"/> Lined <input checked="" type="checkbox"/> Unlined <input type="checkbox"/> Liner type: Synthetic <input checked="" type="checkbox"/> Thickness 12 mil Clay <input type="checkbox"/> Pit Volume 2100 bbl	Below-grade tank Volume: _____ bbl Type of fluid _____ Construction material: _____ Double-walled, with leak detection? Yes <input type="checkbox"/> If not, explain why not _____
Depth to ground water (vertical distance from bottom of pit to seasonal high water elevation of ground water.)	Less than 50 feet (20 points) 50 feet or more, but less than 100 feet (10 points) <u>100 feet or more</u> (0 points) ✓
Wellhead protection area: (Less than 200 feet from a private domestic water source, or less than 1000 feet from all other water sources.)	Yes (20 points) <u>No</u> (0 points) ✓
Distance to surface water: (horizontal distance to all wetlands, playas, irrigation canals, ditches, and perennial and ephemeral watercourses)	Less than 200 feet (20 points) 200 feet or more, but less than 1000 feet (10 points) <u>1000 feet or more</u> (0 points) ✓
Ranking Score (Total Points) <u>0</u>	

If this is a pit closure: (1) Attach a diagram of the facility showing the pit's relationship to other equipment and tanks. (2) Indicate disposal location: (check the onsite box if you are burying in place) onsite ☒ offsite ☐ If offsite, name of facility: _____. (3) Attach a general description of remedial action taken including remediation start date and end date. (4) Groundwater encountered: No ☒ Yes ☐ If yes, show depth below ground surface _____ ft. and attach sample results. (5) Attach soil sample results and a diagram of sample locations and excavations.

Additional Comments.

RCVD APR 14 '08

OIL CONS. DIV.

DIST. 3

I hereby certify that the information above is true and complete to the best of my knowledge and belief. I further certify that the above-described pit or below-grade tank has been/will be constructed or closed according to NMOCD guidelines ☒, a general permit ☐, or an (attached) alternative OCD-approved plan ☐.

Date: 4/10/2008

Printed Name/Title John P. Garrett, President

Signature 

Your certification and NMOCD approval of this application/closure does not relieve the operator of liability should the contents of the pit or tank contaminate ground water or otherwise endanger public health or the environment. Nor does it relieve the operator of its responsibility for compliance with any other federal, state, or local laws and/or regulations.

Approval: Deputy Oil & Gas Inspector,
Printed Name/Title District #3

Signature 

Date:

MAY 30 2008

Daily Drilling Report

West Largo Corp.

Federal 15 #1

API No. 30-045-34311

1985' FNL, 2385' FWL

SENW Section 15 T28N R9W

San Juan County, NM

5973' G.L.

Note: Fluid in reserve pit was pumped out and removed to Basin Disposal and allowed to evaporate before closure.

4/07/08 MIRU Vaughn Oilfield Services, Inc. Remove fence surrounding reserve pit. Cut liner and removed top section to landfill. Used dozer to push berms and surrounding soil into pit. Work witnessed and inspected by BLM personnel.

4/08/08 Recontoured water diversion on north edge of location and walked diversion down. Recontoured drainage on northwest side of pad. Back slope sides and lower (south) end of location and walked down contour.

WEST LARGO CORPORATION FEDERAL 15 #1
1985' FNL & 2385' FWL, SECTION 15, T28N, R9W, NMPM
SAN JUAN COUNTY, NEW MEXICO GROUND ELEVATION: 5973'

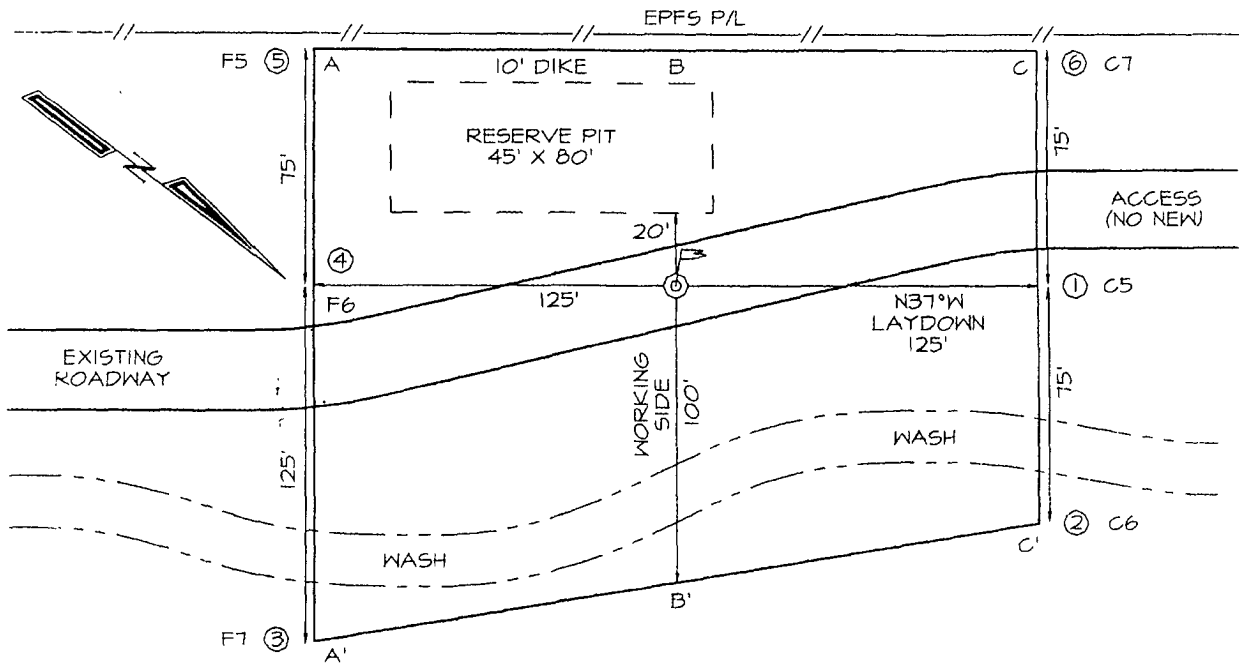

AREA OF WELLPAD = 1.00 ACRES

LATITUDE: 36°39'50"
 LONGITUDE: 107°46'35"
 DATUM: NAD1927

