

**UNITED STATES
DEPARTMENT OF THE INTERIOR
BUREAU OF LAND MANAGEMENT**

RECEIVED**JUL 21 2008**

Sundry Notices and Reports on Wells

Bureau of Land Management
Farmington Field Office

1. Type of Well

GAS

5. Lease Number
SF-0780816. If Indian, All. or
Tribe Name

7. Unit Agreement Name

2. Name of Operator

BURLINGTON

RESOURCES OIL & GAS COMPANY LP

Huerfanito Unit

3. Address & Phone No. of Operator

PO Box 4289, Farmington, NM 87499 (505) 326-9700

8. Well Name & Number

9. Huerfanito Unit 72
API Well No.

30-045-06226

4. Location of Well, Footage, Sec., T, R, M

Unit K (NESW), 1480' FSL & 1450' FWL, Sec. 28, T27N, R09W, NMPM

10. Field and Pool

Basin Dakota

Basin Fruitland Coal

11. County and State

San Juan Co., NM

12. CHECK APPROPRIATE BOX TO INDICATE NATURE OF NOTICE, REPORT, OTHER DATA

Type of Submission

☒ Notice of Intent☐ Subsequent Report☐ Final Abandonment

Type of Action

☐ Abandonment☐ Plugging☐ Casing Repair☐ Altering Casing☐ Change of Plans☐ Non-Routine Fracturing☐ Water Shut off☐ Conversion to Injection☒ Other - Plugback DK

Recomplete FC

13. Describe Proposed or Completed Operations

Burlington Resources wishes to plug back the Dakota and recomplete to the Fruitland Coal per the attached procedures.
See attached C-102 for the Fruitland Coal and the original plat dated June 29, 1962, surveyor name & certificate number are not legible.

RCVD JUL 23 '08

OIL CONS. DIV.

DIST. 3

14. I hereby certify that the foregoing is true and correct.

Signed Tracey N. Monroe Tracey N. Monroe Title Regulatory Technician Date 7/21/2008

(This space for Federal or State Office use)

APPROVED BY Original Signed: Stephen Mason Title _____ Date JUL 22 2008

CONDITION OF APPROVAL, if any:

Title 18 U.S.C. Section 1001, makes it a crime for any person knowingly and willfully to make any department or agency of the United States any false, fictitious or fraudulent statements or representations as to any matter within its jurisdiction

NMOCD

District I

1625 N. French Dr., Hobbs, NM 88240
Phone (505) 393-6161 Fax (505) 393-0720

District II

1301 W. Grand Ave., Artesia, NM 88210
Phone: (505) 748-1283 Fax (505) 748-9720

District III

1000 Rio Brazos Rd., Aztec, NM 87410
Phone: (505) 334-6178 Fax (505) 334-6170

District IV

1220 S. St Francis Dr., Santa Fe, NM 87505
Phone: (505) 476-3470 Fax (505) 476-3462

State of New Mexico
Energy, Minerals and Natural Resources

Oil Conservation Division
1220 S. St Francis Dr.
Santa Fe, NM 87505

Form C-102
Permit 77479

WELL LOCATION AND ACREAGE DEDICATION PLAT

1 API Number 30-045-06226	2. Pool Code 71629	3 Pool Name BASIN FRUITLAND COAL (GAS)
4. Property Code 7138	5. Property Name HUERFANITO UNIT	6 Well No. 072
7 OGRID No 14538	8. Operator Name BURLINGTON RESOURCES OIL & GAS COMPANY LP	9. Elevation 6451

10. Surface Location

UL - Lot K	Section 28	Township 27N	Range 09W	Lot Idn	Feet From 1480	N/S Line S	Feet From 1450	E/W Line W	County SAN JUAN
----------------------	----------------------	------------------------	---------------------	---------	--------------------------	----------------------	--------------------------	----------------------	---------------------------

11. Bottom Hole Location If Different From Surface

UL - Lot	Section	Township	Range	Lot Idn	Feet From	N/S Line	Feet From	E/W Line	County
12. Dedicated Acres 320.00		13 Joint or Infill		14. Consolidation Code		15 Order No			

NO ALLOWABLE WILL BE ASSIGNED TO THIS COMPLETION UNTIL ALL INTERESTS HAVE BEEN CONSOLIDATED OR A NON-STANDARD UNIT HAS BEEN APPROVED BY THE DIVISION

**OPERATOR CERTIFICATION**

I hereby certify that the information contained herein is true and complete to the best of my knowledge and belief, and that this organization either owns a working interest or unleased mineral interest in the land including the proposed bottom hole location(s) or has a right to drill this well at this location pursuant to a contract with an owner of such a mineral or working interest, or to a voluntary pooling agreement or a compulsory pooling order heretofore entered by the division.

E-Signed By: *Tamara Deserin*
Title: *Regulatory Technician*
Date: *7/10/08*

SURVEYOR CERTIFICATION

I hereby certify that the well location shown on this plat was plotted from field notes of actual surveys made by me or under my supervision, and that the same is true and correct to the best of my belief.

Surveyed By: not legible not legible ✓
Date of Survey: 4/4/1962
Certificate Number: see comments

DISTRIBUTION	
SANTA FE	
FILE	
U.S.G.S.	
LAND OFFICE	
TRANSPORTER	OIL
	GAS
PRODUCTION OFFICE	
OPERATOR	

NEW MEXICO OIL CONSERVATION COMMISSION
WELL LOCATION AND ACREAGE DEDICATION PLAT
 SEE INSTRUCTIONS FOR COMPLETING THIS FORM ON THE REVERSE SIDE

FORM C-128
 Revised 8/1/52

SECTION A

Operator Socony Mobil Oil Company, Inc.			Lease Huerfanito Unit		Well No. 23-28
Unit Letter K	Section 28	Township 27N	Range 9W	County San Juan	
Actual Footage Location of Well: 1480 feet from the South line and 1450 feet from the West line					
Ground Level Elev. 6451	Producing Formation Dakota		Pool Basin Dakota	Dedicated Acreage: 320 Acres	

1. Is the Operator the only owner in the dedicated acreage outlined on the plat below? YES _____ NO _____. ("Owner" means the person who has the right to drill into and to produce from any pool and to appropriate the production either for himself or for himself and another. (65-3-29 (e) NMSA 1935 Comp.)
2. If the answer to question one is "no," have the interests of all the owners been consolidated by communitization agreement or otherwise? YES _____ NO _____. If answer is "yes," Type of Consolidation _____
3. If the answer to question two is "no," list all the owners and their respective interests below:

Owner	Land Description

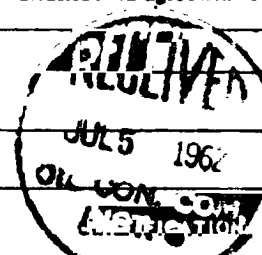

SECTION B

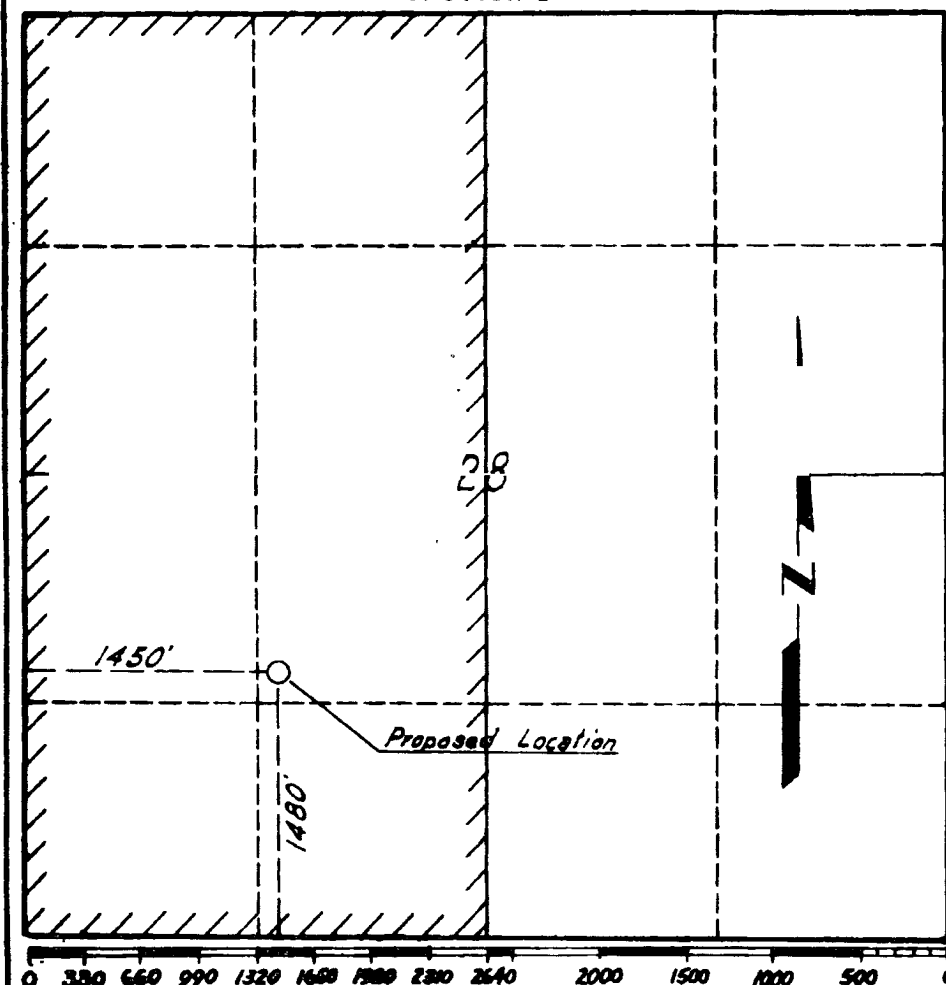

I hereby certify that the information in SECTION A above is true and complete to the best of my knowledge and belief.

Name <i>J. M. Barry</i>
Position Dist. Prod. Supt.
Company Socony Mobil Oil Co., Inc.
Date June 29, 1962

I hereby certify that the well location shown on the plat in SECTION B was plotted from field notes of actual surveys made by me or under my supervision, and that the same is true and correct to the best of my knowledge and belief.

Date Surveyed: April 1, 1962
Registered Professional Engineer and/or Land Surveyor <i>[Signature]</i>

Herfanito Unit #72

Unit K, Section 28, Township 27N, Range 9W

API# 3004506226

Fruitland Coal Recompletion Sundry

07/16/2008

****Sundry procedure does not include the necessary wellbore P&A work as COP's production department is going to complete the P&A work prior to the recompletion of the Fruitland coal.**

Procedure:

1. Run a GR/CCL/CBL correlation log and Cased Hole Neutron Log from PBTD to surface.
2. Perform MIT to 500 psi. If wellbore does not pressure test successfully perform remedial work as required.
3. Perforate the first stage Fruitland Coal.
4. Fracture stimulate the first stage Fruitland Coal with 20/40 Arizona sand in of 75Q foamed 25# linear gel.
5. RIH and set a composite frac plug above first stage.
6. Perforate the second stage Fruitland Coal.
7. Fracture stimulate the second stage Fruitland Coal with 20/40 Arizona sand in 75Q foamed 25# linear gel.
8. Flow back frac on clean-up to steel pit. RIH and wireline set a composite bridge plug 50ft above top perf.
9. MIRU service rig. TIH with a mill and drill out composite plugs. Clean out to PBTD. TOOH.
10. Flow test / run a pressure survey on slick line.
11. TIH and land production tubing.

12. Release service rig and turn over to production.

**Wellbore Schematic as of 7/17/08
(prior to P&A being completed)**

ftKB (MD)

Schematic - Actual

11

321

322

323

780

2,289

2,378

2,475

2,476

2,486

3,837

4,908

5,603

5,776

6,254

6,598

6,619

6,621

6,653

6,653

6,654

6,654

6,690

6,693

6,695

6,753

6,926

6,935

6,948

6,949

6,955

1-1, Casing Joints, 8 5/8, 8,097, 11, 310.0

1-2, Guide Shoe, 8 5/8, 8,097, 321, 1.0

2-1, Casing Joints, 4 1/2, 4,052, 11, 2,484.0

2-2, Stage Tool, 4 1/2, 4,090, 2,475, 1.0

2-1, TUBING, 2 3/8, 1,995, 11, 6,608.5

2-2, MARKER SUB, 2 3/8, 1,995, 6,620, 2.0

2-3, TUBING, 2 3/8, 1,995, 6,622, 31.1

2-4, SEAT NIPPLE, 2 3/8, 1,780, 6,653, 0.8

2-5, SAW TOOTH, 2 3/8, 1,995, 6,653, 0.4

Dakota, 6,693-6,926, 10/4/1962

2-3, Casing Joints, 4 1/2, 4,052, 2,476, 4,472.0

2-4, Guide Shoe, 4 1/2, 4,052, 6,948, 1.0

ConocoPhillips
Huerfanito Unit 72 (DK)
Plug Back Dakota

Lat 36° 00' 32" N **Long** 107° 00' 47" W

Prepared By: Catlain H. Richardson

Engineer

Date: 7/21/08

Scope of work: Multiple casing leaks were discovered in well over the depths of 2486'-4462'.
The wellbore will be plugged back to 2470' and recompleted to the Fruitland Coal.

Est. Cost: \$40,000

Est. Rig Days: 4

WELL DATA:

API: 30-045-06226

Location: 1480' FSL & 1450' FWL, (Spot K), Section 28- T27N - R9W

PBTD: 6755' **TD:** 6790'

Perforations: 6693'-6926' (DK)

Casing Failures: 2486'-4462' (gross interval)

Well History/Justification: The Huerfanito Unit 72 is a Dakota well that was drilled and completed in 1962. The gas production on this well has been limited due to a Halliburton EZ-Drill retainer, which was set 30 feet above the top perforations in October of 1971 to protect the Dakota zone from a suspected casing leak. A recommendation was made in May 2007 to remove the retainer, isolate and repair the possible casing leak(s) and return the well to production. In January 2008, the rig moved onto this well and found multiple casing leaks and poor integrity of the casing between 2486' - 2516' and 3498'- 4462' (1976' gross). Some tight casing spots at 2730', 3270' and 4550' were also identified by the rig supervisor. The retainer is currently located at 6690', which is 3' above the top Dakota perforations. The well will be plugged back to 2470' and recompleted to the Fruitland Coal.

B2 Adapters are required on all wells other than pumping wells.

Artificial lift on well (type): none

Est. Reservoir Pressure (psig): 1200 psi (DK)

Current Rate (Mcf/d): 0 Mcfd

Est. Rate Post Remedial (Mcf/d): n/a

Earthen Pit Required: NO

Special Requirements: A-Plus steel pit required for waste fluids and cement wash up.

BAE Production Engineer: Catlain Richardson Cell: 505-320-3499

BAE Backup: Asif Bari Office: 505-324-5103, Cell: 505-947-1822

MSO: Johnny Arenas Cell: 505-947-0383

Lead: Gary Nelson Cell: 505-320-2565

Area Foreman: Steve Stamets Cell: 505-320-2516

ConocoPhillips
Huerfanito Unit 72 (DK)
Plug Back Dakota

Lat 36° 00' 32" N Long 107° 00' 47" W

PROCEDURE:

Note: All cement volumes use 100% excess outside pipe and 50' excess inside pipe. The stabilizing wellbore fluid will be 8.3 ppg, sufficient to balance all exposed formation pressures.

All cement will be Class G, mixed at 15.8 ppg with a 1.15 cf/sx yield.

1. This project requires the Operator to obtain an approved NMOCD C-144 Pit or Below-Grade Tank Registration application for the use of an A-Plus steel tank to handle waste fluids circulated from the well and cement wash up.
2. Install and test location rig anchors. Comply with all NMOCD, BLM, and Operator safety regulations. MOL and RU daylight pulling unit. Conduct safety meeting for all personnel on location. Record casing, tubing and bradenhead pressures. NU relief line and blow down well. Kill well with water as necessary and at least pump tubing capacity of water down the tubing. ND wellhead and NU BOP. Function test BOP.
3. Rods: Yes , No X , Unknown
Tubing: Yes X , No , Unknown , Size 2.375" , Length 6654'
Packer: Yes , No X , Unknown , Type
If well has rods or a packer, then modify the work sequence in Step #2 as appropriate.
4. TOH and visually inspect tubing. If necessary, LD tubing and PU workstring.
5. **Plug #1 (Dakota perforations and top, 6643' – 6543')**: TIH and tag existing CR at 6690'. Load casing with water and circulate well clean. Mix and pump 12 sxs Class G cement and spot a balanced plug above CR to isolate the Dakota interval. PUH.
6. **Plug #2 (Gallup top, 5825' – 5725')**: Mix 12 sxs Class G cement and spot a balanced plug inside casing to cover the Gallup top. PUH.
7. **Plug #3 (Mesaverde top, 3864' – 3764')**: RIH and set CR at 3814'. Establish rate into casing leaks below CR. Mix 86 sxs Class G cement (excess cement due to casing leaks) and squeeze 60 sxs outside casing and leave 26 sxs inside casing to cover the Mesaverde top. TOH with tubing and WOC. TIH and tag cement at 3764' or higher. If necessary spot additional cement.
8. RIH and set 4.5" CIBP at 2470'. Load casing and circulate well clean. Pressure test casing to 800 PSI. If casing does not test, then spot or tag subsequent plugs as appropriate. If casing does not test then contact COP Engineer for further instruction. If casing does pressure test, then TOH and LD the tubing.
10. RD and MOL.

Current Schematic

ConocoPhillips

Well Name: HUERFANITO UNIT #72

API/ UUI	Surface Legal Location	Field Name	License No	State/Province	Well Configuration Type	Edit
3004506226	NMPM,028-027N-009W	BASF/DKND (A) (PERFORATED GAS)		NEW MEXICO		
Ground Elevation (ft)	Original KB/RT Elevation (ft)	KB-Grout Distance (ft)	KB-Casing Flange Distance (ft)	KB-Tubing Hanger Distance (ft)		
6,483.00	6,474.00	11.00				

Well Config - Original Hole 7/21/2008 7:00:03 AM

