

UNITED STATES  
DEPARTMENT OF THE INTERIOR  
BUREAU OF LAND MANAGEMENT

FORM APPROVED

OMB No. 1004-0136

Expires November 30, 2000

APPLICATION FOR PERMIT TO DRILL OR REENTER

1a. Type of Work <input checked="" type="checkbox"/> DRILL <input type="checkbox"/> REENTER		5. Lease Designation and Serial No. NMSF078476	
1b. Type of Well: Oil Well <input type="checkbox"/> Gas Well <input checked="" type="checkbox"/> Other <input type="checkbox"/> Single Zone <input checked="" type="checkbox"/> Multiple Zone <input type="checkbox"/>		6. If Indian, Allottee or Tribe Name	
2. Name of Operator PHOENIX HYDROCARBONS OPERATING CORPORATION		7. If Unit or CA, Agreement, Name and No.	
3a. Address P O BOX 3638, MIDLAND, TX 79705		8. Lease Name and Well No. FEDERAL R #1B	
3b. Phone Number 915 682-1186		9. API Well No. 3004531870	
4. Location of Well (Footage, Sec, T, R., M, or Survey Description) At surface: 830' FNL & 1045' FEL; A-SEC 15, T-27N, R-8W At proposed prod. Zone: Same		10. Field and Pool, or Exploratory BLANCO MESAVERDE	
14. Distance in miles and direction from nearest town or post office* 20 MILES SOUTH OF BLANCO		11. Sec., T., R., M., or Blk. and Survey or Area A SEC 15, T-27N, R-8W	
15. Distance from proposed* location to nearest property or lease line, ft. (Also to nearest drlg. Unit line, if any) 830' FNL		12. County or Parish, SAN JUAN	
16. No of Acres in lease 320		13. State New Mexico	
18. Distance from proposed* location to nearest property or lease line, ft. 830' FNL		17. Spacing Unit dedicated to this well 320 E/A	
19. Proposed Depth 4760'		20. BLM/BIA Bond No. on file BLM NM 2887	
21. Elevation (Show whether DF, KDB, RT, GL, etc.) GL 5948'		23. Estimated duration 8 DAYS	

24. Attachments

The following, completed in accordance with the requirements of Onshore Oil and Gas Order No. 1, shall be attached to this form:

- Well plat certified by a registered surveyor.
- A Drilling Plan
- A Surface Use Plan (if the location is on National Forest System Lands, the SUPO shall be filed with the appropriate Forest Service Office.
- Bond to cover the operations unless covered by an existing bond on file (see Item 20 above).
- Operator certification.
- Such other site specific information and/or plans as may be required by the authorized officer

Size of Hole	Grade, Size of Casing	Weight per Foot	Setting Depth	Quantity of Cement
11"	8-5/8"	24#	230'	100 sks Halliburton Class"B",circ to surf
7-7/8"	4-1/2"	10.5#	4760'	1235 sks Halliburton Class"A",w/2%CaC12,circ to surf

SEE ATTACHED APD INFORMATION

25. Signature <i>Gregory F. Baiano</i>	Name (Printed/Typed) GREGORY F. BAIANO	Date 8/18/03
Title Engineer		
Approved by (Signature) <i>David J. Markiewicz</i>	Name (Printed/Typed) David J. Markiewicz	Date OCT 21 2003
Title Engineer	Office	

Application approval does not warrant or certify the applicant holds legal or equitable title to those rights in the subject lease which would entitle the applicant to conduct operations thereon.

Conditions of approval, if any, are attached.

Title 18 U.S.C. Section 1001 and Title 43 U.S.C. Section 1212, make it a crime for any person knowingly and willfully to make to any department or agency of the United States any false, fictitious, or fraudulent statements or representations as to any matter within its jurisdiction.

\*(Instructions on reverse)

HOLD C104 FOR *Change in status to Federal R #1*  
This action is subject to technical and procedural review pursuant to 43 CFR 3165.3 and appeal pursuant to 43 CFR 3165.4

NMOCD

DRILLING OPERATIONS AUTHORIZED ARE SUBJECT TO COMPLIANCE WITH ATTACHED "GENERAL REQUIREMENTS".

District I  
PO Box 1980, Hobbs, NM 88241-1980  
District II  
811 South First, Artesia, NM 88210  
District III  
1000 Rio Brazos Rd., Aztec, NM 87410  
District IV  
2040 South Pacheco, Santa Fe, NM 87505

State of New Mexico  
Energy, Minerals & Natural Resources Department

OIL CONSERVATION DIVISION  
2040 South Pacheco  
Santa Fe, NM 87505

Form C-102  
Revised October 18, 1994  
Instructions on back  
Submit to Appropriate District Office  
State Lease - 4 Copies  
Fee Lease - 3 Copies

☐ AMENDED REPORT

WELL LOCATION AND ACREAGE DEDICATION PLAT

1 APT Number 30-045-31870		2 Pool Code 72319		3 Pool Name Blanco Mesaverde		
4 Property Code 26853		5 Property Name Federal			6 Well Number R 1B	
7 OGRID No. 188483		8 Operator Name Phoenix Hydrocarbons Operating Corp.			9 Elevation 5948	

10 Surface Location



UL or lot no.	Section	Township	Range	Lot Idn	Feet from the	North/South line	Feet from the	East/West line	County
A	15	27N	8W		830'	North	1045	East	San Juan

11 Bottom Hole Location If Different From Surface

UL or lot no.	Section	Township	Range	Lot Idn	Feet from the	North/South line	Feet from the	East/West line	County

12 Dedicated Acres	13 Joint or Infill	14 Consolidation Code	15 Order No.

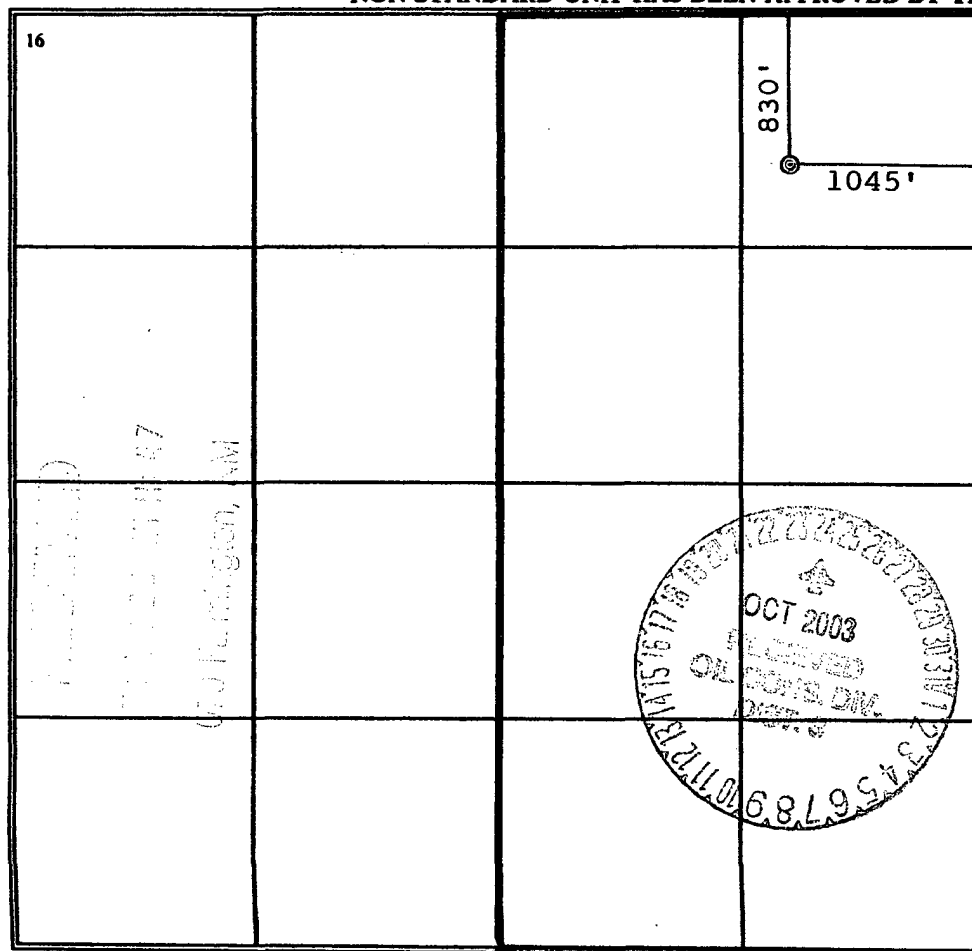
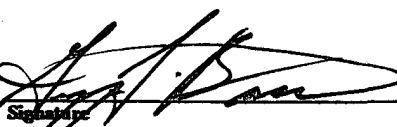
NO ALLOWABLE WILL BE ASSIGNED TO THIS COMPLETION UNTIL ALL INTERESTS HAVE BEEN CONSOLIDATED OR A NON-STANDARD UNIT HAS BEEN APPROVED BY THE DIVISION

16 	17 OPERATOR CERTIFICATION I hereby certify that the information contained herein is true and complete to the best of my knowledge and belief  Signature:  Gregory F. Baiano Printed Name Engineer Title 8/18/03 Date
	18 SURVEYOR CERTIFICATION I hereby certify that the well location shown on this plat was plotted from field notes of actual surveys made by me or under my supervision, and that the same is true and correct to the best of my belief.  Date of Survey: July 30, 2003 Signature:  Cecil B. Tullis Printed Name REGISTERED PROFESSIONAL LAND SURVEYOR NEW MEXICO 19872 Certificate Number
	

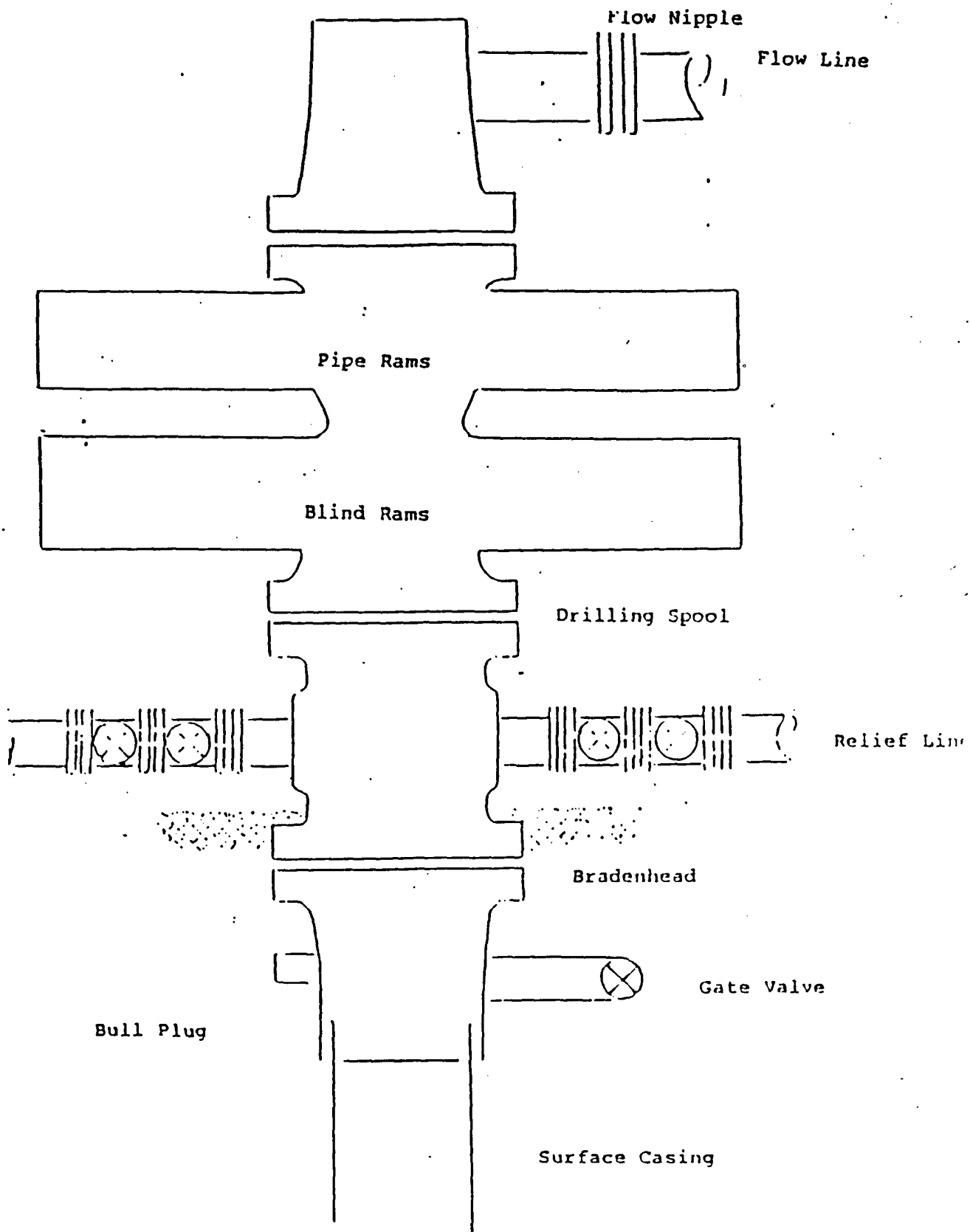

Series 900 Double Gate BOP, rated at 3000 psi Working Pressure. When gas drilling operations begin a Shaffer type 50 or equivalent rotating head is installed on top of the flow nipple and the flow line is converted into a blowie line.