

UNITED STATES  
DEPARTMENT OF THE INTERIOR  
BUREAU OF LAND MANAGEMENT

RECEIVED

AUG 25 2008

Bureau of Land Management  
Farmington Field Office

APPLICATION FOR PERMIT TO DRILL, DEEPEN, OR PLUG BACK

|  |   |
|--|---|
| 1a. Type of Work<br>DRILL  | 5. Lease Number<br>NM-011393<br>Unit Reporting Number   |
| 1b. Type of Well<br>GAS  | 6. If Indian, All. or Tribe<br>RCVD SEP 12 '08<br>OIL CONS. DIV.  |
| 2. Operator<br><b>BURLINGTON</b><br>RESOURCES Oil & Gas Company, LP  | 7. Unit Agreement Name<br>DIST. 3   |
| 3. Address & Phone No. of Operator<br>PO Box 4289, Farmington, NM 87499<br><br>(505) 326-9700  | 8. Farm or Lease Name<br>Cleveland<br>9. Well Number<br>#4S   |
| 4. Location of Well<br>Surf: Unit O(SWSE), 1230' FSL & 1515' FEL<br><br>Surf: Latitude 36.55681° N<br>Longitude 107.78997° W                         | 10. Field, Pool, Wildcat<br>Basin Fruitland Coal<br><br>11. Sec., Twn, Rge, Mer. (NMPM)<br>0 Sec. 21, T27N, R9W<br><br>API # 30-045-34777 |
| 14. Distance in Miles from Nearest Town<br>27 miles/Bloomfield   | 12. County<br>San Juan<br>13. State<br>NM   |
| 15. Distance from Proposed Location to Nearest Property or Lease Line<br>1230'   |   |
| 16. Acres in Lease<br>1,280.00   | 17. Acres Assigned to Well<br>320.00 - S/2  |
| 18. Distance from Proposed Location to Nearest Well, Drig, Compl, or Applied for on this Lease<br>460' from Cleveland #7R                            |   |
| 19. Proposed Depth<br>2367' This action is subject to technical and procedural review pursuant to 43 CFR 3165.3 and appeal pursuant to 43 CFR 3165.4 | 20. Rotary or Cable Tools<br>Rotary   |
| 21. Elevations (DF, FT, GR, Etc.)<br>6282' GR  | 22. Approx. Date Work will Start<br>DRILLING OPERATIONS AUTHORIZED ARE SUBJECT TO COMPLIANCE WITH ATTACHED "GENERAL REQUIREMENTS".        |
| 23. Proposed Casing and Cementing Program<br>See Operations Plan attached  |   |
| 24. Authorized by: <u>Crystal Tafoya</u><br>Crystal Tafoya (Regulatory Technician)   | <u>8/25/08</u><br>Date  |

PERMIT NO.

APPROVAL DATE

APPROVED BY

TITLE

DATE

Archaeological Report attached

Threatened and Endangered Species Report attached

NOTE: This format is issued in lieu of U.S. BLM Form 3160-3

Title 18 U.S.C. Section 1001, makes it a crime for any person knowingly and willfully to make to any department or agency of the United States any false, fictitious or fraudulent statements or presentations as to any matter within its jurisdiction.

Example Master Plan Type 2

Bond Numbers NMP-000015

SEP 19 2008

NMOCD

NOTIFY AZTEC OCD 24 HRS.  
PRIOR TO CASING & CEMENT

A COMPLETE C-144 MUST BE SUBMITTED TO AND APPROVED BY THE NMOCD FOR: A PIT, CLOSED LOOP SYSTEM, BELOW GRADE TANK, OR PROPOSED ALTERNATIVE METHOD, PURSUANT TO NMOCD PART 19.15.17, PRIOR TO THE USE OR CONSTRUCTION OF THE ABOVE APPLICATIONS

District I  
1625 N. French Dr., Hobbs, NM 88240

District II  
1301 W. Grand Avenue, Artesia, NM 88210

District III  
1000 Rio Brazos Rd., Aztec, NM 87410

District IV  
1220 S St Francis Dr., Santa Fe, NM 87505

State of New Mexico  
Energy, Minerals & Natural Resources Department

OIL CONSERVATION DIVISION  
1220 South St. Francis Dr.  
Santa Fe, NM 87505

Form C-102  
Revised October 12, 2005  
Instructions on back  
Submit to Appropriate District Office  
State Lease - 4 Copies  
Fee Lease - 3 Copies

☐ AMENDED REPORT

WELL LOCATION AND ACREAGE DEDICATION PLAT

|                             |  |                                    |
|-----------------------------|--|------------------------------------|
| *API Number<br>30-045-34777 | *Pool Code<br>71629  | *Pool Name<br>BASIN FRUITLAND COAL |
| *Property Code<br>6916      | *Property Name<br>CLEVELAND                                  | *Well Number<br>4S                 |
| *OGRID No<br>14538          | *Operator Name<br>BURLINGTON RESOURCES OIL & GAS COMPANY, LP | *Elevation<br>6282'                |

10 Surface Location

| UL or lot no. | Section | Township | Range | Lot Idn | Feet from the | North/South line | Feet from the | East/West line | County   |
|---------------|---------|----------|-------|---------|---------------|------------------|---------------|----------------|----------|
| 0             | 21      | 27N      | 9W    |         | 1230          | SOUTH            | 1515          | EAST           | SAN JUAN |

11 Bottom Hole Location If Different From Surface

| UL or lot no.                             | Section | Township | Range | Lot Idn | Feet from the      | North/South line      | Feet from the | East/West line | County |
|---|---------|----------|-------|---------|--------------------|-----------------------|---------------|----------------|--------|
| 0   |         |          |       |         |                    |                       |               |                |        |
| 12 Dedicated Acres<br>320.0 Acres - (S/2) |         |          |       |         | 13 Joint or Infill | 14 Consolidation Code | 15 Order No.  |                |        |

NO ALLOWABLE WILL BE ASSIGNED TO THIS COMPLETION UNTIL ALL INTERESTS HAVE BEEN CONSOLIDATED  
OR A NON-STANDARD UNIT HAS BEEN APPROVED BY THE DIVISION

|          |          |          |   |
|----------|----------|----------|---|
| 16       | 5264.16' |          | 17 OPERATOR CERTIFICATION<br>I hereby certify that the information contained herein is true and complete to the best of my knowledge and belief, and that this organization either owns a working interest or unleased mineral interest in the land including the proposed bottom-hole location or has a right to drill this well at this location pursuant to a contract with an owner of such a mineral or working interest, or to a voluntary pooling agreement or a compulsory pooling order heretofore entered by the division.<br><br>Signature <u>Crystal Walker</u> Date <u>2/27/08</u><br>Printed Name <u>Crystal Walker</u> 2-27-08 |
| 5212.68' | 21       | 5281.08' | 18 SURVEYOR CERTIFICATION<br>I hereby certify that the well location shown on this plat was plotted from field notes of actual surveys made by me or under my supervision, and that the same is true and correct to the best of my belief<br>Survey Date: FEBRUARY 19, 2008<br>Signature and Seal of Professional Surveyor<br><br>JASON C. EDWARDS<br>NEW MEXICO<br>REGISTERED PROFESSIONAL SURVEYOR<br>15269<br>JASON C. EDWARDS<br>Certificate Number 15269   |
|          | 1395'    | 1515'    |   |
|          | 1230'    | 1105'    |   |
|          | 5247.00' |          |   |
|          |          |          | LAT: 36°33.4082' N<br>LONG: 107°47.3616' W<br>DATUM: NAD27<br><br>LAT: 36°55.681' N<br>LONG: 107°48.997' W<br>DATUM: NAD83  |

**COMPANY**  
**Charge Code**  
**WELL NAME**  
**DUAL WELL**  
**TRIPLE WELL**

|                      |      |           |
|----------------------|------|-----------|
| BURLINGTON RESOURCES |      |           |
| WAN.RFE.PDO7.ER      |      |           |
| CLEVELAND # 4 S      | DATE | 2/27/2008 |
| WELL NAME            |      |           |
| WELL NAME            |      |           |

**COORDINATES**

|      |       |       |              |               |
|------|-------|-------|--------------|---------------|
| SEC  | TNSHP | RANGE | LATITUDE     | LONGITUDE     |
| O 21 | 27 N  | 9 W   | 36 33.4082 N | 107 47.3616 W |

**COUNTY**

|          |
|----------|
| SAN JUAN |
|----------|

RECTIFIER  
SOLAR  
GROUND BED  
240 V METER POLE  
480 V METER POLE  
D C CABLES  
A C CABLES  
PRIMARY POWER  
DISTANCE TO POWER  
UNDERGROUND  
PUMPJACK  
WATER PUMP

| SIZE   | NEEDED | EXISTING | 1 PHASE     | 3 PHASE |
|--------|--------|----------|-------------|---------|
|        |        |          |             |         |
| (12/4) | X      |          |             |         |
|        | X      |          |             |         |
|        |        |          |             |         |
| # 8    | 150'   |          |             |         |
|        |        |          |             |         |
|        |        |          | JEMEZ       |         |
|        |        |          | 1 1/2 MILES |         |
|        |        |          |             |         |
|        |        |          |             |         |

**COMMENTS**

|                                   |
|-----------------------------------|
| INSTALL SOLAR SYSTEM - SANDY SOIL |
|                                   |
|                                   |
|                                   |
|                                   |

|                  |                        |
|------------------|------------------------|
| <b>WELL NAME</b> | <b>CLEVELAND # 4 S</b> |
|------------------|------------------------|

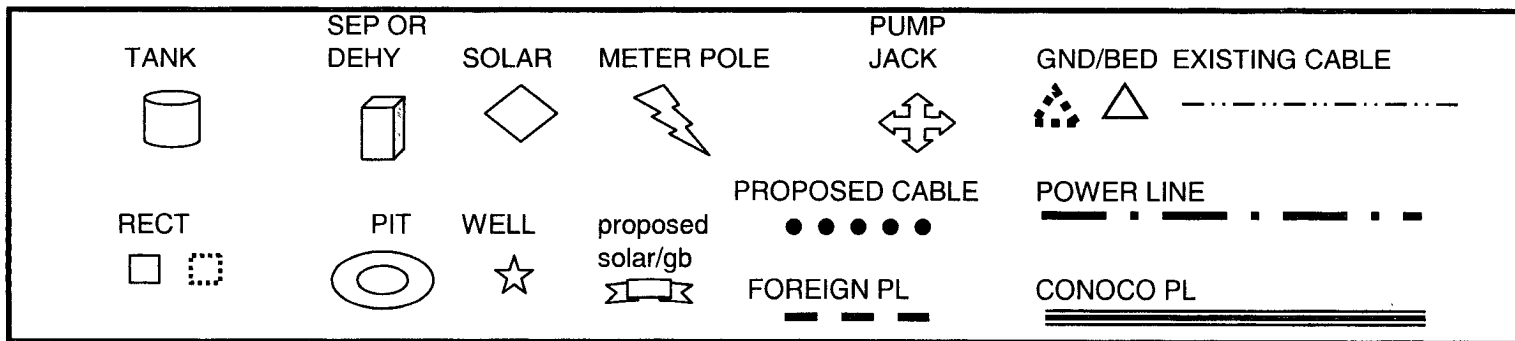
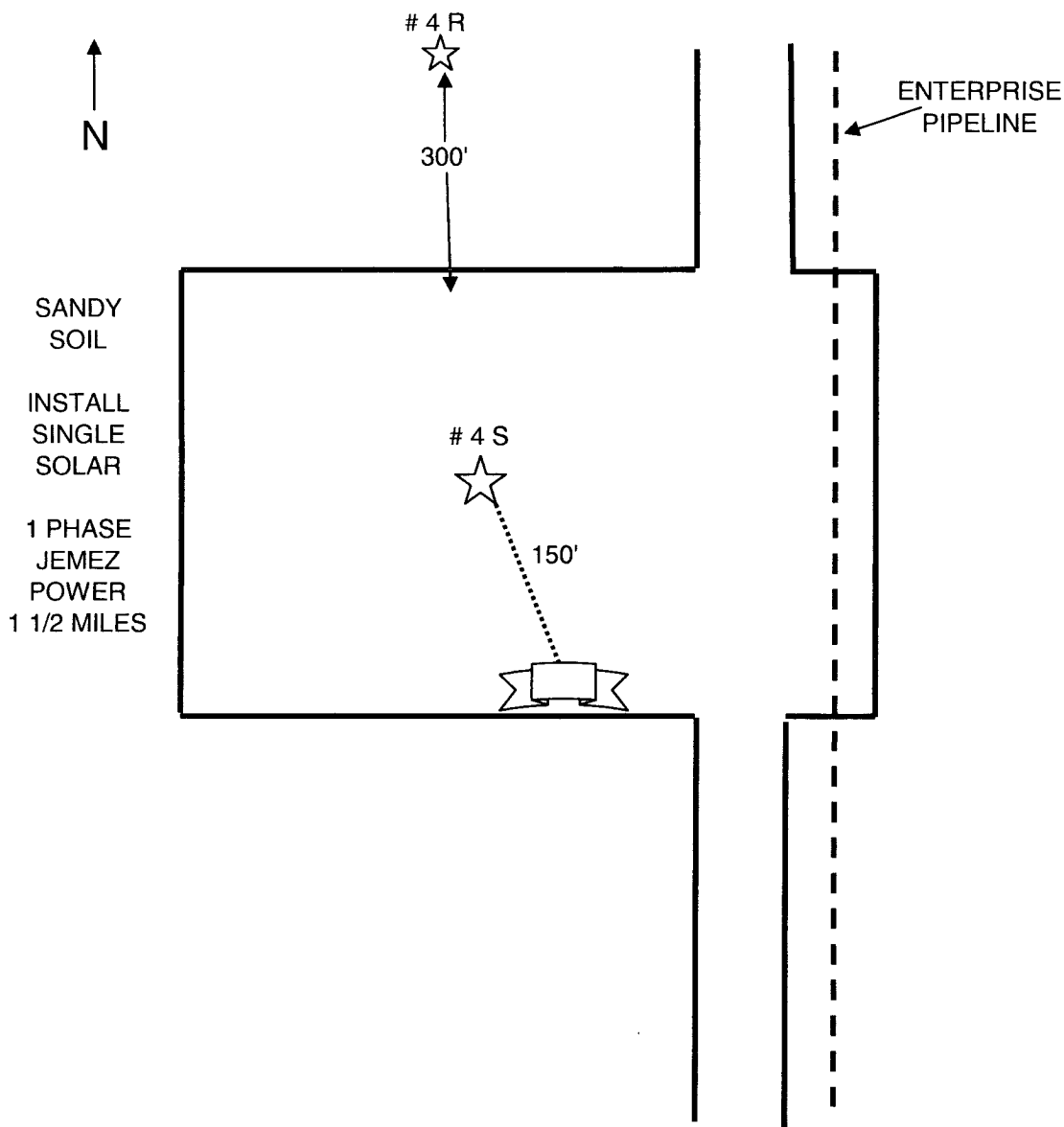

# PROJECT PROPOSAL - New Drill / Sidetrack

CLEVELAND 4S

DEVELOPMENT

|                             |  |                        |  |                          |                  |
|-----------------------------|--|------------------------|--|--------------------------|------------------|
| Lease:                      |  | AFE #: WAN.CDR.7291    |  | AFE \$: 214,452.65       |                  |
| Field Name: hBR_SAN JUAN    |  | Rig: Aztec Rig 580     |  | State: NM                | County: SAN JUAN |
| Geologist:                  |  | Phone:                 |  | Geophysicist: Phone:     |                  |
| Geoscientist: Clark, Dave D |  | Phone: +1 505-326-9762 |  | Prod. Engineer: Phone:   |                  |
| Res. Engineer:              |  | Phone:                 |  | Proj. Field Lead: Phone: |                  |

## Primary Objective (Zones):

| Zone | Zone Name                  |
|------|----------------------------|
| JCV  | BASIN FRUITLAND COAL (GAS) |

## Location: Datum Code: NAD 27

|                     |                        |                     |    |                      |                |
|---------------------|------------------------|---------------------|----|----------------------|----------------|
| Latitude: 36.556801 | Longitude: -107.789355 | X:                  | Y: | Section: 21          | Range: 009W    |
| Footage X: 1515 FEL |                        | Footage Y: 1230 FSL |    | Elevation: 6282 (FT) | Township: 027N |

Tolerance:

Location Type: Year Round Start Date (Est.): 1/1/2008 Completion Date: Date In Operation:

Formation Data: Assume KB = 6296 Units = FT

| Formation Call & Casing Points | Depth (TVD in Ft) | SS (Ft) | Depletion (Yes/No)       | BHP (PSIG) | BHT | Remarks  |
|--------------------------------|-------------------|---------|--------------------------|------------|-----|--|
| Surface Casing                 | 120               | 6176    | <input type="checkbox"/> |            |     | 8-3/4 hole. 7" 20 ppf, J-55 STC csg. Cement with 50 cuft. Circulate cement to surface.             |
| OJO ALAMO                      | 1220              | 5076    | <input type="checkbox"/> |            |     |  |
| KIRTLAND                       | 1381              | 4915    | <input type="checkbox"/> |            |     |  |
| FRUITLAND                      | 1794              | 4502    | <input type="checkbox"/> | 200        |     | Gas  |
| PICTURED CLIFFS                | 2167              | 4129    | <input type="checkbox"/> |            |     | Gas TD - 200' Below Top Pictured Cliffs  |
| Total Depth                    | 2367              | 3929    | <input type="checkbox"/> |            |     | 6-1/4" hole. 4-1/2" 10.5 ppf, J-55, STC casing. Cement with 364 cuft. Circulate cement to surface. |

## Reference Wells:

| Reference Type | Well Name      | Comments          |
|----------------|----------------|-------------------|
| Production     | Cleveland 4-21 | 27N-9W21 NW SE SW |
| Production     | Huerfanto 7-21 | 27N-9W21 SW SE    |
| Production     | Cleveland 7R   | 27N-9W21 SE NW SE |
| Production     | Cleveland 7    | 27N-9W21 SE NW SE |

## Logging Program:

Intermediate Logs: ☐ Log only if show ☐ GR/ILD ☐ Triple Combo

TD Logs: ☐ Triple Combo ☐ Dipmeter ☐ RFT ☐ Sonic ☐ VSP ☐ TDT ☒ Other  
Open Hole - GR & Density from TD to Surface. (minimum footage).

## Additional Information:

| Log Type | Stage | From (Ft) | To (Ft) | Tool Type/Name | Remarks |
|----------|-------|-----------|---------|----------------|---------|
|----------|-------|-----------|---------|----------------|---------|

Comments:

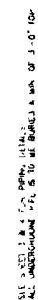

Seitz, S. S.

[illegible]

**Directions from the Intersection of US Hwy 550 & US Hwy 64 in Bloomfield, NM**  
**to Burlington Resources Oil & Gas Company Cleveland #4S**

**1230' FSL & 1515' FEL, Section 21, T27N, R9W, N.M.P.M., San Juan County, NM**

**Latitude: 36.55681°N Longitude: 107.78997°W Datum: NAD1983**

From the intersection of US Hwy 550 & US Hwy 64 in Bloomfield, NM, travel Southerly on US Hwy 550 for 15.8 miles to County Road #7225 @ Mile Marker 135.8;

Go left (Easterly) on County Road #7225 for 4.6 miles to 4-way intersection;

Go straight (North-easterly) @ 4-way intersection remaining on County Road #7225 for 5.2 miles to fork in road;

Go single-right (South-easterly) for 0.4 miles to staked location on right-hand side of existing roadway which overlaps an abandoned wellpad.